

Santa Clara Unified School District – Agnews Campus

Schematic Design Update
September 28, 2017



agenda /

02 min Process Update

03 min Sustainability

05 min Agnews Campus Design

10 min School Floor Plan Organization

05 min Schedule Update

25 MIN UPDATE

FOCUS GROUP: ADJACENCY DISCUSSION

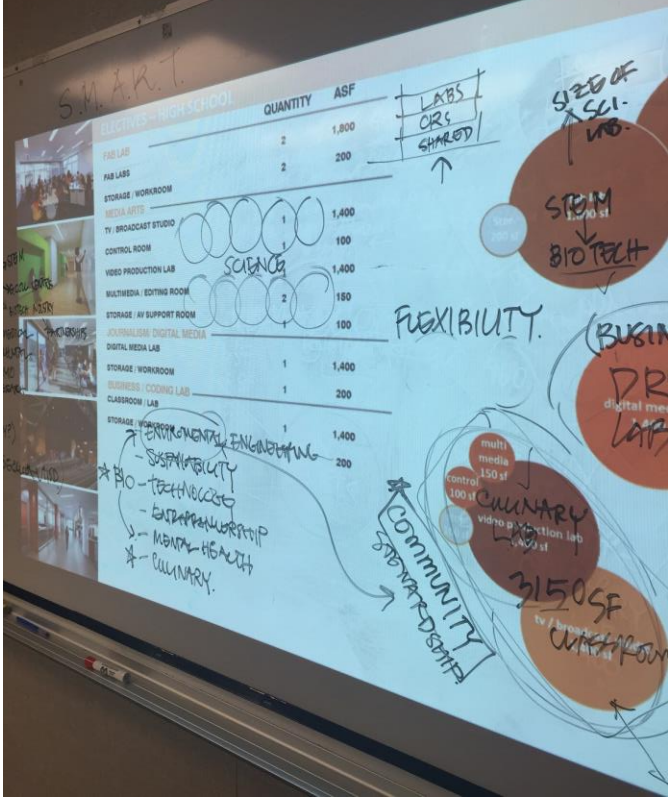

PULL PLANNING SESSION



SCHOOL SITE COMMITTEE WORKSHOP

- 20+ FOCUS GROUP MEETINGS
- 3 SCHOOL SITE COMMITTEE WORKSHOPS
- 3 AGNEWS SITE VISITS
- 1 PULL PLANNING SESSION
- 4 SUPER DESIGN COMMITTEE MEETINGS
- WEEKLY EXECUTIVE COMMITTEE MEETINGS



SITE AWARENESS WALK

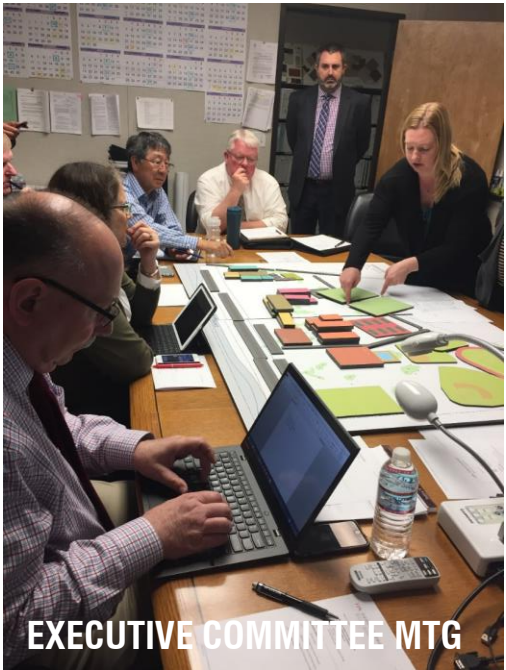

EXECUTIVE COMMITTEE MTG



FOCUS GROUP MTG

PROCESS

SCHEMATIC DESIGN UPDATE



LPA



sustainable



mindful



adaptable



relevant



transformational

Energy & Water Conservation

Reduce on-going utility costs and environmental impacts

Durability & Maintenance

Provide materials, finishes, and systems that will endure with limited costs to maintain, repair and replace

Indoor Environmental Quality

Promote student and staff health, wellness and learning by optimizing indoor air quality, comfort, lighting, and acoustics

Curriculum & Community Engagement

Demonstrate environmental stewardship and provide learning opportunities through tangible and accessible design elements

SUSTAINABILITY + GUIDING PRINCIPLES

SCHEMATIC DESIGN UPDATE

LPA





- ADDITIONAL EDUC PROGRAM
- ADMIN
- ATHLETICS
- CORE ACADEMICS / CLASSROOMS
- ELECTIVES
- CORE/ BUILDING SUPPORT
- PERFORMING ARTS
- PERFORMING ARTS CLASSROOM
- PHYSICAL ED
- STUDENT ACTIVITIES
- STUDENT SERVICES

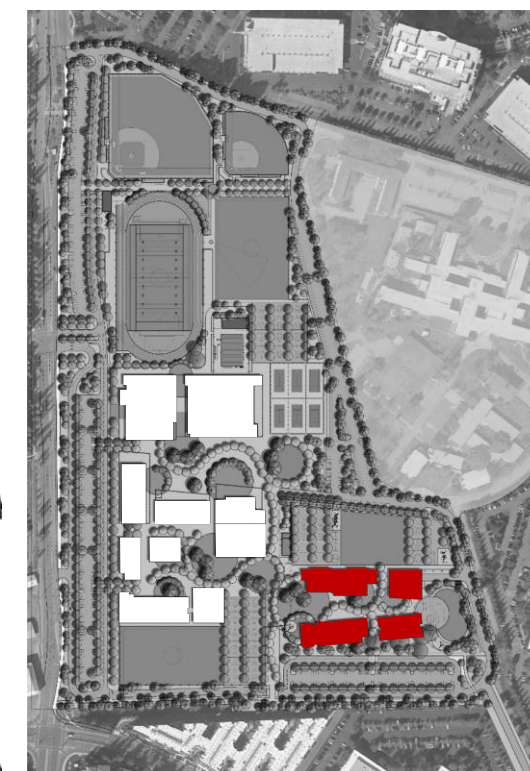
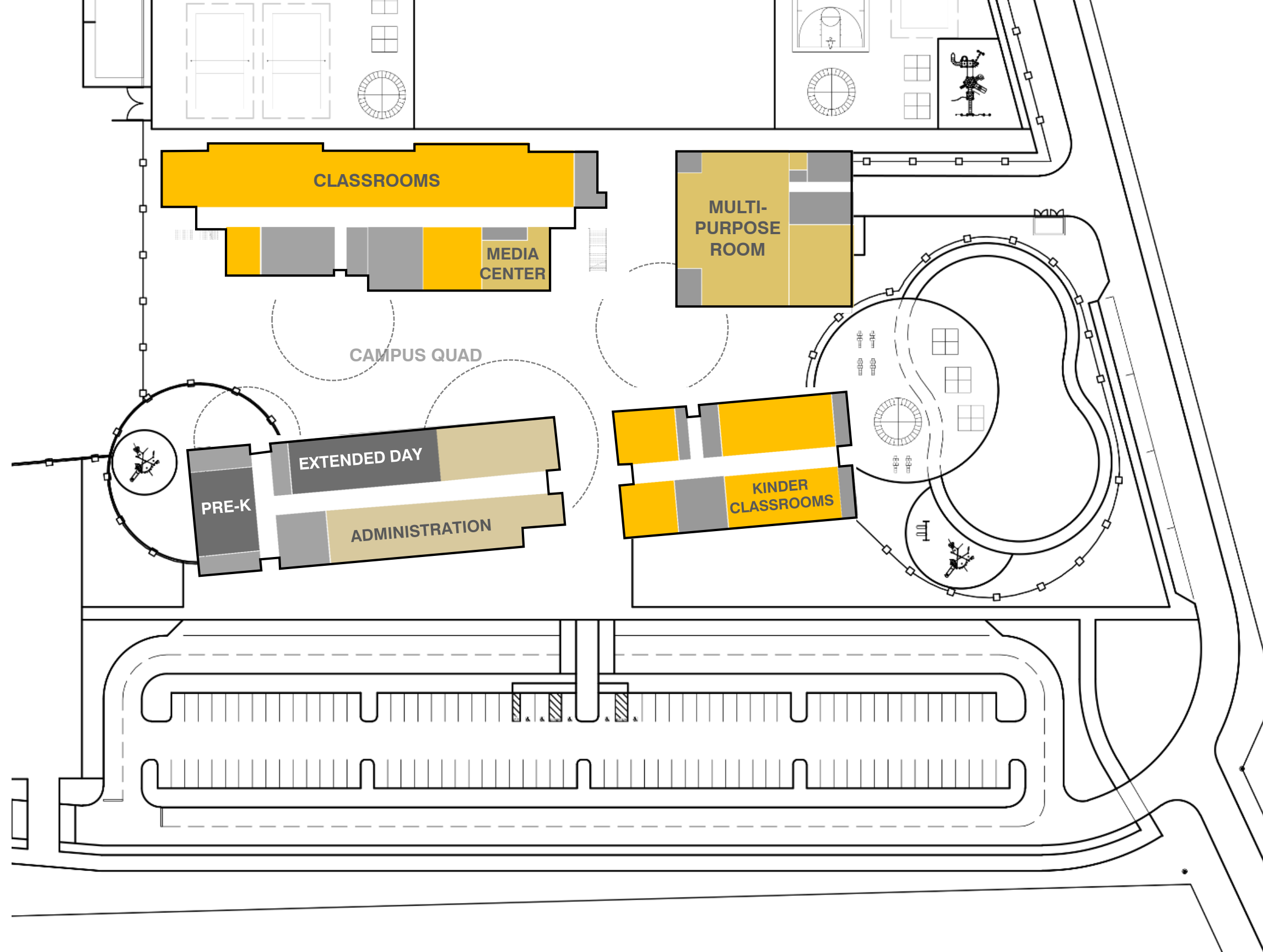
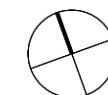

- ADDITIONAL EDUC PROGRAM
- ADMIN
- ATHLETICS
- CORE ACADEMICS / CLASSROOMS
- ELECTIVES
- CORE/ BUILDING SUPPORT
- PERFORMING ARTS
- PERFORMING ARTS CLASSROOM
- PHYSICAL ED
- STUDENT ACTIVITIES
- STUDENT SERVICES

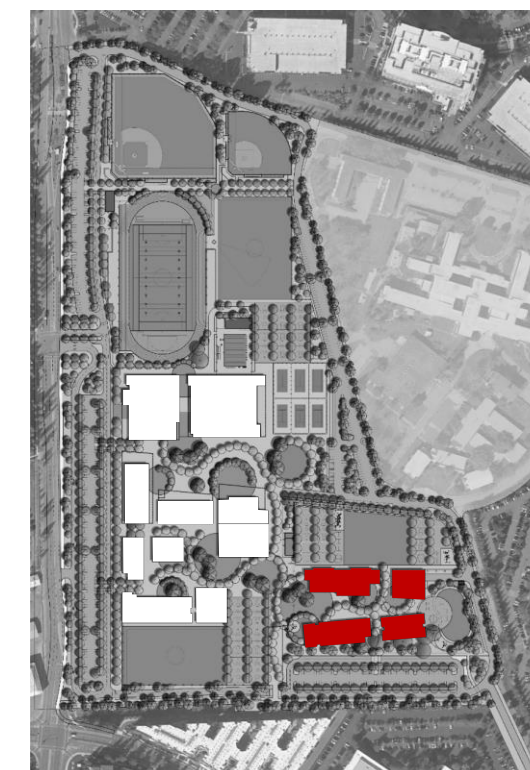
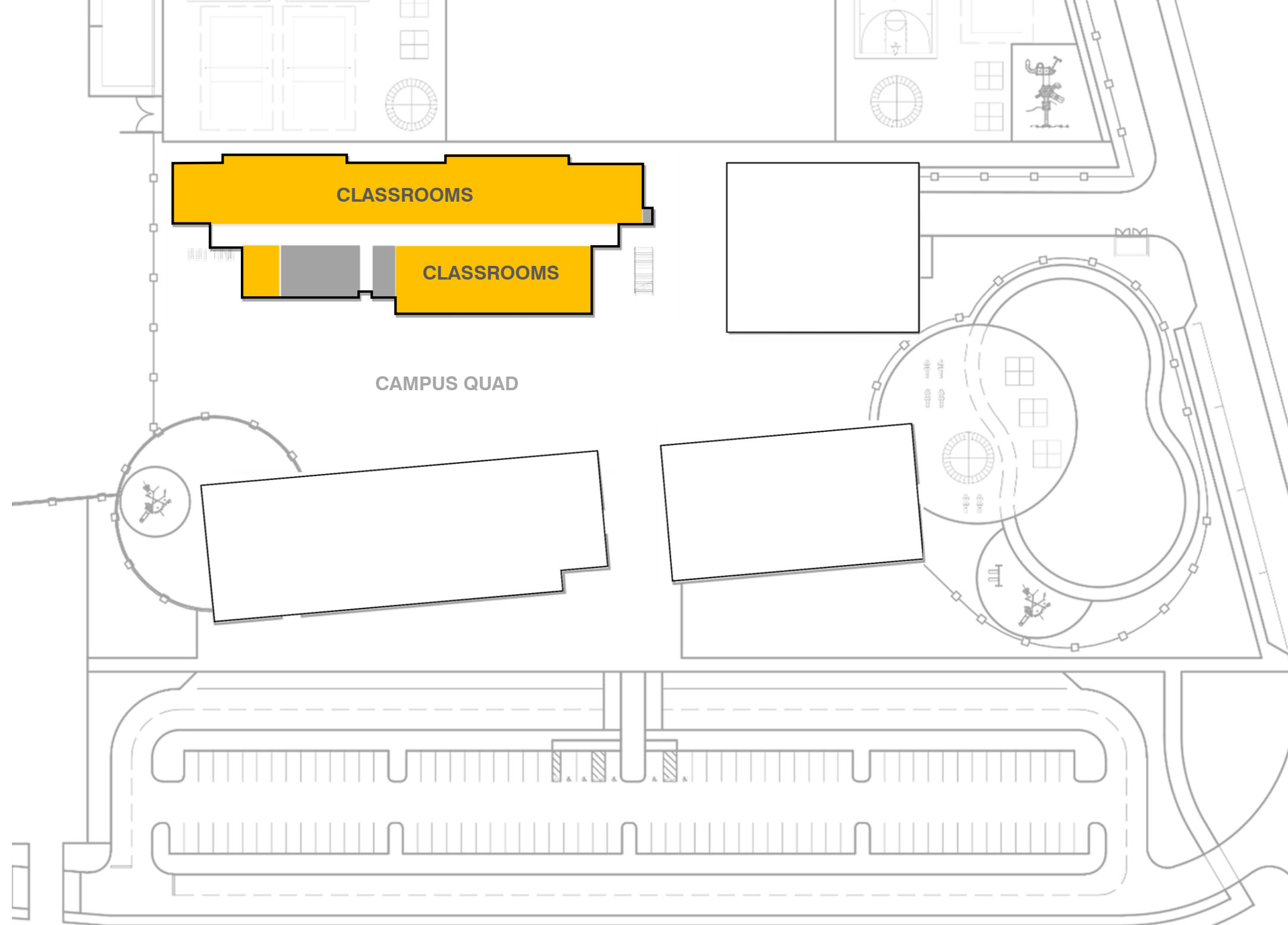
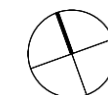

- ADDITIONAL EDUC PROGRAM
- ADMIN
- ATHLETICS
- CORE ACADEMICS / CLASSROOMS
- ELECTIVES
- CORE/ BUILDING SUPPORT
- PERFORMING ARTS
- PERFORMING ARTS CLASSROOM
- PHYSICAL ED
- STUDENT ACTIVITIES
- STUDENT SERVICES

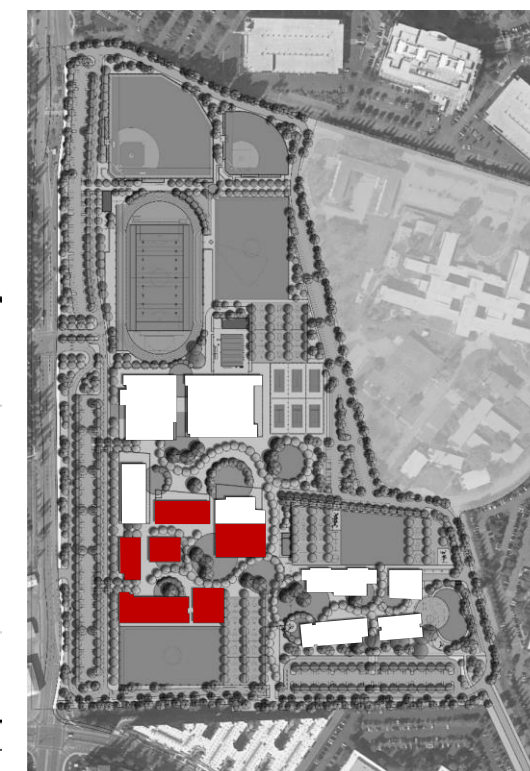
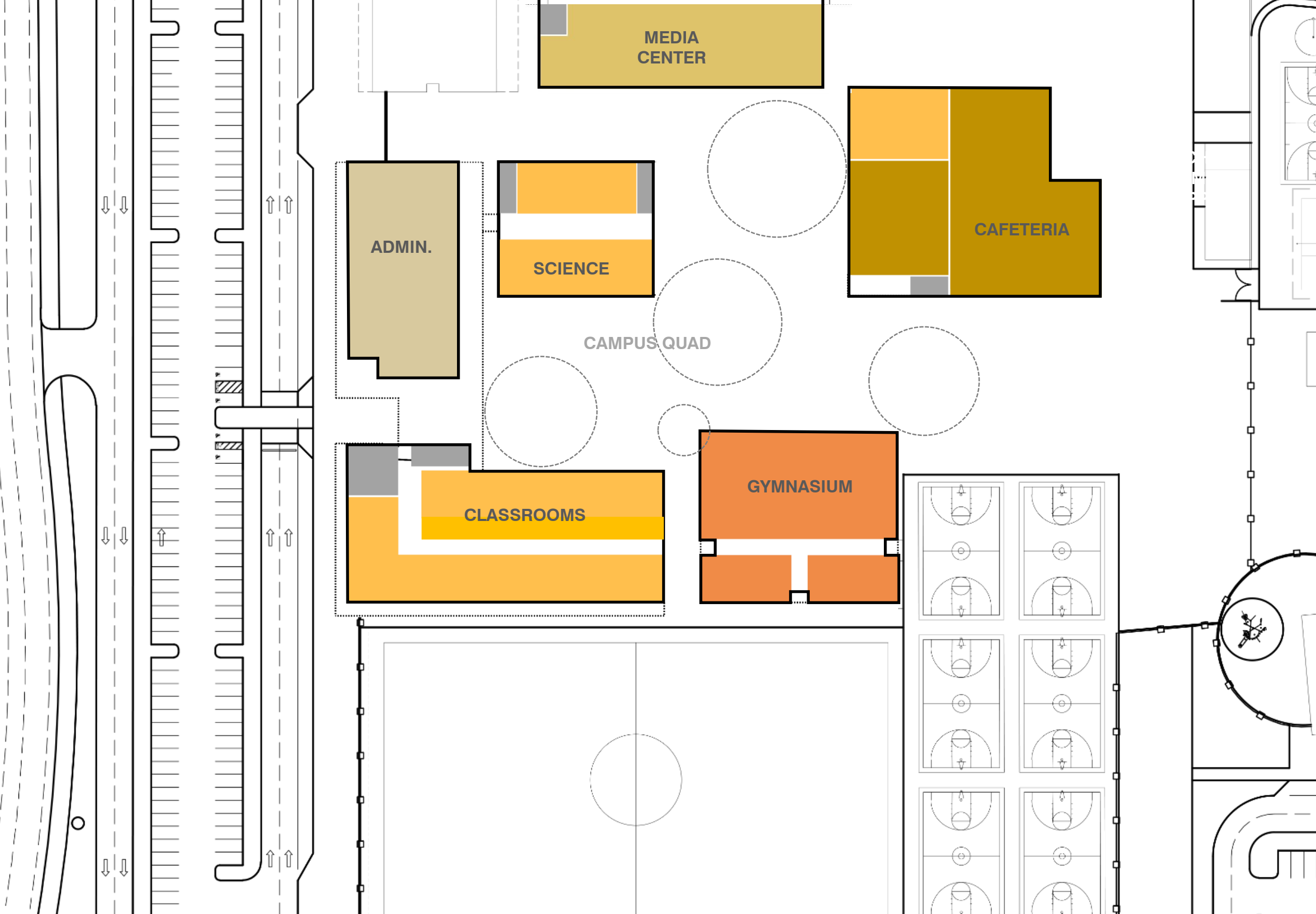
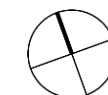

- ADDITIONAL EDUC PROGRAM
- ADMIN
- ATHLETICS
- CORE ACADEMICS / CLASSROOMS
- ELECTIVES
- CORE/ BUILDING SUPPORT
- PERFORMING ARTS
- PERFORMING ARTS CLASSROOM
- PHYSICAL ED
- STUDENT ACTIVITIES
- STUDENT SERVICES

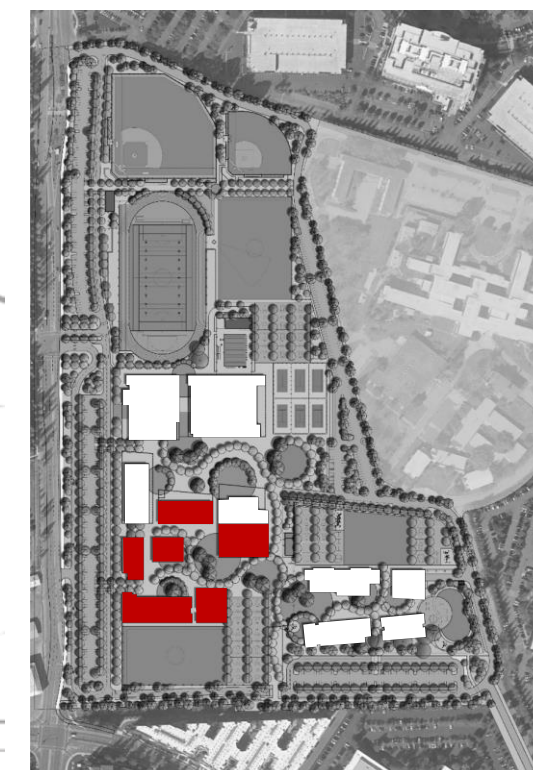
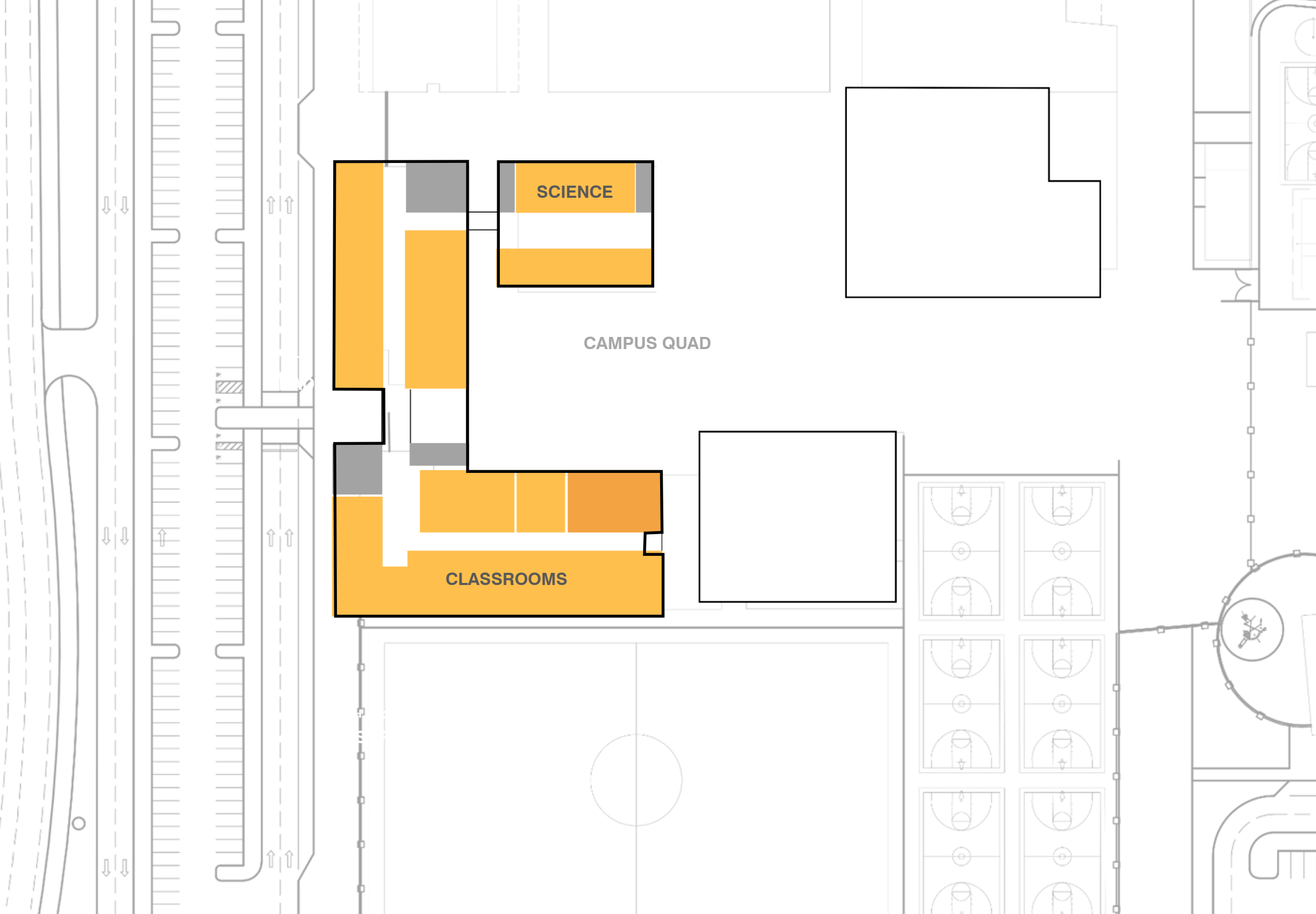
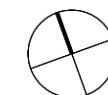

- ADDITIONAL EDUC PROGRAM
- ADMIN
- ATHLETICS
- CORE ACADEMICS / CLASSROOMS
- ELECTIVES
- CORE/ BUILDING SUPPORT
- PERFORMING ARTS
- PERFORMING ARTS CLASSROOM
- PHYSICAL ED
- STUDENT ACTIVITIES
- STUDENT SERVICES

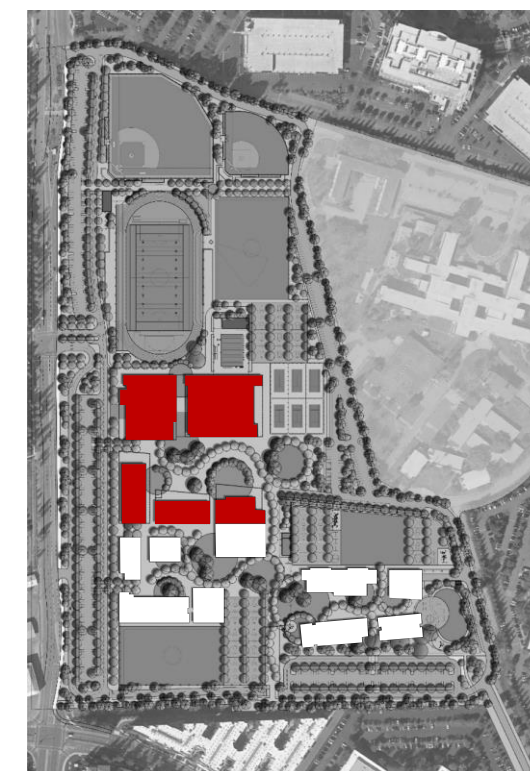
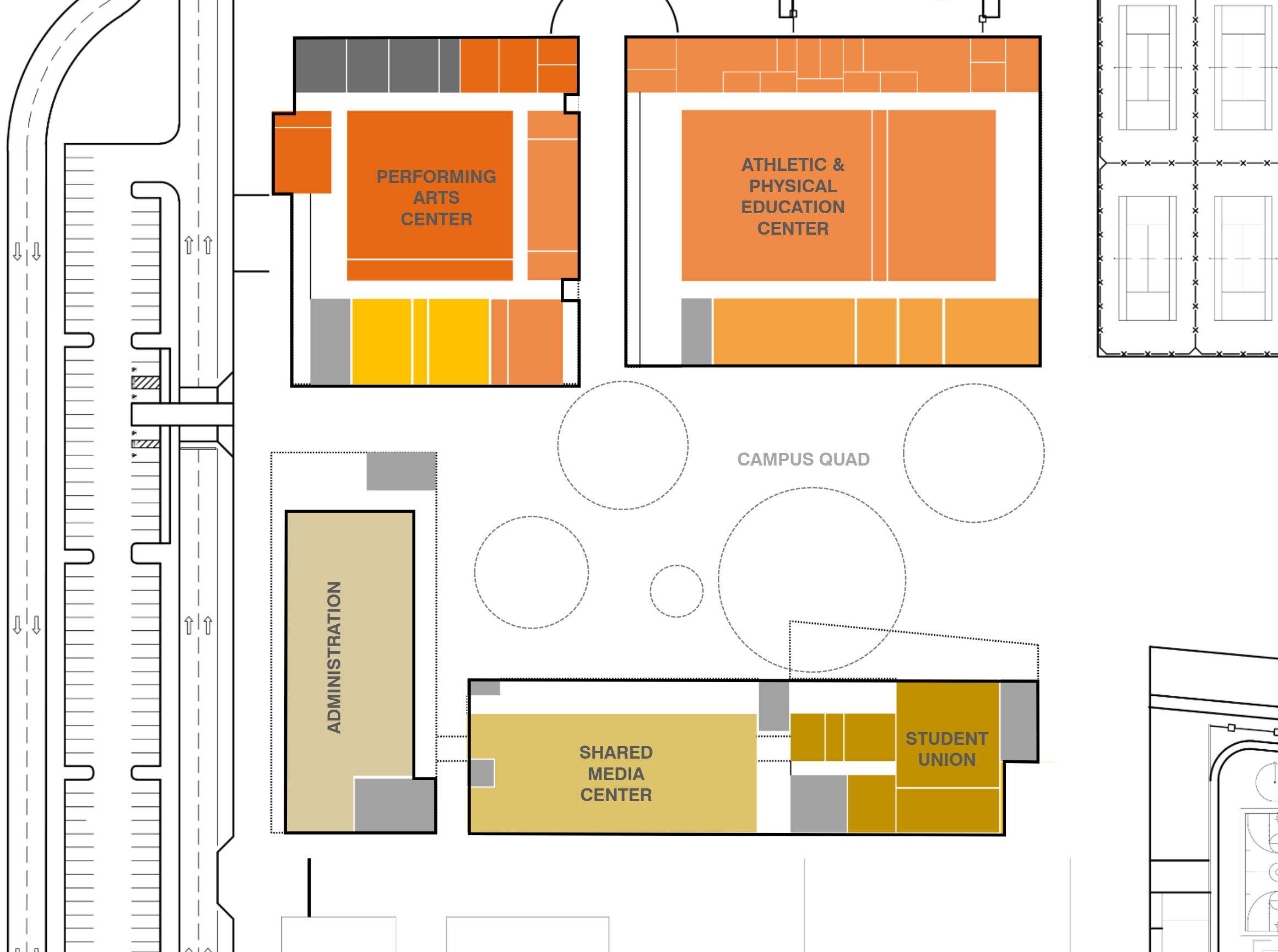
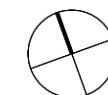

- ADDITIONAL EDUC PROGRAM
- ADMIN
- ATHLETICS
- CORE ACADEMICS / CLASSROOMS
- ELECTIVES
- CORE/ BUILDING SUPPORT
- PERFORMING ARTS
- PERFORMING ARTS CLASSROOM
- PHYSICAL ED
- STUDENT ACTIVITIES
- STUDENT SERVICES

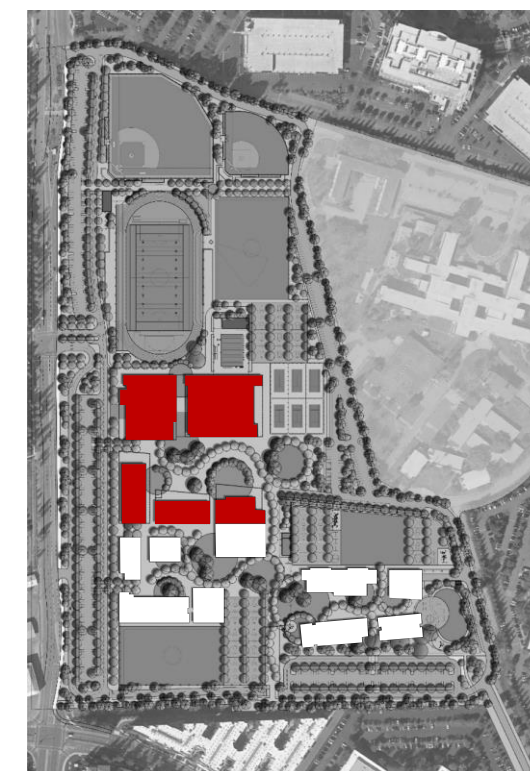
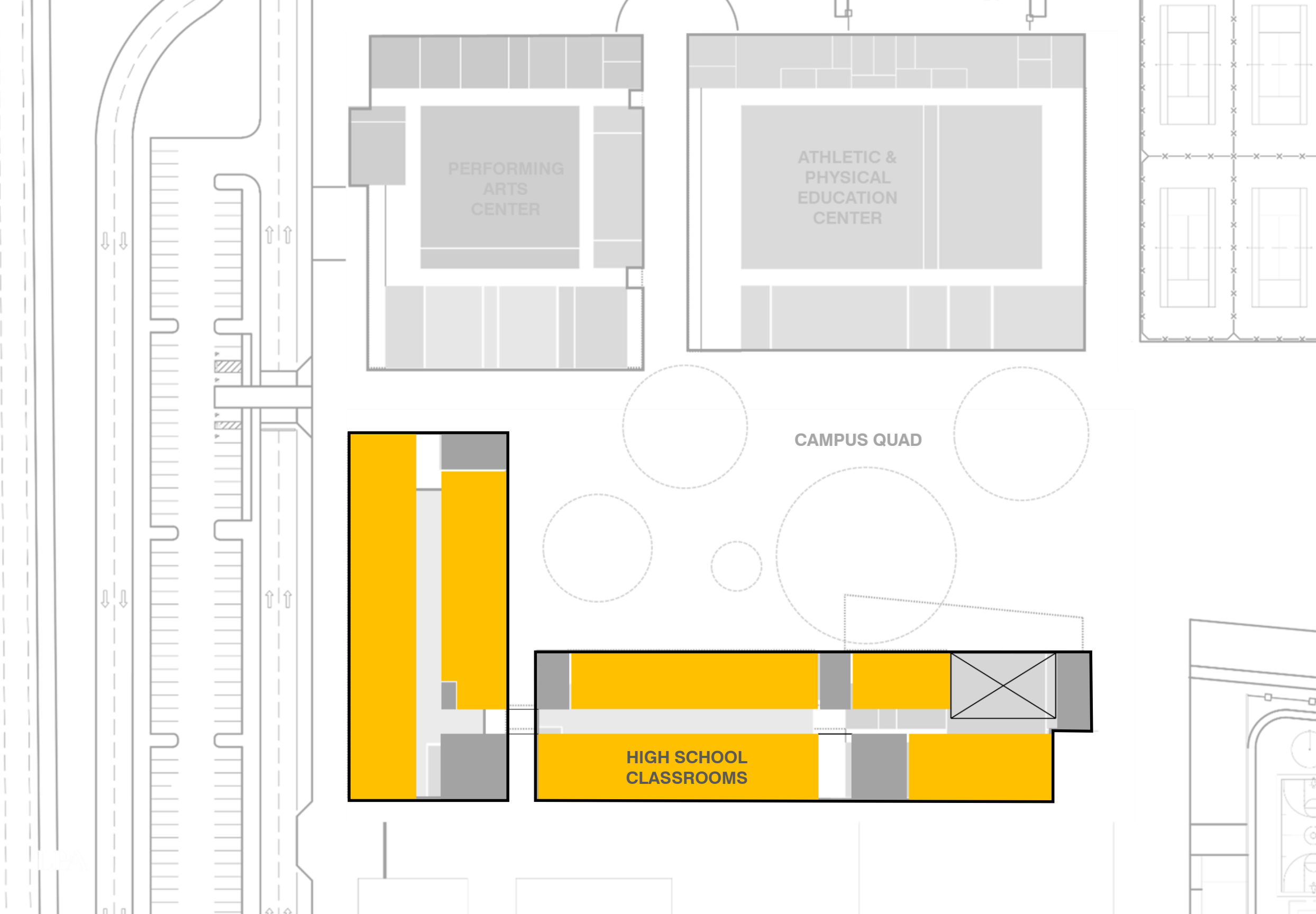
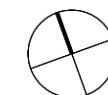

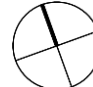
- ADDITIONAL EDUC PROGRAM
 - ADMIN
 - ATHLETICS
 - CORE ACADEMICS / CLASSROOMS
 - ELECTIVES
 - CORE/ BUILDING SUPPORT
 - PERFORMING ARTS
 - PERFORMING ARTS CLASSROOM
 - PHYSICAL ED
 - STUDENT ACTIVITIES
 - STUDENT SERVICES
- 

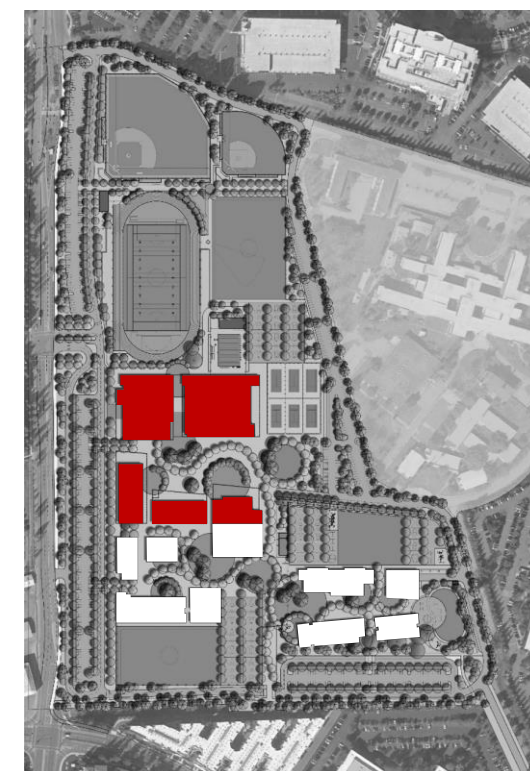
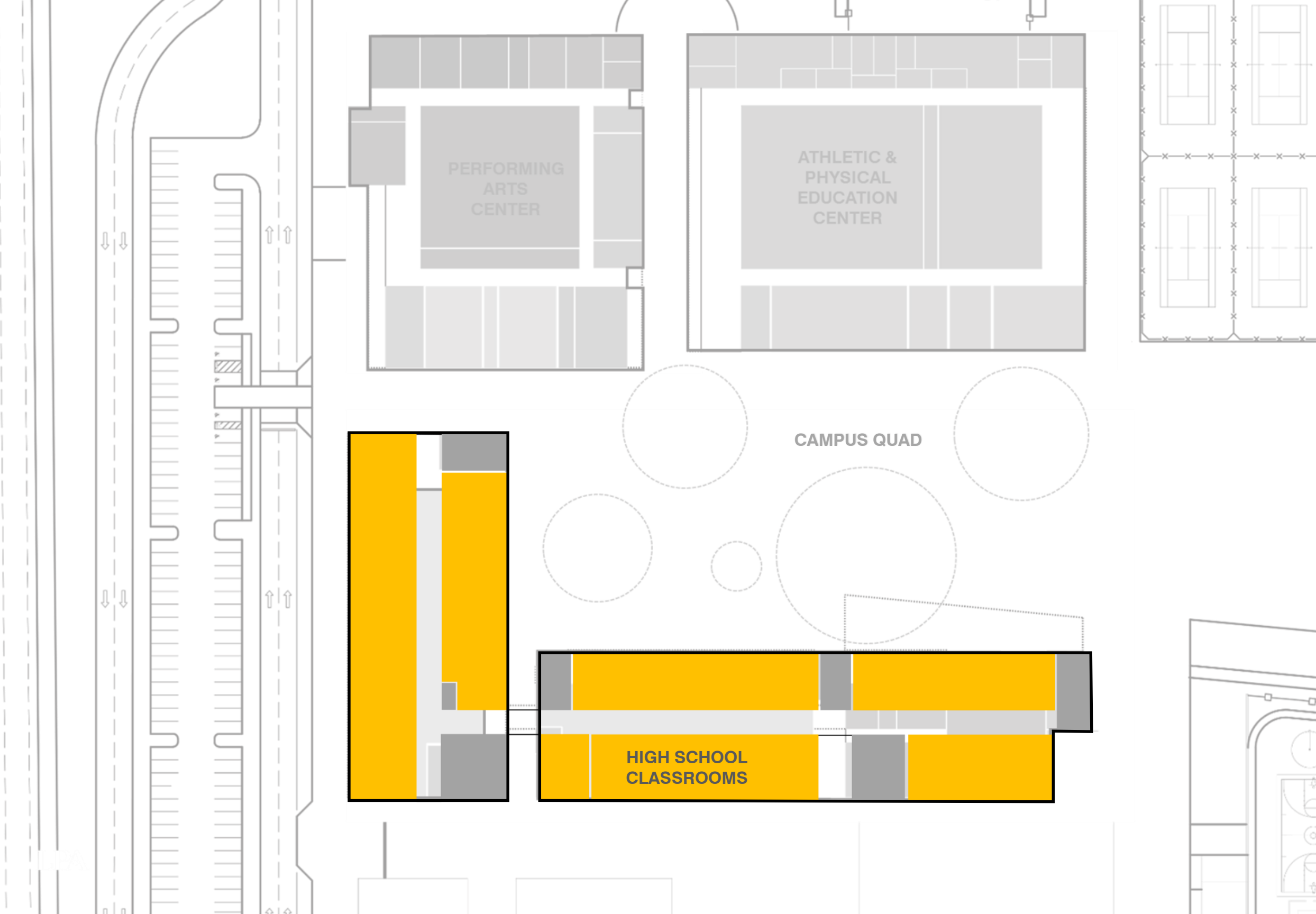

Elementary & Middle School – 2020 Occupancy

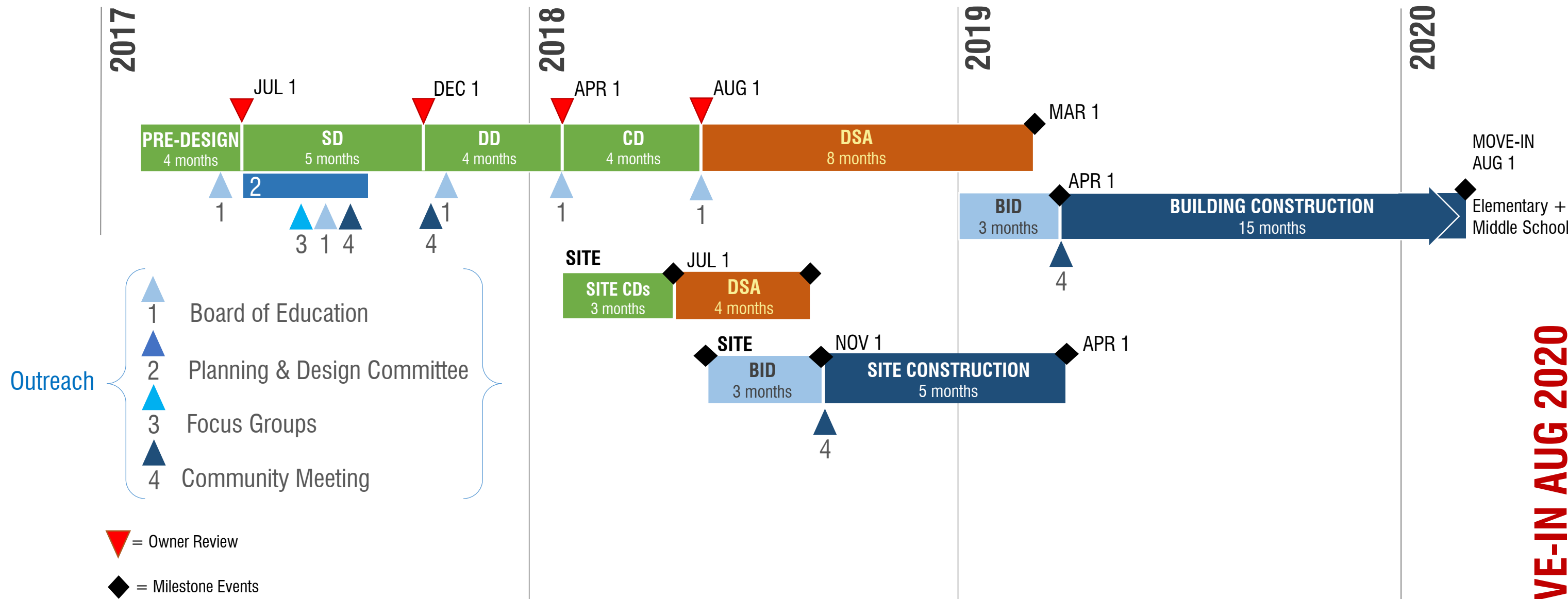

MILESTONES TIMELINE
PROPOSED SCHEDULE

MOVE-IN AUG 2020

High School (400 Student) – 2021 Occupancy

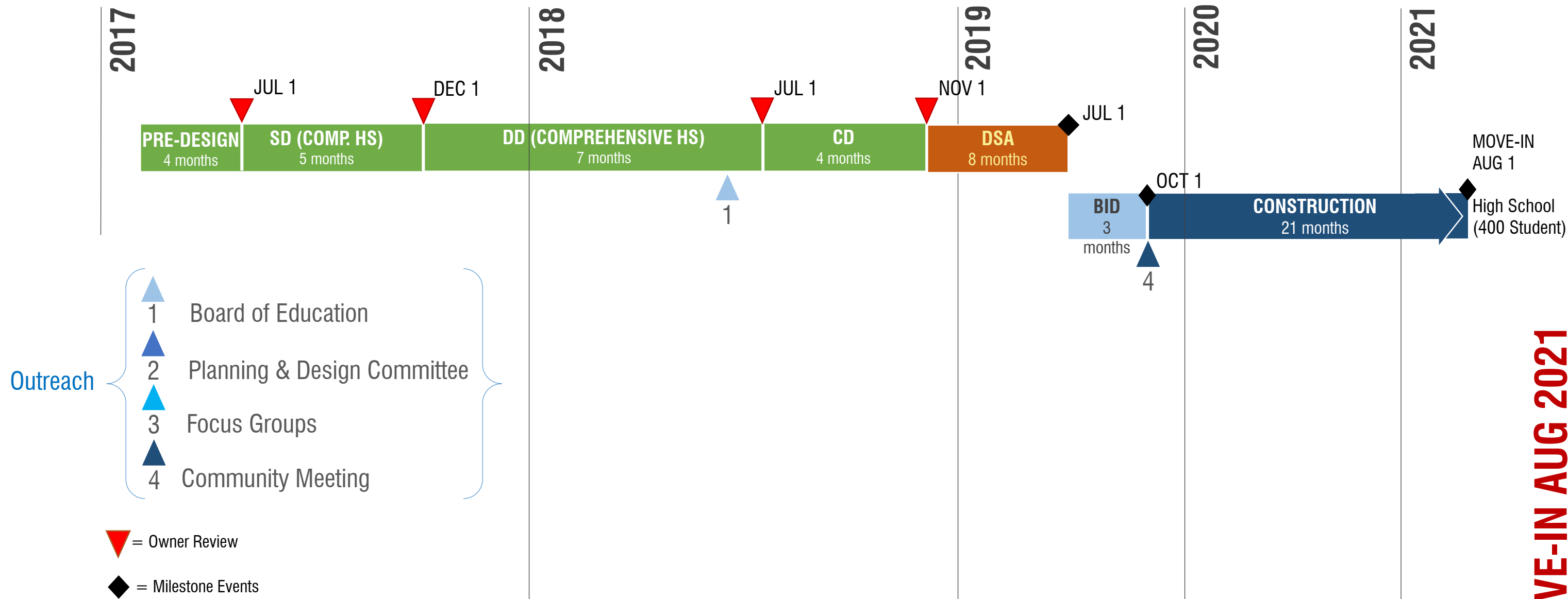

MILESTONES TIMELINE

PROPOSED SCHEDULE

MOVE-IN AUG 2021

LPA

INTEGRATED DESIGN

creating sustainable places and spaces that enrich the lives of those who use them

