

A decorative graphic on the left side of the slide consists of a network of thin, dark blue lines. These lines branch out and connect to small, open circles, resembling a stylized circuit board or a neural network diagram. The lines and circles are concentrated on the left edge, with some extending slightly into the main content area.

NEW ELEMENTARY SCHOOL IN FOSTER CITY

UPDATE FOR THE BOARD OF TRUSTEES

NOVEMBER 2, 2017

PURPOSES

- REVIEW DESIGN DRAWINGS
- PROVIDE A PREVIEW OF UPCOMING ACTIONS
- REVIEW THE SCHEDULE

SITE PLAN



New Elementary School in Foster City Conceptual Site Plan Including Vehicular Circulation Patterns

October 2017

San Mateo-Foster City School District

PASSING LANE: 20'-0" WIDE
 DROP-OFF LANE: 10'-0" WIDE
 PARKING LANE (DOUBLE LOADED): 18'-0" WIDE
 PARKING LANE (SINGLE LOADED): 16'-0" WIDE

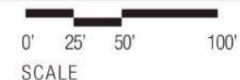

HMC Architects

VISUAL RENDERINGS



New Elementary School in Foster City - View from Shell Blvd, Looking South-West, of Passing & Drop-off Queuing Lanes

October 2017

San Mateo-Foster City School District

HMC Architects



New Elementary School in Foster City - View from Shell Blvd, of Pedestrian Entrance and Vehicular Exit

San Mateo-Foster City School District

October 2017

HMC Architects



New Elementary School in Foster City - View from Beach Park Blvd, Looking North, of Passing & Drop-off Queuing Lanes

October 2017

San Mateo-Foster City School District

HMC Architects



New Elementary School in Foster City - View from Playground, Looking East, of Outdoor Learning Node and Classrooms

October 2017

San Mateo-Foster City School District

HMC Architects



New Elementary School in Foster City - View from Playground, Looking East, of Classrooms & Kinder Classrooms

San Mateo-Foster City School District

October 2017

HMC Architects



INTERIOR CLASSROOMS—COLOR SCHEME AND INTERIOR RENDERING

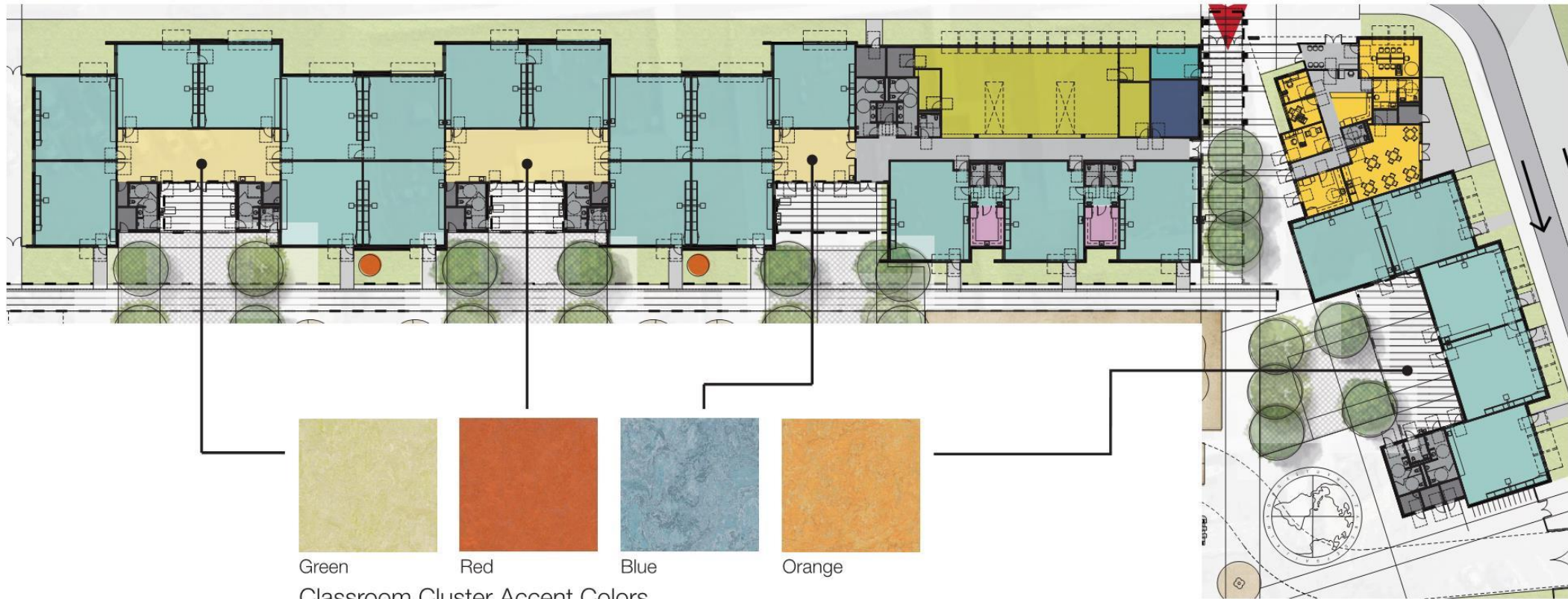

Green Red Blue Orange

Classroom Cluster Accent Colors

Gray Yellow

Field Colors

INTERIOR COLOR SCHEME



The background is a blue gradient with decorative white circuit-like lines in the corners. The lines consist of straight segments and small circles, resembling a stylized electronic circuit or data network.

LIBRARY/RESOURCE CENTER







MULTIPURPOSE ROOM



NOVEMBER 16 BOARD MEETING

- Complete the Comprehensive Environmental Review Process pursuant to the California Environmental Quality Act (CEQA)
- Two steps
 - Public Hearing on the Final Environmental Impact Report (EIR) including Findings, Mitigation Measures, and Responses to Comments on the draft EIR
 - Consideration of two resolutions
 - Certification of Final EIR
 - Statement of Overriding Consideration

NEW ELEMENTARY SCHOOL IN FOSTER CITY

TIMELINE AS OF END OF OCTOBER 2017

Design
Development
and
Construction
Document
Development
Begun

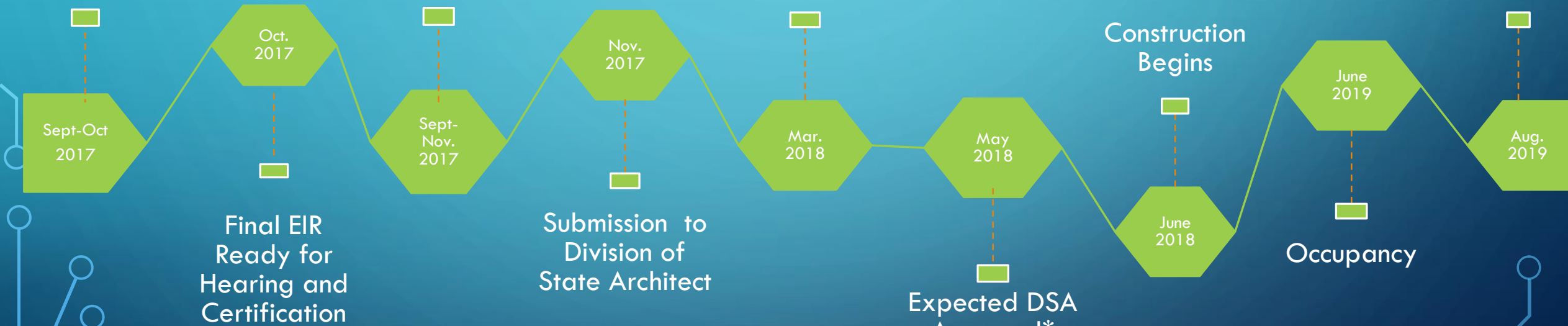

Expected DSA
Approval*

*Note: all dates
after this are
dependent on
DSA approval
by May*

The background is a blue gradient with decorative white circuit-like lines in the corners. These lines consist of straight segments and small circles, resembling a stylized electronic circuit board.

QUESTIONS AND COMMENTS