

BERKELEY HIGH SCHOOL THEATER

PHASE 1 SCOPE DEFINITION STUDY

APRIL 18, 2018

CAW
ARCHITECTS

BERKELEY HIGH SCHOOL THEATER

MASTER PLAN CONCEPT

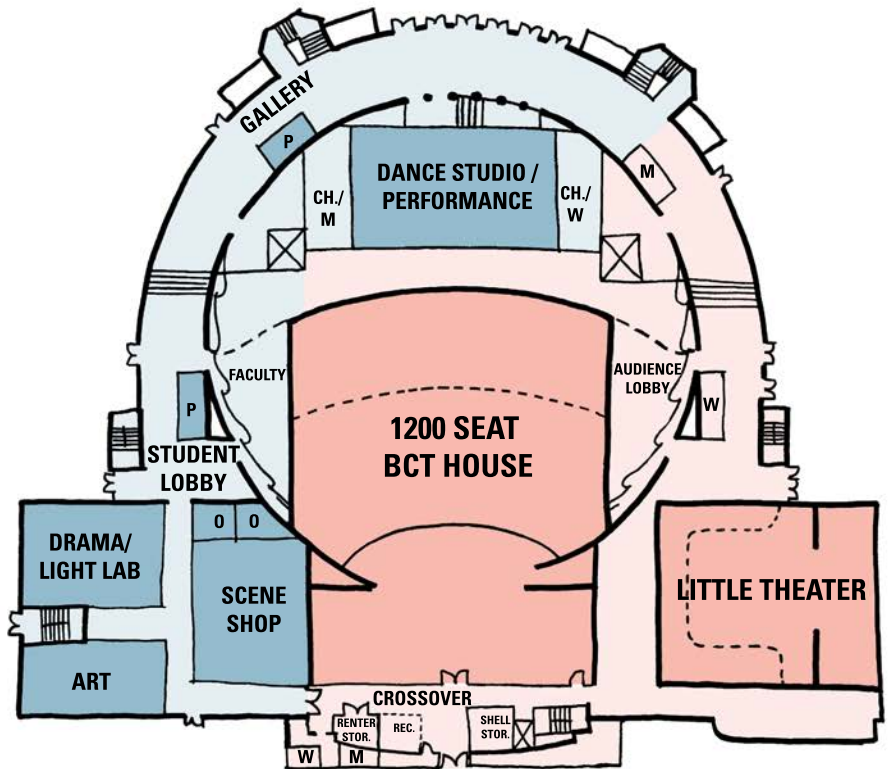

FIRST FLOOR

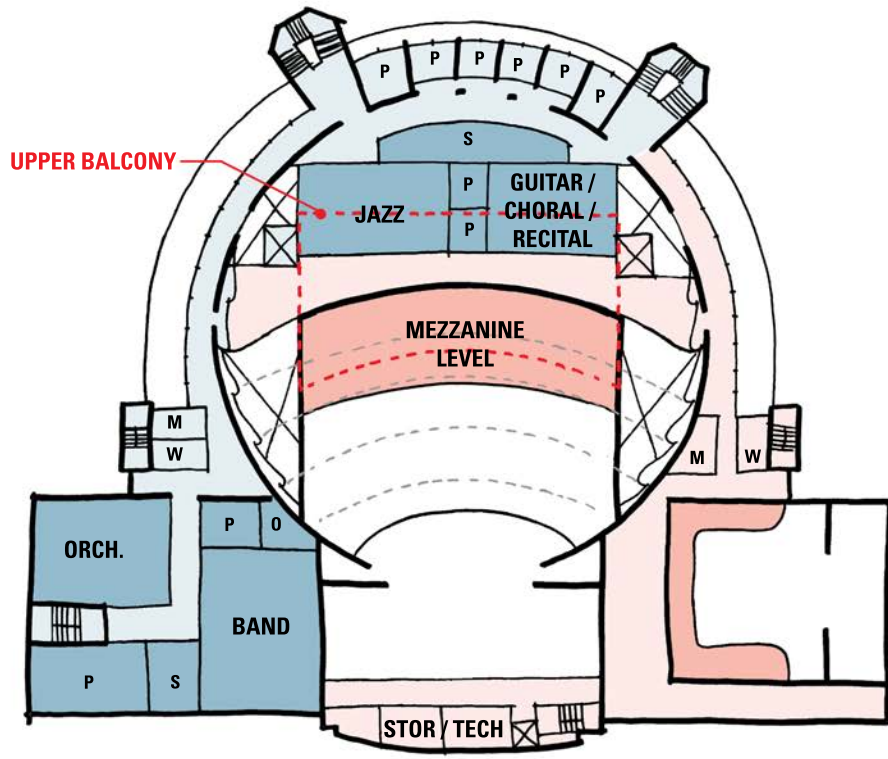

SECOND FLOOR

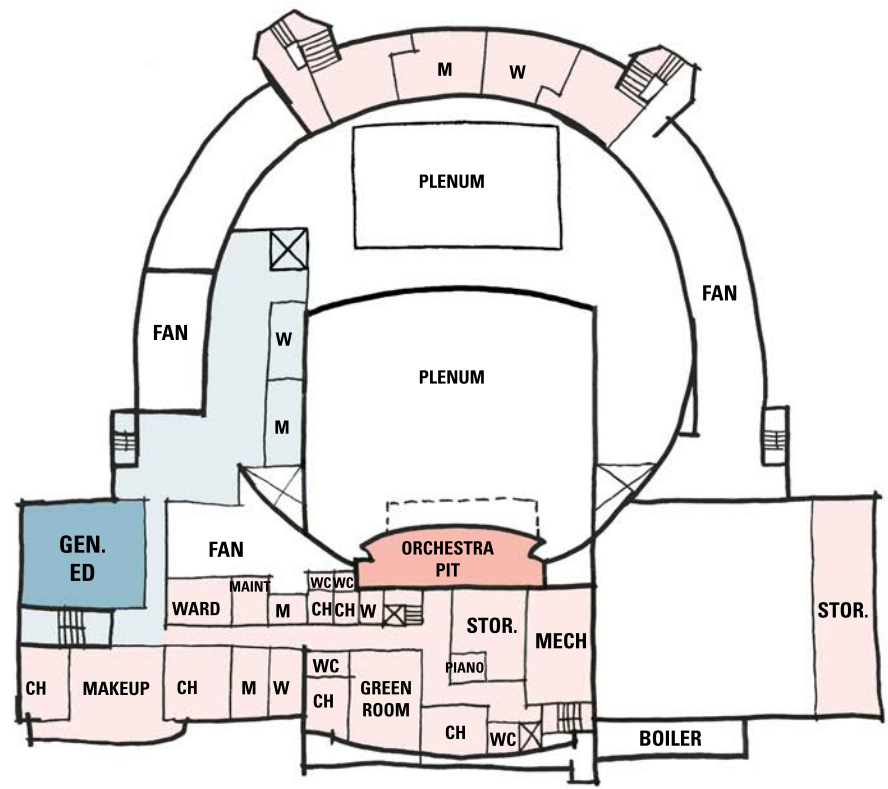

BASEMENT

	ROOM NAME	NOT INCLUDED IN SCHEME	EXISTING	NEW SHARED SPACE	NEW INDIVIDUAL SPACE
DRAMA	DRAMA CLASSROOM			●	
	DRAMA BREAK OUT SPACES			●	
	DANCE STUDIO #1 (LARGE STUDIO)			●	
	DANCE STUDIO #2 (SMALL STUDIO)				●
	DANCE BREAK OUT SPACES			●	
	LOCKER ROOMS				●
MUSIC	CHORAL ROOM				●
	CHORAL / GUITAR STORAGE				●
	ORCHESTRA ROOM				●
	ORCHESTRA INSTRUMENT STORAGE				●
	BAND ROOM				●
	BAND INSTRUMENT STORAGE				●
	JAZZ ROOM				●
	JAZZ INSTRUMENT STORAGE				●
CTE	MUSIC BREAK OUT SPACES			●	
	CTE SCENE SHOP			●	●
	CTE SOUND & LIGHT LAB			●	
ART	ART CLASSROOM		●		●
	ART GALLERY		●		
	DIGITAL DESIGN LAB	●			
OTHER	GENERAL ED CLASSROOM				●
	FACULTY SUITE				●
	FACILITY MANAGER'S OFFICE				●
	THEATER MANAGER'S OFFICE				●
PERFORMANCE	BERKELEY COMMUNITY THEATER				●
	LITTLE THEATER				●
	AUDIENCE LOBBY				●
	STUDENT LOBBY				●
	PERFORMANCE SUPPORT SPACE				●



BERKELEY HIGH SCHOOL THEATER

PHASE 1 DIRECTION

PHASE 1 - OPTION B

- Renovate Classroom Wing
- New Student Lobby

\$17,940,489 (\$580/SF)

PHASE 1 - OPTION A

- Little Theater Stage and Audience Chamber
- New Audience Lobby
- Performer Support

\$13,377,757 (\$762/SF)

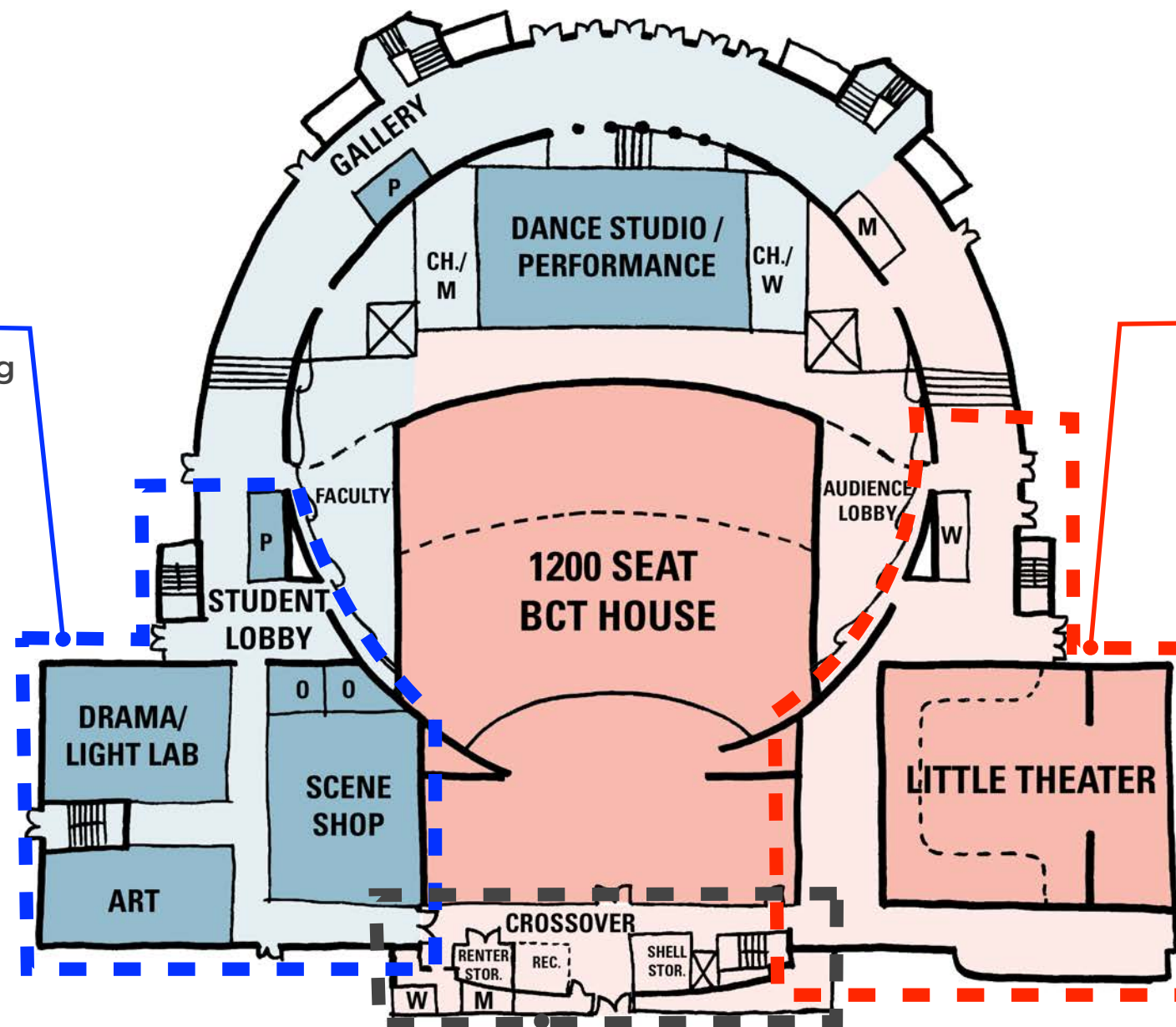

PHASE 1 - OPTION A / B

- Crossover Hall
- Basement Performer Support
- Basement Utilities

CLASSROOM WING



EXISTING PLAN - MAIN LEVEL



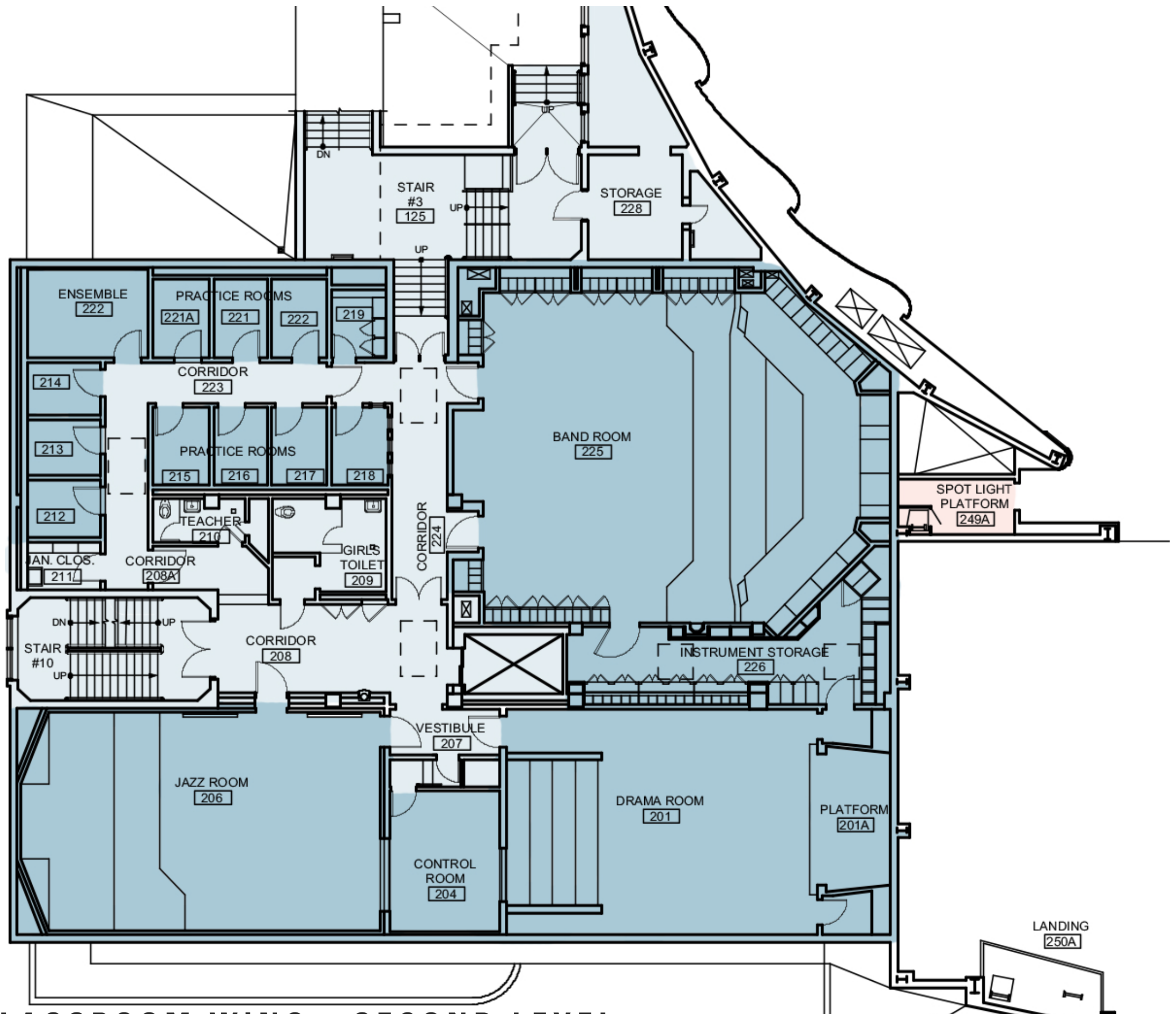

EXISTING CLASSROOM WING - SECOND LEVEL

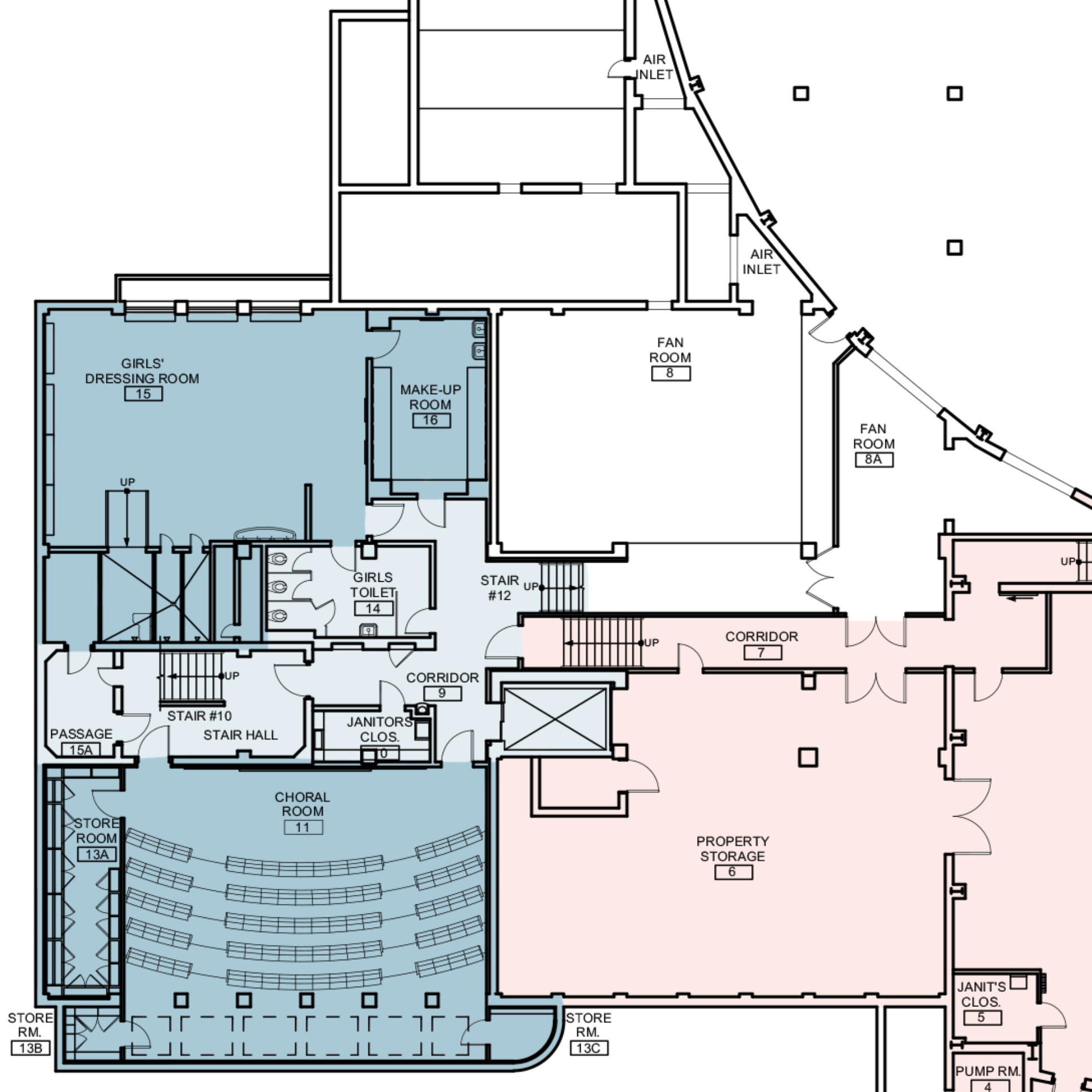

EXISTING CLASSROOM WING - LOWER LEVEL

BERKELEY HIGH SCHOOL THEATER

CLASSROOM WING



BERKELEY HIGH SCHOOL THEATER

PROPOSED PHASE 1 - MAIN LEVEL

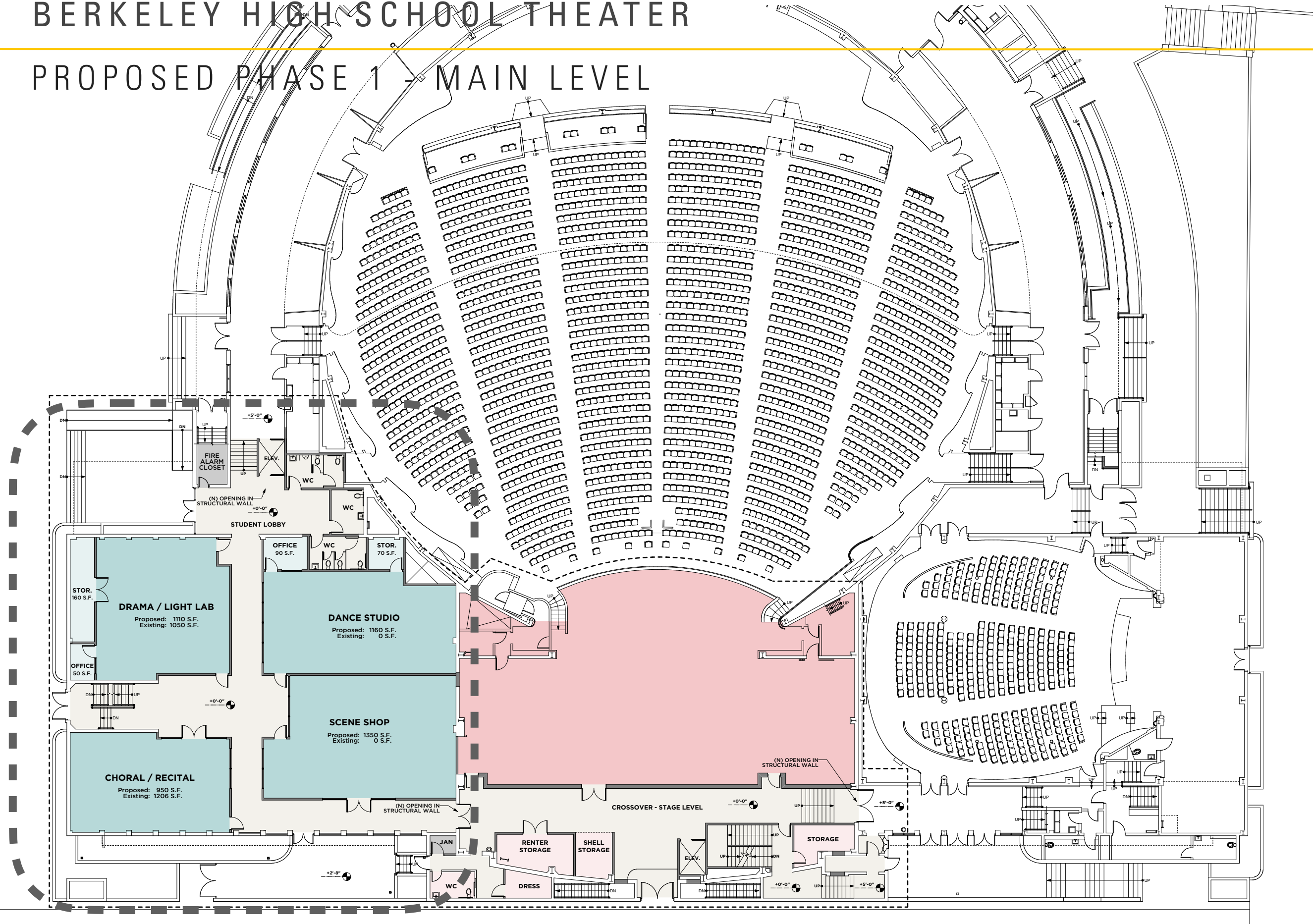

PROPOSED CLASSROOM WING - MAIN LEVEL

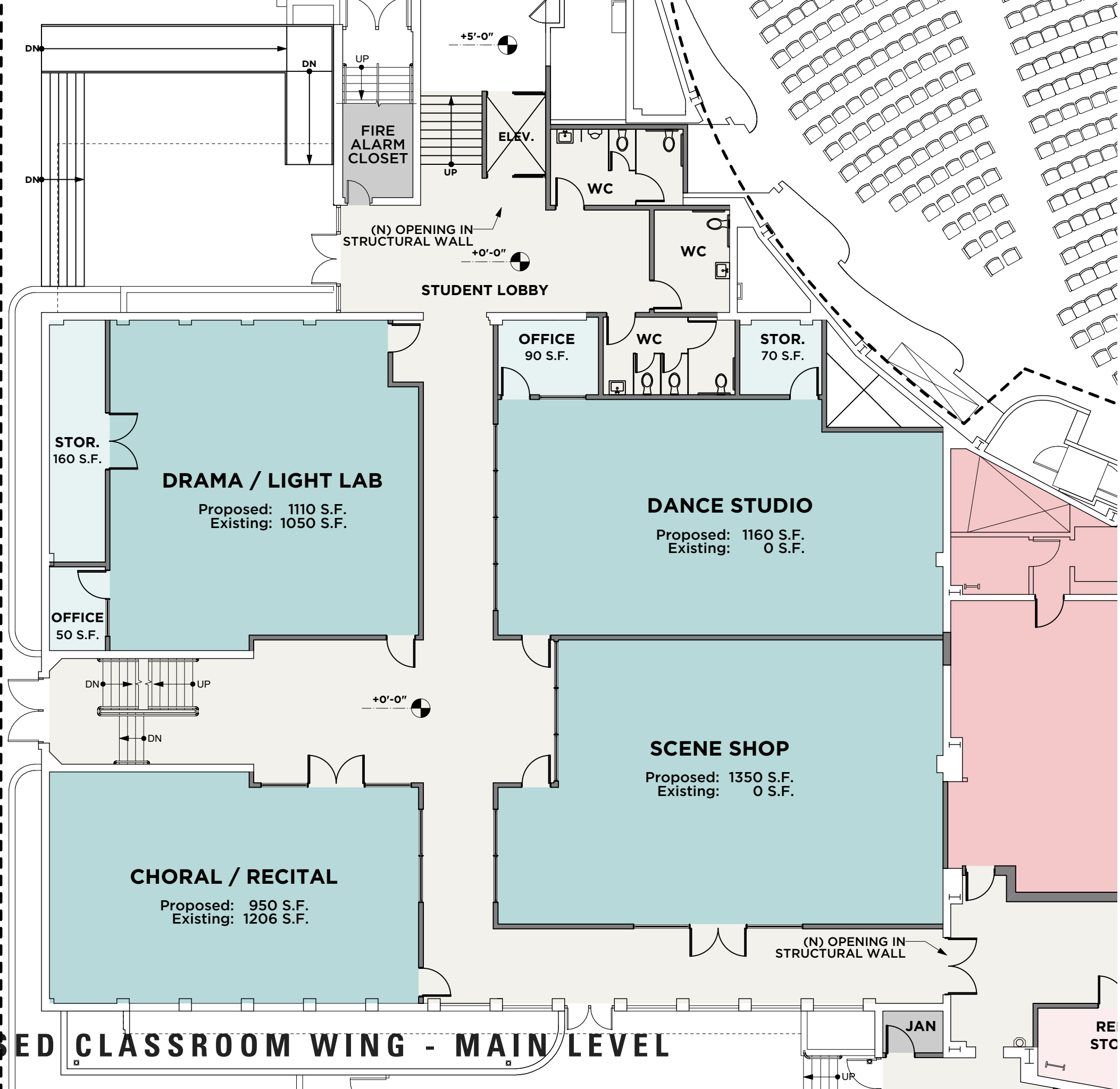

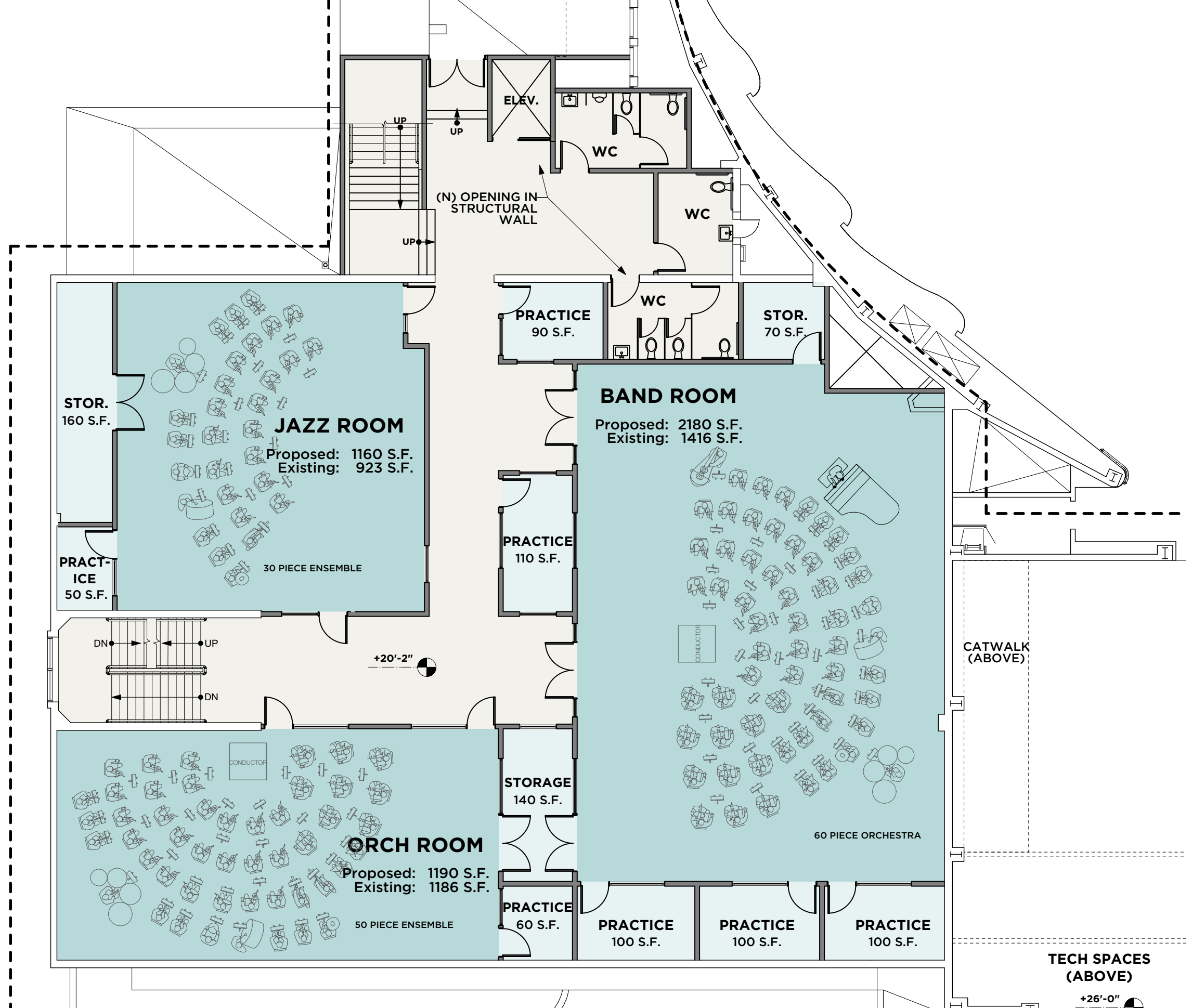

PROPOSED CLASSROOM WING - SECOND LEVEL

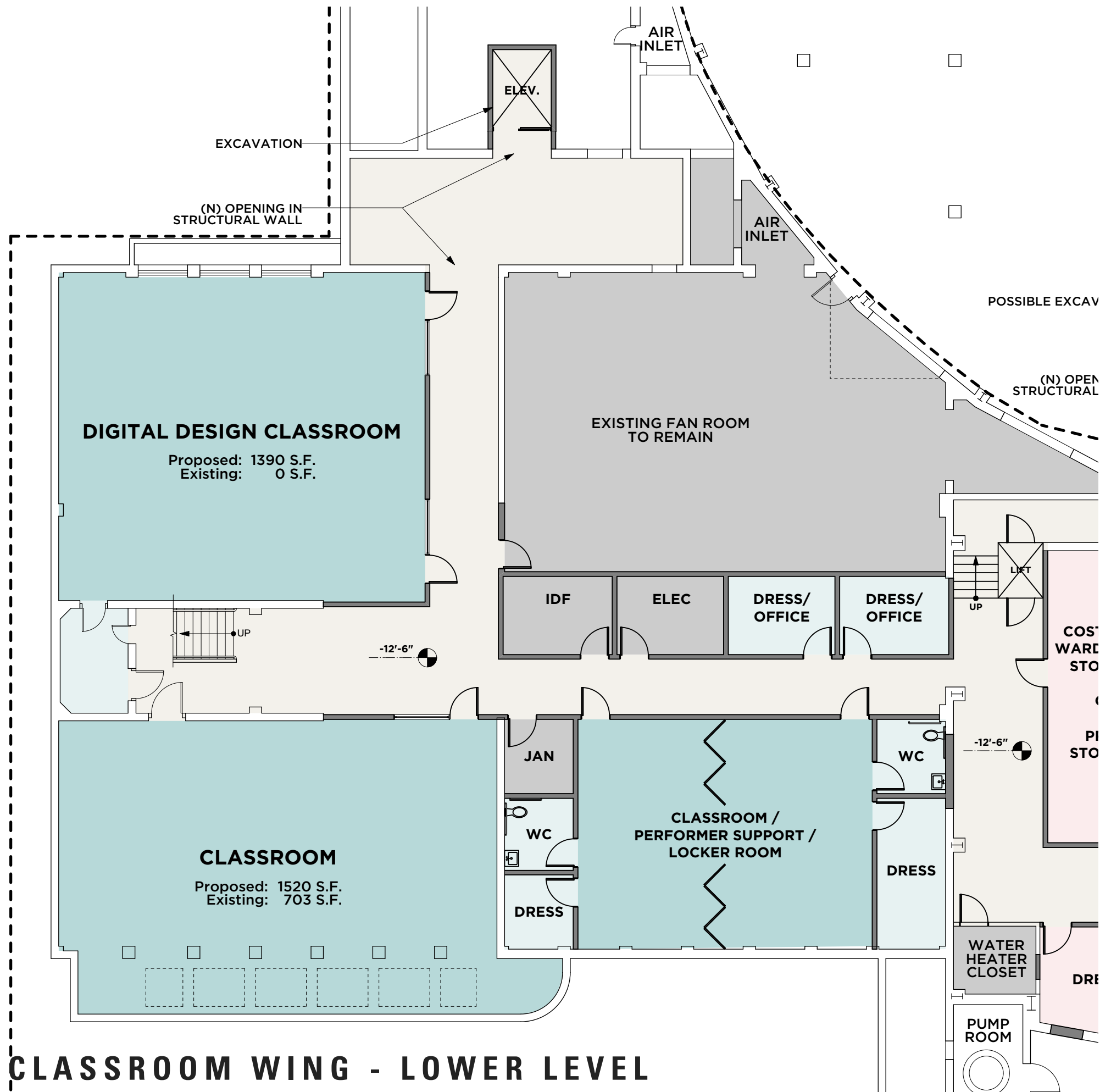

PROPOSED CLASSROOM WING - LOWER LEVEL

BCT STAGE & LOWER LEVEL



BERKELEY HIGH SCHOOL THEATER

EXISTING PLAN - MAIN LEVEL

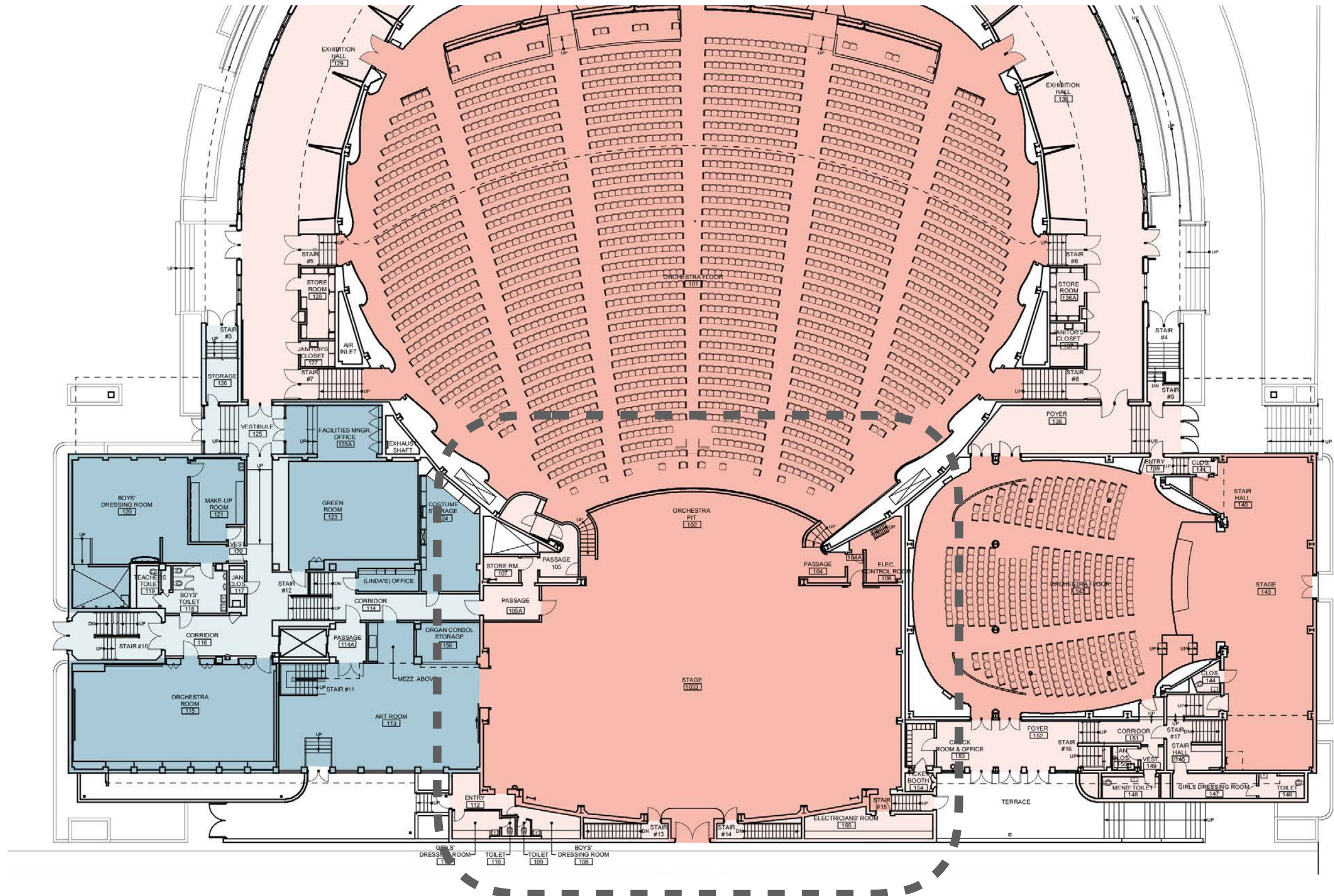

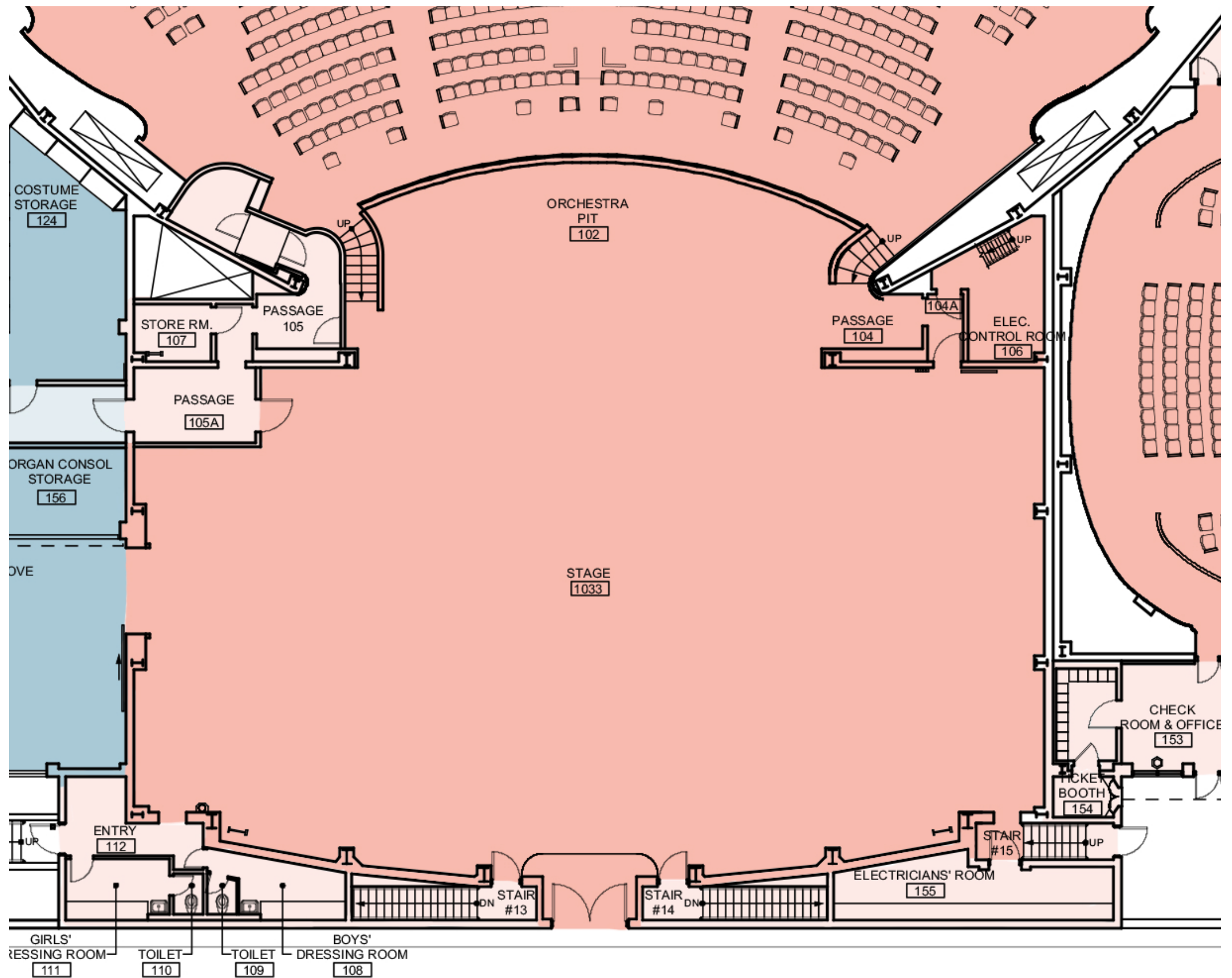

EXISTING STAGE BOX - MAIN LEVEL

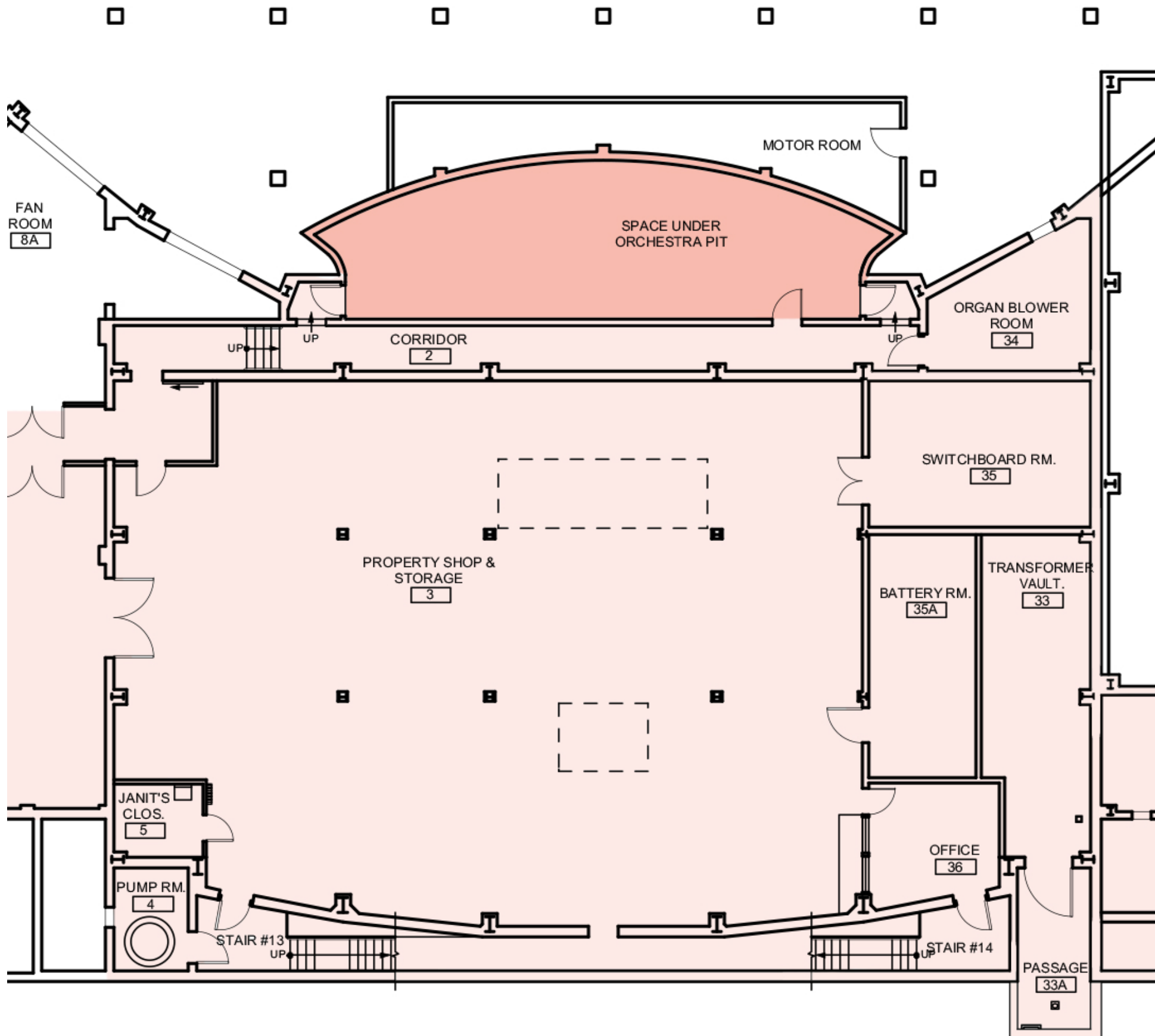

EXISTING STAGE BOX - LOWER LEVEL

BERKELEY HIGH SCHOOL THEATER

BCT STAGE & LOWER LEVEL

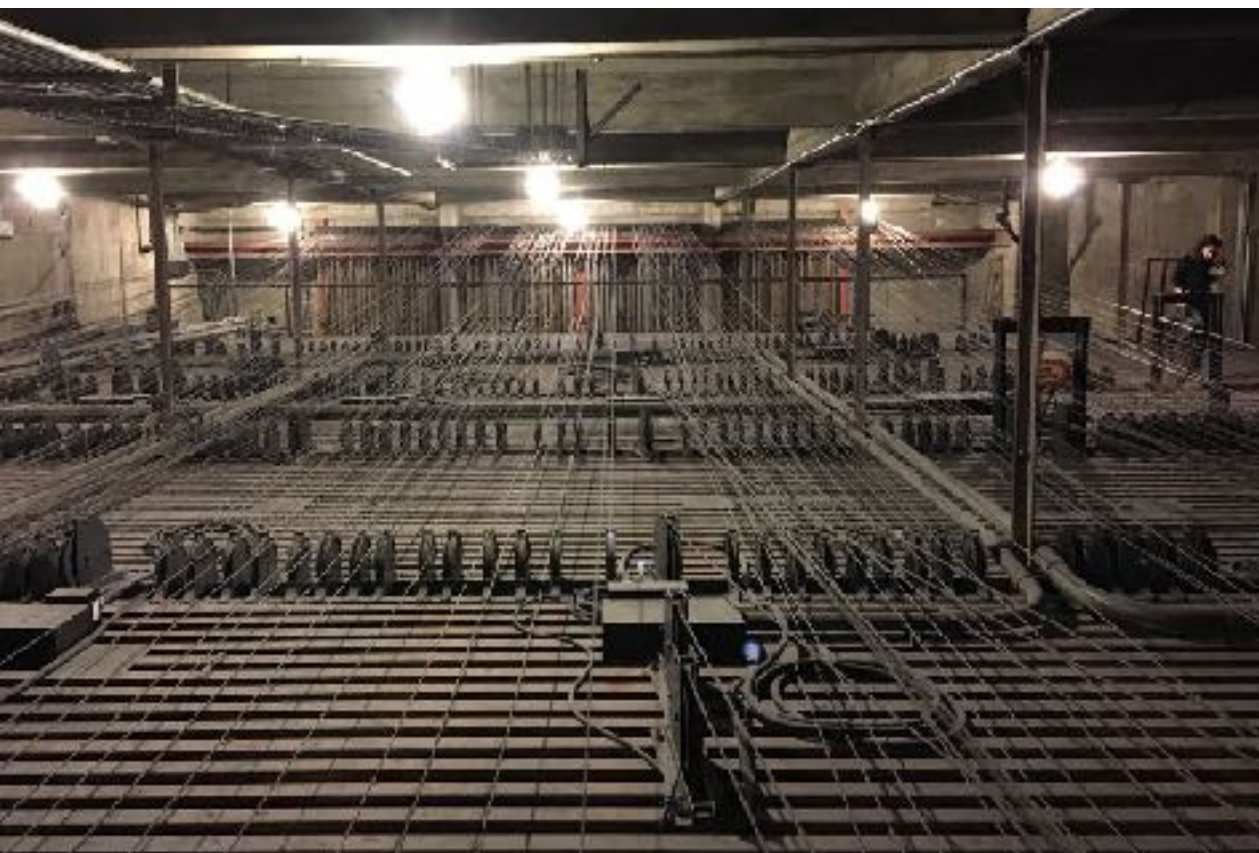

BERKELEY HIGH SCHOOL THEATER

PROPOSED PHASE 1 - MAIN LEVEL

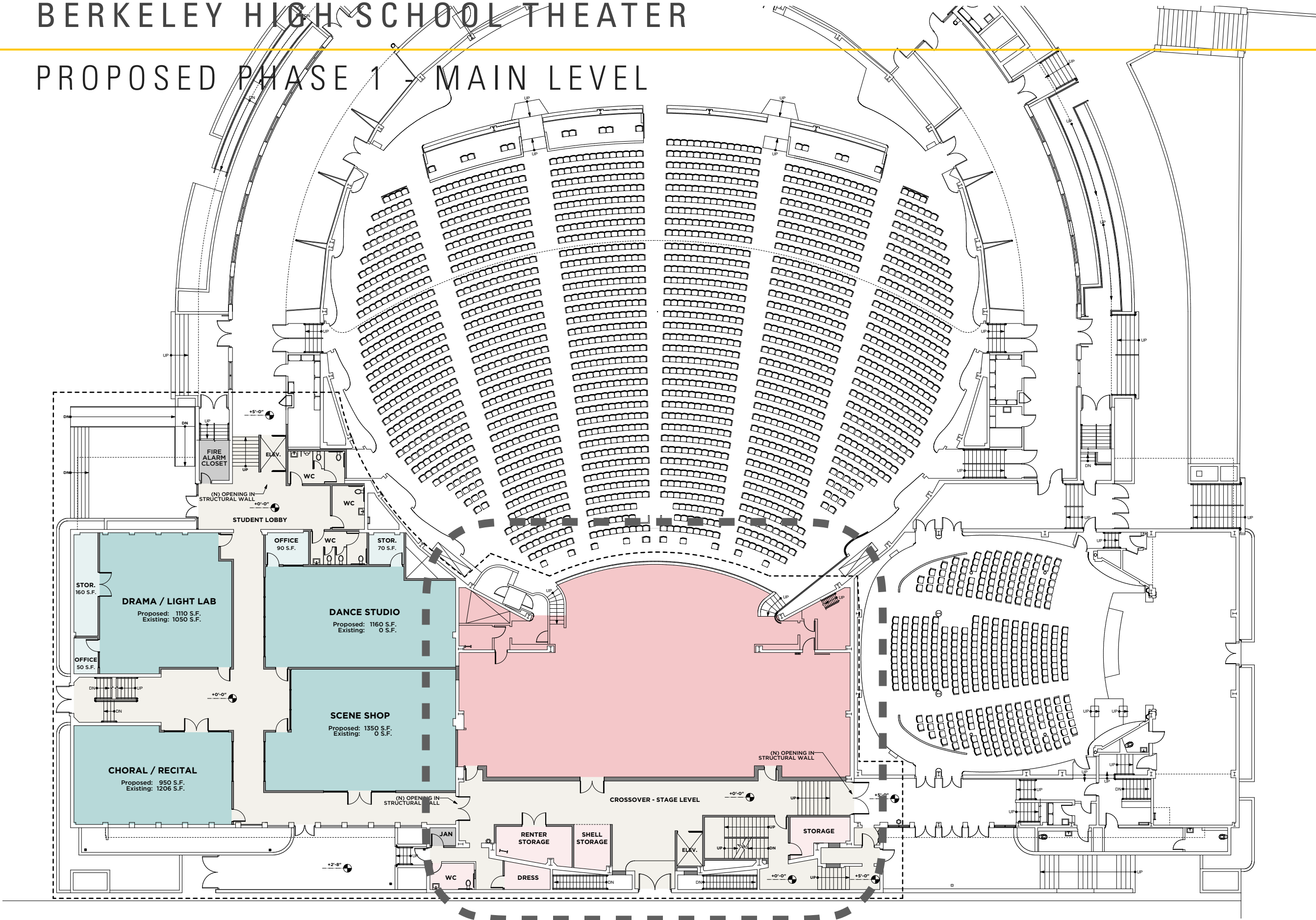

MAIN LEVEL PLAN - SCHEME A - CLASSROOM WING + CROSSOVER

SCALE: 1/8" = 1'-0"

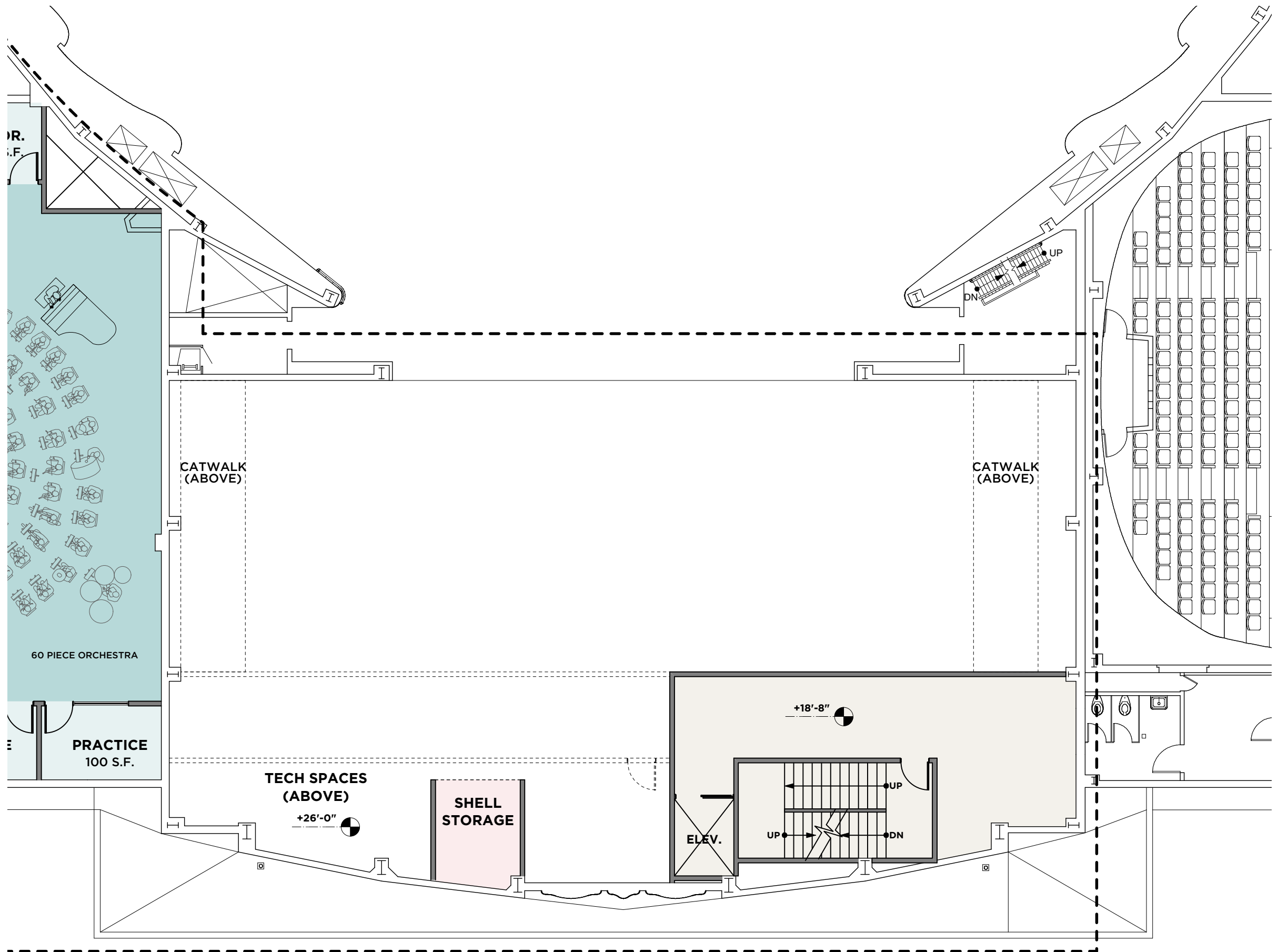

PROPOSED STAGE BOX - SECOND LEVEL

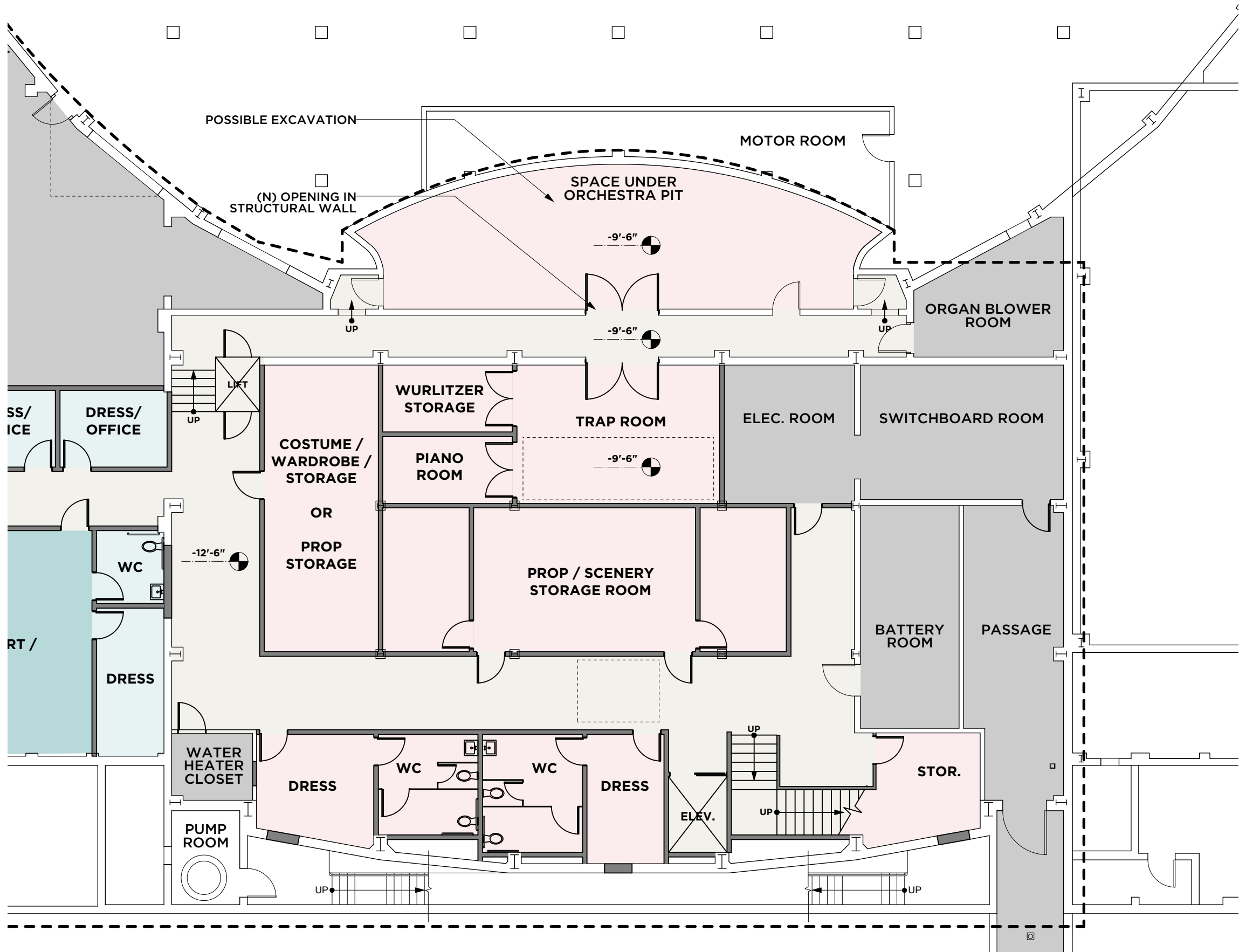

PROPOSED STAGE BOX - LOWER LEVEL

BERKELEY HIGH SCHOOL THEATER

PROPOSED PHASE 1 - CLASSROOM AREAS

SPACE	EXISTING AREA (S.F.)	PROPOSED AREA (S.F.)
DRAMA CLASSROOM	1050	1110
CHORAL ROOM	1206	950
JAZZ ROOM	923	1160
BAND ROOM	1416	2180
ORCHESTRA ROOM	1186	1190
ART CLASSROOM	1946 (including storage mezzanine)	0
SCENE SHOP	0	1350
PRACTICE ROOMS	1 Small - 125 10 Individual - 645 total	5 Small - 500 total 2 Individual - 110 total
DANCE STUDIO (CURRENTLY STAGE)	5000	1160
ADDITIONAL CLASSROOM	703 (existing Fire Education Classroom)	1520
DIGITAL DESIGN CLASSROOM	0	1390

BERKELEY HIGH SCHOOL THEATER

STRUCTURAL ANALYSIS

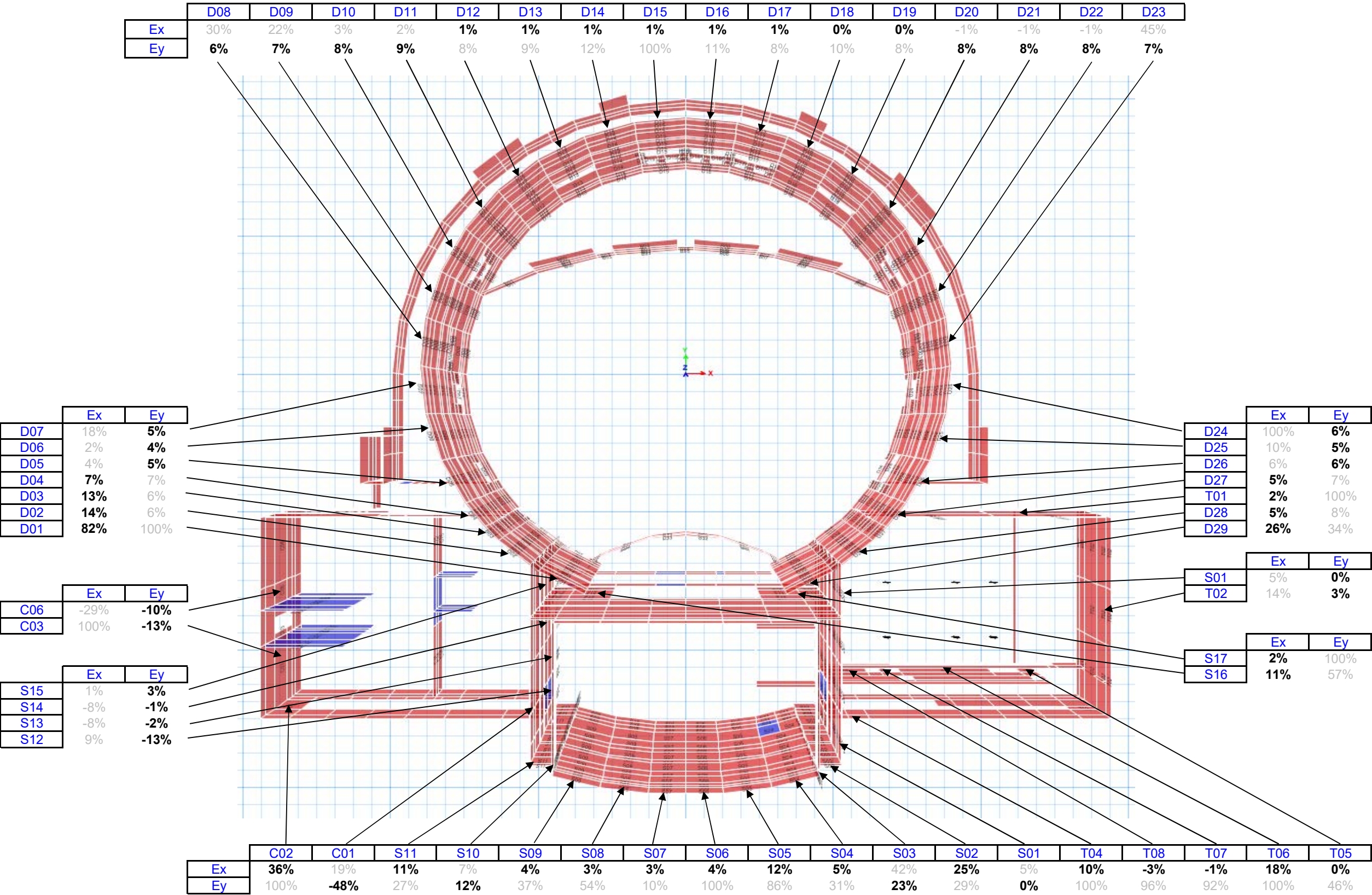

BERKELEY HIGH SCHOOL THEATER

STRUCTURAL ANALYSIS

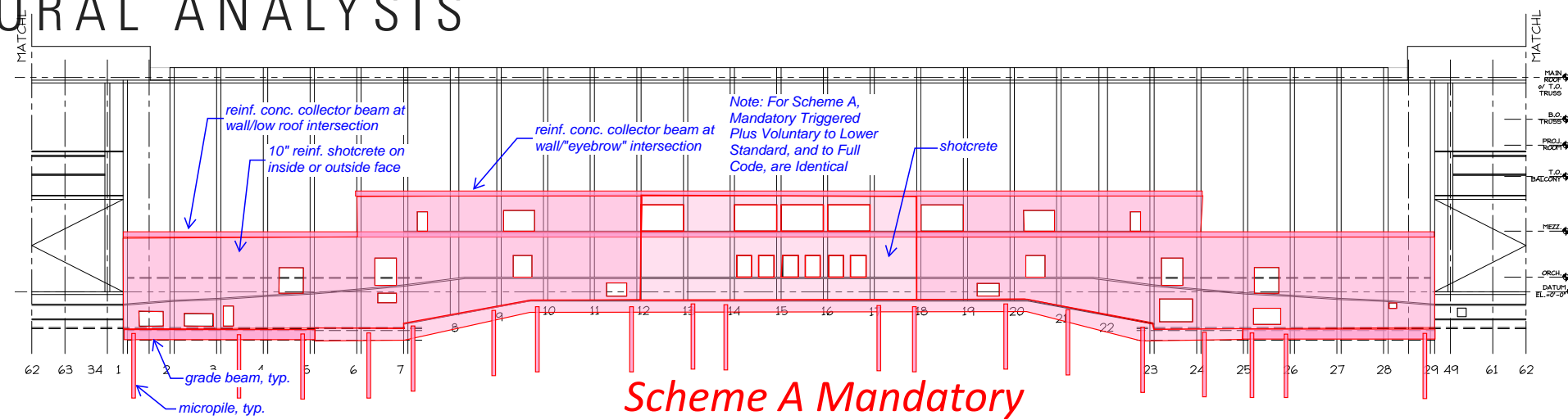

*Scheme A Mandatory
Triggered Plus Voluntary
to Full Code*

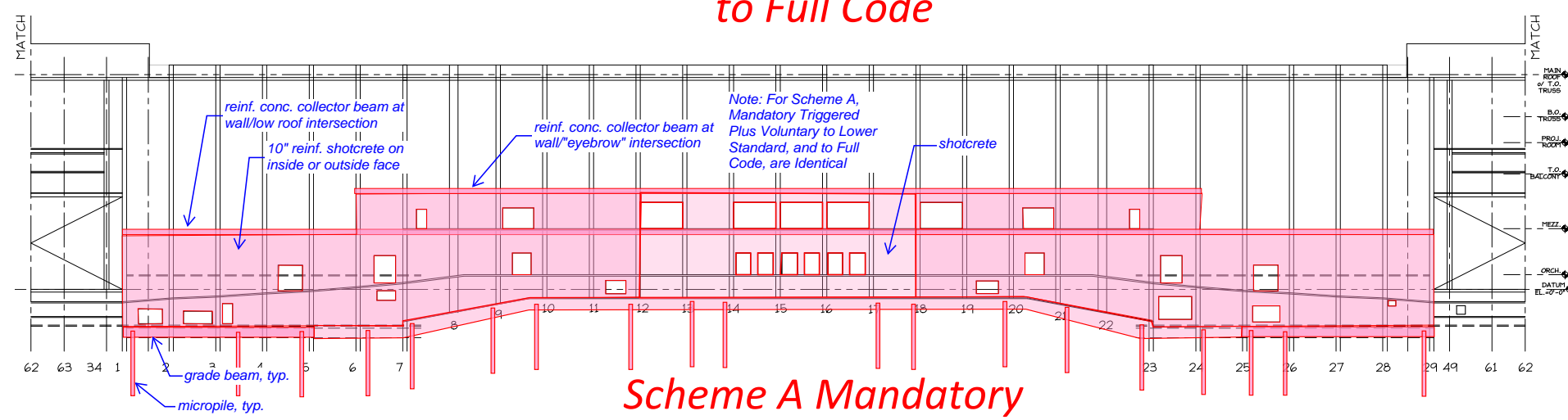

*Scheme A Mandatory
Triggered Plus Voluntary
to Lower Standard*

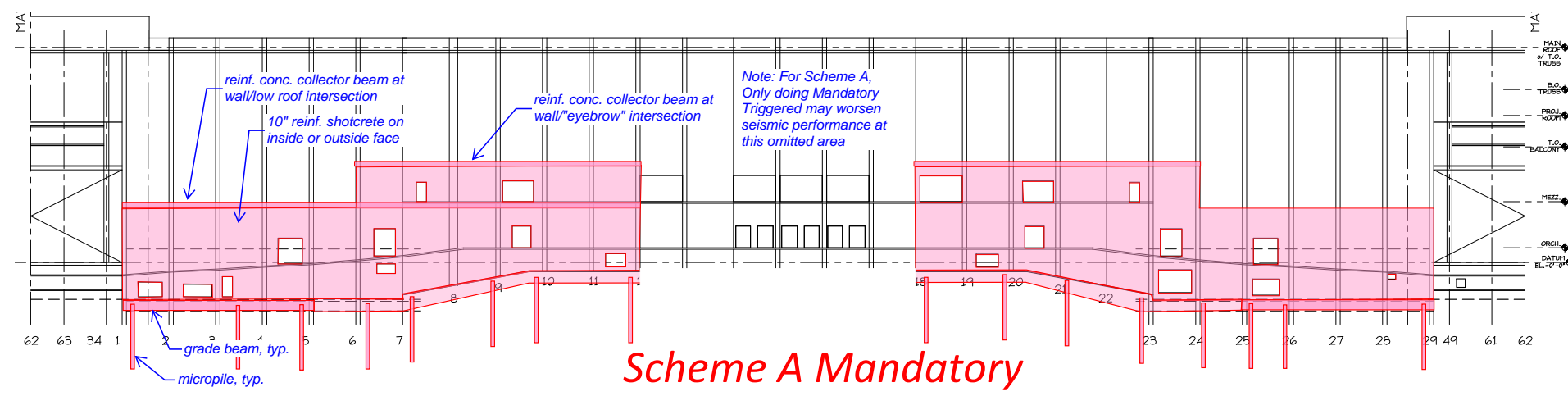

*Scheme A Mandatory
Triggered Only*

BERKELEY HIGH SCHOOL THEATER

ISSUES AND OPPORTUNITIES

POTENTIAL SCOPE OUTSIDE BOUNDARY

- ADD FIRE SPRINKLERS TO MAIN AUDITORIUM
- EXTENT OF SEISMIC UPGRADES AT CONCRETE DRUM AND LITTLE THEATER
- ADA ACCESS TO FRONT ROW OF BCT SEATING

ALTERNATE FUNDING?

- STATE SEISMIC MITIGATION FUNDING

BERKELEY HIGH SCHOOL THEATER

NEXT STEPS

- **FINALIZE COST ESTIMATE & BUDGET**
- **SEEK APPROVAL TO BEGIN DESIGN**



LITTLE THEATER MASTER PLAN

NOT IN SCOPE



BERKELEY HIGH SCHOOL THEATER

PROPOSED MASTER PLAN - MAIN LEVEL

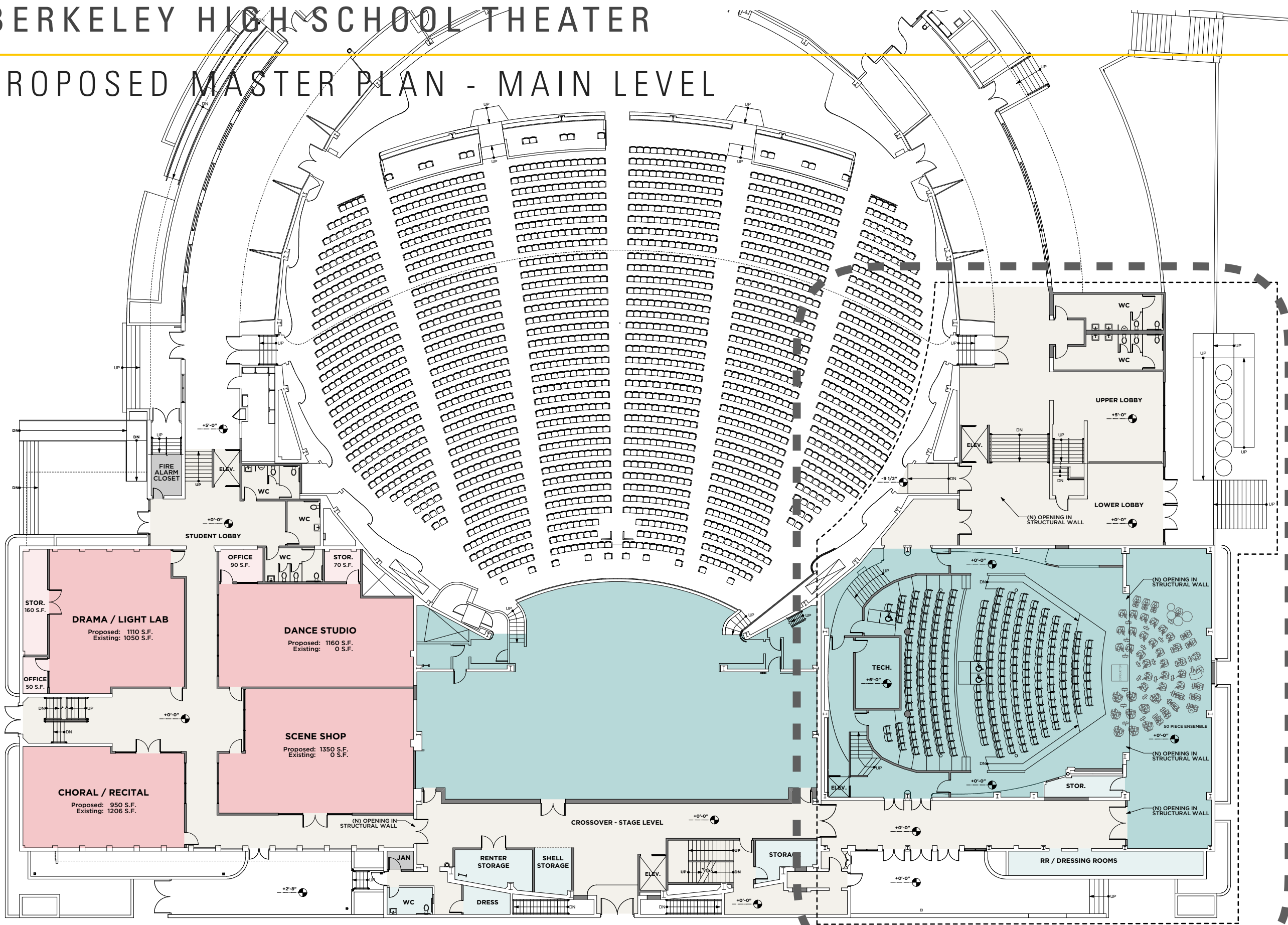

MAIN LEVEL PLAN - LITTLE THEATER
SCALE: 1/8" = 1'-0"

PROPOSED LITTLE THEATER - MAIN LEVEL

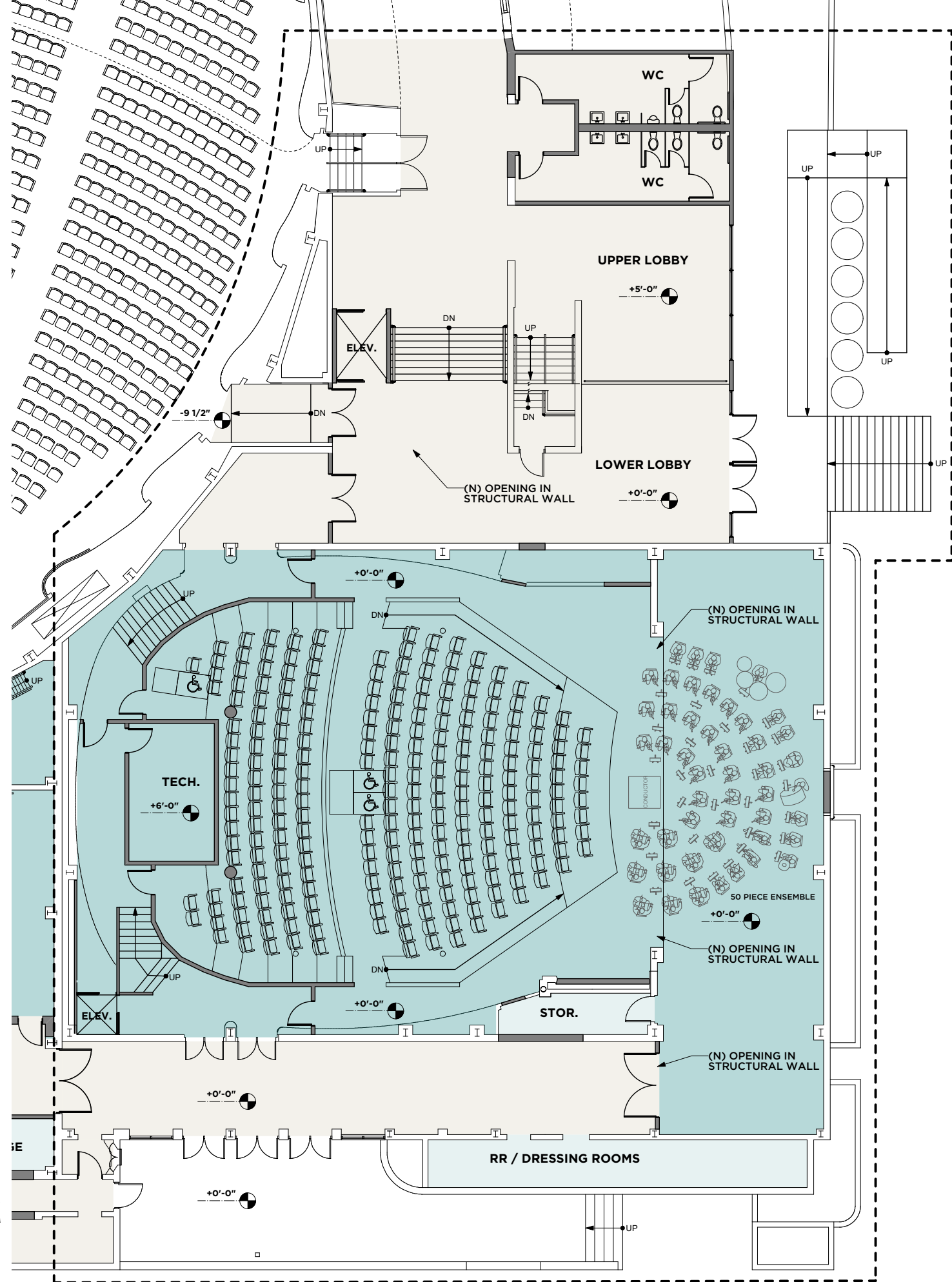

**PROPOSED LITTLE THEATER
- MAIN LEVEL**

