

Gilroy, CA

Gilroy USD Grant Funded Inclusive Playground Project



Playground Equipment Proposal

David Yosso & Chris Olsen

July 31, 2020

CLSB # 1050307

DIR # 1000064237

Table of Contents

El Roble Design info	3
El Roble Quote	14
Glen View Design Info	17
Glen View Quote	28
Rod Kelley Design Info	31
Rod Kelley Quote	42
SPEC Company Info	45
SPEC Guarantee	48
References/Testimonials	49
Manufacturer Info	51
Warranty	56
Color Chart	57
Next Steps	58

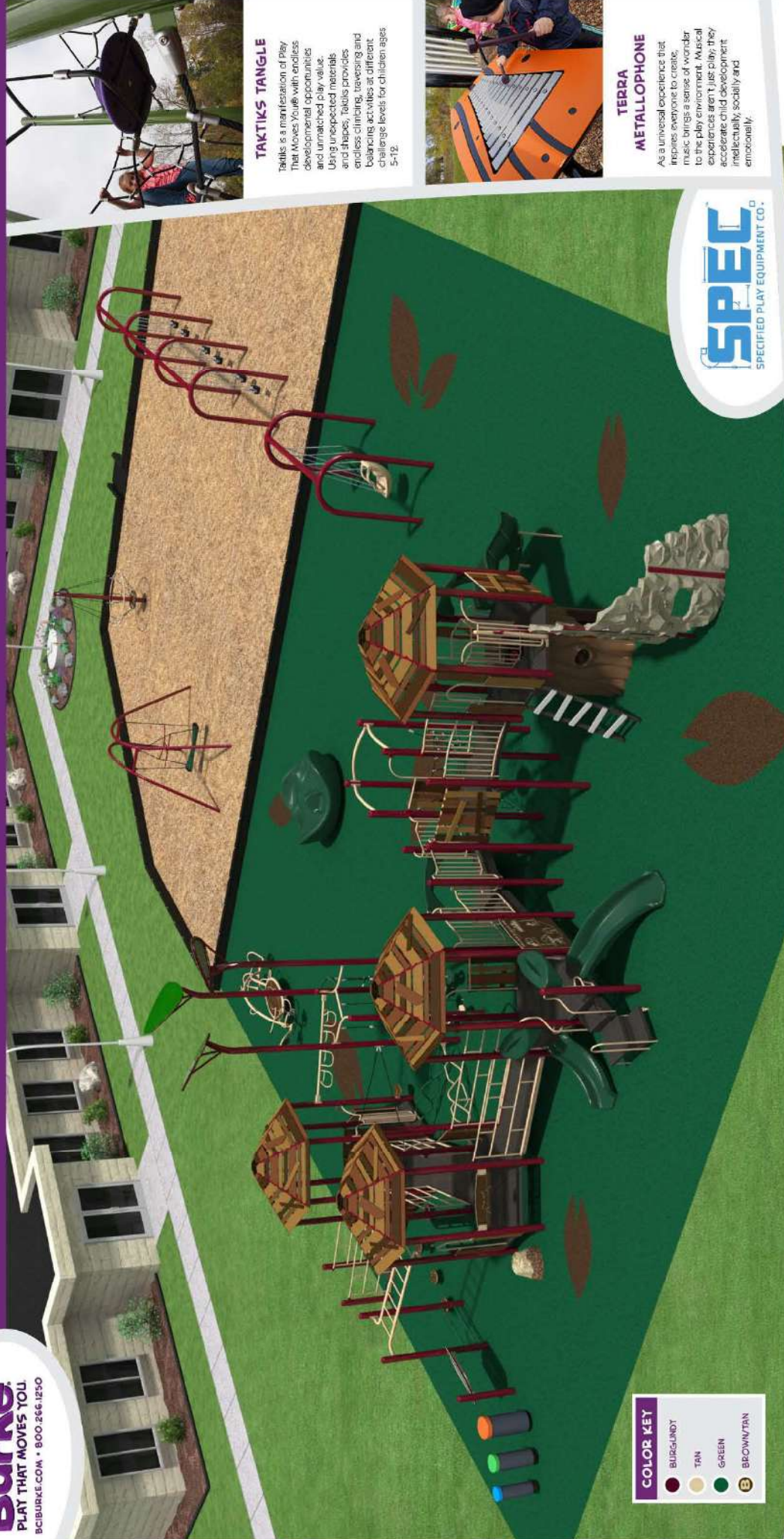

COLOR KEY	
●	BURGUNDY
●	TAN
●	GREEN
●	BROWN/TAN

TAKTIKS TANGLE

Taktiks is a manifestation of play that Moves You® with endless developmental opportunities and unmatched play value. Using unexpected materials and shapes, Taktiks provides endless climbing, traversing and balancing activities at different challenge levels for children ages 5-12.



TERRA METALLOPHONE

As a universal experience that inspires everyone to create, music brings a sense of wonder to the play environment. Musical experiences aren't just play; they accelerate child development intellectually, socially and emotionally.



ORB® ROCKER

With four traditional seats and room for four more in the center, the Orb Rocker's unique design and exciting rocking motion invites everyone into the fun. Caregivers and children will love the ease of access with side openings for users of all sizes.



FREEDOM SWING

The Freedom Swing brings the joy of swinging to children of all abilities. With a locked-in harness and comfort-designed seat, the Freedom Swing can be paired with standard swings to create a space everyone can enjoy.



CLIMBING

Climbing brings adventure and challenge to the playground while providing necessary developmental benefits such as balance, agility, upper and lower body strength and decision-making skills! When children climb, they develop confidence and take age-appropriate risks that help build skills that will help them throughout their lives.



COGNITIVE

So many life skills are learned through play! Skills such as cognitive planning, mastering new concepts, problem solving and expression are developed naturally through play events like climbing, sliding and spinning.







FEATURED PLAY EVENTS



Viper Slide

The Viper Slide can't be tamed, but kids love trying! Viper's exciting twisty and fast serpentine action is guaranteed to generate incredible high-energy fun and safe, healthy play.



RockIt Left 72

RockIt creates the thrill, excitement and challenge of rock climbing in a realistic, yet safe, playground environment. Kids love a challenge, and RockIt challenges them with options to go around, through or over the mountain!



ROBUST ROCKER

Overhead events build upper body strength and endurance, improve eye-hand coordination and elevate children's self-confidence.



Mini Arch Bridge

Bridges appeal to kids' imagination and urge to explore while playing on the playground.

FEATURED PLAY EVENTS

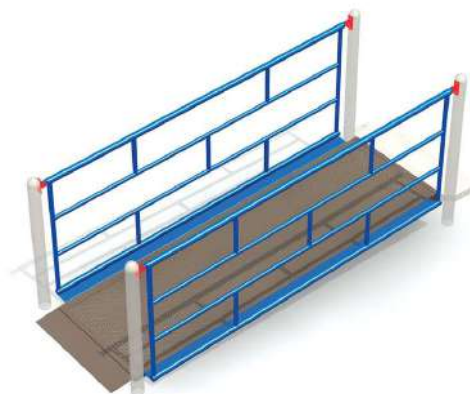

ADAAG Ramp

Ramps and stairs build lower body strength and improve kids' coordination.



3-In-A-Row Panel

Play panels offer opportunities for all children to develop skills, have fun and spend time learning outside. 3-In-A-Row is a way to bring games to the playground and teach cooperation.



Clubhouse Hex Roof

The ClubHouse design offers kids and families the opportunity to reconnect and rediscover the wonders of nature within a safe and durable environment. A full collection of ClubHouse components, including climbers, panels, enclosures and roofs, cultivate imaginations and nurture the need for play.



AirVenture Glider

Children will need to work together to get and keep the AirVenture Glider moving! While gliding, they will be working their upper and lower bodies and their core developing strength and balance. Where fun and development collide, AirVenture begins.

DESIGN SUMMARY

Specified Play Equipment Company is very pleased to present this proposal for consideration for the El Roble located in Gilroy. BCI Burke Company, LLC has been providing recreational playground equipment for over 90 years and has developed the right mix of world-class capabilities to meet the initial and continuing needs of Gilroy Unified School District. We believe our proposal will meet or exceed your project's requirements and will deliver the greatest value to you.

The following is a summary of some of the key elements of our proposal:

- Project Name: El Roble
- Project Number: 137-118263-4
- User Capacity: 224
- Age Groups: Ages 5-12 years
- Dimensions: 69' 2" x 122' 6"
- Designer Name: Pa Der Vang

Specified Play Equipment Company has developed a custom playground configuration based on the requirements as they have been presented for the El Roble playground project. Our custom design will provide a safe and affordable playground environment that is aesthetically pleasing, full of fun for all users and uniquely satisfies your specific requirements. In addition, proposal # 137-118263-4 has been designed with a focus on safety, and is fully compliant with ASTM F1487 and CPSC playground safety standards.

We invite you to review this proposal for the El Roble playground project and to contact us with any questions that you may have.

Thank you in advance for giving us the opportunity to make this project a success.

INFORMATION
MINIMUM FALL ZONE
SURFACED WITH
RESILIENT MATERIAL
AREA

5446 SQ.FT.

PERIMETER

804 FT.

STRUCTURE SIZE

69' 2" x 122' 6"

STRUCTURE IS DESIGNED
FOR CHILDREN AGES:

- ☐ 6-23 MONTH OLDS
☐ 2-5 YEAR OLDS
☒ 5-12 YEAR OLDS
☐ 13 + YEAR OLDS



To verify product certification,
visit www.ipema.org

The play components identified
in this plan are IPEMA
certified. The use and layout of
these components conform to the
requirements of ASTM F1487.
To verify product certification,
visit www.ipema.org

The space requirements shown
here are to ASTM standards.
Requirements for other standards
may be different.

The use and layout of play
components identified in this plan
conform to the CPSC guidelines.
U.S. CPSC recommends the
separation of age groups in
playground layouts.

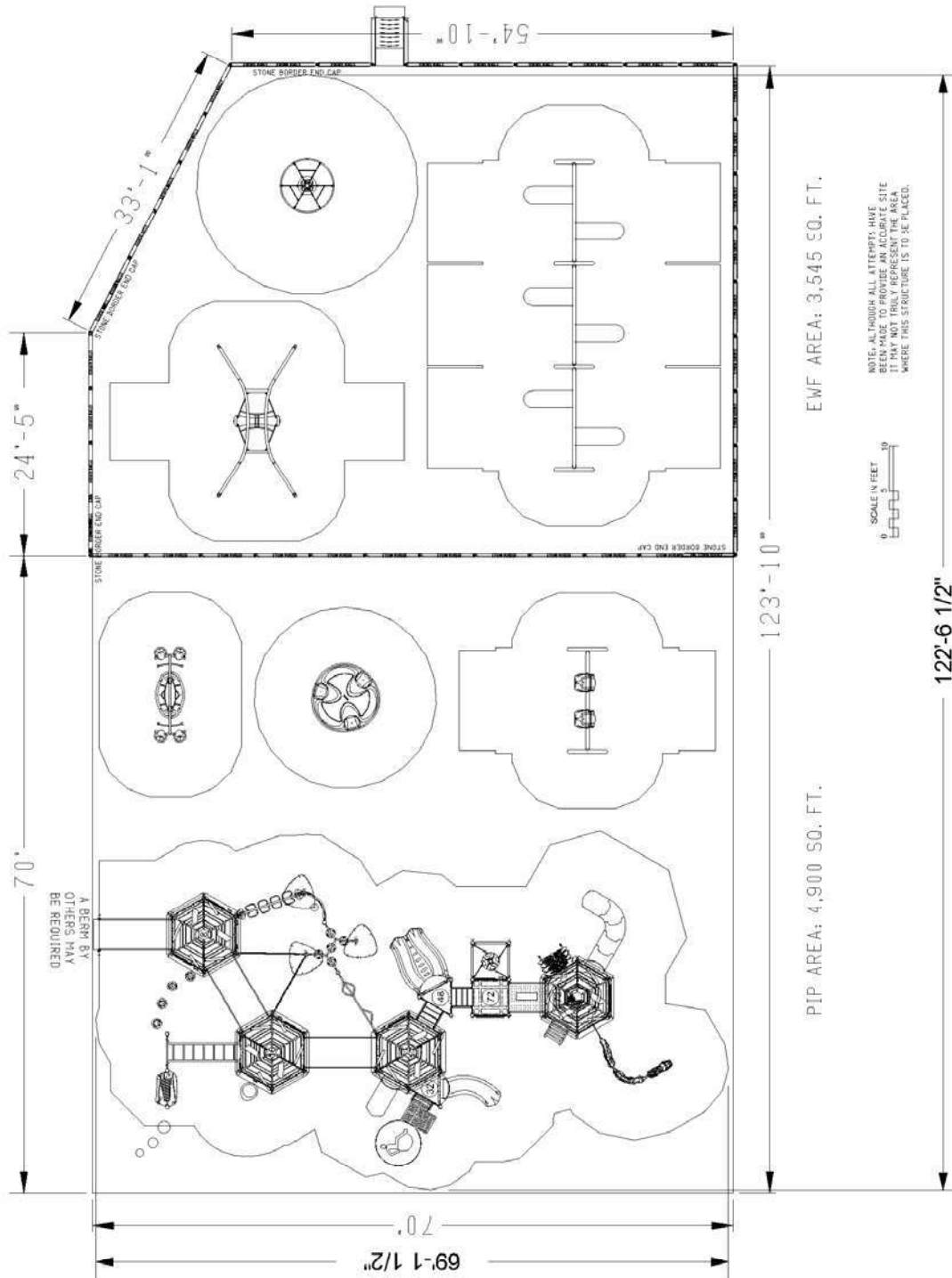

WARNING!

ACCESSIBLE SAFETY SURFACING MATERIAL IS REQUIRED BENEATH
AND AROUND THIS EQUIPMENT.

FOR SLIDE FALL ZONE SURFACING AREA SEE CPSC's Handbook for
Public Playground Safety.

PLATFORM HEIGHTS ARE IN INCHES ABOVE RESILIENT MATERIAL.

ADA ACCESSIBILITY GUIDELINE (ADAAG CONFORMANCE)

NUMBER OF PLAY EVENTS	39
NUMBER OF ELEVATED PLAY EVENTS	14
NUMBER OF ELEVATED PLAY EVENTS ACCESSIBLE BY RAMP	PROVIDED: 6
NUMBER OF ELEVATED PLAY EVENTS ACCESSIBLE BY TRANSFER SYSTEM	PROVIDED: 14
NUMBER OF ELEVATED PLAY EVENTS ACCESSIBLE BY RAMP OR TRANSFER SYSTEM	PROVIDED: 25
NUMBER OF GROUND LEVEL PLAY EVENTS	PROVIDED: 8
NUMBER OF TYPES OF GROUND LEVEL PLAY EVENTS	PROVIDED: 3

Burke

SERIES: Basics, Intensity, Nucleus

SITE PLAN

DRAWN BY: Pa Der Vang

El Roble

930 3rd St.

Gilroy, CA 95020

Specified Play Equipment Company

137-118263-4

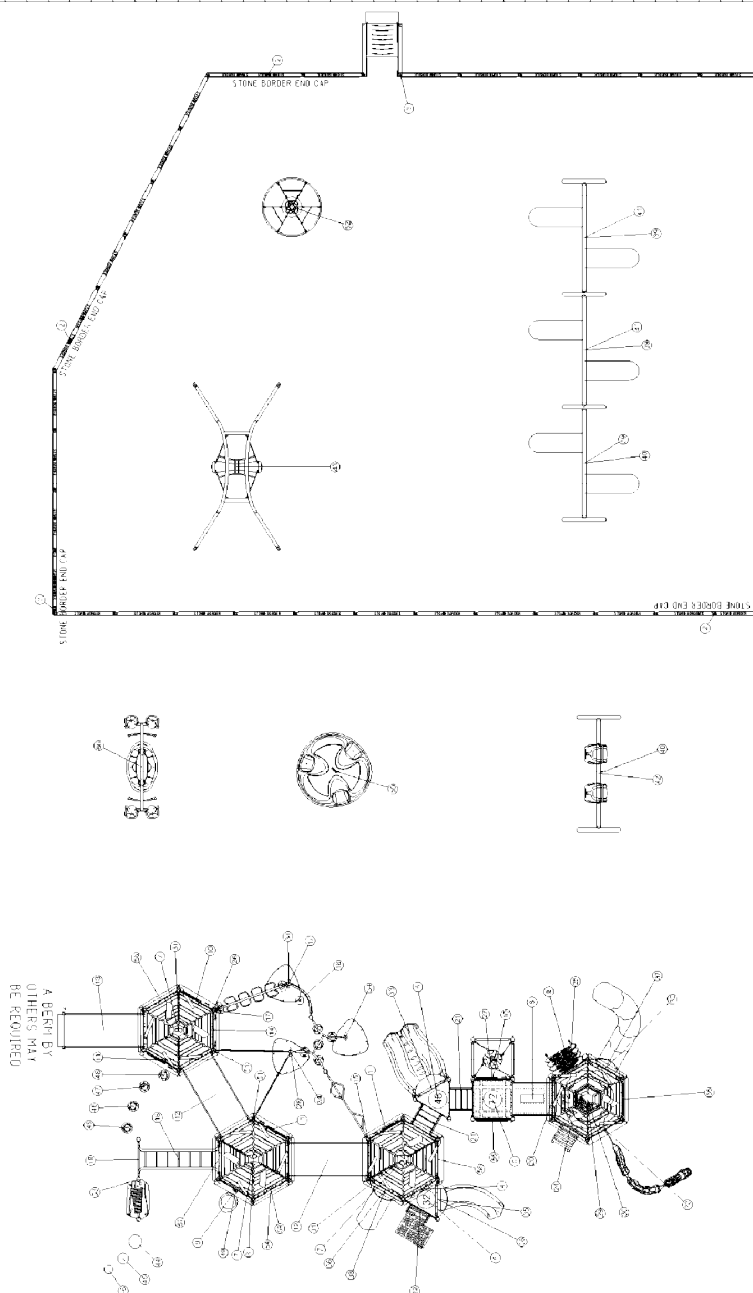

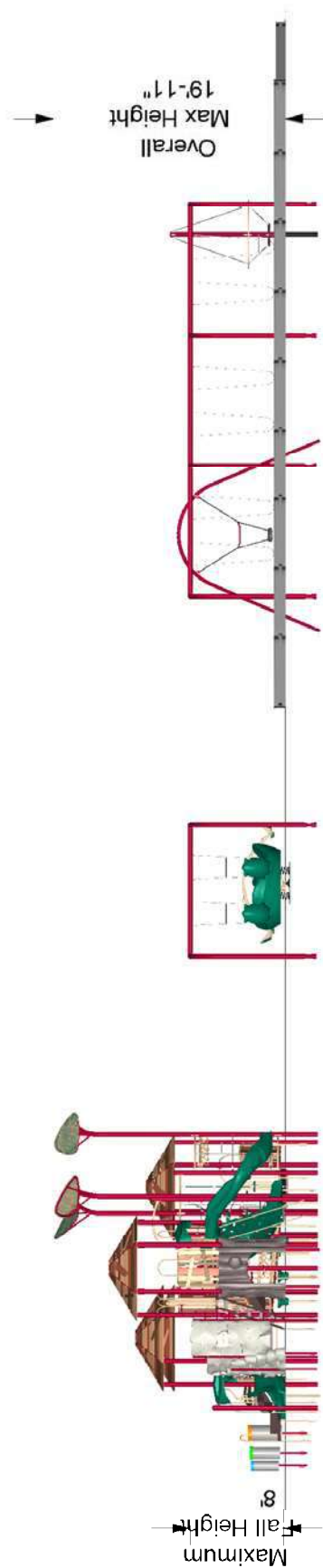

The protective surfacing for this design must accommodate the critical fall height.

Burke

July 29, 2020

SERIES: Basics, Intensity, Nucleus

El Roble

Specified Play Equipment Company

ELEVATION PLAN

930 3rd St.

137-118263-4

DRAWN BY: Pa Der Vang

Gilroy, CA 95020

BCI Burke Company, LLC PO Box 549 Fond du Lac, Wisconsin 54936-0549 Telephone 920-921-9220

Page 69

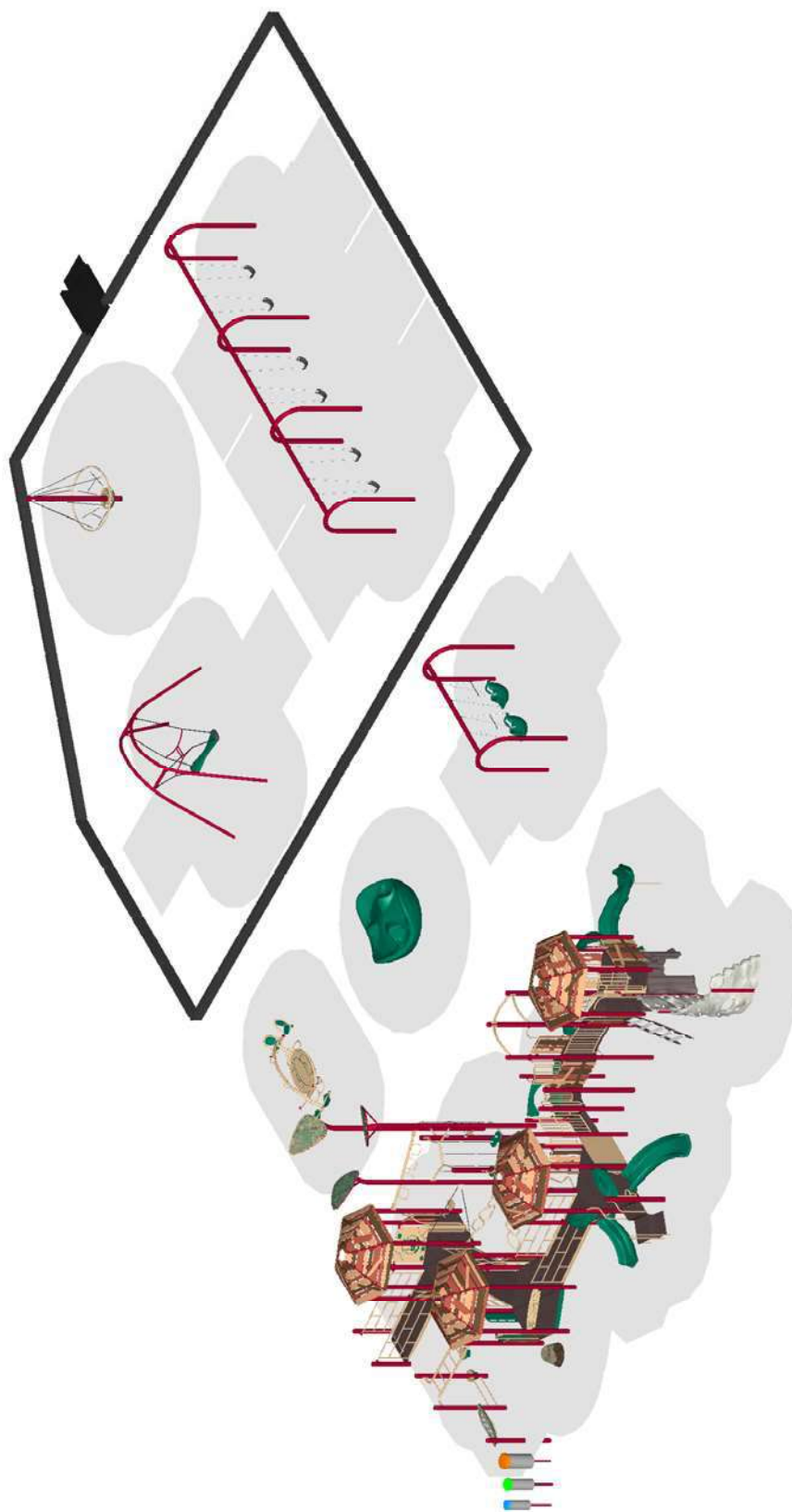

Burke

July 29, 2020

SERIES: Basics, Intensity, Nucleus

ISOMETRIC PLAN

DRAWN BY: Pa Der Vang

El Roble

930 3rd St.

Gilroy, CA 95020

Specified Play Equipment Company

137-118263-4

Specified Play Equipment Co.

121 #1 Industrial Road
 Belmont, CA 94002
 800.475.1071
 www.specplay.com

**ADDRESS**

Paul Nadeau
 Gilroy Unified School District
 7810 Arroyo Circle,
 Gilroy, CA 95020

SHIP TO

Paul Nadeau
 Gilroy Unified School District
 Corp Yard
 Gilroy, CA 95020

Estimate 1832**DATE 07/31/2020****EXPIRATION DATE 10/31/2020****TRACKING NO.**

El Roble 137-118263-4

CSLB# 1050307

-

DIR# 1000064237

-

ACTIVITY	QTY	RATE	AMOUNT
BCI Burke Equipment Burke equipment per plan #137-118263-4	1	124,549.00	124,549.00T
Design Development Design, drafting, fabrication, production and shop drawings.	1	54,124.00	54,124.00
Site Work Demo of Timbers 379 LF	1	3,065.00	3,065.00
Site Work Removal of EWF from 70x70 area to be loaded into district trucks for disposal/re-use at corp yard.	1	10,688.00	10,688.00
Demolition Demo existing play structures	1	6,185.00	6,185.00
Site Work Excavate Soil to 8" depth-4900 SF, 122 c/y, remove and dispose dirt at District Corp yard	1	26,688.00	26,688.00
Site Work Concrete Curb for pour in place perimeter containment	1	16,419.00	16,419.00
Site Work Supply and install compacted base rock 4" depth over 4900 sf for rubber surfacing subbase	1	13,659.00	13,659.00

Please write checks to SPEC
 121 #1 Industrial Road
 Belmont, CA 94002

ACTIVITY	QTY	RATE	AMOUNT
Installation Service Installation of equipment per plan 137-118263-4 to manufacturer's specifications. To include replacing plastic borders in EWF area, factory certified installers. Prevailing wages	1	69,677.00	69,677.00
Protective Safety Surfacing Installation Pour in place rubber surfacing for 8' critical fall height -4900 SF @ 3.5" depth. Black and Green with waves of lighter green and brown, mix with black.	1	86,975.00	86,975.00
Field Inspection 3rd Party CPSI Inspection	1	900.00	900.00
Temporary Fencing Security Fence for duration of project.	1	1,200.00	1,200.00
Receive and Offload Offload of Equipment at corp yard by installers	1	2,350.00	2,350.00
Freight Freight and packaging	1	14,700.00	14,700.00
PLEASE NOTE: • Permits, if required, are the responsibility of the owner • Engineered drawings not included. Quote available upon request. • Bonding not included, but can be quoted upon request. • Location of underground utility conflicts required prior to installation, quote available upon request for 3rd party locator. • EWF in EWF areas to be re-used • EWF removed from sites to be loaded in district trucks for disposal/re-use at corp yard. • SPEC Turnkey Guarantee included			

By signing below you acknowledge and agree to our Contract. The values shown above represent a specific scope; no other work should be assumed unless specifically noted in the text of the above line items. Unless otherwise specified we Exclude Responsibility for: offloading equipment, removal of packaging, project security, landscape & hardscape repair, delays due to conflicts, removal of spoils, locating underground; utilities, pipes, obstructions, conditions unforeseen and/or not disclosed at time of estimate, permits, engineering, soil samples. We are experienced with State & Federal prevailing wage and certified payroll requirements from DIR/DOL and will process when applicable. Union Agreements, including PLA's, are the

SUBTOTAL	431,179.00
TAX	11,209.41

Please write checks to SPEC

121 #1 Industrial Road
 Belmont, CA 94002

responsibility of others and not to be included in our contract.
Conditions: Grades; stable, compacted, & workable, (rough
grade to be taken + or - one tenth of one inch), adequate
access to work site provided for workmen, materials, tools, &
equipment

TOTAL**\$442,388.41**

Accepted By

Accepted Date

Please write checks to SPEC
121 #1 Industrial Road
Belmont, CA 94002



THEMED PLAY

Training your play space can bring children's imaginations to life! Studies show that imaginative play helps nurture a child's social, emotional and cognitive development.



RAMP SYSTEM

The ramp system winds around the playground from ground level up giving all children the opportunity to be in the best of the action. Accessible ramps allow children in wheelchairs to comfortably participate in multiple activities, while also developing fine motor skills.



FREEDOM SWING

The Freedom Swing brings the joy of swinging to children of all abilities. With a locked-in harness and a contoured designed seat, the Freedom Swing can be paired with standard swings to create a space everyone can enjoy.



SPINNING

Besides being just plain fun, spinning helps children develop spatial awareness, balance and coordination. Children on the autism spectrum often find the motion to be a relaxing, soothing activity that can rest them if they need time to themselves.



CLIMBING

Climbing brings adventure and challenge to the playground while providing necessary developmental benefits such as balance, agility, upper and lower body strength and decision-making skills. When children climb, they develop confidence and take age-appropriate risks that help build skills that will help them throughout their lives.



SOCIALIZATION

Children socialize and learn important skills such as empathy and communication through play. Providing a space where children of all abilities can play side by side is important for everyone.

SPEC
SPECIFIED PLAY EQUIPMENT CO.

COLOR KEY	
	SILVER
	AQUA
	WHITE
	BLUE
	GRAY
	BLUE/WHITE





GLEN VIEW ELEMENTARY

PROPOSAL #137-118743-B

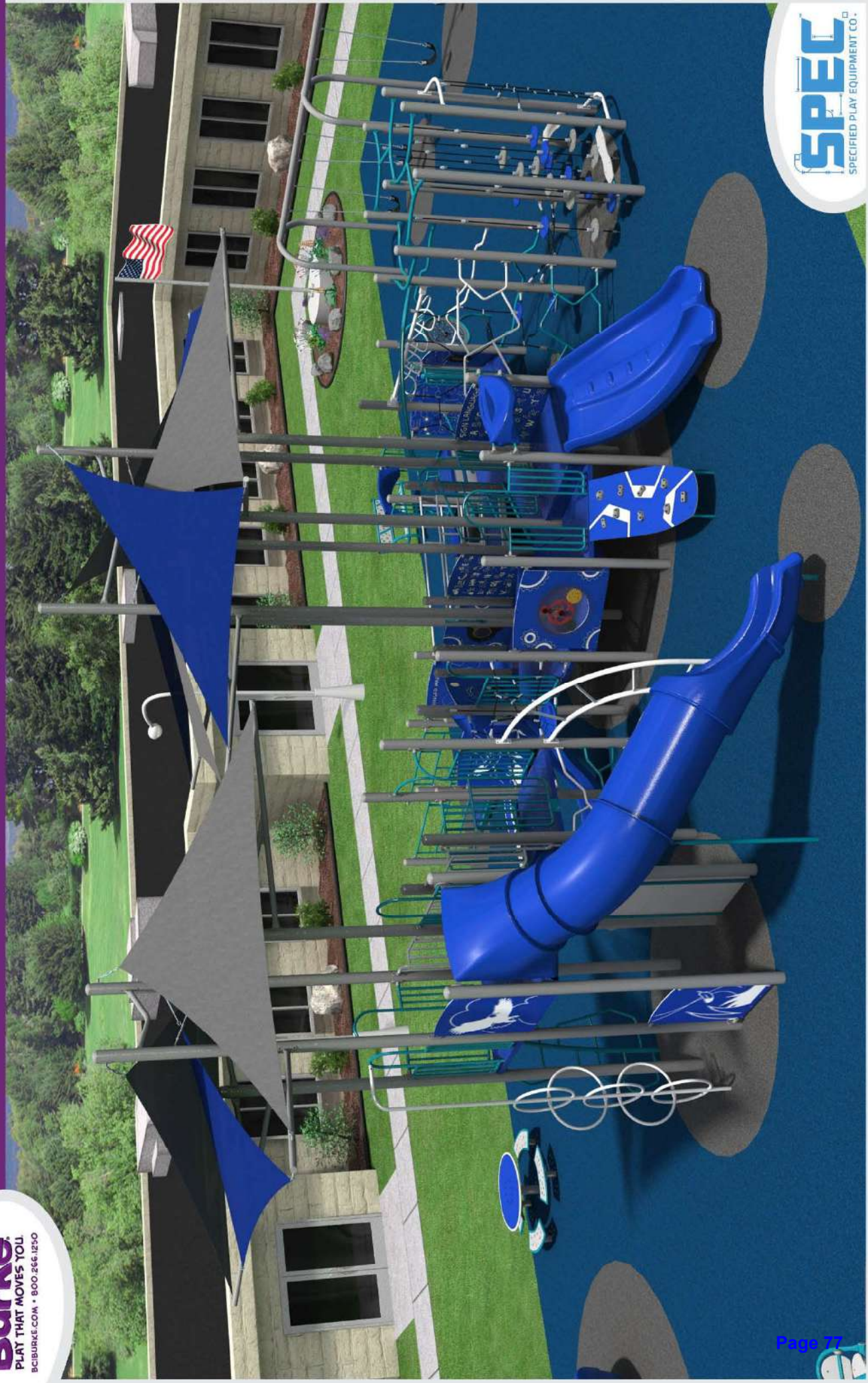

FEATURED PLAY EVENTS

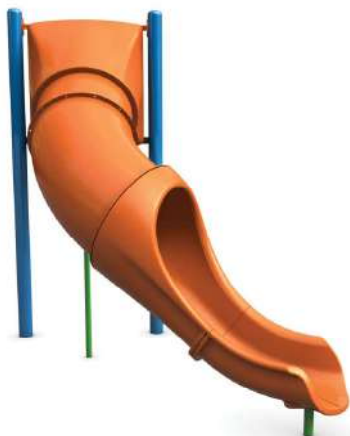

COBRA SLIDE® CURVED

Excitement can't be contained when it comes to COBRA SLIDES! They are twisting, turning, in and out of light and SO MUCH FUN! Fun aside, sliding has a variety of developmental benefits ranging from core strength and balance to taking turns and imagination.



PodStep Intensity

Full of challenge and fun, PodStep Climbers will move kids' bodies and minds as they climb up, down and around these moving pods.



ROBUST ROCKER

Overhead events build upper body strength and endurance, improve eye-hand coordination and elevate children's self-confidence.

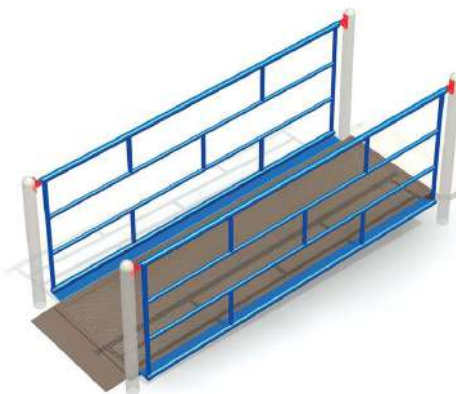

ADAAG Ramp

Ramps and stairs build lower body strength and improve kids' coordination.

FEATURED PLAY EVENTS



COG WHEEL PANEL

Interactive play events provide opportunities for social interaction while increasing coordination and adding additional sensory stimulation to the playground.



Ara Hex Shade

The Ara Shade System provides protection from the sun with 97% UV screen protection and is designed to withstand up to 90mph winds. The addition of Ara can change the entire look of the space and elevate the design to a whole new level!



Arch Swings

Swings help children develop coordination and balance while providing an engaging sensory experience.



ORB™ ROCKER

With four traditional seats and room for four more in the center, the Orb Rocker's unique design and exciting rocking motion invites everyone into the fun. Caregivers and children will love the ease of access with side openings for users of all sizes.

DESIGN SUMMARY

Specified Play Equipment Company is very pleased to present this proposal for consideration for the Glen View Elementary located in Gilroy. BCI Burke Company, LLC has been providing recreational playground equipment for over 90 years and has developed the right mix of world-class capabilities to meet the initial and continuing needs of Gilroy Unified School District. We believe our proposal will meet or exceed your project's requirements and will deliver the greatest value to you.

The following is a summary of some of the key elements of our proposal:

- Project Name: Glen View Elementary
- Project Number: 137-118743-5
- User Capacity: 289
- Age Groups: Ages 5-12 years
- Dimensions: 49' 6" x 99' 9"
- Designer Name: Pa Der Vang

Specified Play Equipment Company has developed a custom playground configuration based on the requirements as they have been presented for the Glen View Elementary playground project. Our custom design will provide a safe and affordable playground environment that is aesthetically pleasing, full of fun for all users and uniquely satisfies your specific requirements. In addition, proposal # 137-118743-5 has been designed with a focus on safety, and is fully compliant with ASTM F1487 and CPSC playground safety standards.

We invite you to review this proposal for the Glen View Elementary playground project and to contact us with any questions that you may have.

Thank you in advance for giving us the opportunity to make this project a success.

INFORMATION
MINIMUM FALL ZONE
SURFACED WITH
RESILIENT MATERIAL
AREA

3894 SQ.FT.

PERIMETER

504 FT.

STRUCTURE SIZE

49' 6" x 99' 9"

STRUCTURE IS DESIGNED
FOR CHILDREN AGES:

- ☐ 6-23 MONTH OLDS
☐ 2-5 YEAR OLDS
☒ 5-12 YEAR OLDS
☐ 13 + YEAR OLDS



Registered
to ISO 9001

Registered
to ISO 14001



To verify product certification,
visit www.ipema.org

The play components identified
in this plan are IPEMA
certified. The use and layout of
these components conform to the
requirements of ASTM F1487.
To verify product certification,
visit www.ipema.org

The space requirements shown
here are to ASTM standards.
Requirements for other standards
may be different.

The use and layout of play
components identified in this plan
conform to the CPSC guidelines.
U.S. CPSC recommends the
separation of age groups in
playground layouts.

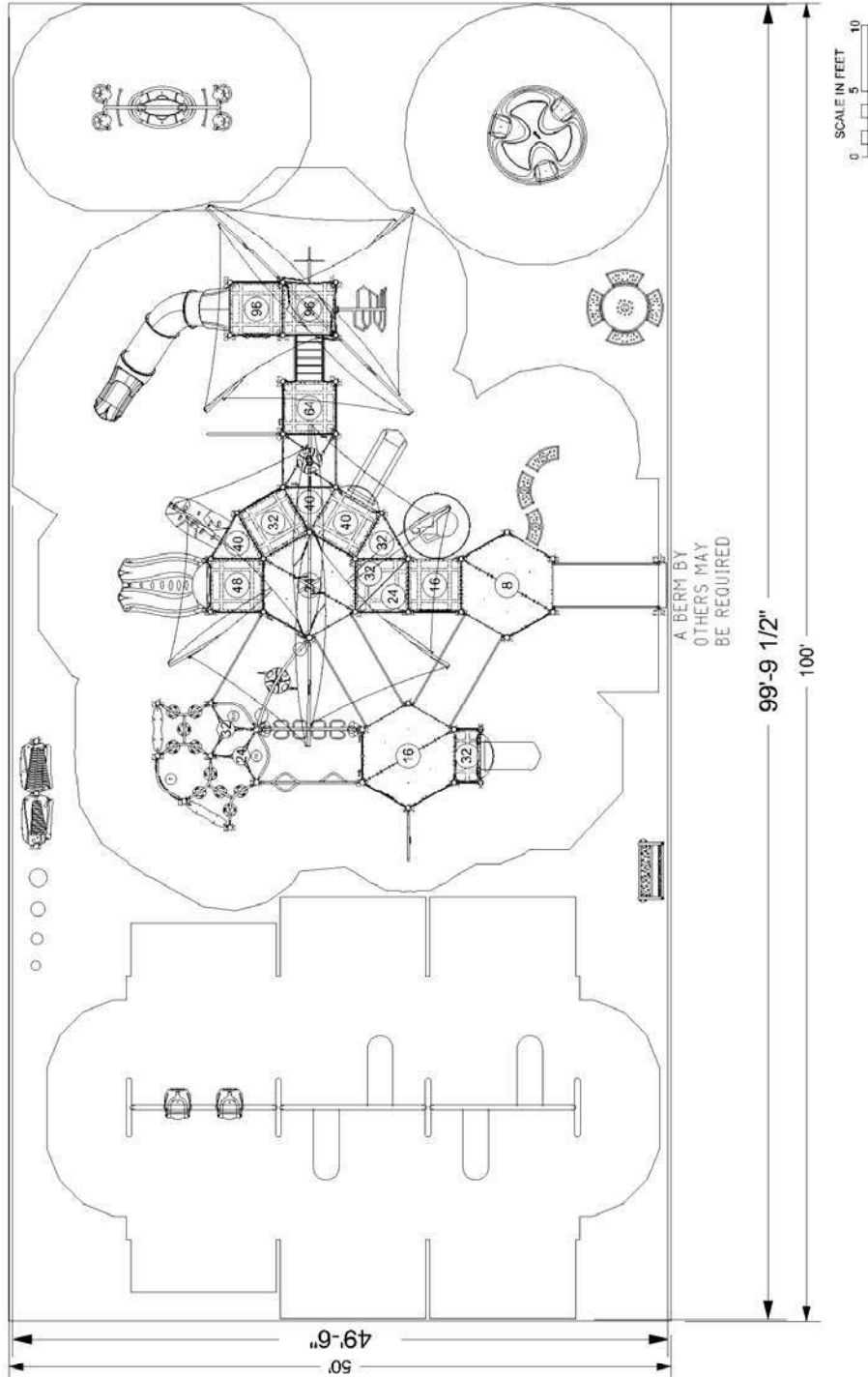

WARNING!

ACCESSIBLE SAFETY SURFACING MATERIAL IS REQUIRED BENEATH
AND AROUND THIS EQUIPMENT.
FOR SLIDE FALL ZONE SURFACING AREA SEE CPSC's Handbook for
Public Playground Safety.
PLATFORM HEIGHTS ARE IN INCHES ABOVE RESILIENT MATERIAL.

ADA ACCESSIBILITY GUIDELINE (ADAAG CONFORMANCE)

NUMBER OF PLAY EVENTS:	46
NUMBER OF ELEVATED PLAY EVENTS:	23
NUMBER OF ELEVATED PLAY EVENTS ACCESSIBLE BY RAMP:	PROVIDED: 7
NUMBER OF ELEVATED PLAY EVENTS ACCESSIBLE BY TRANSFER SYSTEM:	PROVIDED: 16
NUMBER OF ELEVATED PLAY EVENTS ACCESSIBLE BY RAMP OR TRANSFER SYSTEM:	PROVIDED: 23
NUMBER OF GROUND LEVEL PLAY EVENTS:	PROVIDED: 9
NUMBER OF TYPES OF GROUND LEVEL PLAY EVENTS:	PROVIDED: 4

Burke

SERIES: Basics, Intensity, Nucleus

SITE PLAN

DRAWN BY: Pa Der Vang

Glen View Elementary

600 West Eighth St.

Gilroy, CA 95020

Specified Play Equipment Company

137-118743-5

ITEM	COMP.	DESCRIPTION
1	270-0001	OFFSET ENCLOSURE
2	270-0090	8" CLOSURE PLATE
3	270-0109	PLATFORM LADDER 24"
4	270-0112	UNITARY ENCLOSURE
5	270-0129	TRIANGLE PLATFORM
6	270-0130	SQUARE PLATFORM
7	270-0131	HEXAGONAL PLATFORM S&P
8	270-0136	SPLIT SQUARE PLATFORM
9	270-0185	PLATFORM LADDER 16"
10	270-0221	8" RISE RAMP W/ GUARDRAILS
11	270-0223	8" RISE ENTRANCE RAMP W/ GU
12	270-0266	CENTER MOUNT ENCLOSURE
13	270-0291	HALF PLATFORM W/SUPPORT
14	370-0001	AGILITY ARC
15	370-0004	POWER PIPES CLIMBER
16	370-0009	HEALTHY HAMMOCK
17	370-0016	GRAB BAR ASSEMBLY
18	370-0026	LIMBER LADDER ROPE CLIMBER
19	370-0027	LAUNCH PAD
20	370-0033	ODYSSEY POST LINK DOUBLE
21	370-0037	ASCEND ROCK CLIMBER, 32" - 40"
22	370-0468	32" TRANSITION STAIR W/ BARRI
23	370-0495	STEEL PEAK CLIMBER 96"
24	370-0657	LINKING RING CLIMBER 80" - 96"
25	370-0812	CREST POINT CLIMBER
26	370-0867	TREE BRANCH CLIMBER-3
27	370-1611	ROBUST ROCKER
28	370-1620	TAKTIKS BOW CLIMBER
29	370-1622	TAKTIKS TRAIL TOWER
30	370-1624	INTENSITY PODSTEP CLIMBER
31	370-1642	VERVE CLIMBER 96" DK
32	470-0107	COBRA SLIDE CURVED 96"
33	470-0482	48" BENCH
34	470-0659	ROCK'N ROLL SLIDE, 40" - 48" W/
35	470-0670	ARA SQUARE SHADE CANOPY
36	470-0678	ARA HEX SHADE CANOPY
37	470-0756	LUGE SLIDE, 48"-56"
38	470-0804	SLIDE HOOD, LOW SIDE WALL
39	470-0836	ROCK'N ROLL SLIDE, 24-32 W/O
40	550-0112	BELT SEAT, 8" PAIR, STD CHAIN
41	550-0135	5" OD ARCH SWING
42	550-0136	5" OD ARCH SWING ADD-ON
43	550-0175	FREEDOM SWING SEAT, PAIR, 8
44	560-0055	PLAYENSEMBLE CIRQUE DRUM
45	560-0056	PLAYENSEMBLE CIRQUE DRUM
46	560-0057	PLAYENSEMBLE CIRQUE DRUM
47	560-0058	PLAYENSEMBLE CIRQUE DRUM
48	560-2579	VOLTA INCLUSIVE SPINNER
49	570-0394	PIPE WALL
50	570-0411	PLAYENSEMBLE SUPINE CHIMES
51	570-0412	PLAYENSEMBLE TERRA METALL
52	570-0842	ABC 2-SIDED PLAY PANEL
53	570-0846	SIGNING 2-SIDED PLAY PANEL
54	570-1858	3-IN-A-ROW PANEL, ABOVE PLAT
55	570-1862	COG WHEEL PANEL
56	570-1863	RAIN WHEEL PANEL
57	570-1864	GEAR PANEL
58	570-1865	HDPE UNITARY ENCLOSURE, NI
59	570-2624	HALF PIPE WALL
60	570-2635	CUSTOM CURVED 41
61	570-2640	CUSTOM CURVED 41 BELOW PL
62	570-2662	CRAZY MAZE 2-SIDED PLAY PAN
63	570-2664	BEE PANEL
64	570-2703	COLLISION RING PANEL
65	570-2709	ORB ROCKER
66	580-1312	NOVO ARC BENCH
67	580-1314	NOVO BENCH WITH BACK
68	580-1341	NOVO PICNIC TABLE

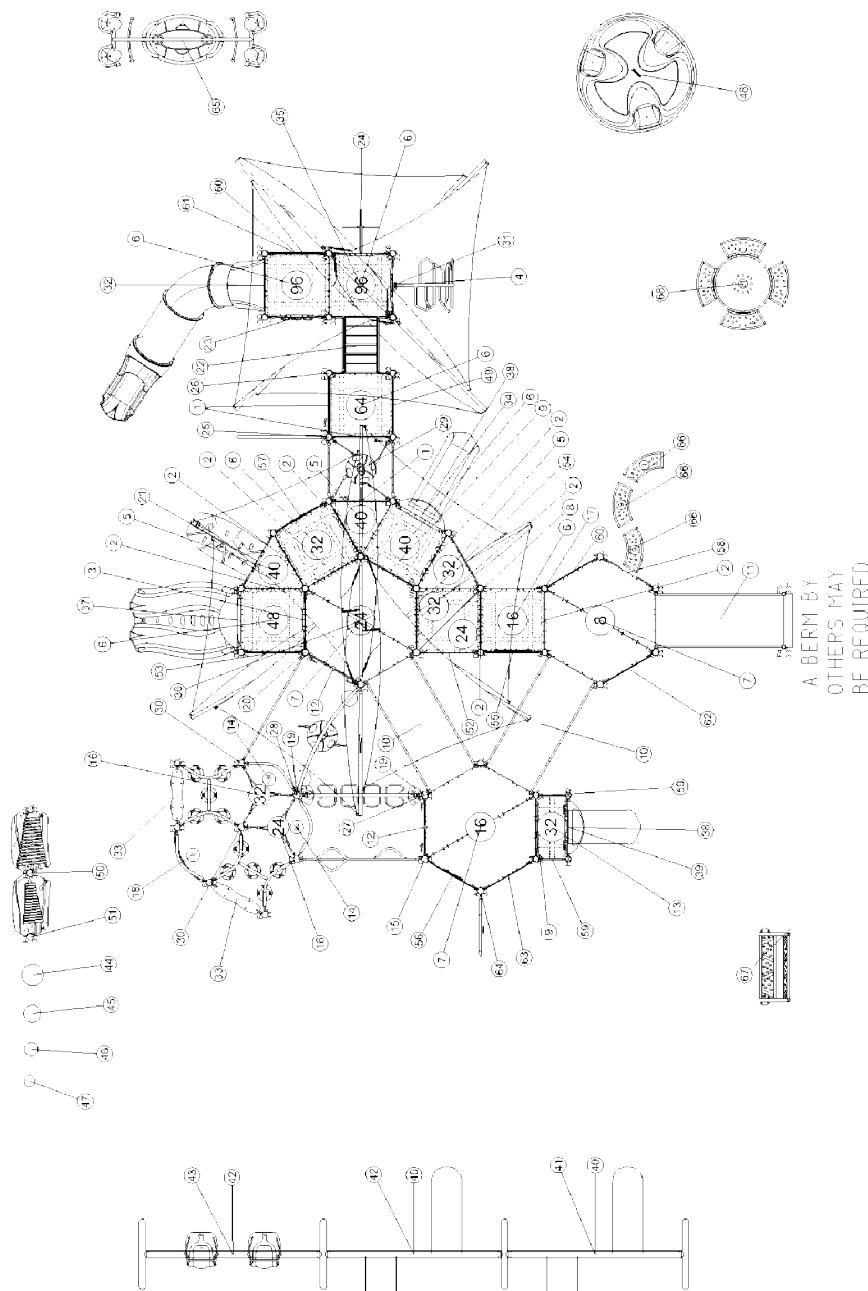

Burke

SERIES: Basics, Intensity, Nucleus

COMPONENT PLAN

DRAWN BY: Pa Der Vang

Glen View Elementary

600 West Eighth St.

Gilroy, CA 95020

Specified Play Equipment Company

137-118743-5

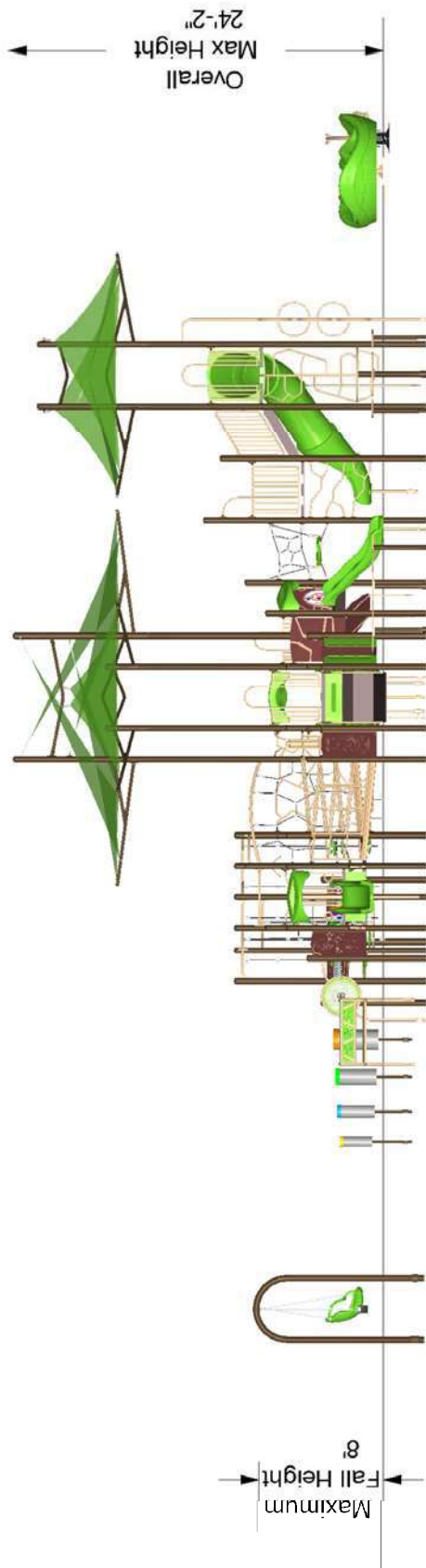

The protective surfacing for this design must accomodate the critical fall height.



SERIES: Basics, Intensity, Nucleus
ELEVATION PLAN
DRAWN BY: Pa Der Vang

Glen View Elementary
600 West Eighth St.
Gilroy, CA 95020

Specified Play Equipment Company
137-118743-5

July 29, 2020

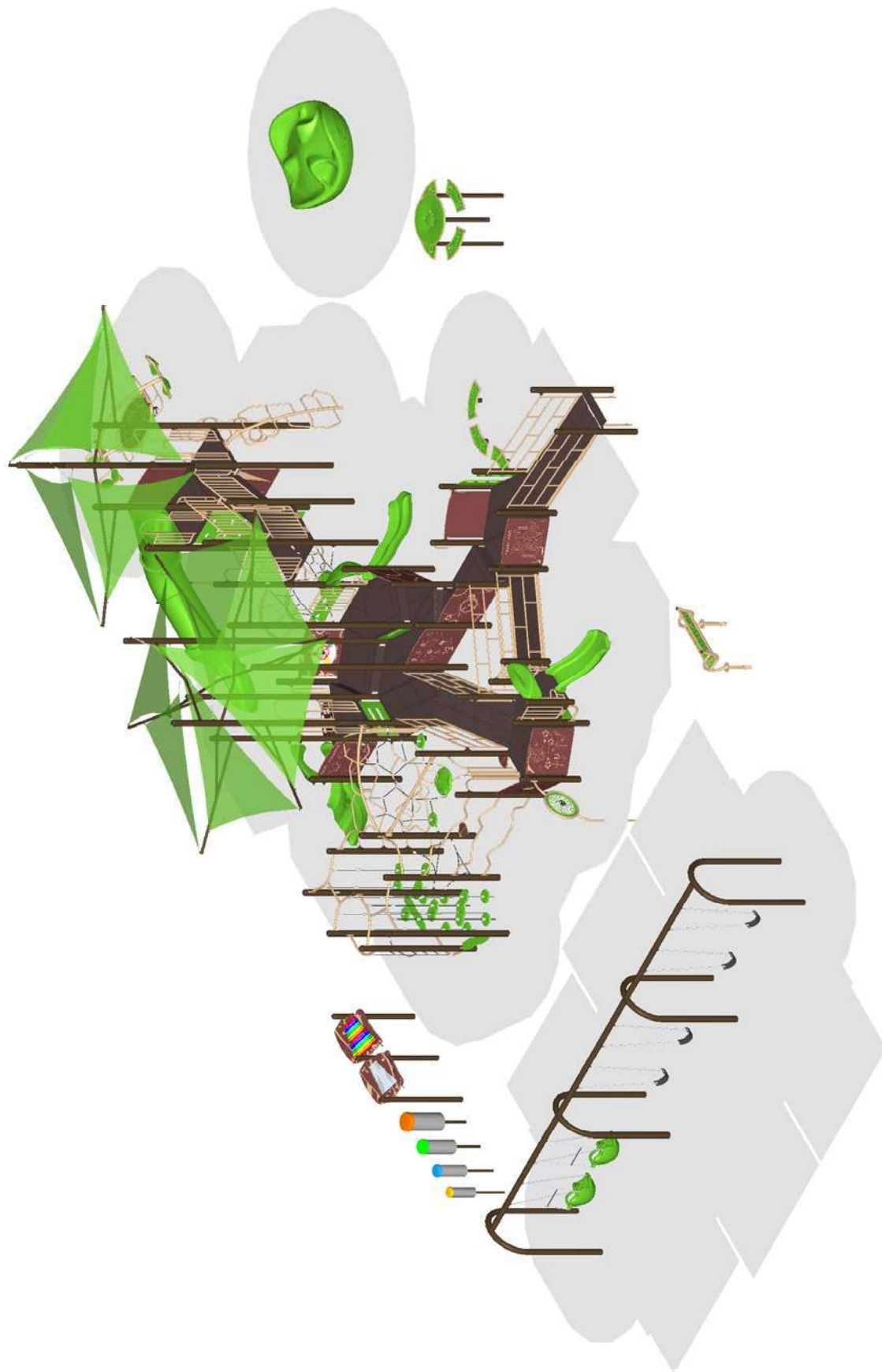

Burke

July 29, 2020

SERIES: Basics, Intensity, Nucleus

Glen View Elementary

Specified Play Equipment Company

ISOMETRIC PLAN

600 West Eighth St.

137-118743-5

DRAWN BY: Pa Der Vang

Gilroy, CA 95020

BCI Burke Company, LLC PO Box 549 Fond du Lac, Wisconsin 54936-0549 Telephone 920-921-9220

Page 84

Specified Play Equipment Co.

121 #1 Industrial Road

Belmont, CA 94002

800.475.1071

www.specplay.com

**ADDRESS**

Paul Nadeau

Gilroy Unified School District

7810 Arroyo Circle,

Gilroy, CA 95020

SHIP TO

Paul Nadeau

Gilroy Unified School District

Corp Yard

Gilroy, CA 95020

Estimate 1833**DATE 07/31/2020****EXPIRATION DATE 10/31/2020****TRACKING NO.**

Glen View 137-118743-5

CSLB# 1050307

-

DIR# 1000064237

-

ACTIVITY	QTY	RATE	AMOUNT
BCI Burke Equipment Burke equipment per plan #137-118743-5	1	122,480.00	122,480.00T
Design Development Design, drafting, fabrication, production and shop drawings.	1	52,903.00	52,903.00
Demolition Demo of existing Plastic Timbers approx.290LF Concrete seat wall area to remain.	1	2,780.00	2,780.00
Site Work Removal of EWF from main play box to be loaded in district trucks and disposed of/re-used at district corp yard	1	10,164.00	10,164.00
Demolition Demo existing play structures in both areas	1	4,851.00	4,851.00
Site Work Excavate Soil to 8" depth-5000 SF, remove and dispose to include saw cut of asphalt for straight edge	1	27,188.00	27,188.00
Site Work Concrete Curb for pour in place containment	1	17,950.00	17,950.00
Site Work Supply and install compacted base rock 4" depth over 5000 sf for rubber surfacing subbase	1	13,938.00	13,938.00

Please write checks to SPEC
 121 #1 Industrial Road
 Belmont, CA 94002

ACTIVITY	QTY	RATE	AMOUNT
Installation Service Installation of equipment per plan 137-118743-5 to manufacturer's specifications. Factory certified installers. Prevailing wages applied.	1	69,825.00	69,825.00
Protective Safety Surfacing Installation Pour in place 5000 SF @ 3.5" depth for 8' CFH. Black/blue and black/grey simple wavy design	1	88,750.00	88,750.00
Temporary Fencing Security Fence for duration of project	1	1,900.00	1,900.00
Receive and Offload Offload Equipment at corp yard by installers	1	2,350.00	2,350.00
Site Work Cap and re-route irrigation as needed	1	1,250.00	1,250.00
Field Inspection 3rd Party CPSI inspection	1	900.00	900.00
Freight Freight and packaging	1	14,600.00	14,600.00

PLEASE NOTE:

- Permits, if required, are the responsibility of the owner
- Engineered drawings not included. Quote available upon request.
- Bonding not included, but can be quoted upon request.
- Location of underground utility conflicts required prior to installation, quote available upon request for 3rd party locator.
- EWF in EWF areas to be re-used
- EWF removed from sites to be loaded in district trucks for disposal/re-use at corp yard.
- SPEC Turnkey Guarantee included

By signing below you acknowledge and agree to our Contract. The values shown above represent a specific scope; no other work should be assumed unless specifically noted in the text of the above line items. Unless otherwise specified we Exclude Responsibility for: offloading equipment, removal of packaging, project security, landscape & hardscape repair, delays due to conflicts, removal of spoils, locating underground; utilities, pipes, obstructions, conditions unforeseen and/or not disclosed at time of estimate, permits, engineering, soil samples. We are experienced with State & Federal prevailing wage and certified payroll requirements from DIR/DOL and will process when applicable. Union Agreements, including PLA's, are the responsibility of others and not to be included in our contract.

SUBTOTAL	431,829.00
TAX	11,023.20

Please write checks to SPEC

121 #1 Industrial Road

Belmont, CA 94002

Conditions: Grades; stable, compacted, & workable, (rough grade to be taken + or - one tenth of one inch), adequate access to work site provided for workmen, materials, tools, & equipment

TOTAL**\$442,852.20**

Accepted By

Accepted Date

Please write checks to SPEC
121 #1 Industrial Road
Belmont, CA 94002



COLOR KEY	
NAVY	●
GOLD	●
RED	●
SILVER	●
GRAY	●
GRANITE	●
RED/WHITE	●
GRAY/BLACK	●

PLAYENSEMBLE®

As a universal experience that inspires everyone to create, music brings a sense of wonder to the play environment. Musical experiences aren't just play, they accelerate child development, intellectually, socially and emotionally.



CASTLE-THEMED PLAY

Theming your playspace can bring children's imaginations to life! Studies show that imaginative play helps nurture a child's social, emotional and cognitive development.

SPEC
SPECIFIED PLAY EQUIPMENT CO.

COGNITIVE

So many life skills are learned through play! Skills such as cognitive planning, mastering new concepts, problem solving and expression are developed naturally through play events like climbing, sliding and spinning.



CLIMBING

Climbing brings adventure and challenge to the playground while providing necessary developmental benefits such as balance, agility, upper and lower body strength and decision-making skills! When children climb, they develop confidence and take age-appropriate risks that help build skills that will help them throughout their lives.



RAMP SYSTEM

Providing access to the most exciting areas of the playspace is vital for inclusion. Ramps allow everyone to move freely through the space and get much-needed physical exercise and socialization.



SWINGING

The joy of swinging is a childhood staple and kids LOVE it! Best of all, it has so many developmental benefits, including inner ear development, social awareness and sensory integration.



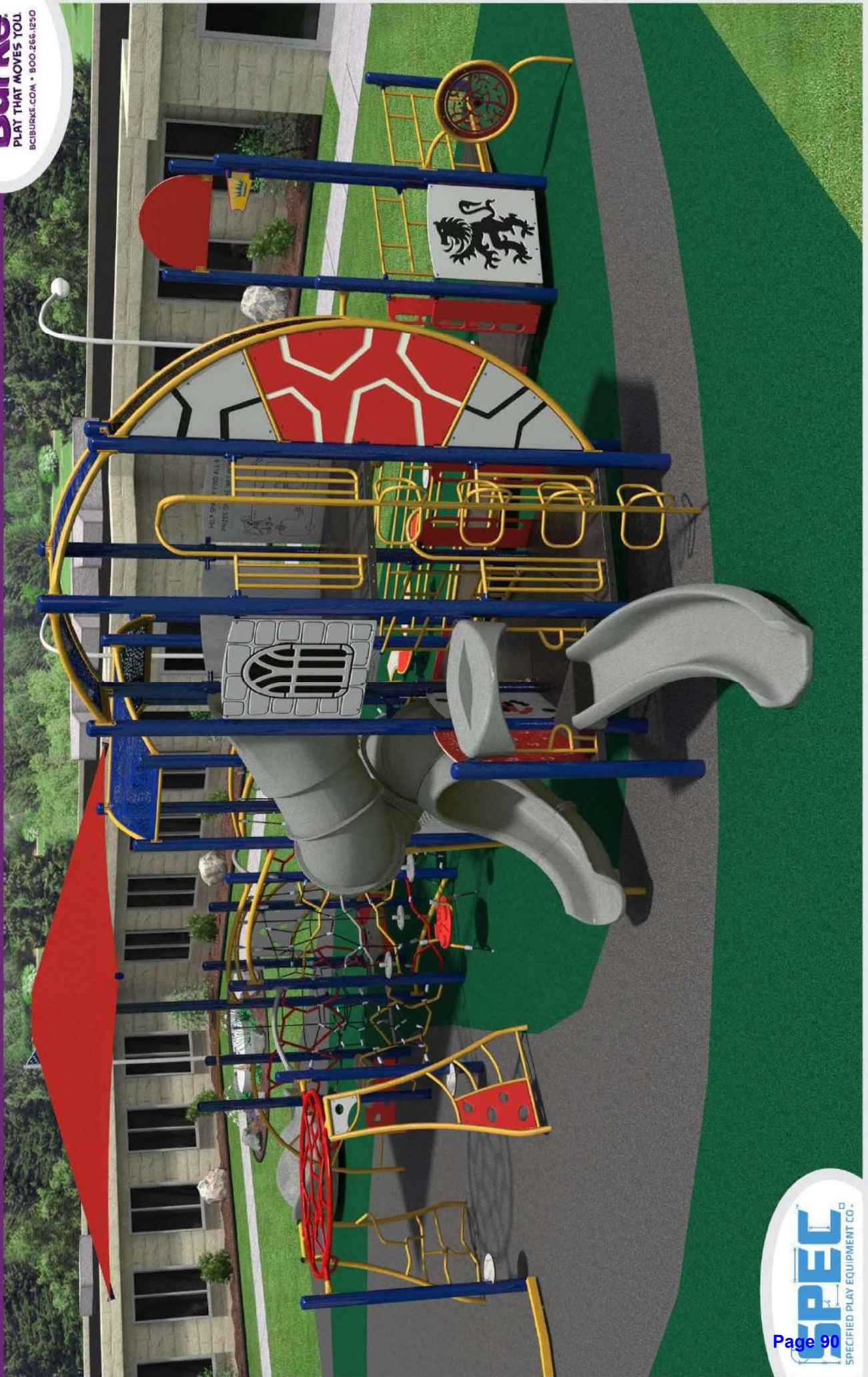



FEATURED PLAY EVENTS



COBRA SLIDE® CORKSCREW

Excitement can't be contained when it comes to COBRA SLIDES! They are twisting, turning, in and out of light and SO MUCH FUN! Fun aside, sliding has a variety of developmental benefits ranging from core strength and balance to taking turns and imagination.



Nucleus® Evolution® Arch Climber

Climbing up ropes to view the world from a different angle. Inspiring new panoramas, creating new vistas. You're protected but it looks open and new. A perspective like nothing you've ever experienced before.



Horizontal Overhead

Overhead events build upper body strength and endurance, improve eye-hand coordination and elevate children's self-confidence.

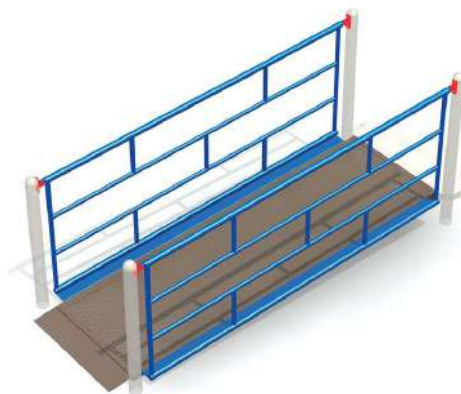

ADAAG Ramp

Ramps and stairs build lower body strength and improve kids' coordination.

FEATURED PLAY EVENTS

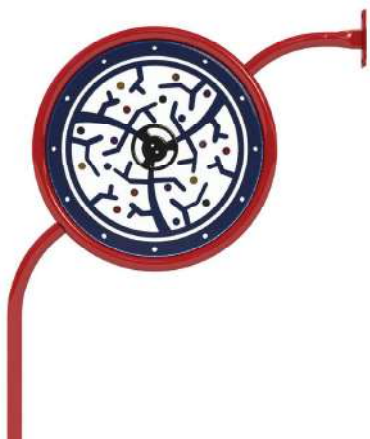

COLLISION RING PANEL

Interact with Burke's Collision Panel to encourage exploration, interaction and develop fine-motor skills for children with all abilities.



15' X 15' SHADEPLAY CANOPY

ShadePlay Canopies can reduce playground temperature by up to 30 degrees and block up to 90 percent of harmful UV radiation.



Pennant Post Topper

Post Toppers are a fun way to provide a finishing touch to any playground structure. Place one, two, three or more of these post toppers on your structure to create an aesthetic appeal or a fun, imaginative play concept.



EVOLUTION HEX ROOF

Intricate climbers. Fast slides. The Next Evolution in Play is here. The Nucleus Evolution collection will move children to experience adventure, develop narratives and create experiences like no one has seen on the playground before.

DESIGN SUMMARY

Specified Play Equipment Company is very pleased to present this proposal for consideration for the Rod Kelley Elementary located in Gilroy. BCI Burke Company, LLC has been providing recreational playground equipment for over 90 years and has developed the right mix of world-class capabilities to meet the initial and continuing needs of Gilroy Unified School District. We believe our proposal will meet or exceed your project's requirements and will deliver the greatest value to you.

The following is a summary of some of the key elements of our proposal:

- Project Name: Rod Kelley Elementary
- Project Number: 137-118742-5
- User Capacity: 251
- Age Groups: Ages 5-12 years
- Dimensions: 79' 3" x 95' 11"
- Designer Name: Pa Der Vang

Specified Play Equipment Company has developed a custom playground configuration based on the requirements as they have been presented for the Rod Kelley Elementary playground project. Our custom design will provide a safe and affordable playground environment that is aesthetically pleasing, full of fun for all users and uniquely satisfies your specific requirements. In addition, proposal # 137-118742-5 has been designed with a focus on safety, and is fully compliant with ASTM F1487 and CPSC playground safety standards.

We invite you to review this proposal for the Rod Kelley Elementary playground project and to contact us with any questions that you may have.

Thank you in advance for giving us the opportunity to make this project a success.

5077 SQ.FT.

PERIMETER

699 FT.

STRUCTURE SIZE

79' 3" x 95' 11"

STRUCTURE IS DESIGNED
FOR CHILDREN AGES:

- ☐ 6-23 MONTH OLDS
☐ 2-5 YEAR OLDS
☒ 5-12 YEAR OLDS
☐ 13 + YEAR OLDS

Registered to ISO 9001
Registered to ISO 14001Registered to ISO 9001
Registered to ISO 14001

To verify product certification, visit www.ipema.org

The play components identified in this plan are IPEMA certified. The use and layout of these components conform to the requirements of ASTM F1487. To verify product certification, visit www.ipema.org

The space requirements shown here are to ASTM standards. Requirements for other standards may be different.

The use and layout of play components identified in this plan conform to the CPSC guidelines. U.S. CPSC recommends the separation of age groups in playground layouts.

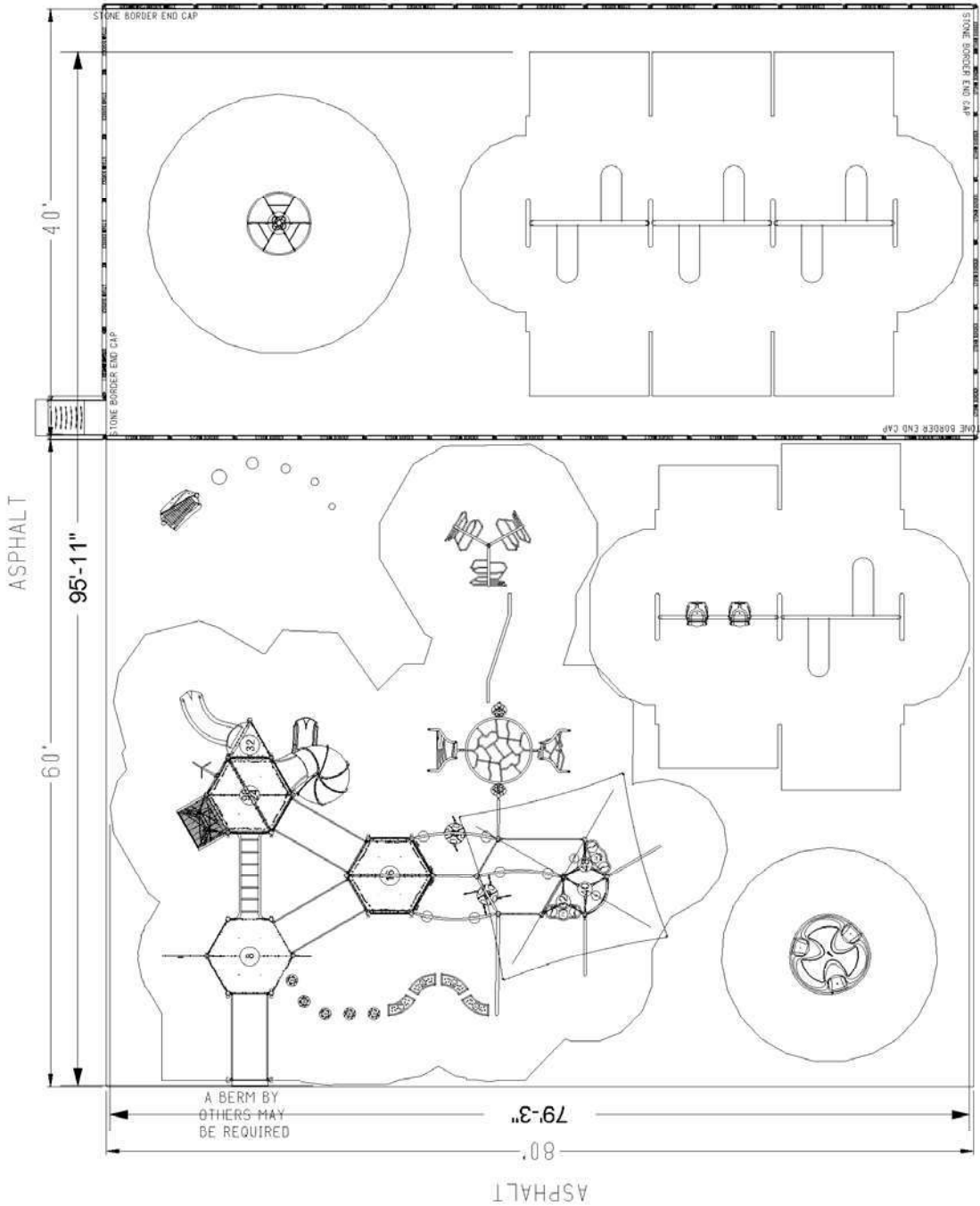

NOTE: ALTHOUGH ALL ATTEMPTS HAVE BEEN MADE TO PROVIDE AN ACCURATE SITE IT MAY NOT TRULY REPRESENT THE AREA WHERE THIS STRUCTURE IS TO BE PLACED.



PIP AREA: 4,800 SQ. FT.
EWF AREA: 3,200 SQ. FT.

WARNING!

ACCESSIBLE SAFETY SURFACING MATERIAL IS REQUIRED BENEATH AND AROUND THIS EQUIPMENT.
FOR SLIDE FALL ZONE SURFACING AREA SEE CPSC's Handbook for Public Playground Safety.
PLATFORM HEIGHTS ARE IN INCHES ABOVE RESILIENT MATERIAL.

ADA ACCESSIBILITY GUIDELINE (ADAAG CONFORMANCE)

NUMBER OF PLAY EVENTS	NUMBER OF ELEVATED PLAY EVENTS	RECD.
59	14	RECD. 0
NUMBER OF ELEVATED PLAY EVENTS:	NUMBER OF ELEVATED PLAY EVENTS ACCESSIBLE BY RAMP	PROVIDED: 9
NUMBER OF ELEVATED PLAY EVENTS ACCESSIBLE BY TRANSFER SYSTEM	NUMBER OF ELEVATED PLAY EVENTS ACCESSIBLE BY RAMP OR TRANSFER SYSTEM	RECD. 7
NUMBER OF ELEVATED PLAY EVENTS ACCESSIBLE BY RAMP OR TRANSFER SYSTEM	NUMBER OF GROUND LEVEL PLAY EVENTS	RECD. 0
NUMBER OF TYPES OF GROUND LEVEL PLAY EVENTS	NUMBER OF TYPES OF GROUND LEVEL PLAY EVENTS	PROVIDED: 12

ITEM	COMP.	DESCRIPTION
1	046-0053	6II STONE BORDER 1/2 DRIVE PINS
2	046-0055	END CAP
3	046-0153	BORDER RAMP W/STAKES
4	270-0090	8" CLOSURE PLATE
5	270-0112	UNITARY ENCLOSURE
6	270-0129	TRIANGLE PLATFORM
7	270-0131	HEXAGONAL PLATFORM S5P
8	270-0221	8" RISE RAMP W/ GUARDRAILS
9	270-0223	8" RISE ENTRANCE RAMP W/ GU
10	270-0266	CENTER MOUNT ENCLOSURE
11	370-0001	AGILITY ARC
12	370-0009	HEALTHY HAMMOCK
13	370-0026	LINER LADDER ROPE CLIMBER
14	370-0033	ODYSSEY POST LINK DOUBLE
15	370-0205	LONG HORIZONTAL OVERHEAD
16	370-0556	ATOM CLIMBER 80" x 96"
17	370-0812	CREST POINT CLIMBER
18	370-0813	RIDGE POINT CLIMBER
19	370-0829	PLEXUS OVERHEAD
20	370-0830	PLEXUS HOLE CLIMBER
21	370-0832	PLEXUS TANGLE CLIMBER
22	370-0834	OVERHEAD POST ATTACHMENT
23	370-0888	TREE BRANCH CLIMBER-4
24	370-1583	APEX ROPE CLIMBER
25	370-1589	TAKTIKS BOLT CLIMBER
26	370-1608	OVISTEP LAUNCH PAD
27	370-1616	TAKTIKS, TALL ROPE WALL
28	370-1620	TAKTIKS BOW CLIMBER
29	370-1621	TAKTIKS, SHORT ROPE WALL
30	370-1649	EVOLUTION, DECK TO ROOF CL
31	470-0101	DYNAMIC PAD
32	470-0108	COBRA SLIDE CORKSCREW RIG
33	470-0773	EZ TENSION 15' X 15' SHADEPLA
34	470-0802	MONACO SLIDE, 32" x 40"
35	470-0804	SLIDE HOOD, LOW SIDE WALL
36	470-0808	EVOLUTION ROOF BOTTOM EDG
37	470-0813	EVOLUTION HEX ROOF
38	550-0112	BELT SEAT, 8" PAIR, STD CHAIN
39	550-0135	5" OD ARCH SWING
40	550-0136	5" OD ARCH SWING ADD-ON
41	550-0175	FREEDOM SWING SEAT, PAIR, 8
42	560-0055	PLAYENSEMBLE CIRQUE DRUM
43	560-0056	PLAYENSEMBLE CIRQUE DRUM
44	560-0057	PLAYENSEMBLE CIRQUE DRUM
45	560-0058	PLAYENSEMBLE CIRQUE DRUM
46	560-0059	PLAYENSEMBLE CIRQUE DRUM
47	560-0453	STEP SPOT POOL 8-16"
48	560-2579	VOLTA INCLUSIVE SPINNER
49	560-2580	VERVE III CLIMBER
50	560-2611	SPINETIC W/O SPEED LIMITER
51	570-0411	PLAYENSEMBLE SUPINE CHIMES
52	570-0584	CUSTOM ARCH SIGN
53	570-0622	PLATFORM ROLL GUARD
54	570-0737	PENNANT FULL COLOR CUSTOM
55	570-0811	BRAILLE PANEL
56	570-0842	ABC 2-SIDED PLAY PANEL
57	570-0848	SIGNING 2-SIDED PLAY PANEL
58	570-1858	3-IN-A-ROW PANEL, ABOVE PLAT
59	570-1865	HDPE UNITARY ENCLOSURE, IN
60	570-2635	CUSTOM CURVED 41
61	570-2662	GAZY MAZE 2-SIDED PLAY PAN
62	570-2669	MAZE ACCESSIBLE REACH PAN
63	570-2703	COLLISION RING PANEL
64	560-1312	NOVO ARC BENCH
65	590-0058	S BALANCE BEAM ASSY
66	670-0423	POST, FOOTER EXTENSION 5'-0

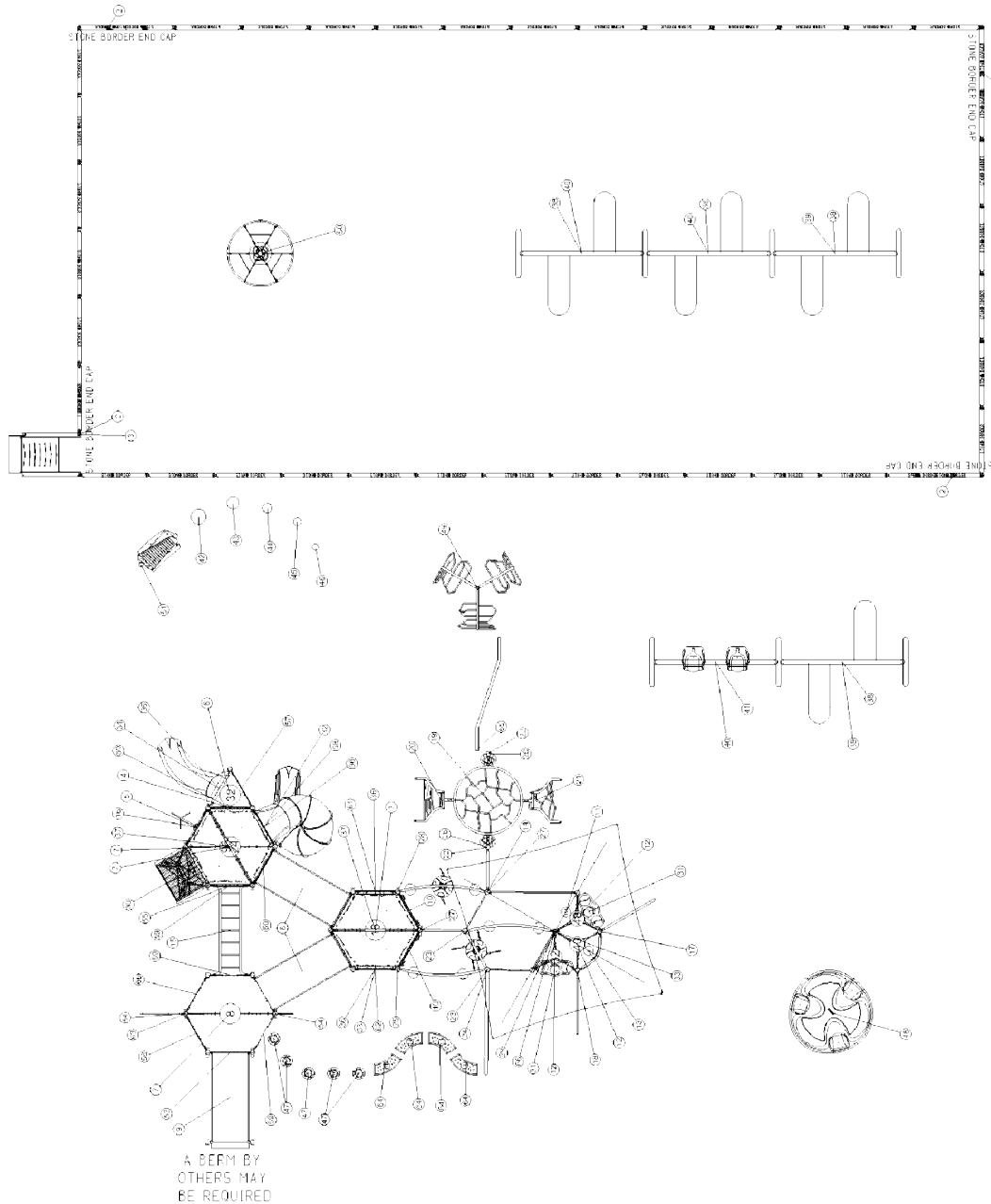

Burke

SERIES: Basics, Intensity, Nucleus
COMPONENT PLAN
DRAWN BY: Pa Der Vang

Rod Kelley Elementary
8755 Kern Ave.
Gilroy, CA 95020

Specified Play Equipment Company
137-118742-5

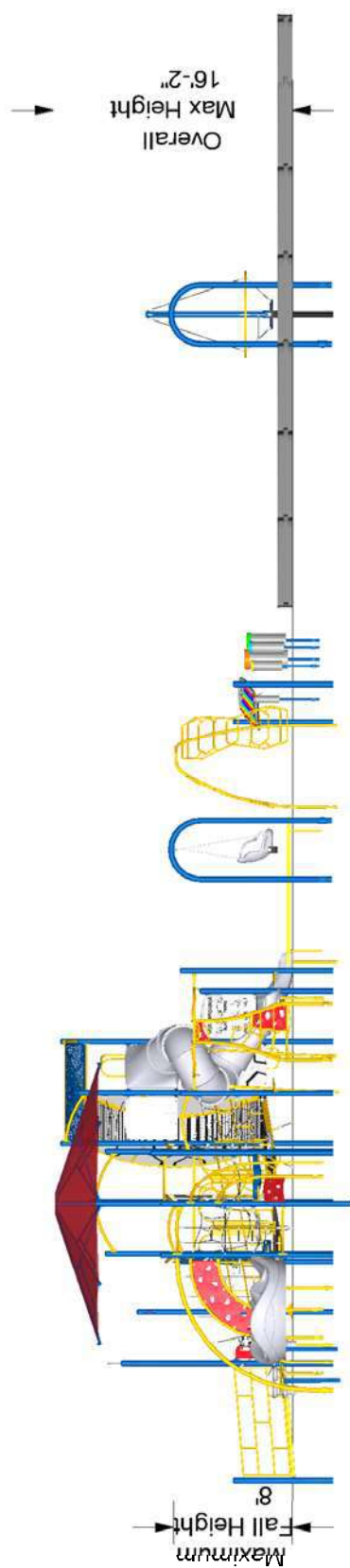

The protective surfacing for this design must accommodate the critical fall height.

Burke

July 29, 2020

SERIES: Basics, Intensity, Nucleus

Rod Kelley Elementary

Specified Play Equipment Company

ELEVATION PLAN

8755 Kern Ave.

137-118742-5

DRAWN BY: Pa Der Vang

Gilroy, CA 95020

BCI Burke Company, LLC PO Box 549 Fond du Lac, Wisconsin 54936-0549 Telephone 920-921-9220

Page 97

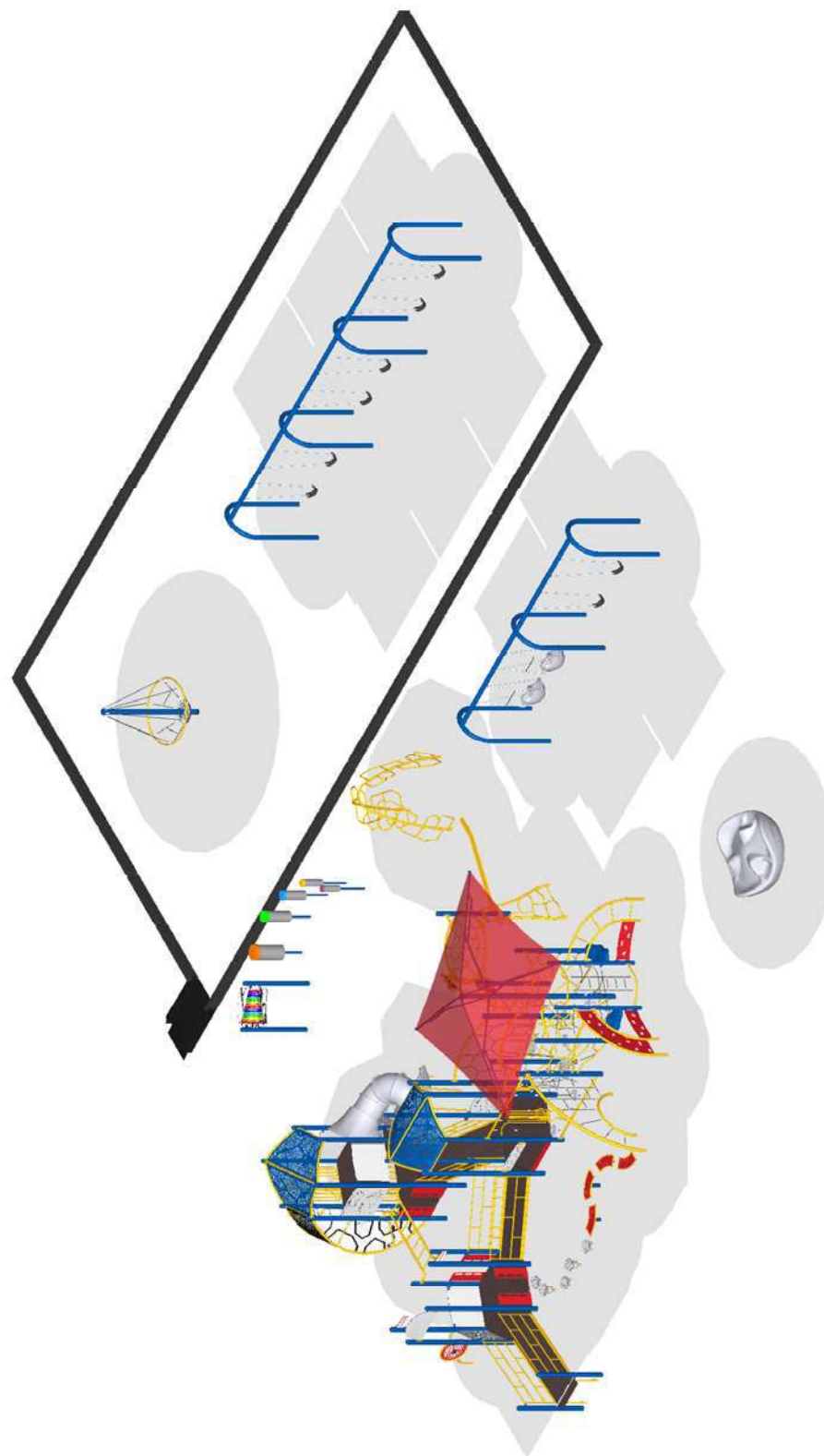

Burke

July 29, 2020

SERIES: Basics, Intensity, Nucleus

ISOMETRIC PLAN

DRAWN BY: Pa Der Vang

Rod Kelley Elementary

8755 Kern Ave.

Gilroy, CA 95020

Specified Play Equipment Company

137-118742-5

Specified Play Equipment Co.

121 #1 Industrial Road
 Belmont, CA 94002
 800.475.1071
 www.specplay.com

**ADDRESS**

Paul Nadeau
 Gilroy Unified School District
 7810 Arroyo Circle,
 Gilroy, CA 95020

SHIP TO

Paul Nadeau
 Gilroy Unified School District
 Corp Yard
 Gilroy, CA 95020

Estimate 1834**DATE 07/31/2020****EXPIRATION DATE 10/31/2020****TRACKING NO.**

Rod Kelley 137-118742-5

CSLB# 1050307

-

DIR# 1000064237

-

ACTIVITY	QTY	RATE	AMOUNT
BCI Burke Equipment Burke equipment per plan #137-118742-5	1	120,147.00	120,147.00T
Design Development Design, drafting, fabrication, production and shop drawings.	1	50,789.00	50,789.00
Demolition Demo/Disposal of Timbers 360 LF	1	3,110.00	3,110.00
Site Work Removal of EWF from pour in place area. To be loaded in district trucks and to corp yard for disposal/re-use.	1	10,823.00	10,823.00
Demolition Demo existing play Equipment	1	6,185.00	6,185.00
Site Work Excavate Soil to 8" depth- 4800 SF, remove and dispose	1	27,144.00	27,144.00
Site Work Concrete Curb for pour in place area containment	1	17,075.00	17,075.00
Site Work Supply and install compacted base rock 4" depth over 4800 sf for rubber surfacing subbase	1	13,915.00	13,915.00

Please write checks to SPEC
 121 #1 Industrial Road
 Belmont, CA 94002

ACTIVITY	QTY	RATE	AMOUNT
Installation Service Installation of equipment per plan 137-118742-5 to manufacturer's specifications by factory certified installers. Prevailing wages. To include installation of new border timbers in EWF area.	1	78,969.00	78,969.00
Protective Safety Surfacing Installation Pour in place 4800 SF @ 3.5" depth for 8' critical fall height. Green and Black mix with wavy design	1	85,920.00	85,920.00
Temporary Fencing Security Fence for duration of project	1	1,200.00	1,200.00
Receive and Offload Offload Equipment at corp yard by installers and move to site when ready.	1	2,350.00	2,350.00
Freight Freight and packaging	1	14,400.00	14,400.00

- Permits if required are the responsibility of the owner
- Engineered drawings not included. Quote available upon request.
- Bonding not included, but can be quoted upon request.
- Location of underground utility conflicts required prior to installation, quote available upon request for 3rd party locator.
- EWF in EWF areas to be re-used
- EWF removed from sites to be loaded in district trucks for disposal/re-use at corp yard.
- SPEC Turnkey Guarantee included

By signing below you acknowledge and agree to our Contract. The values shown above represent a specific scope; no other work should be assumed unless specifically noted in the text of the above line items. Unless otherwise specified we Exclude Responsibility for: offloading equipment, removal of packaging, project security, landscape & hardscape repair, delays due to conflicts, removal of spoils, locating underground; utilities, pipes, obstructions, conditions unforeseen and/or not disclosed at time of estimate, permits, engineering, soil samples. We are experienced with State & Federal prevailing wage and certified payroll requirements from DIR/DOL and will process when applicable. Union Agreements, including PLA's, are the responsibility of others and not to be included in our contract. Conditions: Grades; stable, compacted, & workable, (rough grade to be taken + or - one tenth of one inch), adequate access to work site provided for workmen, materials, tools, &

SUBTOTAL	432,027.00
TAX	10,813.23

Please write checks to SPEC

121 #1 Industrial Road

Belmont, CA 94002

equipment

TOTAL

\$442,840.23

Accepted By

Accepted Date

Please write checks to SPEC
121 #1 Industrial Road
Belmont, CA 94002



OUR MISSION IS TO CONSULT, DESIGN
COLLABORATE & CONSTRUCT SELF REGULATED
PLAY EXPERIENCES FOR ALL AGES & ABILITIES
TO EXERCISE RISK, FAILURE & MASTERY.

9
A5-2
1.5

SECTION DETAIL: CONNECTION

2700 A.F.F.



EXPERTS IN PLAY,
SPORT AND PARK

SPEC Company Profile



DAVID YOSSO, PRINCIPAL.OWNER

Yosso holds a Bachelor's Degree in Recreation Management along with a Master's Degree in Parks Management from California Polytechnic State University, San Luis Obispo. For nearly 15 years, Yosso has managed more than 350 park and playground projects throughout California and the United States. Yosso is passionate about parks and play area design. He believes strongly that play should be spontaneously selected, individually directed, and inherently educational. As a former NCAA Division I student athlete he holds a record for the most yellow cards in a single season. He has coached soccer at all age levels from U5 to NCAA Division II. He now coaches his son, Dylan, in the hopes he does not break Yosso's illustrious NCAA Division I yellow card record. BTW, Dylan frankly is way too nice on the pitch to threaten the record and likely will be a Lego Master builder before he is 10.



CHRIS OLSEN, CPSI, SR.PROJECT.MANAGER

A Bay Area native and current resident of the Livermore Tri-Valley, Chris Olsen brings years of playground experience and passion to every project he works on. Chris' past experience as a social worker helping severely emotionally disturbed children, combined with his extensive experience in customer service, has given Chris a unique perspective on play, child development, and making sure his customers receive the utmost in service and value. During his "down time" you'll most likely find Chris in his kitchen roasting vegetables (the guy really likes healthy food), or possibly visiting the plethora of amazing parks in the region with his wife, Adrienne and 7 year old son, Nicholas (who is also his go to "playground test pilot" and resident "fun consultant") and family dog "Harley". A lifelong Star Wars nerd and Sci-Fi enthusiast, Chris is also a serial optimist who's personal and professional goal is to bring memorable, fun, and enriching play experiences to children (and adults) of all ages and abilities.



DAYA SANCHEZ, COMMUNITY OUTREACH.COORDINATOR

Sánchez grew up in San José and went on to attend UC Berkeley where she majored in Political Economies of Industrialized Societies and played outside center for the rugby team. Daya brings over 15 years of experience in education and community. She has served in AmeriCorps, taught bilingual fifth grade, migrant education and preschool and worked as a volunteer firefighter and EMT. Daya coaches youth soccer, serves on the boards of two nonprofits and is the author of the nonfiction children's book *This is Gymnastics*. Daya also has her own team of professional playground testers—her sons Sebastian (shortstop, freeskier) and Dominic (gymnast, ballet dancer), her daughter Adrienne (futbolista, taekwondo

blue belt and giant slalom racer), and her husband Stephen (educator and CrossFit rock star). When they're not out competing, Daya and her family love to learn about the world around them through books, outdoor exploration and play.



LISA CRESSON, CPSI PROJECT.MANAGER

Cresson holds a B.A. in psychology from San Francisco State University and an M.A. in marital and family from Loyola Marymount University. For the last ten years she has been applying her psychological foundation to sales and business management. Cresson believes wholeheartedly that play and community space can combine to exert a powerfully enriching influence on child, family and community development. She loves learning new things, spending time with her husband and 9 yr old daughter Chloe, and training for/ competing in triathlon and aquabike races.



CAROLINE O'NEAL, CPSI, ASLA, PROJECT.MANAGER LANDSCAPE.DESIGNER

A San Francisco native, O'Neal loves all things parks and recreation. With a master's degree in landscape architecture from the University of Colorado, Denver, she is a fierce advocate for accessibility to parks, open space and nature. She believes that these places bring communities together, foster a love of the world and ecology around us and, of course, encourage play! Her years of experience in public design and urban renewal bring a unique perspective. She is a lover of the outdoors and can be found climbing mountains, backpacking or growing her own food on her urban farm.



IAN PARSONS, CPSI, JR.PROJECT.MANAGER

A recent graduate of Cal Poly's Experience Industry Management program with a minor in Entrepreneurship, Ian combines a passion for play with a love for everything outdoors. He is excited to contribute to SPEC's impressive portfolio with dynamic play areas that encourage independent thinking and social problem-solving. When not surfing or hiking, you can catch Ian enjoying a soccer game on his couch with his plus-sized orange cat named Andretti.

SPEC Guarantee

Specified Play Equipment provides FREE warranty labor on all SPEC installed equipment in California

- Equipment must have been originally installed by SPEC installers
- Labor covered must be on Equipment under manufacturer's warranty
- Covers all SPEC Playground and Sport Equipment brands
- Applies only to customers in California

Manufacturer + SPEC:

- Slide breaks 14 years after installation
- Manufacturers Warranty + SPEC
- Cost to replace slide
 - \$0 equipment
 - \$0 freight
 - \$0 installation
 - Total: \$0
- SPEC provides FREE Lifetime Warranty labor on SPEC installed equipment
- Slide then comes with new 15-year warranty

Other Companies:

- Slide broken 14 years after installation
- Cost to replace broken slide:
 - \$4,700 equipment
 - \$1,300 freight
 - \$3,000 installation
 - Total: \$9,000
- New slide does not come with new warranty

Professional Project References

Pete Chiamos

Parks Manager
City of Foster City
650.286.3549
pchiamos@fostercity.org

Joseph Pandolfo, Ed.D.

Deputy Superintendent,
Rincon Valley Union School District
707.542.7375
jpandolfo@rvusd.org

Geoff de Santis

Operations Director
Sacred Heart Schools of San Francisco
415.345.5901
Geoff.desantis@sacredsfs.org

John Gianoli

Parks Manager
City of Millbrae
650.333.0766
jgianoli@ci.millbrae.ca.us

Toks Ajike

Project Manager
Capital Improvement Division
City of San Francisco
415.581.2543
Toks.ajike@sfgov.org

La Shawn Butler

Parks and Recreation Director
City of Dublin
925.833.6645
Lashawn.butler@dublin.ca.gov

Sheila Canzian

Director of Parks and Recreation
City of San Mateo
650.522.7404
scanzian@cityofsanmateo.org

Lizzy Hirsch

Parks and Team Leader, Landscape Architecture
City of San Francisco
415.558.4494
Lizzy.Hirsch@sfdpw.org

Matt Gruber

Landscape Architect
City of Pleasanton
925.931.5650
mgruber@cityofpleasantonca.gov

Jeff Miller

Principal
Miller Company Landscape Architects
415.559.1914
jmiller@millercomp.com

David Fletcher

Principal
Fletcher Studios
415.230.9144
dfletcher@fletcherstudio.com

Kevin Conger

Principal
CMG Landscape Architecture
415.495.3070
KConger@cmgsite.com

Chad Kennedy

Principal
O'Dell Engineering
209.571.1765
ckennedy@odellengineering.com

Brian Fletcher

Principal
Callander Associates
650.375.1313
bfletcher@callanderassociates.com

Testimonials

David Yosso provided a Free Needs Assessment for Rincon Valley School District to review all our playground equipment. We used this comprehensive report to replace our equipment with a district wide standard. We interviewed and asked other districts to make sure we did our due diligence. SPEC was suggested for our short list interviews among all the major brands and companies. SPEC has proven to be the most trustworthy, price competitive, and reliable company on the market. We can't say enough about the professionalism and honesty we receive from the SPEC staff and their products and services are amongst the highest quality at a reasonable price. RVUSD can rely on SPEC to provide what they say they will provide on time and under budget.

Joseph Pandolfo, Ed.D. Deputy Superintendent, Rincon Valley Union School District

Mr. Yosso provided a Free Needs Assessment for Cotati-Rohnert Park School District and reviewed the entire school districts playground equipment. The district came up for a bond and since our equipment was so old and out of compliance we had the opportunity to replace all our equipment with a district standard. Working with Mr. Yosso is easy and reliable. He comes through when he says he will and is extremely knowledgeable and accountable. I've worked with several other playground companies in the past but now that we work with David Yosso and SPEC we are set.

Josh Savage Executive Director, Cotati-Rohnert Park Unified School District

PLAY THAT MOVES YOU®

Creating Play That Moves You requires dedication, research and a fierce passion for bringing a higher level of play to communities. The results are more than worth the effort. Products such as Novo® Playful Furniture and Taktiks® move us to design the best play environments for all. Taking play interaction to the next level is the Konnection™ Swing. There isn't a better way to connect on the playground - whether it's an adult and a child or two kids. The fusion of traditional and active-based play lays the foundation for an environment where everyone can develop physically, emotionally, socially and cognitively through play. It fosters opportunities for the types of experiences that bring communities together and move us in so many ways. Join Our Movement and see how you can bring a higher level of play to your community!

GET MOVING!

Burke's unique fitness offerings keep people of all ages moving! Our Intensity® and Nucleus® playgrounds feature a fusion of traditional and fitness-based play that engages children to move like never before. The ELEVATE® Fitness Course features challenging obstacles designed for healthy competition and fun for ages 5-12 or 13 plus. Our variety of fitness play options ensures everyone has the opportunity to reap the benefits of movement at any age and skill level.

MOVE YOUR MIND

Extensive research suggests that play provides tremendous developmental benefits to children. In fact, it's been said that children learn through play - it helps their brains and bodies develop. There's no such thing as too much of a good thing when it comes to play!

INTERACTIONS THAT MOVE US

Play brings communities together and strengthens families and friendships. Burke's playgrounds provide amazing opportunities for kids to develop socially from playing independently at a young age, transitioning to parallel play and learning how to cooperatively play together as their development continues.

MOTION THAT MOVES YOU

Movement is essential to life and to play. Motion play creates movement for children of all abilities and assists with many developmental areas, including increased spatial awareness, inner ear stimulation and balance. Motion can be soothing to children with sensory processing differences and offers an exciting activity for everyone to enjoy.

PLAY THAT MOVES DEVELOPMENT

Play is an important part of a child's emotional development and it is often through play that they learn necessary skills such as patience and empathy. Play also helps children learn how to express and manage their feelings, which is the grounds for much of a child's future success and well-being.



WORK THAT MOVES US

What we bring to work every day is more than just ourselves. Our ideas, craftsmanship and collaboration form our culture and help us bring a higher level of play to communities around the world.

HANDCRAFTED IN AMERICA'S HEARTLAND

Walk through our Fond du Lac, WI manufacturing facility and you will see playgrounds coming to life through the hands of our people. In the age of assembly lines, we work to combine efficiency with a personal touch that makes every playground special. Bringing quality playgrounds to communities like yours is Work That Moves Us, and we hope the playgrounds we make move you too.

SUPERIOR SERVICE

Customer Service is a hallmark of Burke and we take pride in the fact that when you call, we answer. Yes, a real-live person will answer your call and help to direct you to the proper person. We have factory-direct customer service representatives that are available to answer questions, help with replacements parts or field inquiries about installations.

YOUR BURKE REPRESENTATIVE

We as Burke Representatives are passionate about bringing play to your community and helping you design your perfect play environment! We are knowledgeable and experienced about the entire playground process from site evaluation to design to maintenance and will work with you beyond installation to make sure your playground is, and remains, all you dreamed!

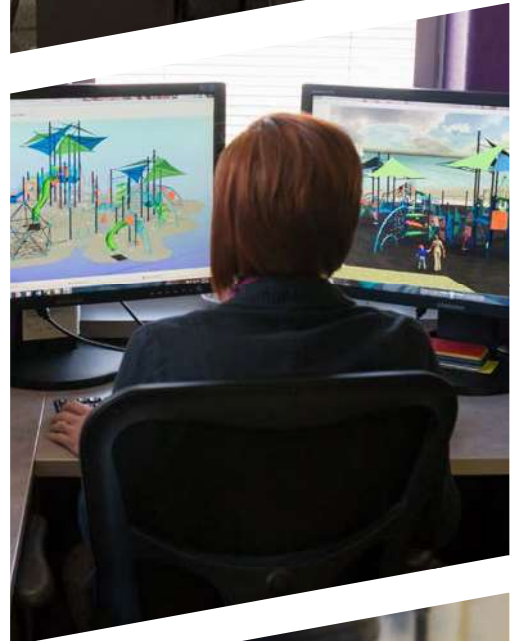

BURKE'S HISTORY

John Edward was a farmer in Fond du Lac, Wisconsin and farmed the land the Burke company headquarters stands on today. In 1920, he incorporated a weather-stripping company that quickly expanded to include the design and production of designer radiator furniture. After receiving a request to fabricate a slide for a family friend, Burke entered the playground industry! Soon playground products were the company's main focus and they introduced Swing King, a residential line of play equipment.

When World War II began, Burke, like many companies, changed their focus to the war effort. J. E. Burke, always an inventor, devised a self-contained ammunition cart that could be parachuted to army personnel. The Parachute, as it was suitably named, was also used to deliver food and medical supplies. The company's dedication earned special recognition, and in 1943, the J.E. Burke Company was awarded an Excellence in War Production citation. Over the next 40 years, the Burke family grew the business and began to add interesting color and material combinations. In 1972, Burke invented the original Funnel Ball® that became a staple on playgrounds across the country.

In the late 1990's, Greg Burke, grandson of founder J.E. Burke, determined it was time to find a successor to lead the business into the 21st Century. Tim Ahern became the president/CEO of Burke in 1997 and remained until 2015 when Incline Equity Partners invested in Burke and Michael Phelan became the new president/CEO.

Most recently, in May 2017, The Halifax Group joined Burke's management team as an investment partner to continue the company's growth plans. All design and manufacturing operations continue to be located in Fond du Lac, Wisconsin on the same plot of land where J.E. Burke founded the company nearly 100 years ago.

Burke remains committed to the original innovation, customer service and superior quality that sustained the company for generations. We are bringing play to the next level with our focus on "Play That Moves You" and innovating products that move all of us in so many ways.



BURKE BUILT QUALITY

Discover the value of investing in a Burke Playground:

KOREKONNECT® DIRECT-BOLT CLAMP SYSTEM: Nucleus® and Voltage® feature our Industry-leading KoreKconnect direct-bolt clamp system resulting in the strongest and most accurate connection system ever. Factory located connection points make for easy, precise installation and an error-free fit. Best of all, KoreKconnect is covered for 100 years under our non-prorated Generations Warranty®.

DIRECT-BOLT CONNECTION SYSTEM: Intensity, ELEVATE® Fitness Course, ACTIVATE® Fitness Circuit and Little Buddies® feature Burke's trusted direct-bolt connection that uses a durable, straightforward direct-bolt system to ensure a trouble-free installation and provide the necessary strength to accommodate the demands of playing children. Like our KoreKconnect system, Direct-Bolt connections are covered for 100 years under our Generations Warranty.

EZKONNECT® DECK MOUNTING SYSTEM: Our exclusive self-leveling deck attachment and factory CNC construction allows for faster and more precise location of decks during installation. The 2-bolt per corner deck attachment increases overall structure strength and stability.

PLATFORMS: Burke's oversized non-slip platforms are constructed of heavy-duty punched steel that can support more than 2 tons. Our vinyl coating is California compliant, free of lead and other hazardous heavy metals.

TAMPER-RESISTANT STAINLESS STEEL HARDWARE: All hardware is covered for 100 years under our Generations Warranty.

PREMIUM POWDER COATINGS: Our industry-leading powder coatings and finishes prevent fading, last longer and deter rust. We also offer a "coastal package" powder coat system. This special powder coat system for metal components and upright posts will provide additional corrosion and chemical protection along with added longevity to the color and gloss retention of the powder coated parts. Contact your Burke Representative for more information on colors, price and warranty.

COMPOUND PLASTICS WITH UV-16: You'll get long wear and bright, vibrant colors that hold up for years thanks to our thick, durable rotomolded plastics with UV-16 protection. This is why we can cover them for 15 years under our non-prorated Generations Warranty.

CLIMBING CABLES: Our climbing cables are flexible enough to provide movement, yet strong enough to last. Our ropes are made from 6 polyester cords with steel reinforcement wrapped around a synthetic fiber core. Each cord contains 8 galvanized steel strands tightly covered with polyester multi-fibers. Our RopeVenture® cables consist of 6 strands, each containing 24 stainless steel reinforcing strands within a nylon sleeve, wrapped around a solid nylon core.

ALUMINUM CONNECTORS: Swivel connectors at the end of our ropes allow assembly at any angle with no unwanted twists in the net. The aluminum fittings used to secure the joints are swaged in place to prevent any movement between the rope and fittings that could cause wear.



FREE RESOURCES

NPPS SAFETY KIT

Burke truly gives you the most value for your money. As part of our Total Cost of Ownership Package, we offer value-added resources FREE with every playground structure purchase. The National Program for Playground Safety (NPPS) Playground Supervision Safety Kit helps supervisors and educators be prepared on the playground. Learn more at bciburke.com/safety.

CUSTOM MAINTENANCE KIT

To help maintain a safe, functioning playground we include a custom maintenance schedule, touch-up paint, graffiti remover and carrying case FREE with every playground structure purchase.

PLANNING & FUNDING TOOLS

We provide you with FREE tools to plan your playground from fundraising and design to installing a community build playground. At Burke, we understand the dedication and hard work it takes to raise the funds for playground equipment. That's why we created Funds for Fun, a direct donation fundraising program to help your organization raise the funds it needs for your new playground. We've also partnered with The School Funding Center to provide up-to-date grant information along with expert grant writing services. Learn more at bciburke.com/funding.



FREE FUNDRAISING TOOLS!



BURKE GENERATIONS WARRANTY®

The Longest and Strongest warranty in the industry

BCI Burke Company, LLC ("Burke") warrants that all standard products are warranted to be free from defects in materials and workmanship, under normal use and service, for a period of one (1) year from the date of shipment.

We stand behind our products.

In addition, the following products are warranted, under normal use and service from the date of shipment as follows:

- One Hundred (100) Year Limited Warranty on aluminum and steel upright posts (including Intensity®, Synergy™, Nucleus®, Voltage®, Little Buddies®, ELEVATE®, ACTIVATE®, INVIGORATE™) against structural failure due to corrosion, deterioration or workmanship.
- One Hundred (100) Year Limited Warranty on KoreConnect® clamps against structural failure due to corrosion, deterioration or workmanship.
- One Hundred (100) Year Limited Warranty on Hardware (nuts, bolts, washers)
- One Hundred (100) Year Limited Warranty on bolt-through fastening and clamp systems (Synergy™, Intensity®, Nucleus®, Voltage®, Little Buddies®, ELEVATE®).
- Twenty-Five (25) Year Limited Warranty on spring assemblies and aluminum cast animals.
- Fifteen (15) Year Limited Warranty on structure platforms and decks, metal roofs, table tops, bench tops, railings and barriers against structural failure due to materials or workmanship.
- Fifteen (15) Year Limited Warranty on all plastic components including StoneBorders against structural failure due to materials or workmanship.
- Ten (10) Year Limited Warranty on ShadePlay Canopies fabric, threads, and cables against degradation, cracking or material breakdown resulting from ultra-violet exposure, natural deterioration or manufacturing defects. This warranty is limited to the design loads as stated in the specifications.
- Ten (10) Year Limited Warranty on NaturePlay® Boulders and GFRG products against structural failure due to natural deterioration or workmanship. Natural wear, which may occur with any concrete product with age, is excluded from this warranty
- Ten (10) Year Limited Warranty on Full Color Custom Signage against manufacturing defects that cause delamination or degradation of the sign. Full Color Custom Signs also carry a two (2) year warranty against premature fading of the print and graphics on the signs.
- Five (5) Year Limited Warranty on Intensity® and RopeVenture® cables and LEVEL X® flex bridge against premature wear due to natural deterioration or manufacturing defects. Determination of premature wear will be at the manufacturer's discretion.
- Five (5) Year Limited Warranty on moving parts, including swing components, against structural failure due to materials or workmanship.
- Five (5) Year Limited Warranty on PlayEnsemble® cables and mallets against defects in materials and workmanship.
- Three (3) Year Limited Warranty on electronic panel speakers, sound chips and circuit boards against electronic failure caused by manufacturing defects.

The warranty stated above is valid only if the equipment is erected in conformity with the layout plan and/or installation instructions furnished by BCI Burke Company, LLC using approved parts; have been maintained and inspected in accordance with BCI Burke Company, LLC instructions. Burke's liability and your exclusive remedy hereunder will be limited to repair or replacement of those parts found in Burke's reasonable judgment to be defective. Any claim made within the above stated warranty periods must be made promptly after discovery of the defect. A part is covered only for the original warranty period of the applicable part. Replacement parts carry the applicable warranty from the date of shipment of the replacement from Burke. After the expiration of the warranty period, you must pay for all parts, transportation and service charges.

Burke reserves the right to accept or reject any claim in whole or in part. Burke will not accept the return of any product without its prior written approval. Burke will assume transportation charges for shipment of the returned product if it is returned in strict compliance with Burke's written instructions.

THE FOREGOING WARRANTIES ARE EXCLUSIVE AND IN LIEU OF ANY OTHER WARRANTY, EXPRESS OR IMPLIED, INCLUDING BUT NOT LIMITED TO ANY IMPLIED WARRANTY OF MERCHANTABILITY OR FITNESS FOR A PARTICULAR PURPOSE. IF THE FOREGOING DISCLAIMER OF ADDITIONAL WARRANTIES IS NOT GIVEN FULL FORCE AND EFFECT, ANY RESULTING ADDITIONAL WARRANTY SHALL BE LIMITED IN DURATION TO THE EXPRESS WARRANTIES AND BE OTHERWISE SUBJECT TO AND LIMITED BY THE TERMS OF BURKE'S PRODUCT WARRANTY. SOME STATES DO NOT ALLOW THE EXCLUSION OF CERTAIN IMPLIED WARRANTIES, SO THE ABOVE LIMITATION MAY NOT APPLY TO YOU.

Warranty Exclusions: The above stated warranties do not cover: "cosmetic" defects, such as scratches, dents, marring, or fading; damage due to incorrect installation, vandalism, misuse, accident, wear and tear from normal use, exposure to extreme weather; immersion in salt or chlorine water, unauthorized repair or modification, abnormal use, lack of maintenance, or other cause not within Burke's control; and

Limitation of Remedies: Burke is not liable for consequential or incidental damages, including but not limited to labor costs or lost profits resulting from the use of or inability to use the products or from the products being incorporated in or becoming a component of any other product. If, after a reasonable number of repeated efforts, Burke is unable to repair or replace a defective or nonconforming product, Burke shall have the option to accept return of the product, or part thereof, if such does not substantially impair its value, and return the purchase price as the buyer's entire and exclusive remedy. Without limiting the generality of the foregoing, Burke will not be responsible for labor costs involved in the removal of products or the installation of replacement products. Some states do not allow the exclusion of incidental damages, so the above exclusion may not apply to you.

The environment near a saltwater coast can be extremely corrosive. Some corrosion and/or deterioration is considered "normal wear" in this environment. Product installed within 500 yards of a saltwater shoreline will only be covered for half the period of the standard product warranty, up to a maximum of five years, for defects caused by corrosion. Products installed in direct contact with saltwater or that are subjected to salt spray are not covered by the standard warranty for any defects caused by corrosion.

Contact your local Burke Representative for warranty information regarding Burke Turf® and Burke Tile products.

Terms of Sale

Pricing: Prices published in this catalog are in USD, are approximate and do not include shipping & handling, surfacing, installation nor applicable taxes. All prices are subject to change without notice. Contact your Burke representative for current pricing. Payments are to be made in USD.

Weights: Weights are approximate and may vary with actual orders.

Installation: All equipment is shipped unassembled. For a list of factory-certified installers in your area, please contact your Burke representative.

Specifications: Product specifications in this catalog were correct at the time of publication. However, product improvements are ongoing at Burke, and we reserve the right to change or discontinue specifications without notice.

Loss or Damage in Transit: A signed bill of lading is our receipt from a carrier that our shipment to you was complete and in good condition upon arrival. Before you sign, please check the Bill of Lading carefully when the shipment arrives to make sure nothing is missing and there are no damages. Once the shipment leaves our plant, we are no longer responsible for any damage, loss or shortage.

For more information regarding the warranty, call Customer Service at 920-921-9220 or 1-800-356-2070.

01/2020

COLORS THAT MOVE YOU

HDPE PLASTIC PANELS



POWDER COAT PAINT



SHADE CANOPIES

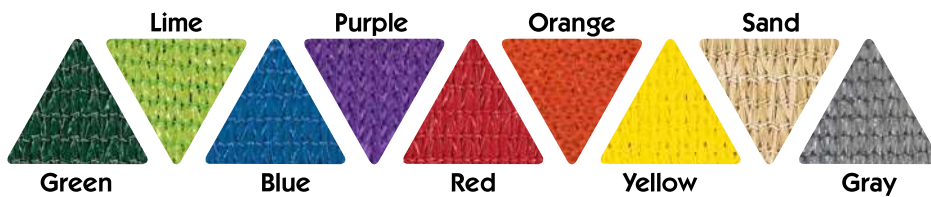

PLATFORMS

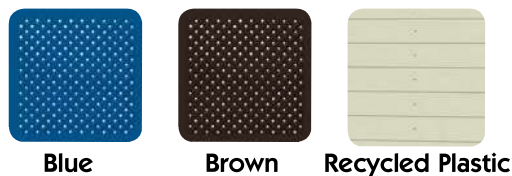

ROCKIT CLIMBERS

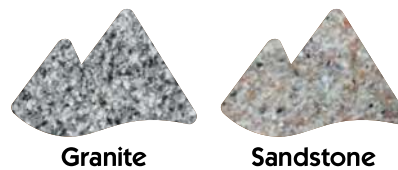

ROTOMOLD PLASTIC

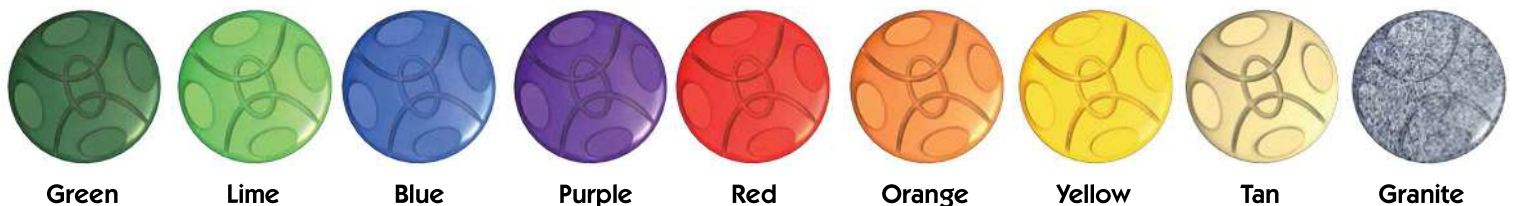

VISIT BCIBURKE.COM/COLORSELECTION TO CUSTOMIZE YOUR PLAYGROUND COLORS!

Next Steps – Please Contact

Chris Olsen and David Yosso

Specified Play Equipment Company

121 #1 Industrial Road Belmont, CA 94002

Contact Information

M: 650.863.5006-David

650.769.0775-Chris

O: (800) 475-1071

David@specplay.com

C.Olsen@specplay.com

Thank you!

www.SPECPLAY.com

