

# Spring 2021: Peninsula High School Return to School Plan

Updated Month XX, 2021

## Return to School Plan Overview

The administration and staff of Peninsula High School is committed to providing students with the best education possible - in a safe and healthy environment. As a result, we have crafted this DRAFT return to school plan. We are sure that this plan will continue to shift as we continue to learn more about the COVID-19 virus, how to maintain healthy classroom and campus environments, and as county and state regulations move in response to transmission rates and ICU capacities.

## Plan Topics

[Entrance, Egress, and Movement within the School](#)

[Campus Visitation](#)

[Health Screenings for Students and Staff](#)

[Face Coverings and Other Essential Protective Gear](#)

[Healthy Hygiene Practices](#)

[Physical Distancing](#)

[Classrooms](#)

[Cohorting and Phases for Return](#)

[Campus Supervision](#)

[Designated Brunch/Lunch Areas](#)

[Bell Schedule for Spring 2021](#)

[Restroom Assignments](#)

[Health Office and Safety](#)

[Cleaning and Disinfection](#)

[Communications Plans](#)

[Staff Training and Family Communication](#)

[Testing of Students and Staff](#)

[Communication Process for Covid and Related Covid Incidents](#)

[Identification and Tracing of Contacts](#)

[Triggers for Transitioning to Distance Learning](#)

[Glossary of Terms](#)

[Resources](#)

[Appendices](#)

- Site Contact Information
- Site COVID Team
- COVID-19 Expectation and Responses
- Bell Schedule Overview
- Basis for Bell Schedules and Classroom Consideration

## Entrance, Egress, and Movement within the School

### Entering and Exiting the Classroom: Beginning of the day:

- Students will bring all their belongings with them to the classroom. Students will be asked to only bring essential items to and from school each day.
- Students and adults must wash their hands and/or sanitize their hands before they enter the classroom.
- Once their hands are washed, students place their coats on the back of their chair.
- Access to hand-sanitizer and disinfectant wipes.

### Entering and Exiting the Classroom: During the Day:

- Students and adults must wash their hands and/or sanitize their hands before they enter the classroom; this is at the beginning of the day, after brunch/lunch, after using the bathroom or any other time they enter the room.
- Students and adults must wash their hands and/or sanitize when they exit the classroom; this is at the end of the day, before and after going to brunch/lunch, after going to the bathroom or any other time they leave the room.
- Access to hand-sanitizer and disinfectant wipes.

## Campus Visitation

All visitors are required to complete health screenings and enter at the designated entry. The entry station will be staffed throughout the day by a trained staff member. If the check is successful, that person will be directed to the designated location.

In general:

- On campus visitation is discouraged unless necessary
- Drive through procedures are encouraged for distribution of materials
- Doorbells will be used where installed to notify office staff of visitor arrivals
- Vendors are encouraged to make appointments and arrange access with Operations
- Conferences with families should be conducted through Zoom or Google Meet
- Sign in and out of our visitor log in the main office

Below are the common visitor scenarios:

- **Student picking up learning materials in-person** will follow the directional map to the designated area to pick up materials (student provided wristband after successful screening)
- **Parent/guardian picking up learning materials** - same as above.
- **Student picking up work permit, pictures, or other similar item** will be directed to the Main Office (health screening staff member will radio Main Office); Main Office staff member to greet at the door (Main Office doors to be kept locked regularly)
- **Member of the public picking up a transcript** - same as student picking up work permit, pictures, etc.
- **Deliveries** (outside vendors - e.g. UPS, USPS) - if entrance is necessary, the driver will complete health screening. If successful, the driver will place items in designated hallways.

Delivery drivers for Operations and Nutrition departments will be health screened by the department leads before drop-offs.

- **Campus Hours** - The Main Office will be open at selected times throughout the week for the public. Staff members are expected to leave campus by 5:30 pm to allow for sufficient sanitization time. Students are expected to exit campus after their last class, except those engaged in supervised extracurricular activities.

## Health Screenings for Students and Staff

Students and staff arriving at school will be greeted at the main entrances with adequate separation and undergo a health and safety check. All Staff Members and students must be health screened (temp check and COVID exposure-related questions) before entering campus. This is at our front doors and the infrared temperature screener is in front of the first hallway.

The health and safety check will include taking the temperature of students and staff, completing a health screening, and completing a visual inspection of students and staff for signs of infection. Once completed, students and staff may go to their classroom spaces. We will also monitor temperatures throughout the day.

All staff members and students must follow health and safety protocols at all times (i.e., face coverings, physical distancing). Per our handbook any student or staff member with a mask not covering the mouth AND nose will be warned once and sent home on second violation.

If a student or adult's temperature is above 100.4F/38C, they will be excluded from participation in our school day.

Over 95% of our students attend school through bus transportation. Bus drivers will check student's temperature prior to allowing them on the bus and continuing their route. It is vital that parents/guardians keep students at home if they are sick or until a fever has been gone for at least 72 hours without the use of medicine. Regular communication will be shared with Peninsula High School families and posted on our website.

Parents/Guardians should not bring their student to school or allow them to take the school bus if they have any COVID-19 associated symptoms or a fever.

Parents/Guardians should not bring their students to school or allow them to take the school bus if they OR ANYONE the child lives with developing COVID-like symptoms. This includes: cough, shortness of breath/difficulty breathing, or fever, chills, repeated shaking with chills, muscle pain, headache, sore throat, new loss of taste or smell. Anyone showing symptoms of illness must remain home.

## Face Coverings and Other Essential Protective Gear

### Face Coverings:

- Students and staff are required to bring and wear personal face coverings to all SMUHSD campuses

- Choose a mask that covers your nose and mouth, goes under your chin, and fits snugly against the sides of your face
- Wash your hands before putting on a mask
  - Do not touch the mask when wearing it
- [Face coverings](#) will be required to be worn by all at all times
- Extra face coverings will be available when needed or requested
- Accommodations may be available for those with medical conditions or behavioral concerns with alternative protective wear.
- School branded face coverings will be distributed to staff and students when on site during the initial return phase to campus.
- Those using cloth face coverings will be instructed to wash them daily.

### **Essential protective equipment:**

- Plexiglass shields have been installed at clerical stations and other desks as needed, such as teacher stations.
- Protective suits available for custodial and health staff
- Gloves available for cleaning in classrooms
- Signage highlighting the four pillars have been posted throughout campus in English, Spanish, and Mandarin:
  - Hand hygiene
  - Face coverings
  - Six foot distancing
  - Directional travel arrows
  - Virus prevention
  - Cleaning and disinfecting

Students and staff face covering use will be monitored by staff and administration. Students who violate face covering requirements will be referred to site administration for follow-up. Progressive discipline will be followed using [COVID-19 Expectations and Responses](#).

## **Healthy Hygiene Practices**

### **Hygiene Routines:**

- Hand sanitizer will be required to be used when entering and exiting all locations for staff and students.
- If hands are soiled washing with soap and water will be required and available.
- Washing hands with soap at least every 2-3 hours (with hand sanitizer as an alternative) will be expected.
- Proper hygiene etiquette will be expected, such as covering the mouth when sneezing/coughing.
- Touchless hand sanitizer stations and sanitizers in classrooms and work areas have been installed.

**Sanitizing and Disinfecting Materials:**

- Disinfecting wipes and hand sanitizer will be provided to all departments and in common spaces.
- Proper use of wipes and hand sanitizers will be incorporated into student and employee training.
- Communication for students and families about cleaning and hygiene practices will be provided at regular intervals.

**Physical Distancing****Physical Distancing Expectations**

- All students and staff will be required to maintain a minimum of 6 feet of physical distancing at all times
- When physical distancing is not possible other supplemental measures of safety will be assessed and offered as identified.

**Learning Spaces / Desks:**

- Desks will be placed 6'-14' apart to allow for adult staff to walk between students and still maintain physical distancing requirements.
- Desks will be numbered for student assignment
- Students are required to use the same assigned desk every day.
  - This will support attendance taking.
  - This will allow the school the opportunity to implement contact tracing

**Classrooms**

For each period, students will be provided a consistent assigned seat. Desks have been marked to ensure physical distancing at a minimum of six feet. Where classrooms have two doors, one will be designated for entrance, while the other will be used as an exit. Learning spaces will be stocked with hand-sanitizer, gloves, and disinfectant wipes.

**Classroom Expectations Around Use of Materials:**

- Teachers and students will help maintain sanitizing the classroom and materials. Students cannot use the disinfectant spray but will be given wipes.

**Chromebooks:**

- Must NOT be shared while using and wipe down after each use if borrowed from chrome cart.
- Need to be wiped before and after use several times daily with wipes.
- Students must wash hands before and after use or use hand sanitizer.
- Chromebook management -plan for use/charging. Most students bring their own assigned chromebook but those rented out are disinfected prior and upon return to technology department, Lee Miller.

**Passing period protocols:**

- **Between Classes - Students:**

- Follow hallway protocols - walk on the right side of the hallway.
- Wear a face covering over your nose and mouth at all times.
- Maintain a six foot minimum physical distance at all times.
- Stretch break OUTSIDE - vacate the indoor spaces during breaks and lunches to allow for proper airflow.
- Use of Sanitation Station / Handwashing

- **Between Classes - Faculty/Staff:**

- Open classroom doors
- Assist with hallway monitoring: specifically, students walking on the right side of the hallways, wearing face coverings, and following physical distancing requirements.
- Wear a face covering over your nose and mouth at all times.
- Maintain a six foot minimum physical distance at all times.

## **Cohorting and Phases for Return**

### **Staff**

No more than 25 staff members on campus per day.

### **Students**

No more than 120 students on campus per day.

A Stable Cohort refers to a defined group of students whose size is dictated by the ability to implement physical distancing within the designated classroom environment or primary learning setting. Below is a sample of what spacing could look like and possible different locations of staff members' desks to supervise the space.

The Peninsula High School Pod Cohort provides for a smaller group of students (maximum of 14), plus staff members (Could be teacher/administrator/classified personnel), to exist within a defined location with no mixing between any other groups or individuals for a period of three weeks.

Peninsula staff must remain solely with their Pod Cohort, and if a child is absent, another student new to the cohort may not fill their space.

The Peninsula Pod Cohort will be used and implemented with physical distancing within the classroom setting.

### **Configuring Space:**

Classroom spaces have been specifically arranged to maximize the floor space and promote physical distance among students. We have measured and adjusted the layout of all of our learning spaces across the school (classrooms and specialist areas) to ensure the provision of separation between students of at least 6ft. Here is a floor plan example:

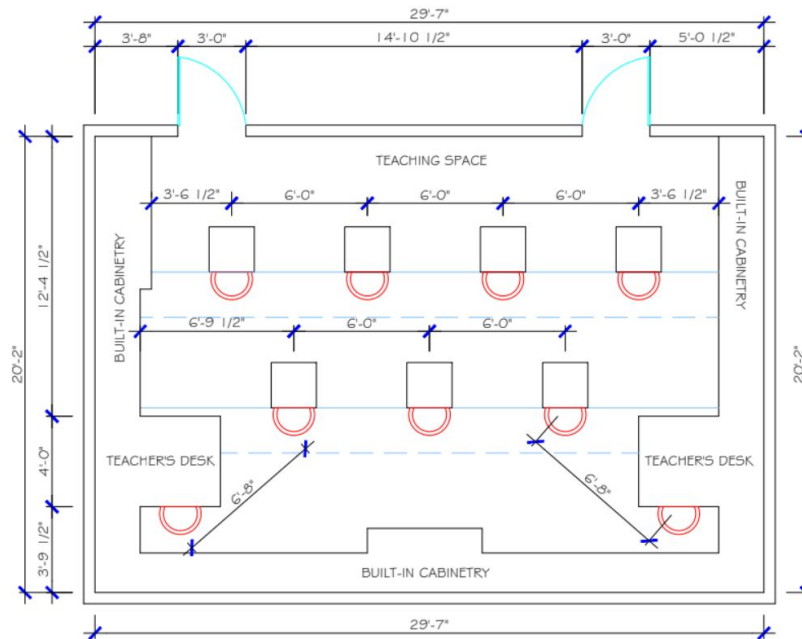

The Stable Pod Cohort aims to minimize mixing of the group members with others, but allows for necessary and practical considerations in a student's educational program with a maximum of 14 students.

The intent of the Stable Pod Cohorts is to create as stable an environment as is practicable by reducing numbers of students and the movement of students across campus.

In an effort to reduce the volume of students on campus each day to below 30% of total students, cohorting will consist of two student groups. In configuration, students will have the choice to 'OPT-IN' to in-person instruction or remain virtual synchronous learning. Students opting in will be placed on an 'A' or 'B' rotation. Students choosing to continue their learning completely synchronously will be placed in the 'C' rotation.

### In-Person Phase 1:

Students in specialized programs will return to campus for some in-person instruction.

- **Staff:** up 40 staff members on campus daily
- **Students:** up to 100 students on campus daily

### In-Person Phase 2:

Students enrolled in Bridge, Peninsula High School, Middle College and Various Enrichment Programs will return to campus for some instruction.

- **Staff:** up to 60 staff members on campus daily
- **Students:** up to 200 students on campus daily

### In-Person Phase 3:

All students who opt for in-person instruction\* will return to campus for some in-person instruction through a hybrid A/B Cohorts instructional schedule.

- **Staff:** Up to 120 staff members on campus daily 100%
- **Students:** up to 300 students daily or less than 30%

**Staff:**

- Teachers, Classified and Administration will be on campus on their assigned days.
- A team of campus supervisors will support each learning pod or cohort.
- The number of campus supervisors will be based upon the number of students allowed to be on campus.
- Additional staffing will be required to support classes where teachers are teaching from home. This may include substitute teachers.

**Campus Supervision**

One Campus Safety Specialist will be on campus each day to supervise staff and students. Each will be trained on the practices included within this reopening plan to ensure that they can successfully support health and safety practices. During opening, transition, and closing periods, staff and members of the administrative team will provide additional support and supervision. Screening stations will be staffed daily (additional staff may be necessary).

During class periods, teachers will be responsible for the supervision of those students who are enrolled in their class. Where a teacher receives an accommodation to continue working from home, the District will provide a substitute teacher to supervise the class, while students engage in virtual learning within the classroom.

**Designated Brunch/Lunch Areas/Times**

- All Peninsula High School students will eat their snacks in their designated classroom/area.
- All students and staff will wash their hands or use hand sanitizer before and after eating snack/lunch.
- Students must maintain 6-foot distance when utilizing exercise spaces and will be limited to pre-designated spaces.
- Football, Basketball, and Soccer will not be permitted until conditions have significantly improved.

**Lunchtime Routines:** If weather is raining or unsafe for students to be outdoors)

- All students will eat lunch in their designated classroom.
- All students and staff wash their hands before and after eating lunch.
- Faculty and staff use the provided disinfectant to thoroughly clean classroom desks after
- Students will be supervised by administration, health aide, and campus aide to take off their face coverings for lunch and once finished eating will be asked to put their face covering back on.
- Sharing of food will be prohibited.



## Break and Lunch Protocols

- **At Break & Lunch - Students:**

- Wear a face covering over your nose and mouth at all times when not actively eating/drinking.
- Maintain a six foot minimum physical distance at all times.
- Stretch break OUTSIDE - vacate the indoor spaces during breaks and lunches to allow for proper airflow.
- Access to alternate outdoor spaces delineated for their pod area:
- Designated picnic benches / other outdoor seating
- Designated grassy spaces
- Use of bathrooms
- Use of Sanitation Station / Handwashing - after break
- In some phases of our bell schedule, classes will be staggered to halve the number of students out at lunch the same time.

- **At Break & Lunch - Classified & Administrative Staff:**

- Classified staff will be assigned to strategic locations in Center Court to support students in following safety protocols.
- Administrators will be out on campus to support students in following safety protocols.
- Teachers are also asked to assist with clearing the hallways at break only; all teachers will have their guaranteed 30-minute duty-free lunch

## Bell Schedule for Spring 2021

In this bell schedule configuration, all students are learning with their teachers in a synchronous model, using connectivity services such as Zoom to conduct classes.

<https://www.remind.com/join/pumas20-21>

## Asynchronous Fridays

- Fridays are Asynchronous Work Days (No Zoom Classes).
- Students are expected to work on their assignments in order to be marked present.
- Go to this document [<CLICK HERE>](#) to receive your assignments for each of your classes.

Bell Schedule		
Monday - Thursday		Friday (Asynchronous)
Period 1	9:00 - 9:37 a.m.	9:00 a.m. -12:00 p.m. Teacher Office Hours Email your teacher if you wish to meet with them on Zoom  12:45 - 3:15 p.m. PLC/ Teacher Collaboration Time
Period 2	9:42 - 10:19 a.m.	
Brunch	10:19 - 10:34 a.m.	
Period 3	10:39 - 11:16 a.m.	
Period 4	11:21 - 11:58 a.m.	
Period 5	12:33 - 1:10 p.m.	
Period 6	1:15 - 1:52 p.m.	

## Restroom Assignments

- Restroom physical spacing will be followed including disabling every other stall, urinal, and sink.
- All restrooms will be cleaned/disinfected between each class period or hourly.
- All touch points will be disinfected.
- One to two students at a time in each restroom determined by size of restroom.

## Health Office and Safety

The Health Office will operate adjacent to the Main Office. A quarantine area for students will exist allowing accessibility to the parking lot). Pop-up tents will be utilized in the situation where overflow is necessary to ensure adequate social distancing.

## Cleaning and Disinfection

The District has directed custodians to 1) conduct more frequent cleanings throughout the day in public spaces and common areas, as well as 2) use EPA-approved germicide/disinfectant.

### Cleaning and disinfecting:

- Place hand sanitizer dispensers in lobbies/common areas
- Prop doors open to reduce touching of handles as appropriate
- Provide disinfectant wipes in appropriate locations; post signage advising occupants to sanitize touch surfaces before and after each use
- Publicize frequency and scope of cleaning and disinfection
- Cleaning and disinfecting supplies are properly stored
- Schools have an established cleaning and disinfecting schedule
- High traffic areas are cleaned regularly
- Commonly used surfaces are frequently disinfected
- Shared equipment is disinfected or quarantined between uses
- Schools have a detailed cleaning and disinfecting plan for infected spaces
- Proper cleaning procedures will be incorporated into student and employee training
- Schools are disinfected nightly using Clorox 360 machines and #49
- Training on cleaning, disinfecting and safety protocols will be provided by Operations to ensure the safe and effective use of our facilities and equipment.
- We will follow the EPA's [Six Steps for Safe & Effective Disinfectant Use](#).

### After Occupied Hours/Night Shift

- All areas that were occupied during the day will be thoroughly cleaned.
- Trash will be removed.
- Floors will be dust mopped and spot mopped as needed.

- All areas will be disinfected using electrostatic sprayers.
- Phones, computers, and other equipment must be disinfected after use and only shared if necessary based on equipment (i.e. printers, copy machines).

## Communication Plans

As the school prepares to shift phases, we will work with families to communicate as effectively as possible.

### Outreach and communication will include:

- Additional Q&A sessions with the entire campus community - offered with simultaneous translation.
- This report will be available on our website with automatic translation into any language offered by the web service.
- Opportunities for students to opt-in to in-person learning in three-week periods (as we prepare to implement Phase 3).

## Staff Training and Family Communication

### Student Training and Family Communication

Aeries Communication and Canvas will be used to provide specific education and instructions for students, parents, and guardians on the implementation and enforcement of this reopening plan. These communications will include written and screencast instructional videos that will be available on the school website in multiple languages and will include instructions regarding entering campus, health screening, wearing face masks over the mouth and nose at all times, maintaining six feet of physical distancing at all times, students sitting at their assigned desk (work/study/station), and students following directional maps and signage.

Teachers will review safety practices with students daily. Safety reviews will include proper safety etiquette and proper hygiene practices, distance monitoring, appropriate movement around campus, and directions for lunch and restrooms.

### Staff Training

- Mandatory training will be provided for practices related to hygiene, face coverings, physical distancing, and limited gatherings
  - In addition to site/classification specific training
- All employees will complete the following trainings, among other required trainings:
  - Coronavirus 103: Managing Stress & Anxiety (25 minutes)
  - Coronavirus 105: Cleaning & Disinfecting Common Spaces (25 minutes)
  - Coronavirus 106: CDC Guidelines for Using Cloth Masks (25 minutes)
  - Duty to Report: California Schools (30-40 minutes)
  - Bloodborne Pathogen (45 minutes)
- Supervisors will be trained regarding temperature taking and symptom checks

## Testing of Students and Staff

Students will be PCR tested for Covid-19 through a surveillance model. Students should be expected to be tested once every two weeks. Students who are at higher risk may have the option of more frequent testing.

Staff should be expected to be PCR tested twice a month. Testing will be facilitated through the school health aides and the district student health coordinator.

## Communication process for Covid-19 or possible Covid-19 related incidents

Positive Test Results are communicated in the following manner.

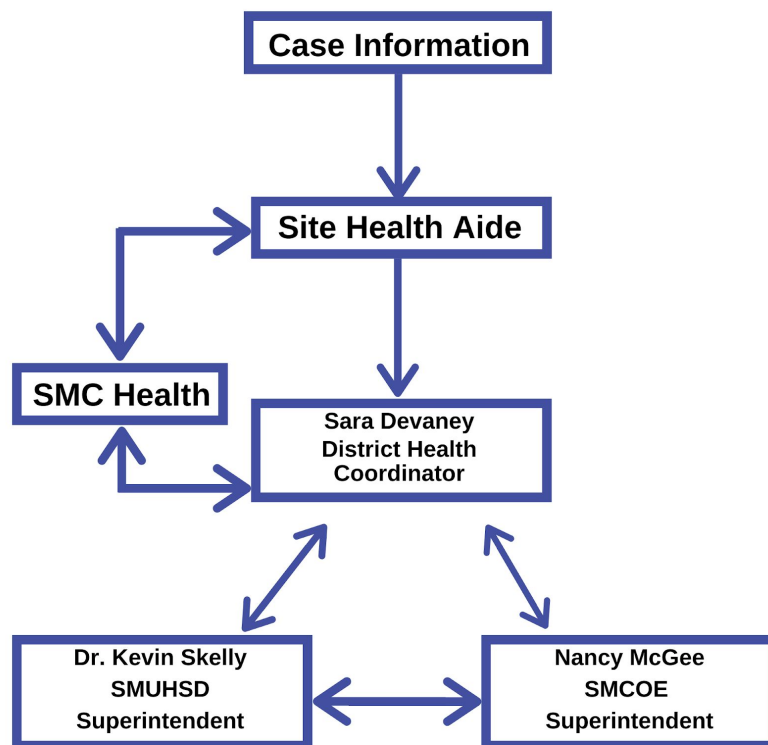

## Identification and Tracing of Contacts

### Case, Close Contact, Indirect Contact

To understand the continuum of health concern for members of the public regarding the contracting of COVID-19, the Pandemic Recovery Framework uses the terms Case, Close Contact, and Indirect Contact to mean the following within a pandemic context:

- **Case:** A Case refers to a person who tests positive
- **Close Contact:** A Close Contact refers to a person who is within 6 feet of a confirmed case for more than 15 minutes, regardless of face covering use.
- **Indirect Contact:** Indirect Contacts are people who may have been in proximity to a Close Contact

**Table 1: Steps to Take in Response to Confirmed or Suspected COVID-19 Cases and Close Contacts to Known COVID-19 Cases**

Scenario	Immediate Actions
<b>Scenario 1:</b> A student or staff member either exhibits COVID-19 symptoms, answers “yes” to a health screening question, or has a temperature of 100.4°F or above	<ul style="list-style-type: none"> <li>• Send home</li> <li>• Recommend testing (If positive, see Scenario 3; if negative, see Table 2)</li> <li>• School/classroom remain open</li> </ul>
<b>Scenario 2:</b> A family member of a student or staff member OR someone in close contact with a student or staff member (outside the school community) tests positive for COVID-19	<ul style="list-style-type: none"> <li>• Send home</li> <li>• Contacts should be quarantined for 14 days from the last exposure to the case</li> <li>• Testing can be considered but will not shorten 14-day quarantine.</li> <li>• One cannot test out of quarantine.</li> <li>• School/classroom remain open</li> </ul>
<b>Scenario 3:</b> A student or staff member tests positive for COVID-19	<ul style="list-style-type: none"> <li>• The school Principal or designee must immediately notify SMC CD Control</li> <li>• Case should be isolated and excluded from school for at least 10 days after symptoms first appeared and at least 3 days (72 hours) after recovery, or date of positive test if case is asymptomatic</li> <li>• Quarantine and exclude the affected cohort/pod for 14 days after the last day the case was present at school while infectious. Specific questions should be directed to SMC CD Control.</li> <li>• Testing of contacts can be considered. Symptomatic contacts should be prioritized for testing (but a negative test will not shorten 14-day quarantine)</li> <li>• Thorough cleaning and disinfecting of classroom and primary spaces where case spent significant time</li> <li>• Other cohorts/pods continue in-person instruction. I.e., the entire school does not need to close.</li> <li>• Send notification to affected cohort/pod</li> </ul>

**Table 2: Steps to Take in Response to Negative Test Results**

Scenario	Immediate Action
A symptomatic student or staff member tests negative for COVID-19 and was a household contact to a case	Student/staff must remain in quarantine for a full 14 days after the COVID-19 positive household member completes his/her isolation. One cannot test out of quarantine.
A symptomatic student or staff member tests negative for COVID-19 and was a non-household close contact to a case.	Student/staff must remain in quarantine for a full 14 days after the date of last exposure. One cannot test out of quarantine.
A symptomatic student or staff member tests negative for COVID-19 without close contact to a case.	Student/staff may return to school 72 hours after resolution of symptoms.
An asymptomatic student or staff member tests negative	Student/staff must remain in quarantine for a full 14 days

for COVID-19 and was a household contact to a case	after the COVID-19 positive household member completes his/her isolation. One cannot test out of quarantine.
An asymptomatic student or staff member tests negative for COVID-19 and was a non-household close contact to a case	Student/staff must remain in quarantine for a full 14 days after the date of last exposure. One cannot test out of quarantine.
An asymptomatic student or staff member tests negative for COVID-19 without close contact to a case	Can return to school/work immediately.
A symptomatic student or staff member who is not a close contact to a known COVID-19 case tests negative for COVID-19 after <b>Scenario 1</b>	Student/staff may return to school 72 hours after resolution of symptoms
A symptomatic or asymptomatic student or staff member who is a close contact to a known COVID-19 case tests negative after <b>Scenario 2</b>	Student/staff must remain in quarantine for a full 14 days after: <ol style="list-style-type: none"> <li>1. Date of last exposure to COVID-19 positive non-household close contact OR</li> <li>2. Date that COVID-19 positive household member completes his/her isolation. One cannot test out of quarantine.</li> </ol>
A staff member tests negative after routine surveillance testing (no symptoms and no close contact to a confirmed COVID-19 case)	Can return to school/work immediately.

## Triggers for Transitioning to Distance Learning

The school will reopen only upon approval of the site reopening plan by the San Mateo County Office of Education. The instructional schedule that will be used is one that can accommodate a switch from in-person hybrid instruction to complete distance learning. The school will follow the directives from the County and State regarding the need to transition from in-person instruction to a distance learning model. All students have been assigned personal computers and internet access assistance is available for all families.

Below is the guidance from the California Department Public Health that will be followed by the school and District.

### What are the criteria for closing a school to in-person learning?

Individual school closure, in which all students and staff are not on campus, is recommended based on the number of cases and stable groups impacted, which suggest that active in-school transmission is occurring. Closure should be done in consultation with the LHO. Situations that may indicate the need for school closure:

- Within a 14-day period, an [outbreak](#) has occurred in 25% or more stable groups in the school.
- Within a 14-day period, at least three [outbreaks](#) have occurred in the school AND more than 5% of the school population is infected.
- The LHO may also determine school closure is warranted for other reasons, including results from public health investigation or other local epidemiological data.

**Length of closure:** 14 days, or according to a decision made in consultation with the LHO.

The State Safe Schools for All Technical Assistance teams (TA teams), comprised of experts across multiple state agencies, will be available to assist schools with disease investigation for those with outbreaks that cannot find resources to investigate the outbreaks. The TA teams will also be available to help schools that close in order to identify and address any remediable safety issues.

### **If a school is closed, when may it reopen?**

Schools may typically reopen after 14 days and if the following have occurred:

- Cleaning and disinfection
- Public health investigation
- Consultation with the LHD

## **Glossary of Terms**

### **Educational Planning Terms:**

- **Asynchronous Learning:** Students have the ability to access information, demonstrate what they've learned, and communicate with classmates and instructors on their own time - they don't have to be in the same classroom or even in the same time zone to participate.
- **Independent Study (IS):** Students may elect to complete their full semester of a class, multiple classes, or all classes, using our fully asynchronous learning platform, Edgenuity. Students taking one or several (but not all) classes through Independent Study at AHS will be required to check in with their site-based IS teacher weekly. Students opting for a full IS program will check in weekly with a district-based IS teacher.
- **Synchronous Concurrent Learning:** Teachers will instruct in-person from their classrooms. Some students will be in-person in the classroom space, other students will engage in class through the use of virtual platforms (like Zoom) *at the same time*.
- **Virtual Synchronous Learning:** All students and teachers will engage in classroom activities using virtual platforms (like Zoom) at the same time.

### **County Covid Terms**

- **Confirmed Case of COVID-19 Infection:** Individual with positive COVID-19 molecular amplification laboratory testing result (e.g., PCR) or positive antigen testing result.
- **Suspected Case of COVID-19 Infection:** In the absence of a more likely diagnosis: *AT LEAST ONE* of the following criteria:
  - Fever ( $\geq 100.4$ ) AND Cough
  - Fever ( $\geq 100.4$ ) AND Shortness of breath
  - New loss of taste or smell
  - Painful purple or red lesions on the feet or swelling of the toes
  - Pneumonia
  - Acute Respiratory Distress Syndrome

*OR AT LEAST 2* of the following criteria:

- Fever ( $\geq 100.4$ )
- Chills

- Repeated shaking with chills (rigors)
- Cough
- Shortness of breath or difficulty breathing
- Chest pain with deep breathing
- Sore throat
- Hoarseness
- Muscle pain
- Malaise or fatigue
- Abdominal Pain
- Loss of appetite
- Nausea
- Vomiting
- Diarrhea
- Headache
- Altered mental status (confusion)
- Conjunctivitis (“pink eye”)
- Rash

- **Close Contact:** A person who is within less than 6 feet from a confirmed case for more than 15 minutes regardless of face covering use. In some school situations, it may be difficult to determine whether individuals have met this criterion and an entire cohort, classroom, or other group may need to be considered exposed, particularly if people have spent any time together indoors.
- **Isolation:** Isolation is used to separate people infected with a contagious disease (such as those who are sick with COVID-19 and those who have tested positive for COVID-19 but do not have any symptoms) from people who are not infected. People who are in isolation should stay home until it is safe for them to be around others. In the home, sick/infected individuals should separate themselves from others by staying in a specific “sick” room or area and using a separate bathroom if available.
- **Quarantine:** Quarantine refers to the practice of separating individuals who have had close contact with someone with a contagious disease such as COVID-19 from others. This is meant to interrupt disease transmission as people can be contagious before they develop symptoms and in the case of COVID-19 can be contagious without ever developing symptoms. People who are in quarantine should stay home until it is safe for them to be around others. They should stay home, separate from others, and monitor their health.

## Resources

- [San Mateo County Health - COVID-19 Recommendations Checklist](#)
- [San Mateo County Coalition for Safe Schools and Communities: Pandemic Recovery Framework](#)

## Appendices

### Site Contact Information

Main Office: 650-558-2499

Attendance Office: 650-558-2408

Health Office: 650-558-2408

### Site Covid Team

Principal: Ron Campana

Asst. Principals: Fred Wolfram

Senior Staff Assistant: Nora Barrientos

Ops. Maint. Employee, Lead: Dan Varela

Health Aide: Viliami Dauwe

Attendance Clerk: Viliami Dauwe



**Covid Team Responsibilities:**

- Collect information regarding COVID-positive staff and students - ensure sharing of information for appropriate health protocols.
- Identify shifting staffing needs and work with the district office to put substitutes in place as needed.
- Maintain stock of back-up PPE and sanitizing supplies for offices, bathrooms, and classrooms.

**COVID-19 Expectations and Responses**

It is **IMPERATIVE** that all students participating in learning on campus follow the health and safety guidelines included in this plan.

Students and families should be aware of the consequences for unsafe behaviors at school. Please review these [COVID-19 Expectations and Responses](#) that all schools within the SMUHSD are following during the Pandemic.