



# LONGFELLOW MIDDLE SCHOOL

## Berkeley Unified School District

Facilities Subcommittee Meeting  
June 1, 2021



**EXISTING CAMPUS 1ST FLOOR**

0' 10' 20' 30' 40'

**MAIN**  
3 Levels  
51,000 SQFT

**ADMIN**  
15,065 SQFT

**GYM**  
7,505 SQFT

**ANNEX**  
12,500 SQFT

**CAFETERIA**  
7,600 SQFT

DERBY STREET

WARD STREET

SACRAMENTO STREET

CALIFORNIA STREET

*Includes Building Footprint*



# INFRASTRUCTURE

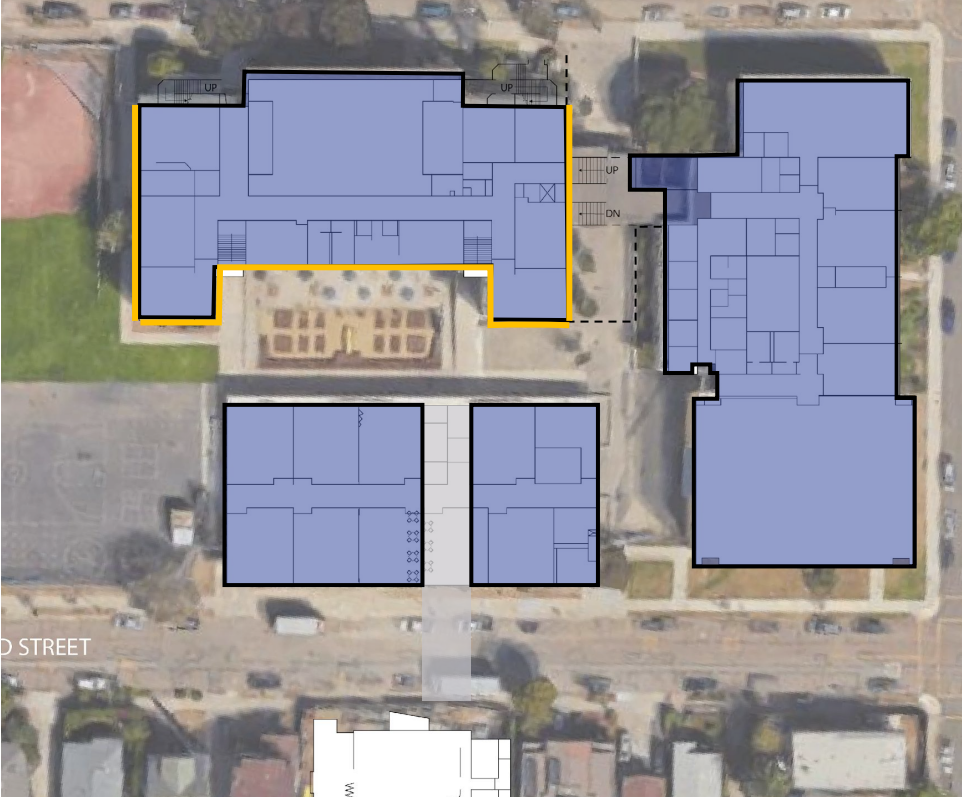



# CAREER TECHNOLOGY EDUCATION (CTE)

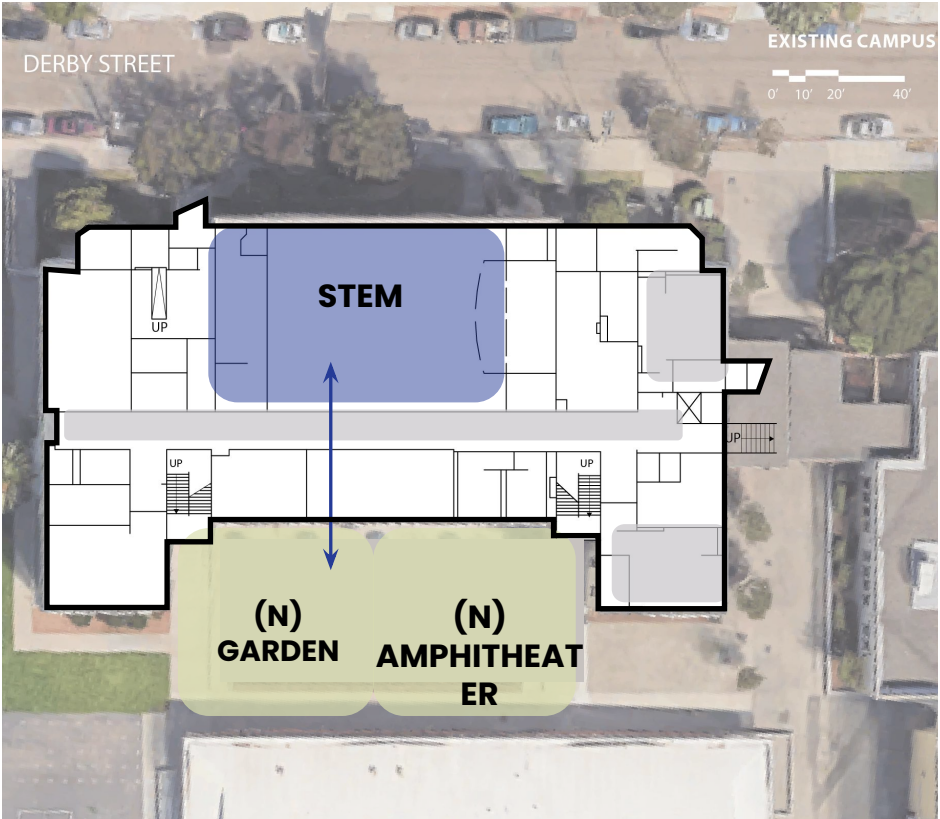



# SOLAR



ENERGY REDUCTION-LED LIGHTING



PHOTOVOLTAICS





# ADD PROJECT (MODERNIZATION)

gouldevans **BASE**



ADMINISTRATION OFFICE



FAMILY RESOURCE CENTER



CLASSROOM MODERNIZATION



RESTROOM MODERNIZATION





# CONCEPTUAL COST ESTIMATE

	<u>TARGET BUDGET</u>	<u>COST ESTIMATE</u>
INFRASTRUCTURE	\$5,194,670	\$5,053,855
CAREER TECHNOLOGY EDUCATION (CTE)	\$1,365,000	\$1,533,449
SOLAR	\$2,185,508	\$2,252,777
BOARD APPROVED-ADD PROJECT	<u>\$6,339,250</u>	<u>\$6,446,053</u>
SUB-TOTAL (HARD COSTS)	\$15,084,428	\$15,286,134
SOFT COSTS (35%)	<u>\$ 5,279.550</u>	<u>\$ 5,350,147</u>
TOTAL	\$20,363,978	\$20,636,281



# ENGAGEMENT SCHEDULE

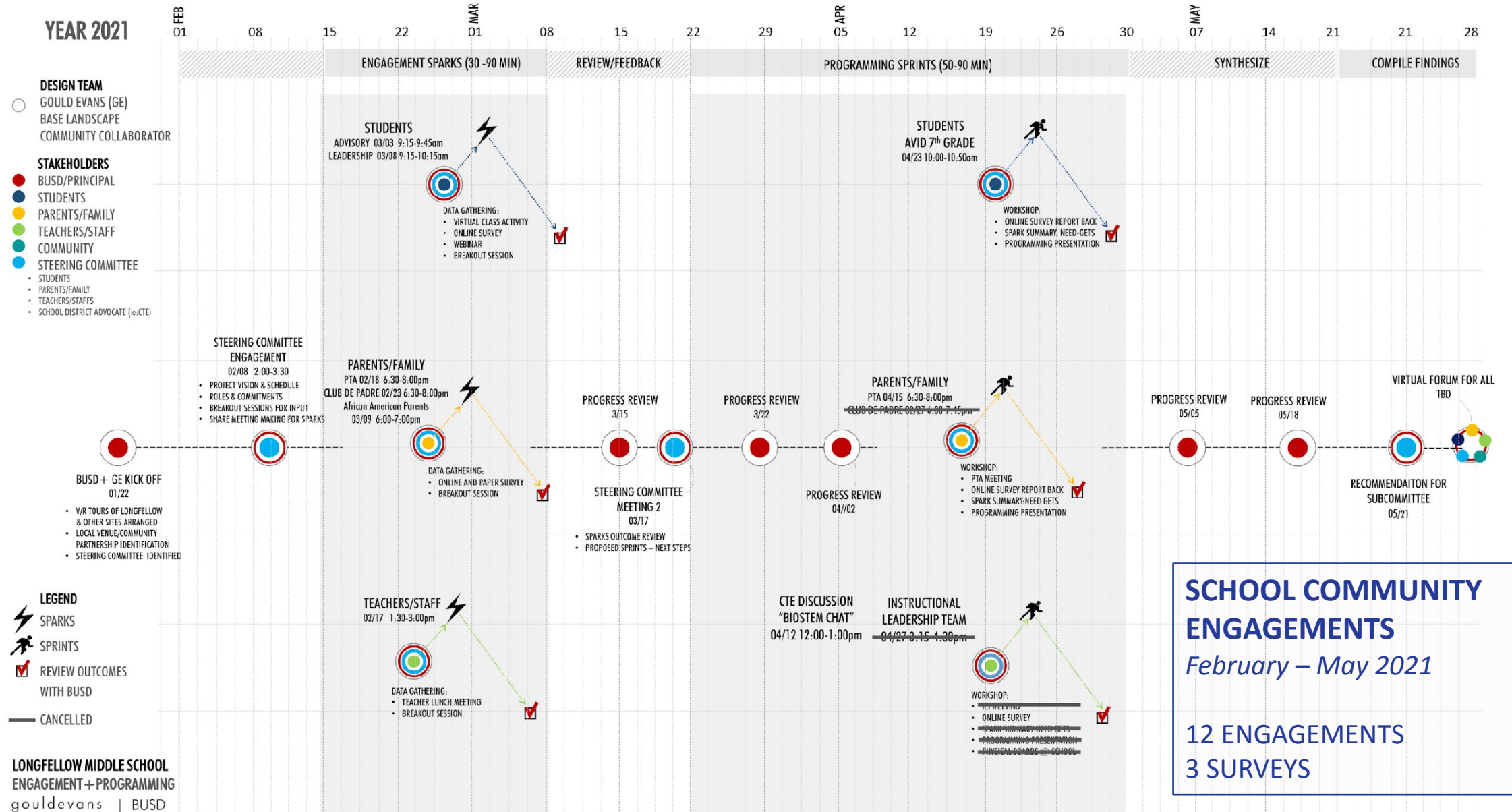



# ENGAGEMENT METHODS

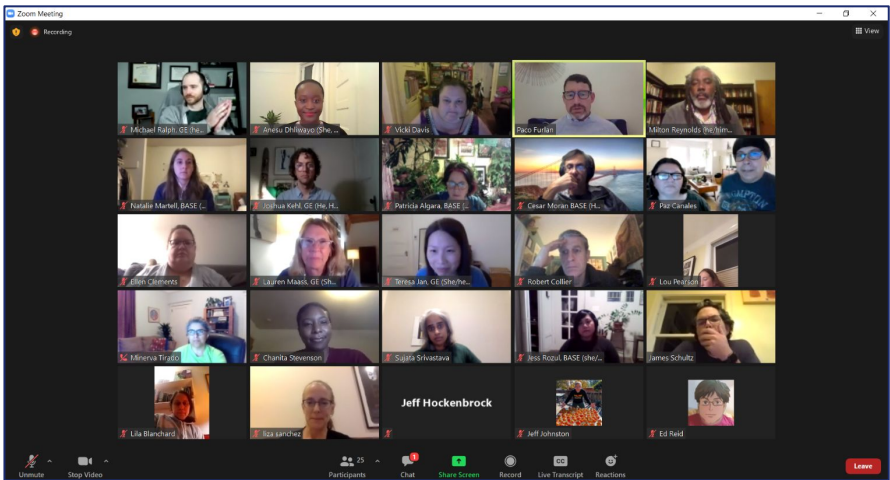

## COMMUNITY MEETINGS



## DIGITAL WHITEBOARDS

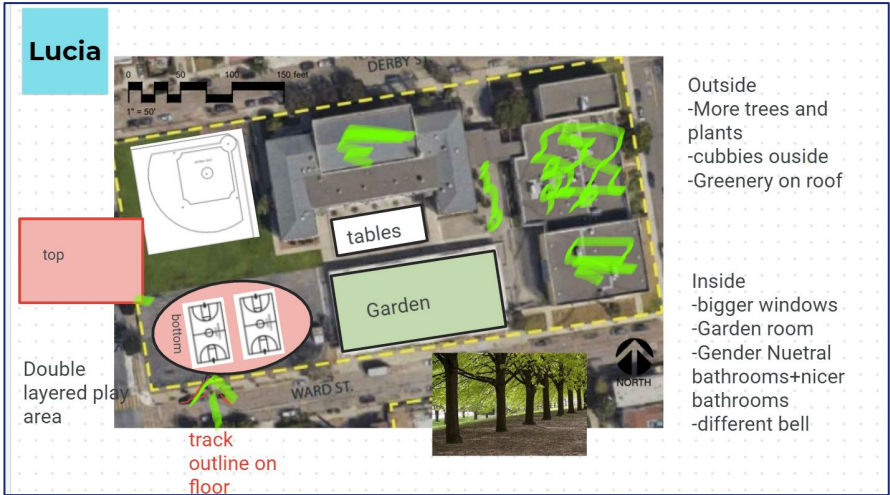

## STUDENT VISIONS

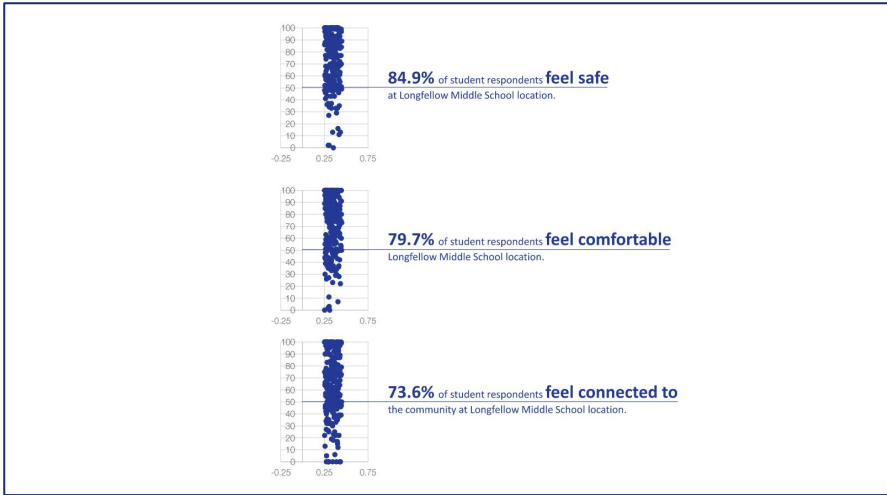

## SURVEYS



# NEED/GETS



**NEED #1:** A welcoming, aesthetically beautiful and dignified school campus.



**NEED #2:** A school with clear programming goals and facilities to support learning.



**NEED #3:** Campus needs to represent the Longfellow community.



**GET #1:** Campus oasis that reflects the Longfellow Community.



**GET #2:** Create a “heart” for LFMS to celebrate school programming.

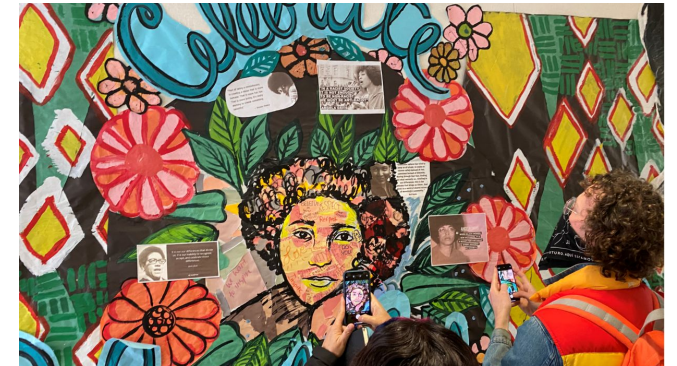

**GET #3:** Campus architecture and outdoor learning/ physical education spaces to represent the uniqueness of Longfellow.



# NEED/GETS



**NEED #4:** Variety of spatial experiences.



**NEED #5:** Modernization of Existing Buildings.



**NEED #6:** Outdoor athletic and physical education spaces that reflect school community interests and goals.



**GET #4:** Create experiential, flexible spaces that adapt.



**GET #5:** Healthy, sustainable and well-maintained facilities and buildings that support student learning.



**GET #6:** Create multi-use athletic facilities that focus on sports programming at Longfellow and supports community usage.



# SITE PLAN PROPOSED





# ENTRY PORCH & ADMINISTRATION





# FAMILY RESOURCE CENTER

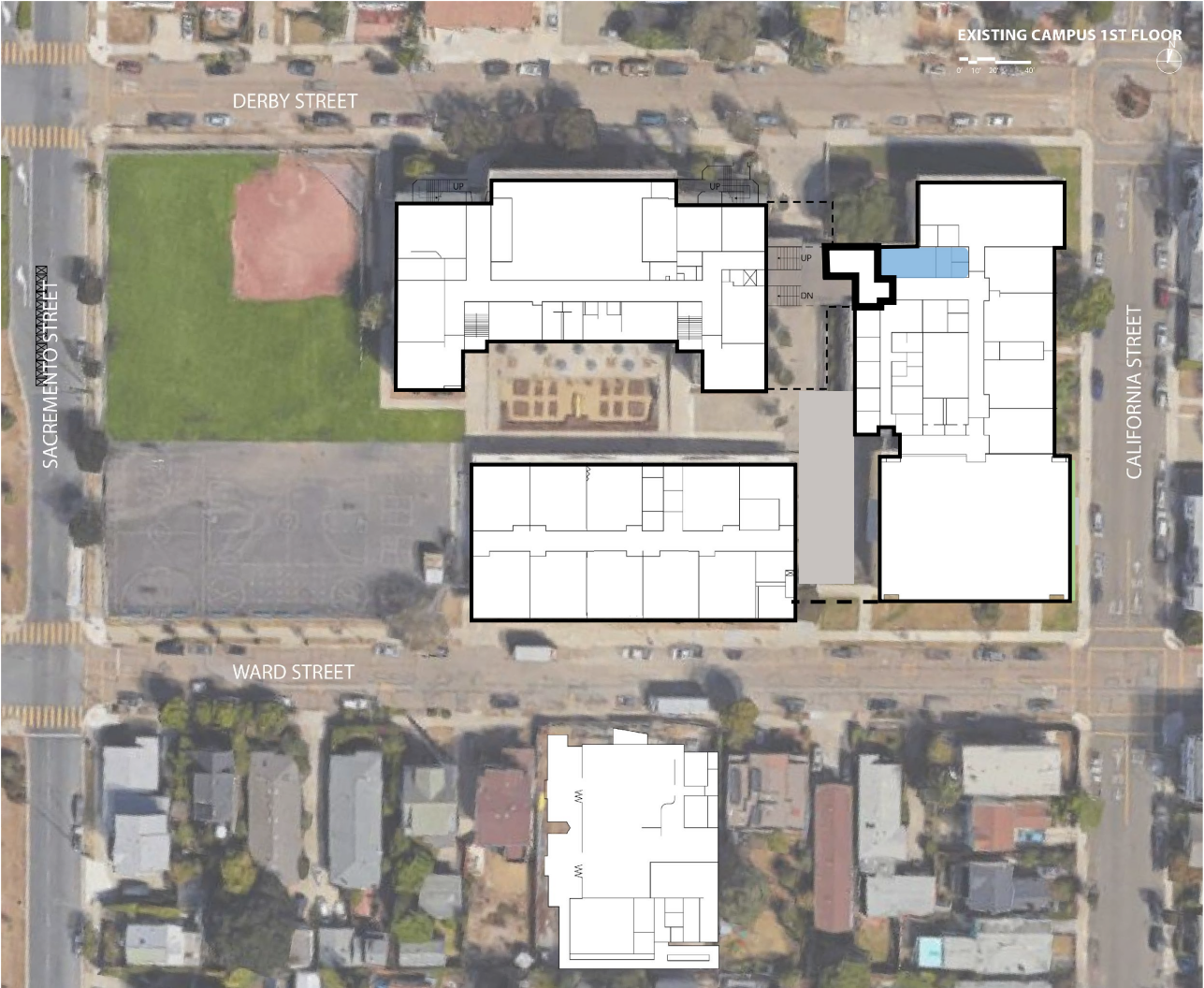



# STUDENT HUB, COMMONS, & LOCKERS





# SITE IMPROVEMENTS

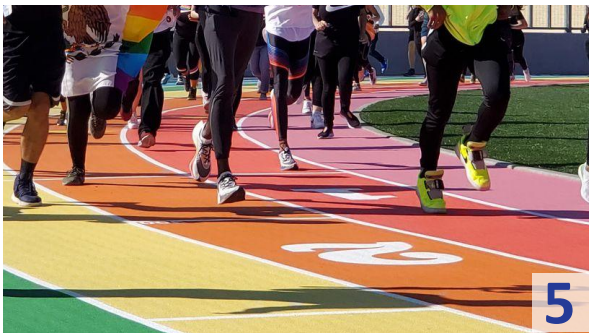
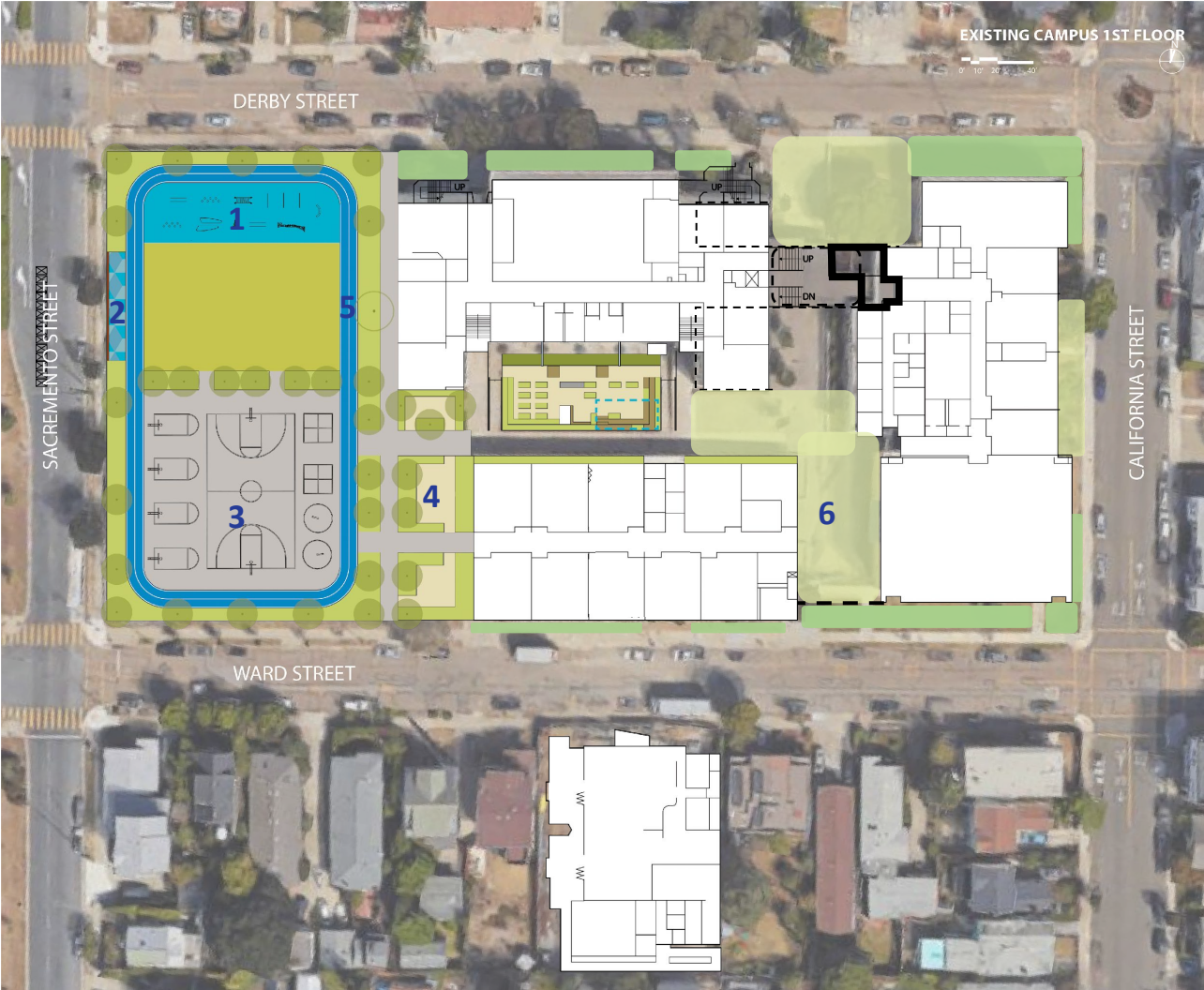



# CONCEPTUAL COST ESTIMATE

	<u>COST ESTIMATE</u>	<u>SOFT COSTS</u> <u>(35%)</u>	<u>TOTAL</u>
Add 01 – Exterior Shades and Awnings	\$674,441	\$226,054	
Add 02 – AV Equipment, Allow	\$323,711	\$113,299	
Add 03 – Professional Development Center: Electrical, Comms, & Security	\$44,221	\$ 15,477	
Add 04 – Play Yard / Track & Field Site Improvements / Additional Trees	\$2,919,888	\$1,021,961	
Add 05 – Entry Plaza, Breezeway, and Lockers Canopy	\$547,983	\$191,794	
Add 06 – Redesign All Multi-use Restrooms as All Gender, Allowance	\$207,391	\$ 72,587	
Add 07 – Exterior Graphic Signage, Murals, & Exterior Education Signage	\$357,027	\$124,960	
Add 08 – Auditorium Upgrades	\$465,260	\$162,841	
Add 09 – Furniture	\$1,750,000	\$612,500	
TOTAL			\$9,831,395
Add Alt. 01 – Cistern / Rainwater Collection under Turf Field, Allow 80,000 gal tank	\$250,105	\$ 87,537	



# SHORT TERM: EXTERIOR PAINTING

gouldevans **BASE**



*Included in in Conceptual Cost Estimate*



# SHORT TERM: NATIVE & DROUGHT TOLERANT LANDSCAPE

goulddevans **BASE**



**SOUTH & EAST SIDE PLANTING  
AND IRRIGATION**



**NORTH & EAST SIDE PLANTING AND IRRIGATION**



***Included in in Conceptual Cost Estimate***



# PROJECT SCHEDULE

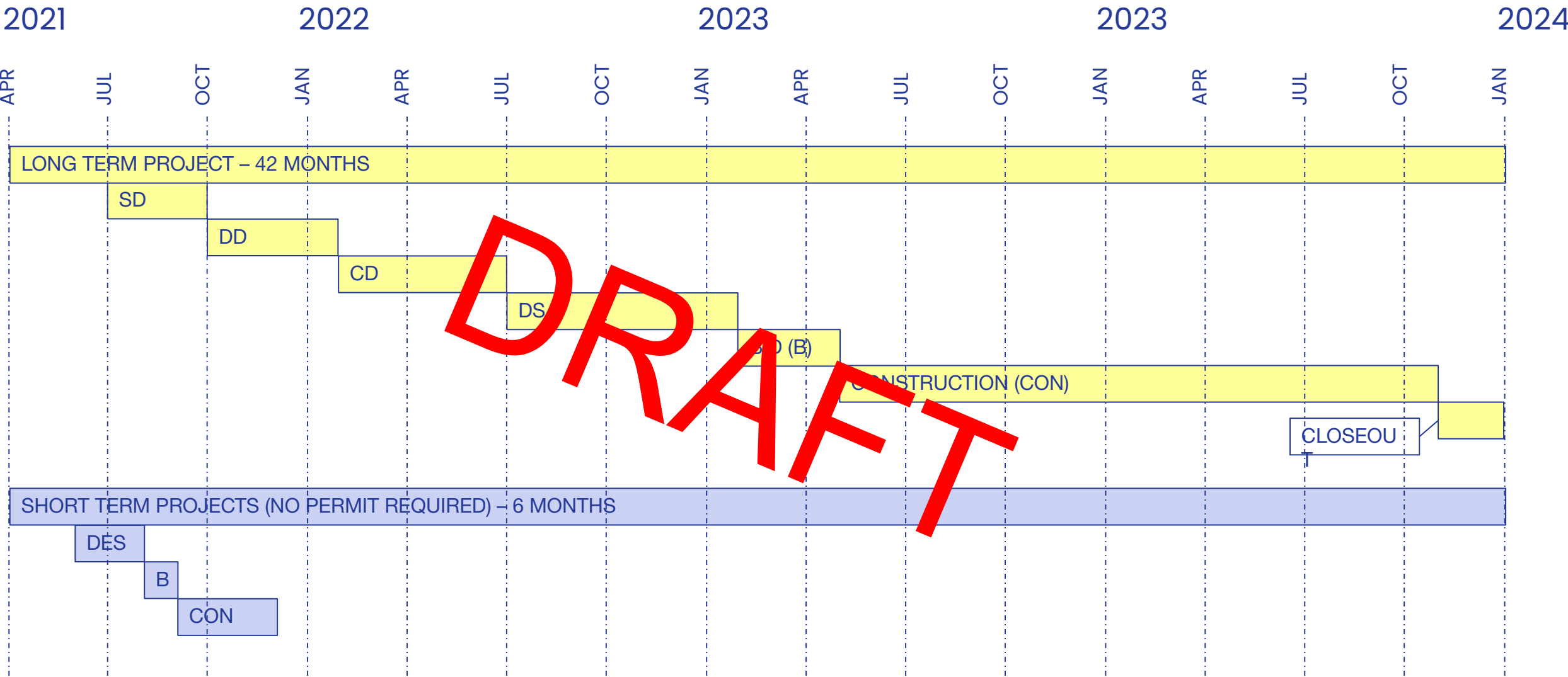





# QUESTIONS & COMMENTS

---

Facilities Subcommittee Meeting  
June 1, 2021