



# LONGFELLOW MIDDLE SCHOOL

## Berkeley Unified School District

# The Board of Education Meeting June 23, 2021



# SITE PLAN EXISTING

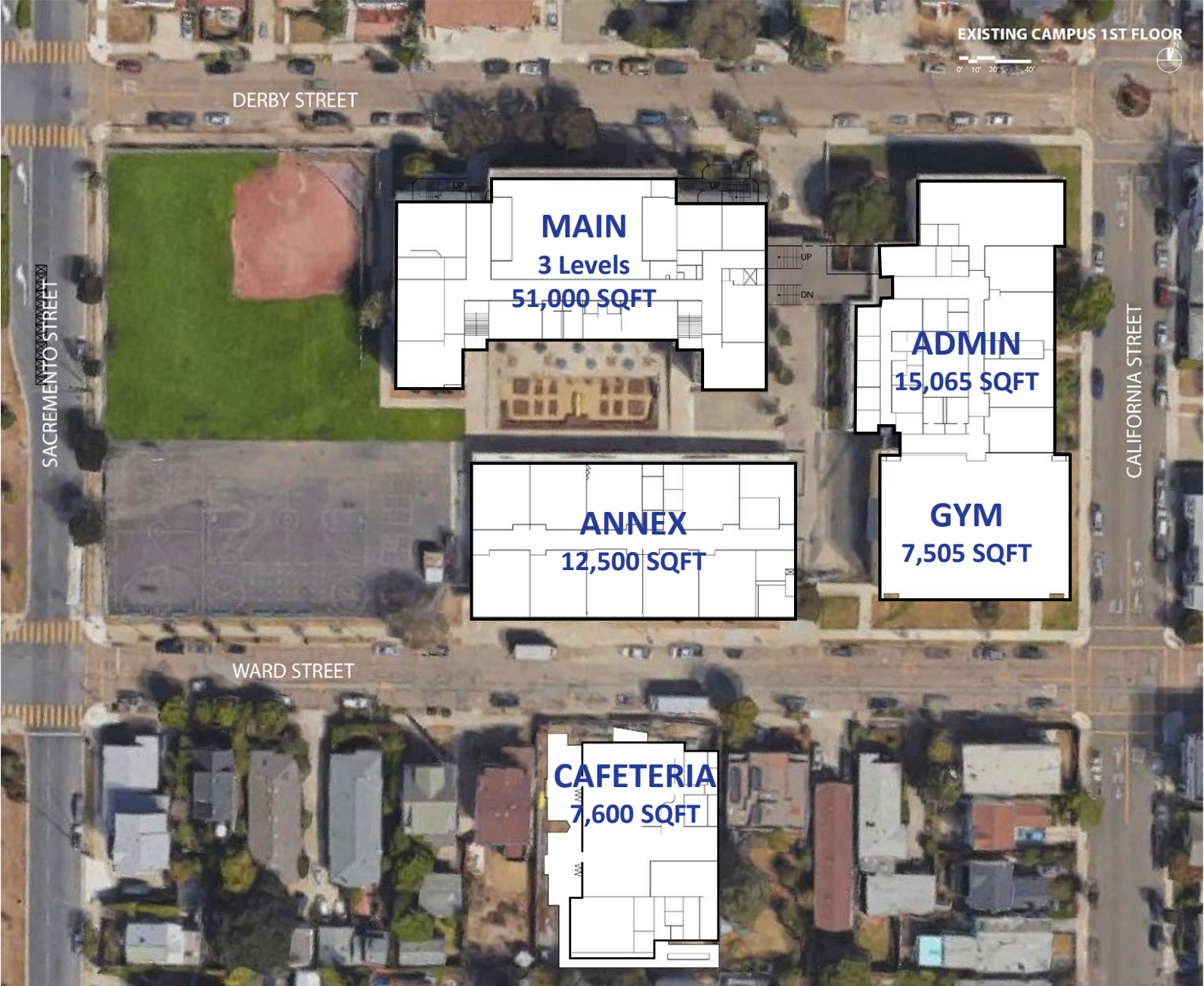

**TOTAL BUILDING AREA**  
93,700 SQFT

**TOTAL SITE AREA**  
164,657 SQFT  
*Includes Building Footprint*



# INFRASTRUCTURE

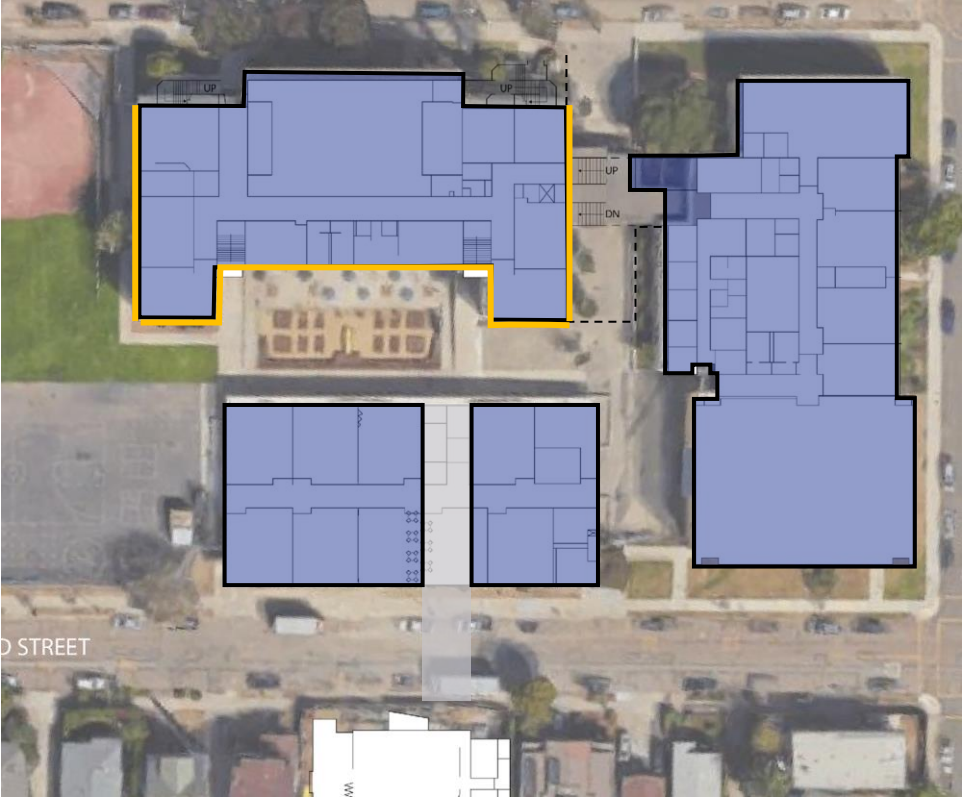



# CAREER TECHNOLOGY EDUCATION (CTE)

gouldevans **BASE**

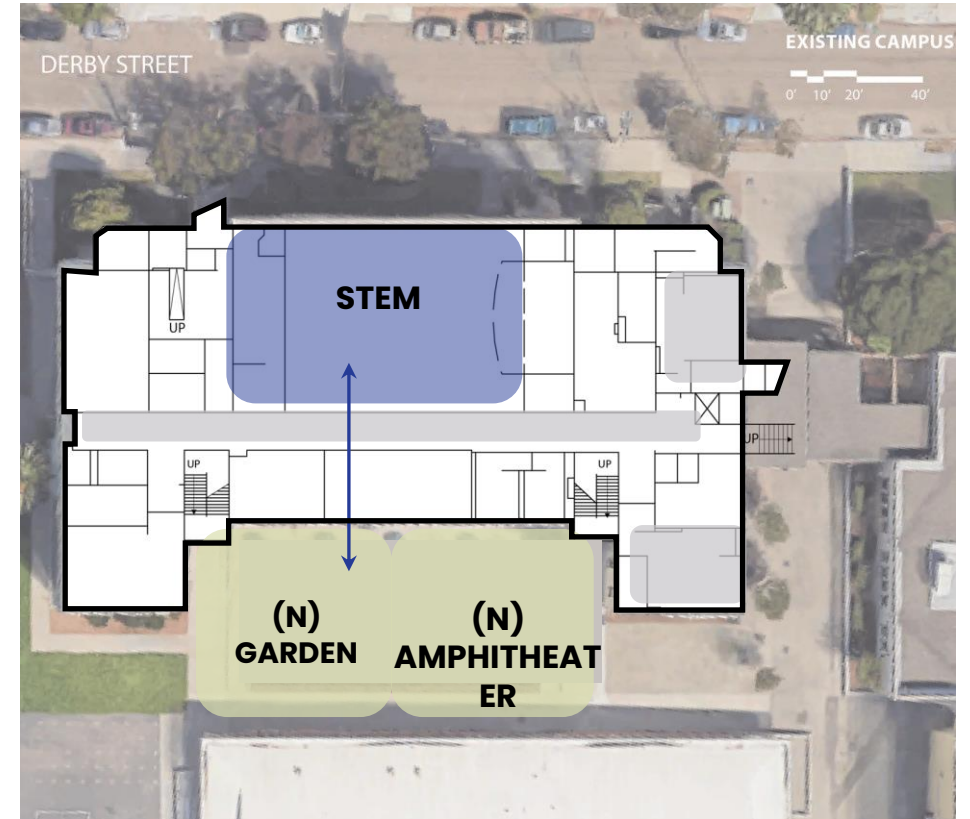



# SOLAR



ENERGY REDUCTION-LED LIGHTING



PHOTOVOLTAICS





# ADD PROJECT (MODERNIZATION)

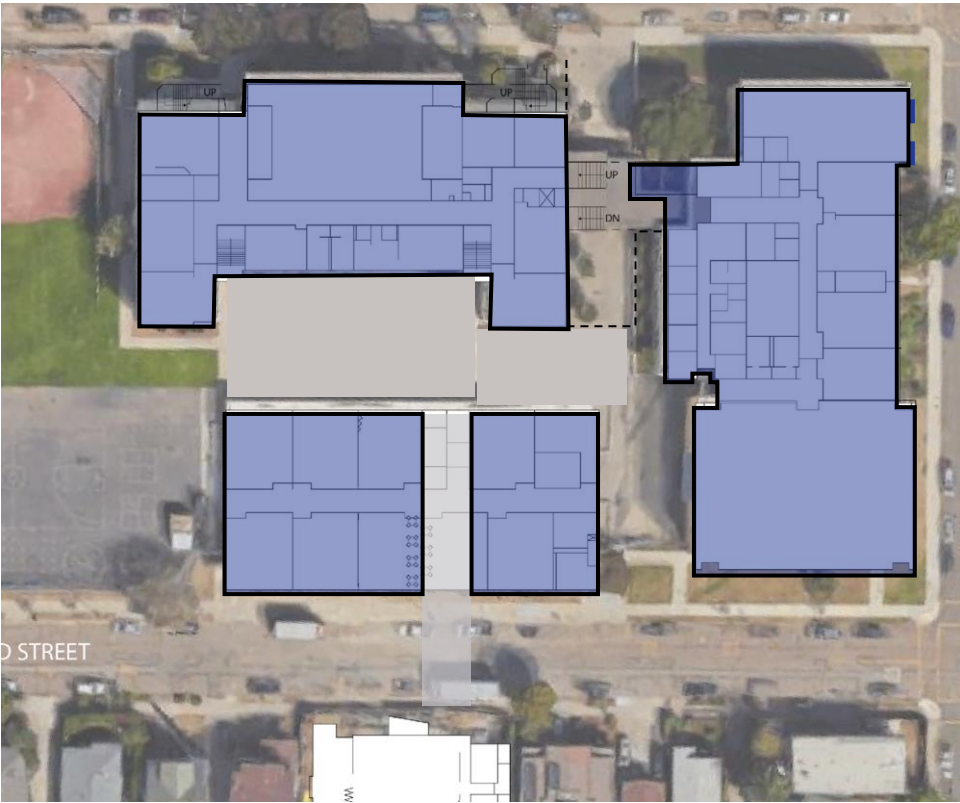

# APPROVED BUDGET & COST ESTIMATE

	<u>BUDGET</u>	<u>COST ESTIMATE</u>
INFRASTRUCTURE	\$7,218,400	\$7,432,140
CAREER TECHNOLOGY EDUCATION (CTE)	\$2,100,000	\$2,255,072
SOLAR	\$3,522,640	\$3,312,907
BOARD APPROVED (07/1/2020) PROJECT	\$9,845,000	\$9,479,490
<hr/>		
TOTAL (HARD + SOFT COSTS)	\$22,686,040	\$22,479,609

# ENGAGEMENT SCHEDULE

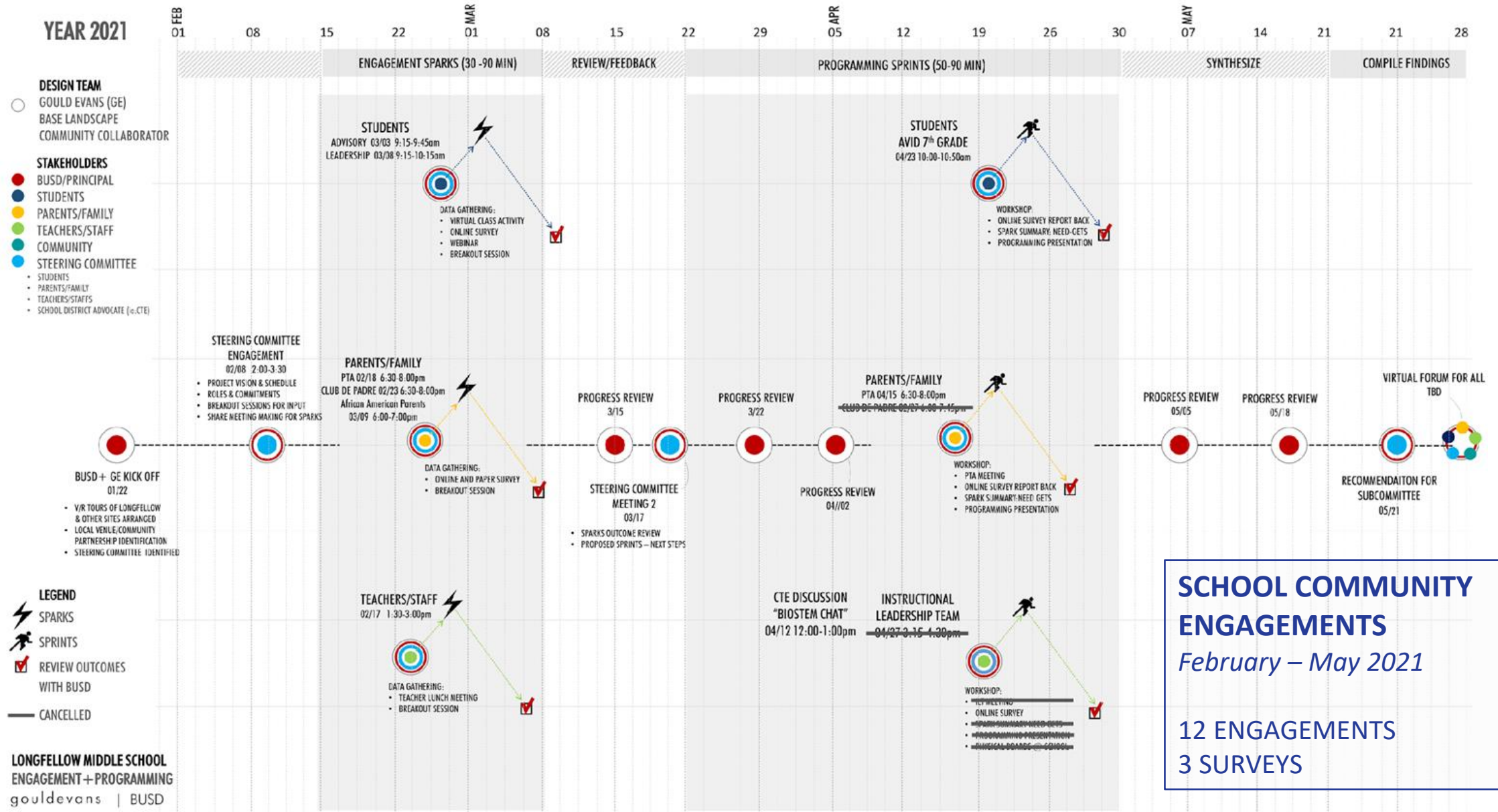



# ENGAGEMENT METHODS

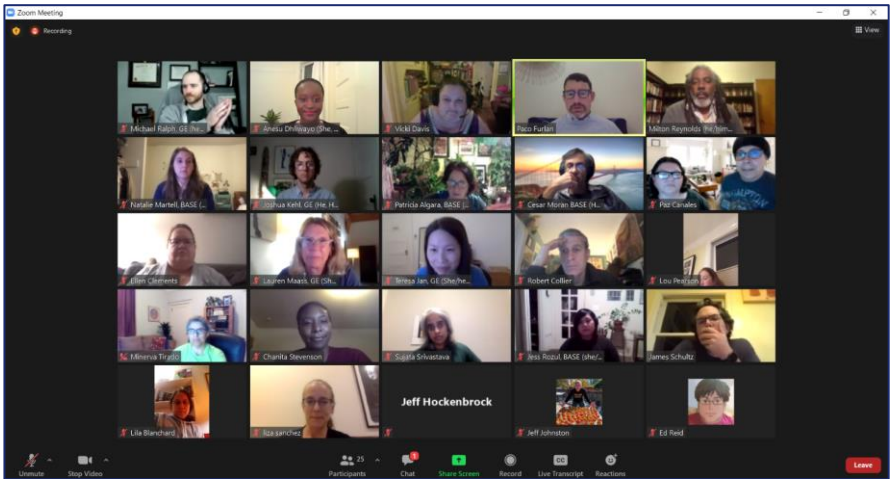

COMMUNITY MEETINGS



DIGITAL WHITEBOARDS

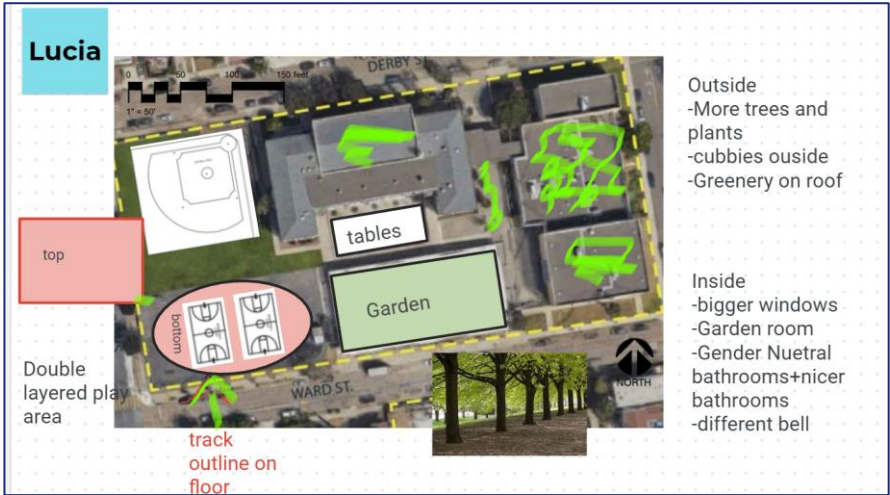

STUDENT VISIONS

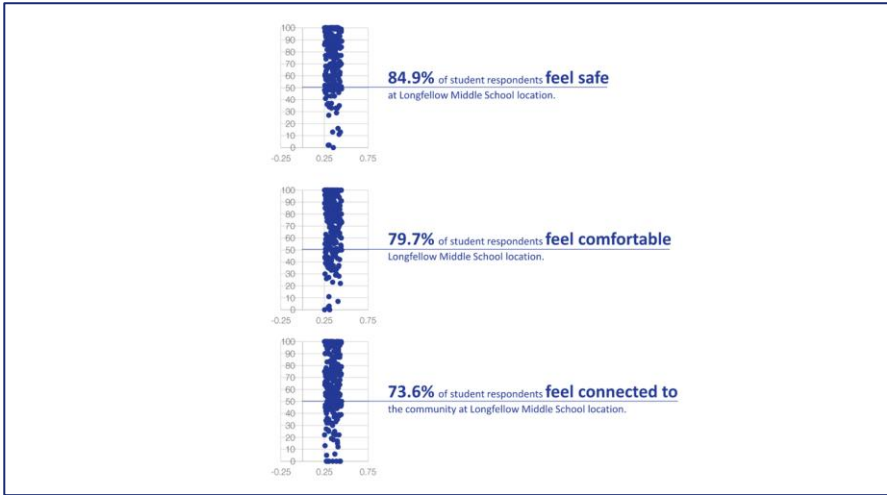

SURVEYS



# NEED/RESPONSE/PROPOSED



**NEED #1:** A welcoming, aesthetically beautiful and dignified school campus.



**RESPONSE #1:** Campus oasis that reflects the Longfellow Community.

## PROPOSED #1:

- New Entry Porch: Plaza, Canopy, & Breezeway
- New Administration Area
- New Decorative Entry Fence and School Fencing
- New Exterior Painting, Exterior Graphic & Education Signage
- New Native and Drought resistant Streetscape Landscaping



**NEED #2:** A school with clear programming goals and facilities to support learning.



**RESPONSE #2:** Create a “heart” for LFMS to celebrate school programming.

## PROPOSED #2:

- New Central Plaza
- New Main Gardens
- Modernization of Existing Historical Auditorium
  - Seating, Audio-Visual, Lighting, Window Shades, Technology, & Stage Upgrades
- New Lockers for each Longfellow Student



# NEED/RESPONSE/PROPOSED



**NEED #3:** Campus needs to represent the Longfellow community.



**RESPONSE #3:** Campus architecture and outdoor learning/ physical education spaces to represent the uniqueness of Longfellow.



**NEED #4:** Variety of spatial experiences.



**RESPONSE #4:** Create experiential, flexible spaces that adapt.

## PROPOSED #3:

- New Family Resource Center
- Modernization of:
  - UMOJA & Two-Way Immersion (TWI) Programming Spaces
  - STEM Maker Lab
  - Library, New Reading Room, & Reading Garden
  - Teacher's Lounge as Professional Development Center
- Relocation & New Counseling Center

## PROPOSED #4:

- New Student Hub in Main Building Basement
- New Student Commons in Annex Building
- New Exterior Amphitheater
- New Outdoor Learning
- New AV Equipment
- All New Furniture and Furnishings



# NEED/RESPONSE/PROPOSED



**NEED #5:** Modernization of Existing Buildings.



**RESPONSE #5:** Healthy, sustainable and well-maintained facilities and buildings that support student learning.



**NEED #6:** Outdoor athletic and physical education spaces that reflect school community interests and goals.



**RESPONSE #6:** Create multi-use athletic facilities that focus on sports programming at Longfellow and supports community usage.

## PROPOSED #5:

- Window Replacement and Water Intrusion Repair of Main Building
- New Exterior Shades & Awnings
- New Solar Technology
- New Cistern, Rainwater Collection, and Bioswales
- Modernize Restrooms & Locker Rooms
- New Trash Enclosure
- Classroom Refresh

## PROPOSED #6:

- New Site Amenities & Outdoor Physical Education
  - Basketball, Tetherball, and Four-Square Courts
  - Seating and Gathering Spaces
  - Track & Play Yard
  - Bouldering Wall
  - Exercise/ Play Equipment



# SITE PLAN PROPOSED



gouldevans **BASE**

- TEACHER SUPPORT
- STUDENT SUPPORT
- CLASSROOM
- ADMINISTRATION
- INFRASTRUCTURE
- COMMUNITY
- LANDSCAPE
- OUTDOOR PROGRAM
- (E) BLDG OUTLINE
- (N) BLDG OUTLINE
- (N) CANOPY STRUCTURE
- CIRCULATION



# ENTRY PORCH & ADMINISTRATION

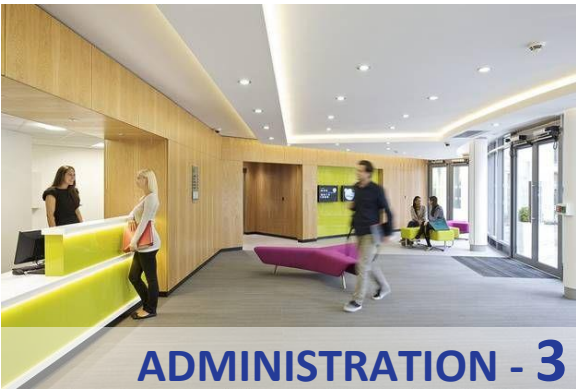



# FAMILY RESOURCE CENTER

gouldevans **BASE**





# STUDENT HUB, COMMONS, & LOCKERS





# SITE IMPROVEMENTS

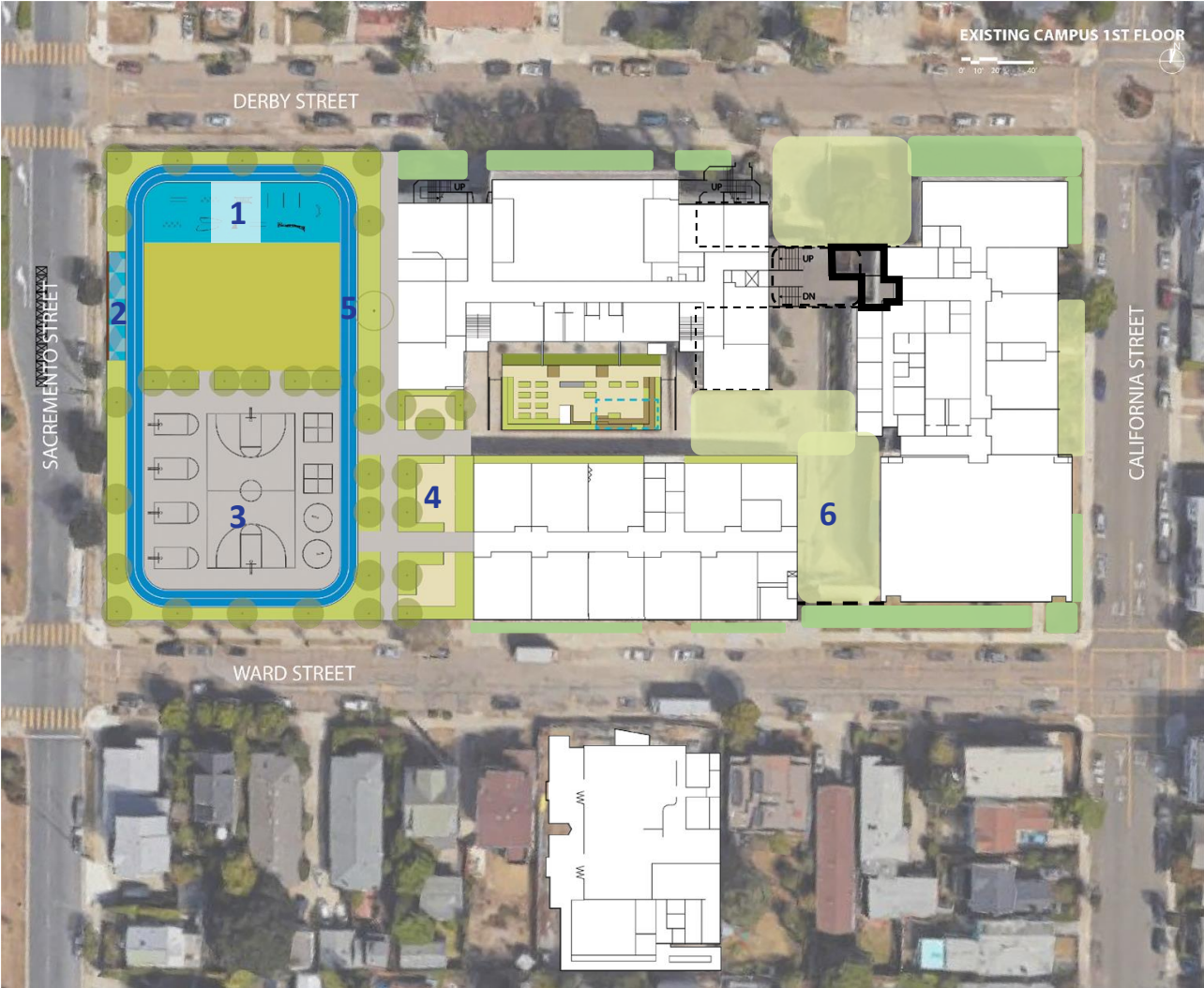



# RECOMMENDED SCOPE ADDITIONS

## COST ESTIMATE

Add 01 – Exterior Shades and Awnings	\$793,460
Add 02 – AV Equipment, Allow	\$238,023
Add 03 – Teacher Lounge: Elec, Comms & Security	\$65,031
Add 04 – Play Yard / Track & Field/Trees	\$3,209,390
Add 05 – Entry Plaza, Breezeway, and Lockers Canopy	\$644,686
Add 06 – Exterior Signage & Education Signage	\$420,032
Add 07 – Auditorium Upgrades	\$547,365
Add 08 – Furniture	\$1,591,176

---

<b>TOTAL</b>	<b>\$7,509,163</b>
--------------	--------------------

<i>Add Alt. 01 – Rainwater Collection under Turf Field, 80,000 gal tank</i>	<i>\$367,801</i>
---	------------------



# PROPOSED TOTAL PROJECT BUDGET

COST ESTIMATE OF BOARD APPROVED	\$22,686,040
RECOMMENDED SCOPE ADDITIONS	\$7,509,163
<hr/>	
PROPOSED TOTAL PROJECT BUDGET	\$30,195,203



# SHORT TERM: EXTERIOR PAINTING

gouldevans **BASE**



*Included in in Conceptual Cost Estimate*



# SHORT TERM: NATIVE & DROUGHT TOLERANT LANDSCAPE

goulddevans **BASE**



SOUTH & EAST SIDE PLANTING  
AND IRRIGATION



NORTH & EAST SIDE PLANTING AND IRRIGATION



*Included in in Conceptual Cost Estimate*



# PROJECT SCHEDULE

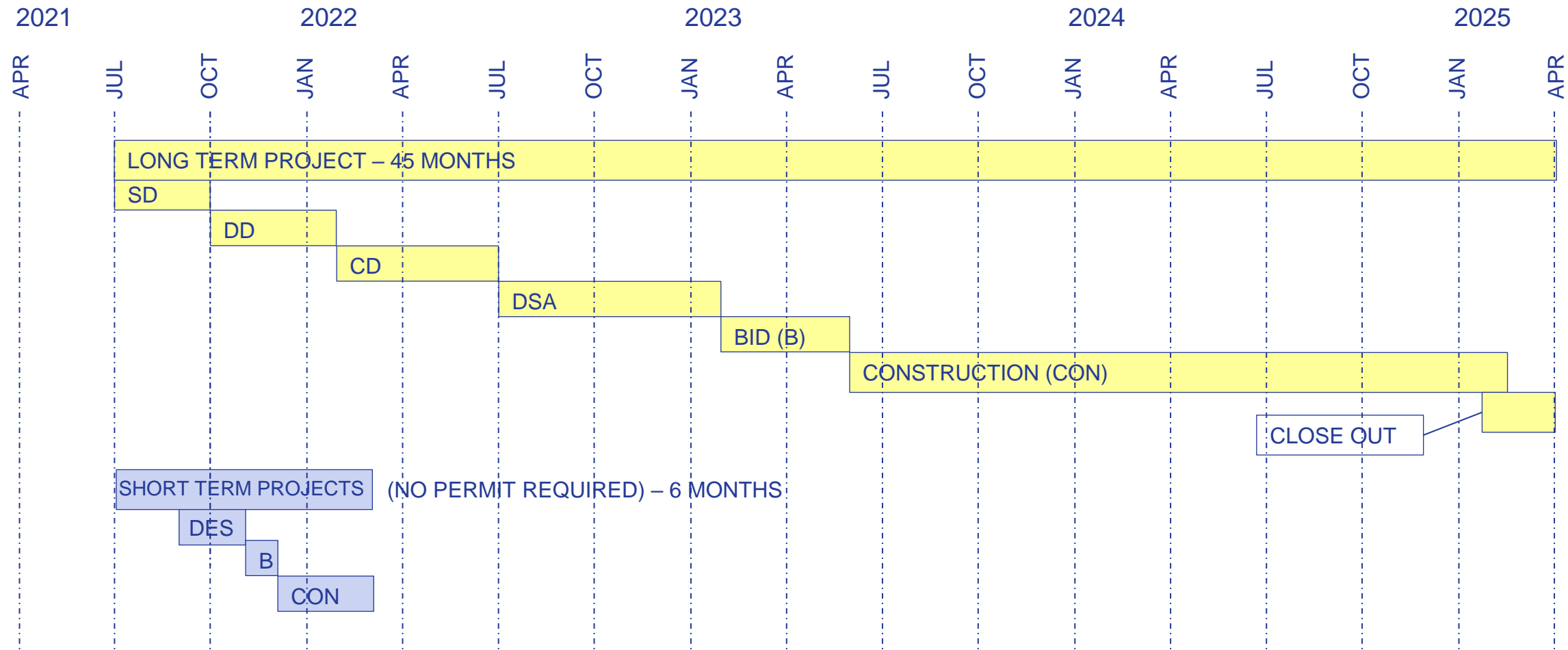





# QUESTIONS & COMMENTS

---

The Board of Education Meeting  
June 23, 2021