

MEASURE X UPDATE

Board of Trustees

June 24, 2021

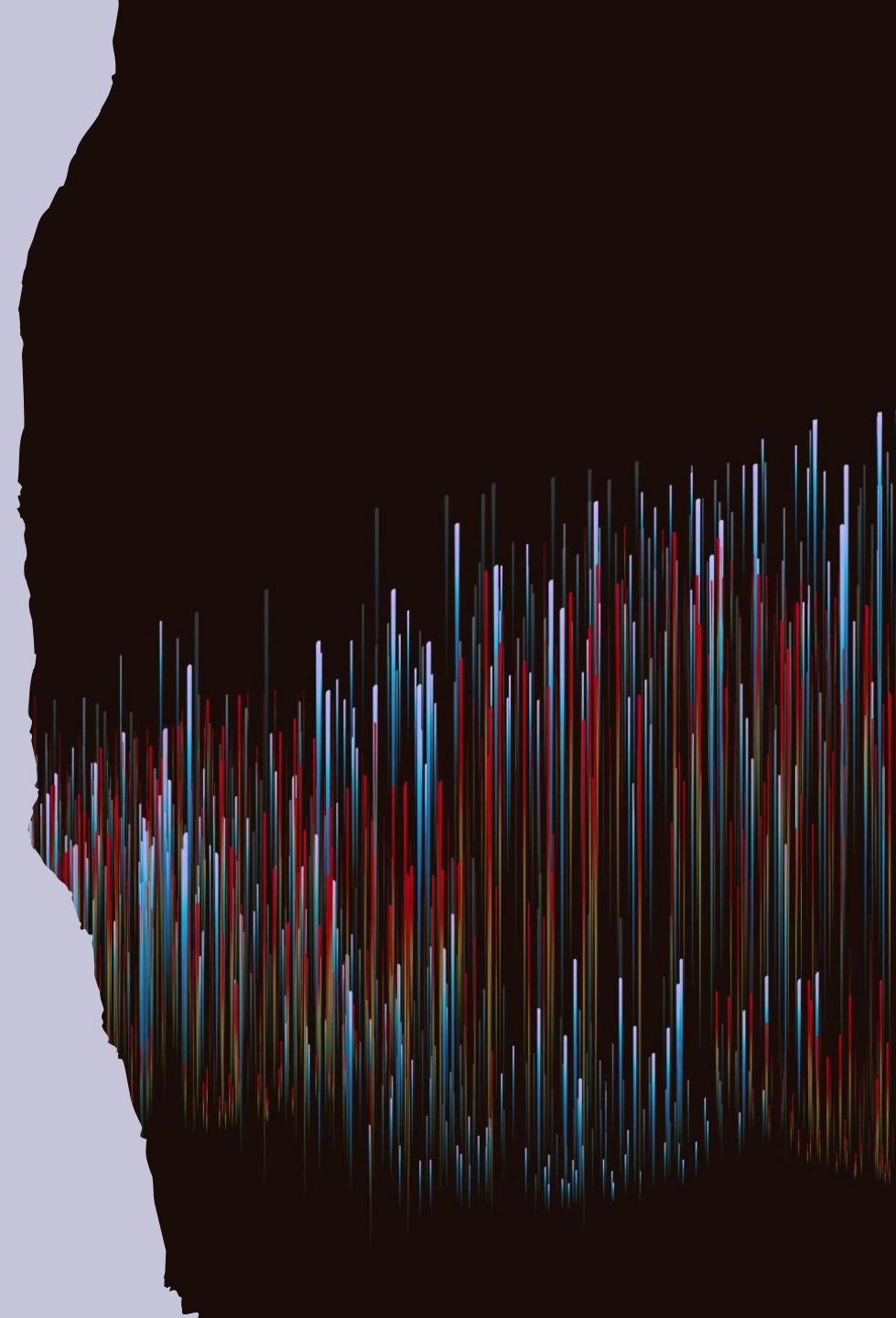

MEASURE X OVERVIEW

- Measure X Bond Measure approved by the voters in November 2015
- \$148m. for facilities for increased/increasing enrollments
- Phase I—planning began in 2016 for 4 projects
- Phase II—planning began in 2020 for 4 additional projects

MEASURE X PHASE I

Bayside Academy--new gym and locker rooms

Abbott MS—new gym and locker rooms and additional classrooms

Borel MS—new gym and locker rooms and additional classrooms

New elementary school in Foster City for 400–420 students

BAYSIDE GYM AND LOCKER ROOMS

Planning Team

- School Team of parent and staff leaders
- John Cosmos, Principal and Megan Gurka, Assistant Principal
- District Facilities Team

Architect: QKA

General Contractor: Rodan

SMFCSD Construction Project Manager: Kevin Sanders

Total budget—construction and soft costs: \$14,464,924





BAYSIDE GYM AND LOCKER
ROOMS EXTERIOR

BAYSIDE LOCKER ROOMS AND GYM FROM SCHOOL LOOKING NORTH





BAYSIDE GYM INTERIOR

BAYSIDE GYM AND LOCKER ROOMS: STATUS

- COMPLETED, ready for use in Summer 2020
- Total budget—construction and soft costs: \$14,464,924

ABBOTT CLASSROOMS, GYM AND LOCKER ROOMS

- 6 additional classrooms
 - 2 new on top of the locker rooms
 - 4 created from existing spaces/conversion
- New gym and locker rooms
- Planning Team
 - School Team of parent leaders, previous administration, and staff with later assistance from Jeremy Packman, Principal, and Walter Valencia, Assistant Principal
 - District Facilities Team
- Architect: CAW
- General Contractor: Rodan
- SMFCSD Construction Project Manager: Mark Sherrill





ABBOTT EXTERIORS

ABBOTT GYM INTERIOR





ABBOTT INTERIOR
WITH BLEACHERS OPEN

ABBOTT CLASSROOMS, GYM AND LOCKER ROOMS: STATUS

- Classrooms COMPLETED, ready for use August 2020
- Gym and Locker Rooms COMPLETED March 2021
- Total budget—construction and soft costs: \$22,924,251

BOREL CLASSROOMS, GYM AND LOCKER ROOMS

- 8 additional classrooms
 - 6 new
 - 2 created from existing spaces/conversion
- New gym and locker rooms
- Planning Team
 - School Team of parent and staff leaders
 - Kenyetta Cook, Principal, and Jessica Notte, Assistant Principal
 - District Facilities Team
- Architect: CSDA
- General Contractors: Rodan and Beals Martin
- SMFCSD Construction Project Manager: Bob Price





GYMNASIUM

BOREL EXTERIOR —
GYM AND LOCKER ROOMS



BOREL GYM INTERIOR

BOREL LOCKER ROOM





BOREL CLASSROOM WINGS
LOOKING TOWARD GYM

BOREL CLASSROOMS, GYM AND LOCKER ROOMS: STATUS

- Classrooms: 1 conversion in 2018; 6 COMPLETED, ready for use August 2020; two classroom renovations underway Summer 2021
- Gym and Locker Rooms COMPLETED March 2021; two remaining classrooms to be completed by 2021-22 school year
- Total budget—construction and soft costs: \$26,379,430

NEW SCHOOL IN FOSTER CITY— BEACH PARK ELEMENTARY SCHOOL

- 17 classrooms built around collaboration areas, multipurpose room, library/resource center, 1 classroom for the Children's Annex program, administration building, outdoor play areas and learning nodes
- Planning Team
 - Original Team: parent leaders, administrators & staff from existing FC schools
 - Finishing: Amy Snow, Beach Park School Principal, and staff
 - District Facilities Team and Student Services and Ed Services staff members
- Architect: HMC
- General Contractors: Overaa
- SMFCSD Construction Project Manager: Kevin Sanders





BEACH PARK SCHOOL LOOKING
NORTH FROM ADMINISTRATION
BUILDING ALONG SHELL BLVD.



BEACH PARK ELEMENTARY SCHOOL
ADMINISTRATION BUILDING
11551 Street Boulevard

BEACH PARK SCHOOL CLASSROOM





BEACH PARK LIBRARY

BEACH PARK SCHOOL: STATUS

- COMPLETED May 2021; opened to students and staff May 10, 2021
- Total budget—purchase of site, construction and soft costs: \$75,918,830 (Measure L, X and other sources)

MEASURE X PHASE I PROJECTED REMAINING FUNDS

- At least \$7million projected in remaining funds after all Phase I projects are completed and closed-out due to savings in contingency funding set aside for change orders and other unused soft costs

Note: close-outs on all Phase I projects except two to be completed by end of 2021; close-out to be completed on two remaining projects (share of traffic signals adjacent to Beach Park School and Borel lunch structures) after installation anticipated by fall 2022

MEASURE X PHASE II: OVERVIEW

New Elementary School in North
Central San Mateo

New Science and Drama
Buildings at Bowditch MS

New Multipurpose Building and
additional classrooms at Sunnybrae
and George Hall Schools

NEW ELEMENTARY SCHOOL IN NORTH CENTRAL SAN MATEO

- Recommendations for North Central School Vision and Program presented to the Board on June 10, 2021 from PAN, independent educational consultancy firm
- Start of school facility planning aligned with school vision and program projected to begin in second half of 2021 after Board direction
- Original Budget (250 student school): \$23 million

BOWDITCH PROJECT

MAJOR ELEMENTS:
NEW SCIENCE AND
DRAMA BUILDINGS

ARCHITECT: HED

TOTAL PROJECT
BUDGET: \$19.5M

BOWDITCH NEW DRAMA AND SCIENCE BUILDINGS



BOWDITCH
EXTERIOR
RENDERING
OF SCIENCE
AND DRAMA
BUILDINGS
FROM THE
SOUTHEAST
(NOTE: EXTERIOR
COLORS STILL
UNDER
CONSIDERATION)



CONDOMINIUMS



CHURCH



EXISTING CAMPUS



GARLAND CADET
GRAY

STANDING SEAM
ROOF COLOR

NEIGHBORING BUILDINGS

NEW SCIENCE BUILDING INTERIOR

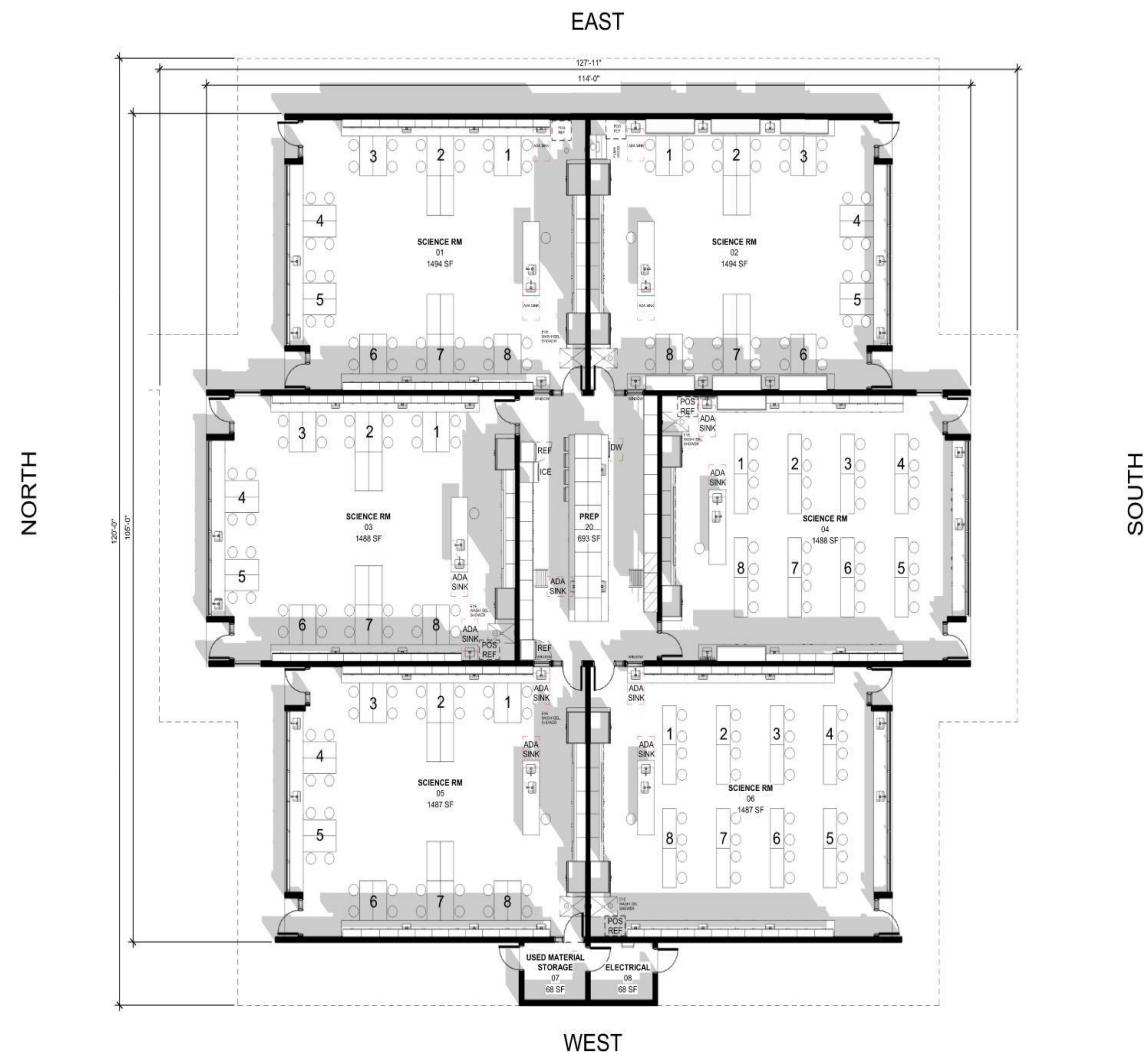

NEW DRAMA BUILDING INTERIOR

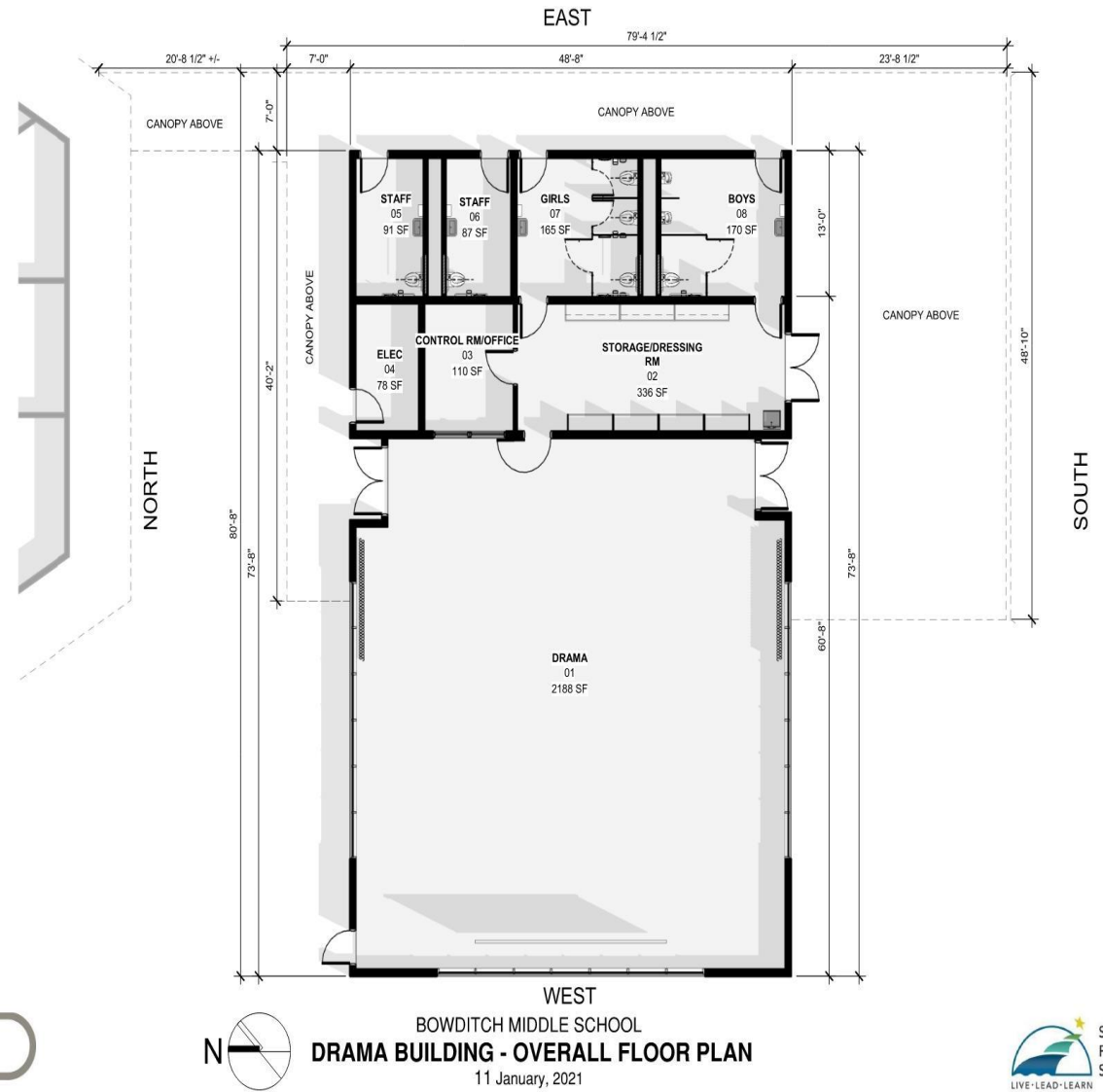

CURRENT PROJECTED TIMELINE—BOWDITCH NEW SCIENCE AND DRAMA BUILDINGS

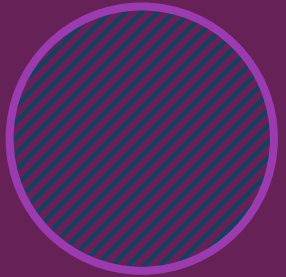

Technical Studies,
Location and
Schematic Design
Phase

DONE

Summer 2020–
Spring 2021

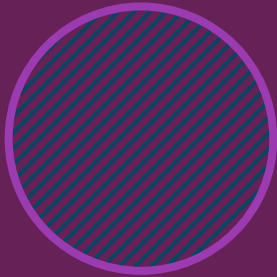

Construction
Documentation
and Specifications
Phase

**ALMOST
DONE**

Summer 2021

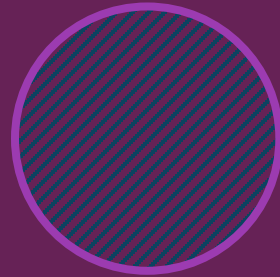

Division of State
Architect Review
and Approval

**SUBMISSION
PLANNED FOR
JULY 2021**

Summer 2021–
Winter 2022

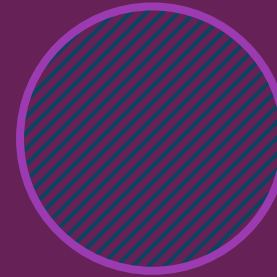

Public Bidding
Phase and Award
of Contract to
General
Contractor

Spring 2022

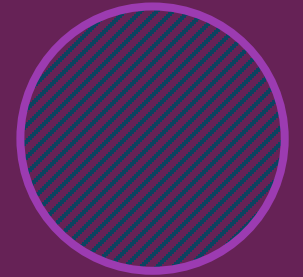

Site Mobilization
and Construction

Summer 2022–
end of 2023

SUNNYBRAE AND GEORGE HALL MULTIPURPOSE BUILDING PROJECTS

- District Standards with unique designs for each school
 - Scope: Large assembly area with stage
 - Small instructional rooms/offices to free up classrooms for enrollment growth
 - Warming kitchen and serving room (servery)
 - Restrooms, storage areas and custodial room
 - Relocation of classrooms (GH) and play structures (both)
 - Landscaping
 - Lunch shade structure (Sunnybrae) and courtyard (GH)
- Total Approved Budget: \$11.6 million each

SUNNYBRAE
CAMPUS
WITH NEW
MULTI-
PURPOSE
BUILDING:
LOCATION



SUNNYBRAE
RENDERING
FROM THE
PLAY AREA
LOOKING
NORTHWARD





SUNNYBRAE NEW
MULTIPURPOSE BUILDING AND
SHADE STRUCTURE FROM THE
SOUTHEAST

GEORGE HALL MULTIPURPOSE BUILDING PLAN



George Hall Elementary School - Multi Purpose Building



FLOOR PLAN

Jan 2021



GEORGE HALL EXTERIOR AND NEW
COURTYARD FROM LUNCH SHELTER

GEORGE HALL MULTIPURPOSE BUILDING FROM PLAYGROUND



CURRENT PROJECTED TIMELINE—GEORGE HALL AND SUNNYBRAE MULTIPURPOSE BUILDINGS

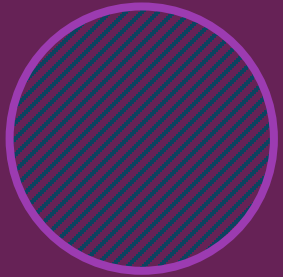

Technical Studies,
Location and
Schematic
Design Phase

COMPLETED

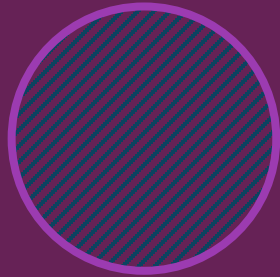

Construction
Documentation
and
Specifications
Phase

CURRENT
PHASE

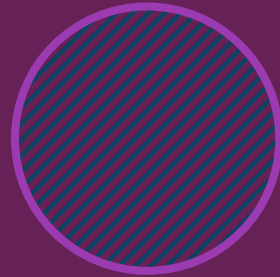

Division of
State Architect
Review and
Approval

Summer 2021–
Early 2022

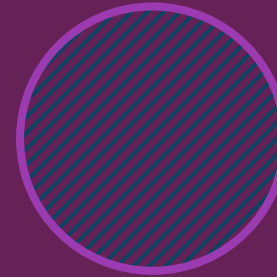

Public Bidding
Phase and
Award of
Contract to
General
Contractor

Spring 2022

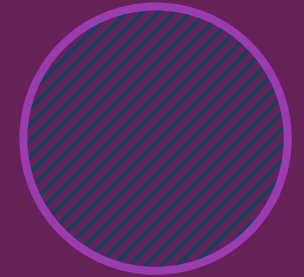

Site
Mobilization
and
Construction

Summer 2022–
Summer 2023

COST ESTIMATES—MEASURE X PHASE II

- Bowditch: within budget
- Sunnybrae: \$1m. over construction cost budget in large part due to the need for a lunch shade structure next to the Multipurpose Building (May 2021 cost estimate)
- George Hall: \$800k over construction cost budget because of need to relocate two portables, one play structure and the grass area in the primary yard, and add fire hydrants (June 2021 cost estimate)
- New School in North Central: to be determined once facility planning begins after Board of Trustees' direction on school

RECOMMENDED BUDGET REVISIONS— GEORGE HALL AND SUNNYBRAE PROJECTS

- Increase George Hall's approved total budget (hard and soft costs) to \$12.690 million
- Increase Sunnybrae's approved total budget (hard and soft costs) to \$12.960 million
- Total increase: \$2.450 million
- Recommended Source of Funds: part of the projected remaining balances in Measure X Phase I with the rest being added to Phase II budgeted \$7million Escalation/Contingency to be used if needed

Note: recent Cost Estimator's note about volatility in the materials market

QUESTIONS AND COMMENTS