



LONGFELLOW MIDDLE SCHOOL

Berkeley Unified School District

Facilities Subcommittee Meeting
Feb 17, 2022

LONGFELLOW MS PROJECT COST

TOTAL CONSTRUCTION COST	\$20,233,576
SCIENCE GARDEN + SLAT MURAL ALLOWANCE	\$1,000,000
TOTAL SOFT COST	\$7,431,750
<hr/>	
TOTAL PROJECT COST ESTIMATE	\$28,665,326
+ 5% CONTINGENCY	\$1,433,266
 TOTAL PROJECT COST	 \$30,098,592

SITE PLAN - EXISTING

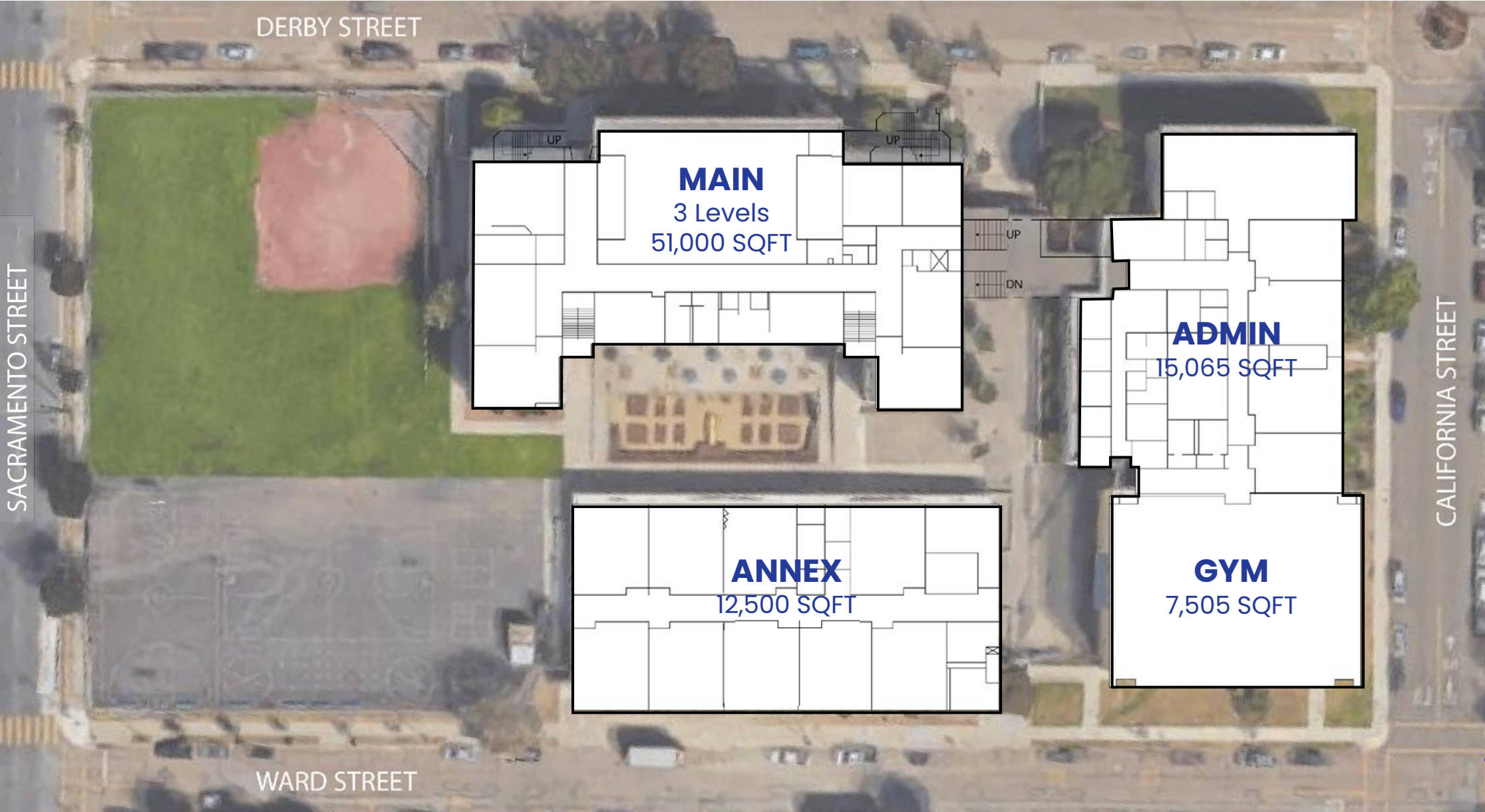

TOTAL SITE AREA
164,657 SQFT
Includes Building Footprint

PROPOSED SITE PLAN

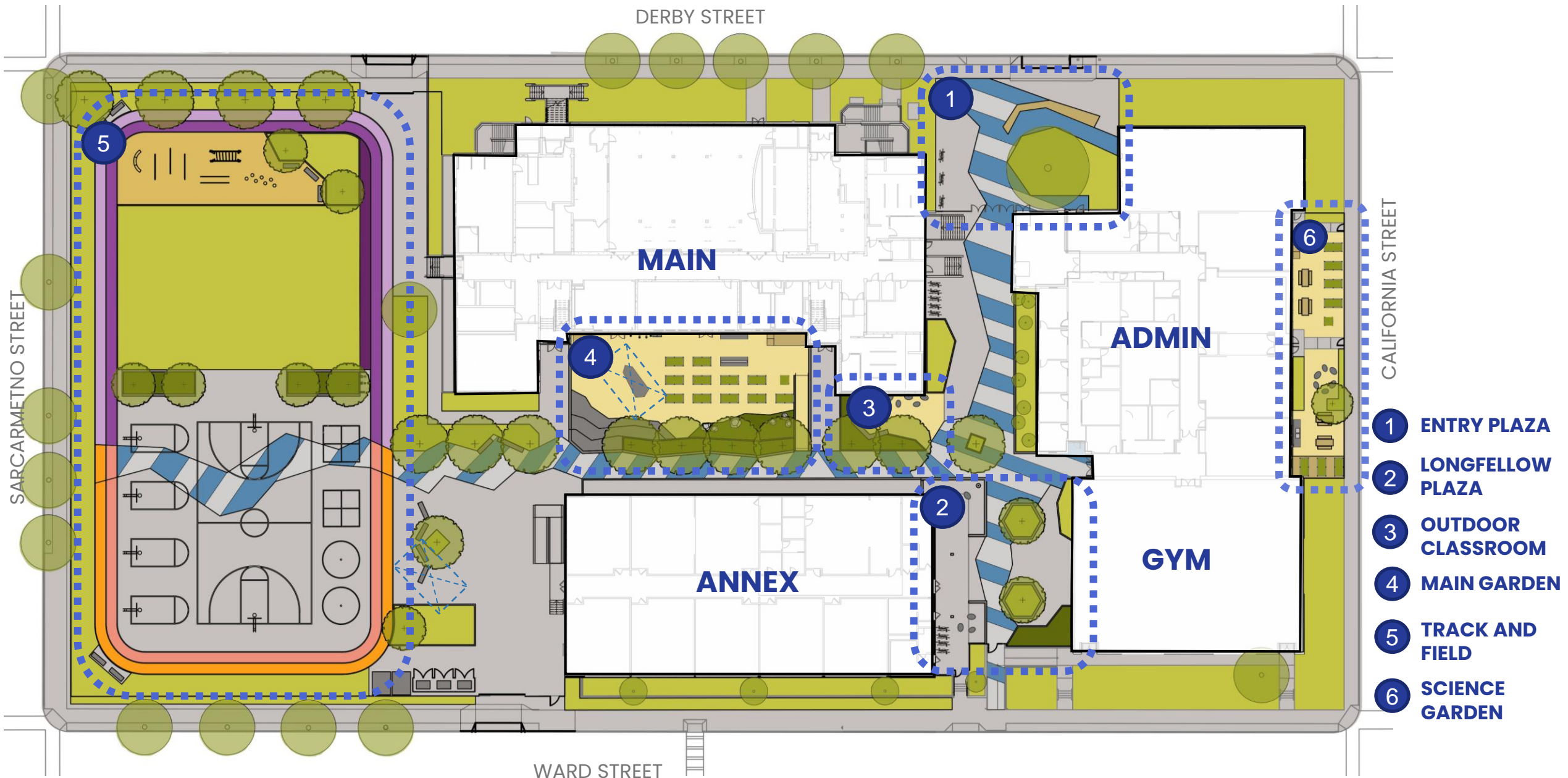

MODERNIZATION PROPOSED 06/23/2021 Board of Education

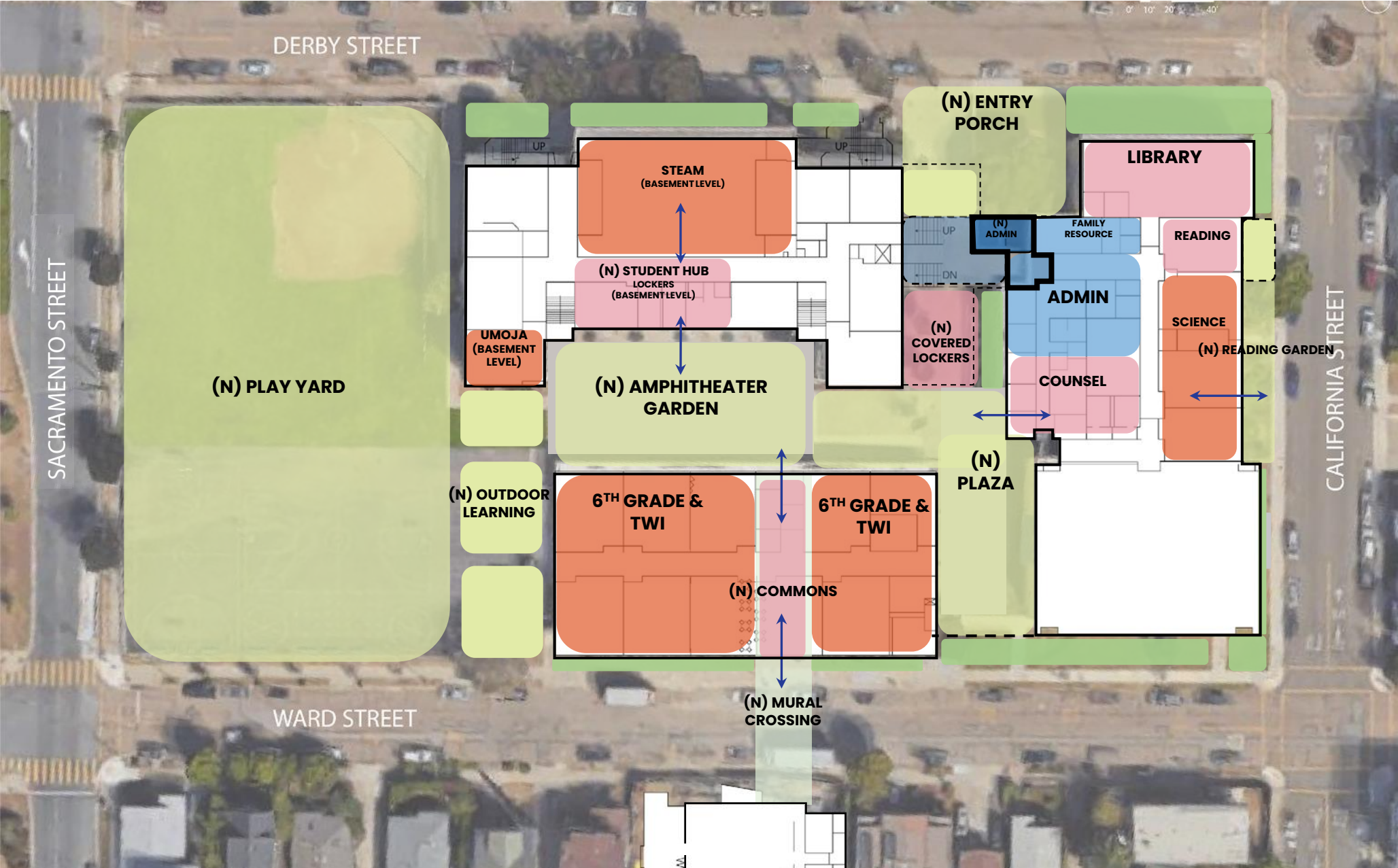

- TEACHER SUPPORT
- STUDENT SUPPORT
- CLASSROOM
- ADMINISTRATION
- INFRASTRUCTURE
- COMMUNITY
- LANDSCAPE
- OUTDOOR PROGRAM
- (E) BLDG OUTLINE
- (N) BLDG OUTLINE
- (N) CANOPY STRUCTURE
- CIRCULATION

PROPOSED MODERNIZATION

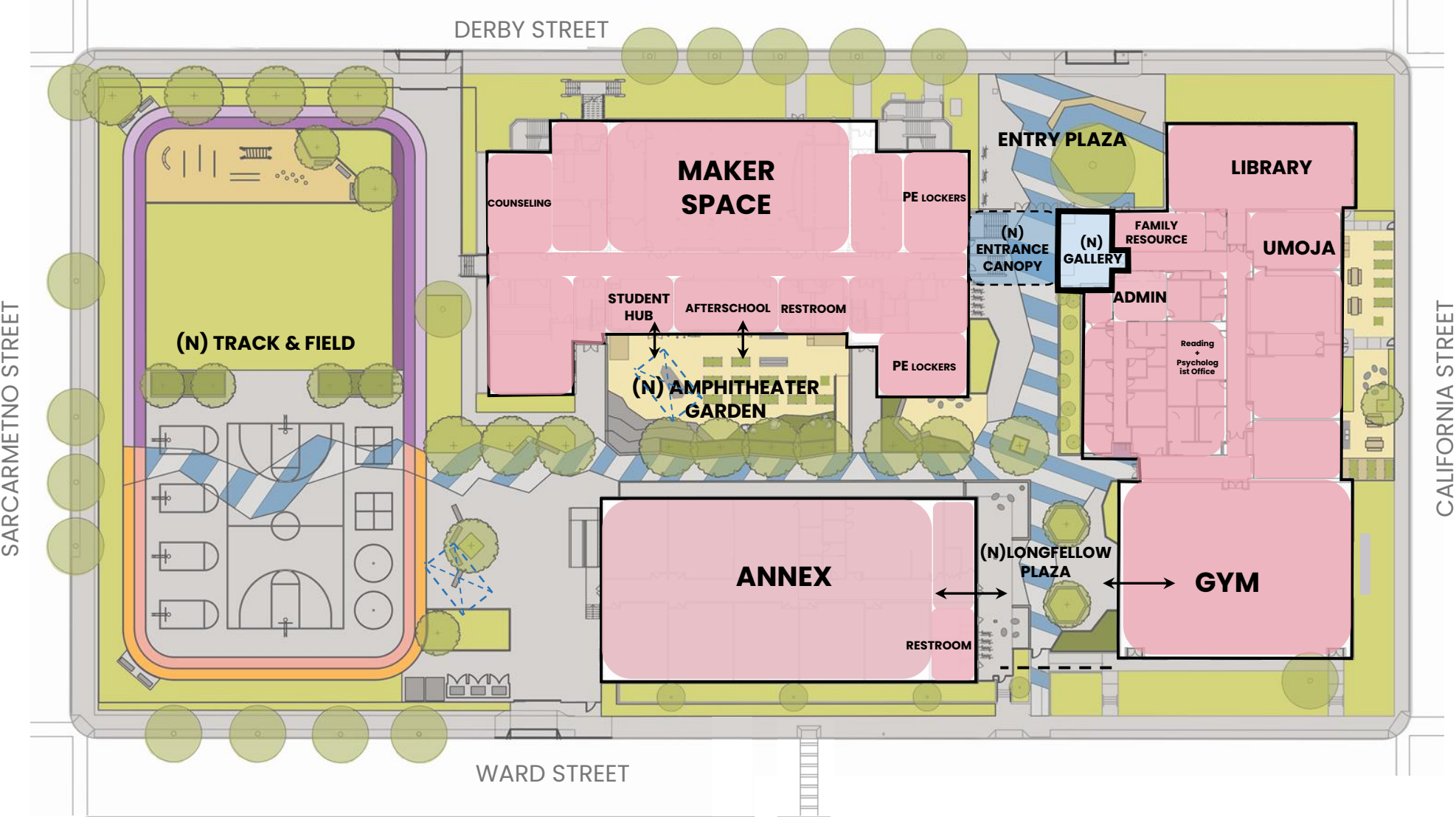

**MODERNIZATION
OR RENOVATON**
ADDITION

PROPOSED MODERNIZATION

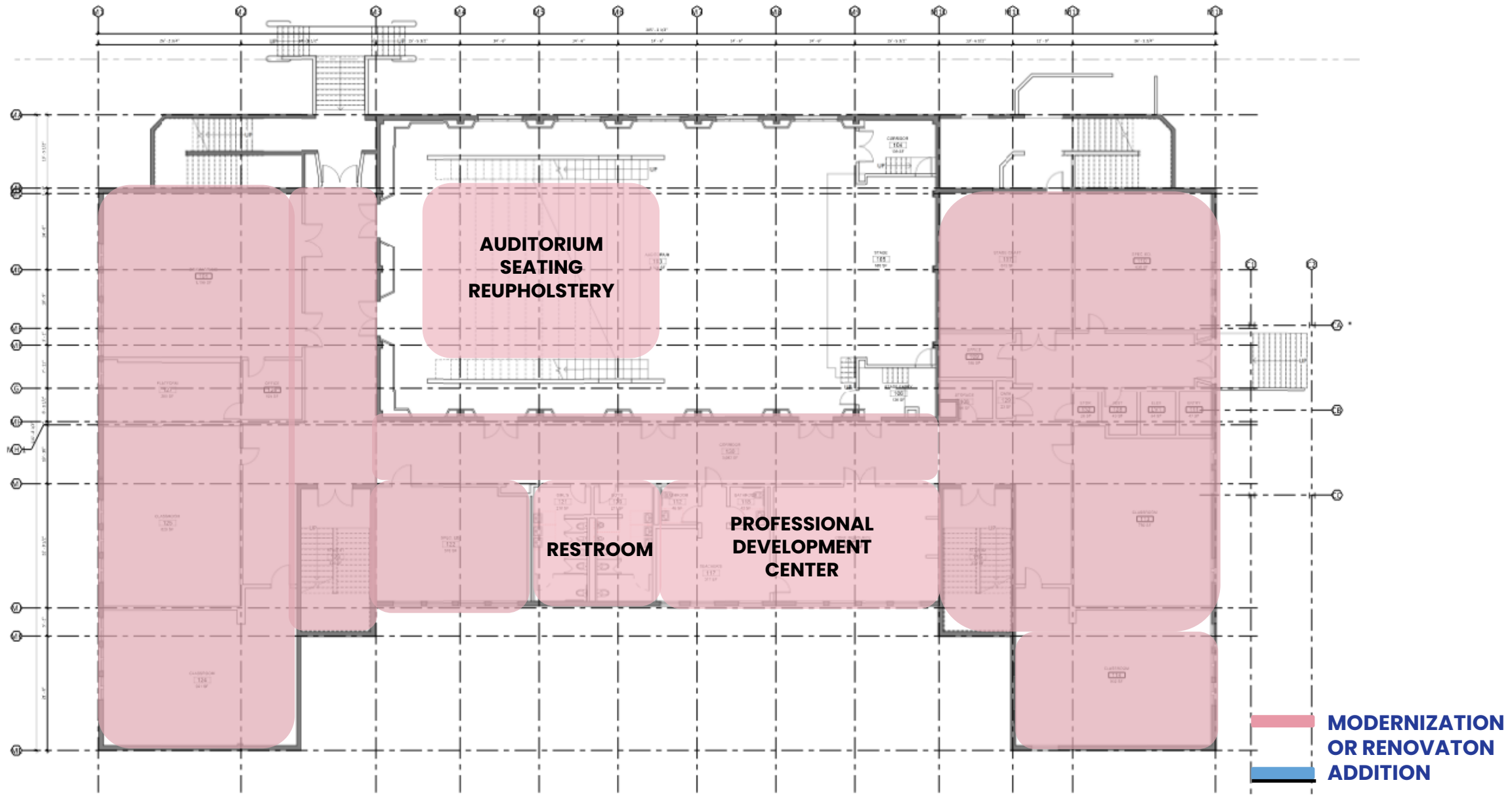

PROPOSED MODERNIZATION

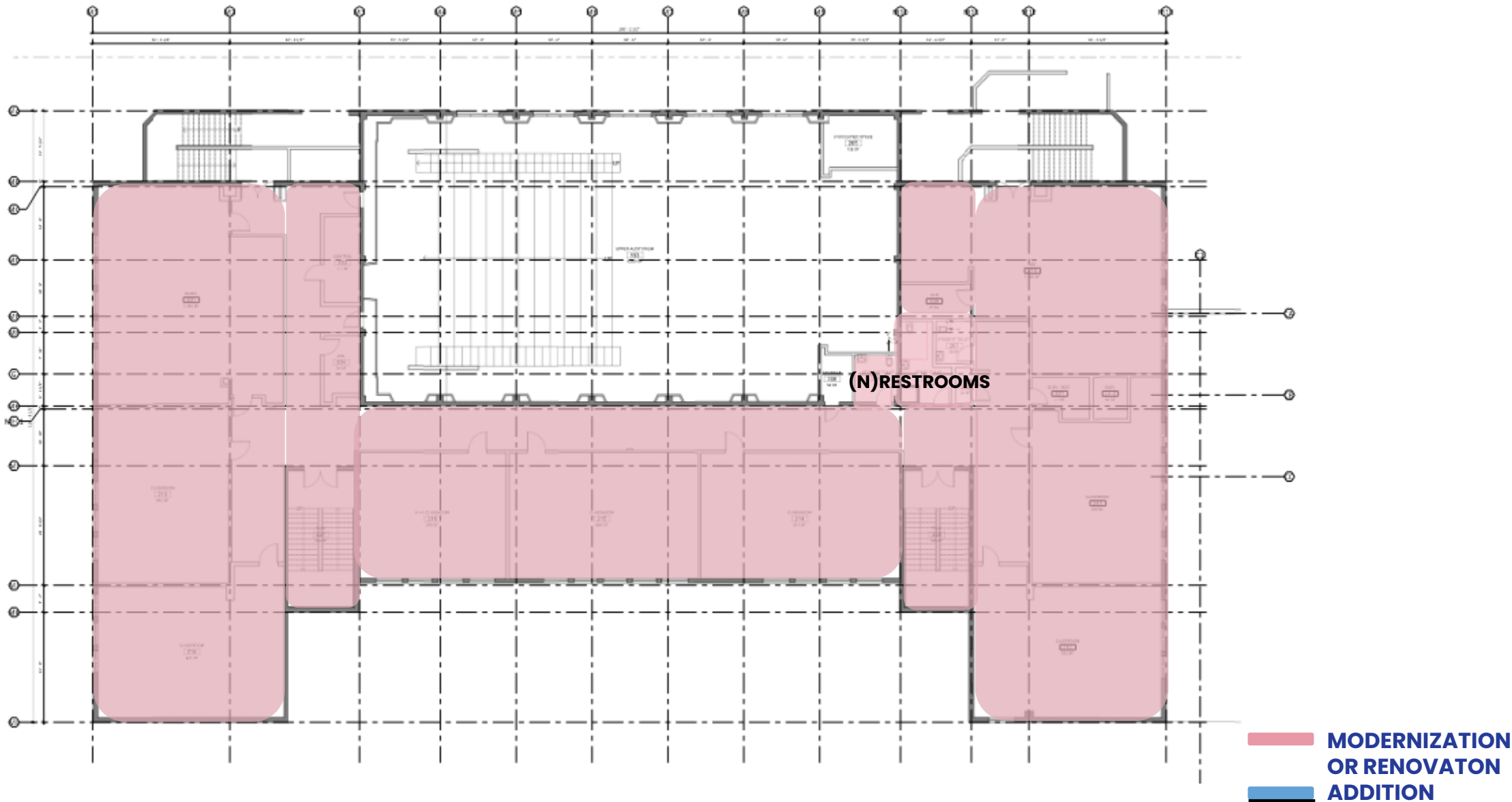



LONGFELLOW MIDDLE SCHOOL

1500 DERRY STREET

PROJECT SCHEDULE

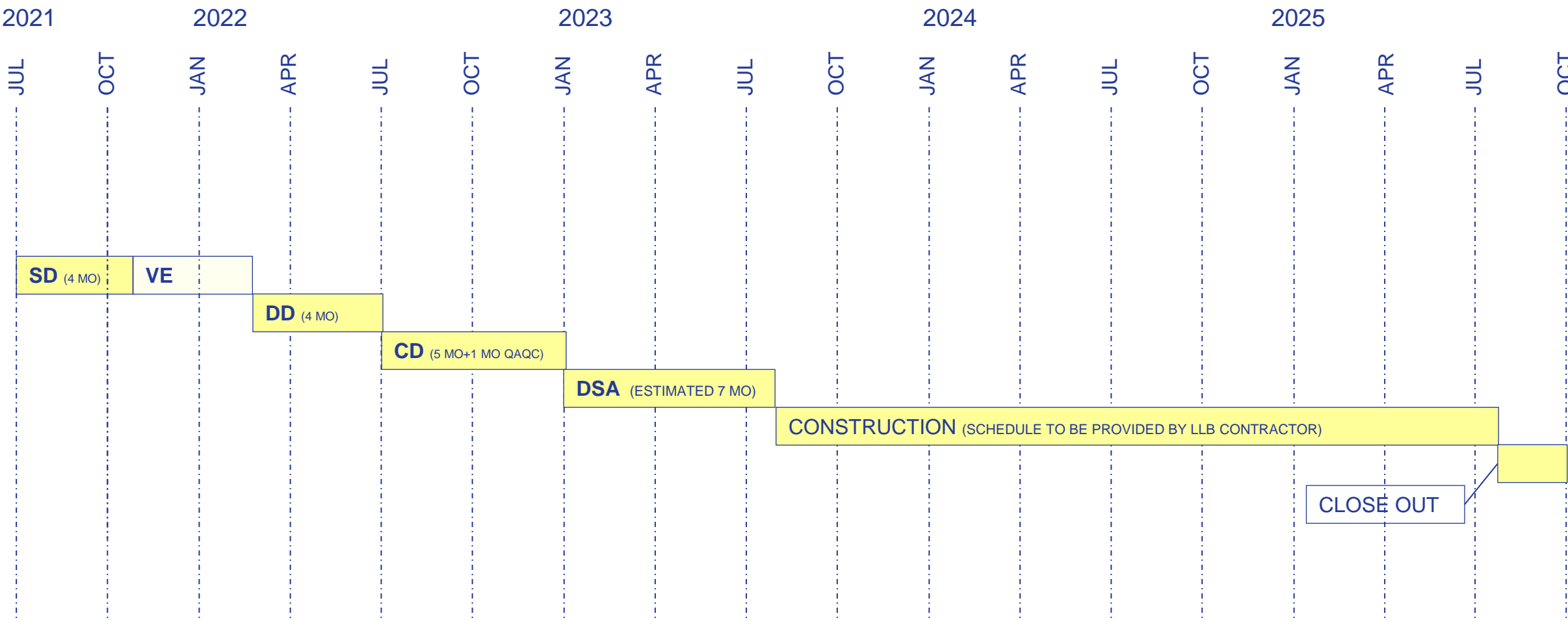



QUESTIONS & COMMENTS
