

Master Facilities Planning

Facilities Needs for the Ayer Site

Outline

Background and Goals

Review of Existing Facilities

Explore Concepts for new Facilities

Background

+

Goals

CONCEPT *A*



PROS _____





CONS

STUDY: Second High School Campus at Ayer

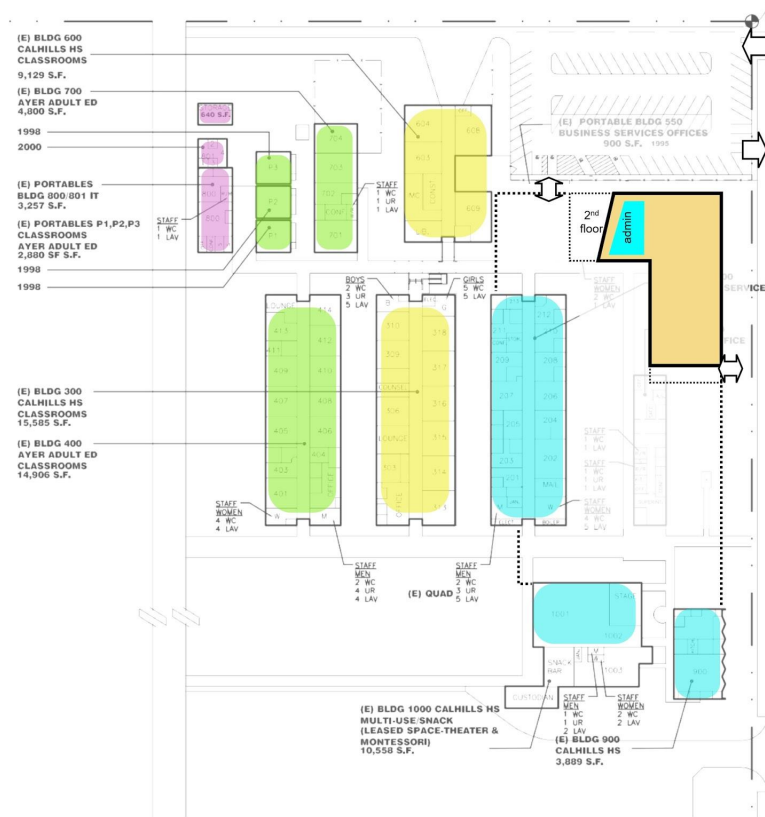
CONCEPT *B*

“Keep DO onsite”



-  district offices
in new 2 story building
-  tech services
remains on site
-  adult education
remains on site
-  cal hills
remains on site
-  2nd high school
Occupies 100, 200,
500, 550, 900, 1000
and new building.
Capacity: 15 CR's
450 students

PROS _____

CONS _____

STUDY: Second High School Campus at Ayer

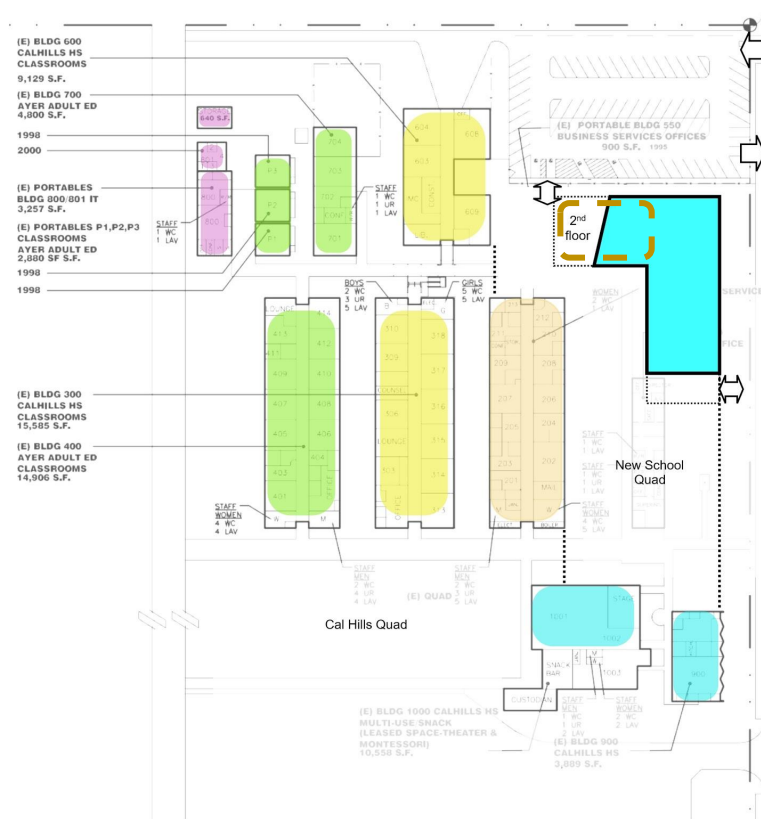

CONCEPT C

"new construction for school"

- district offices
remain in 200. occupy portion of new building
- tech services
remains on site
- adult education
remains on site
- cal hills
remains on site
- 2nd high school
occupies new 2 story Building and buildings 900, 1000

PROS _____

CONS _____

STUDY: Second High School Campus at Ayer

CONCEPT *D* Other Ideas

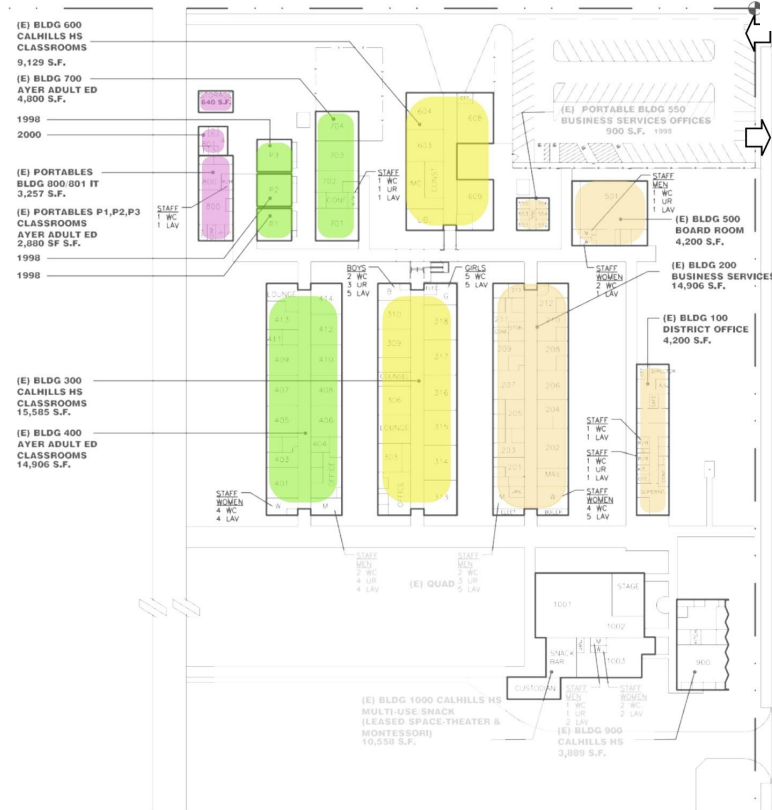

Next Steps

April	Finalize Masterplan Project List and Costs, Consultant Selection
May	Ballot Language Complete
June	Update Polling
July	Community Outreach
August	Board Resolution
Sept	Community Outreach
October	Community Outreach
November	Vote!

Projects: MHS

SCHEME PRE-A

20,800sf Classroom Bldg (15)
7,300sf MPR
14,300sf Field House
12,800sf Renovated PAB

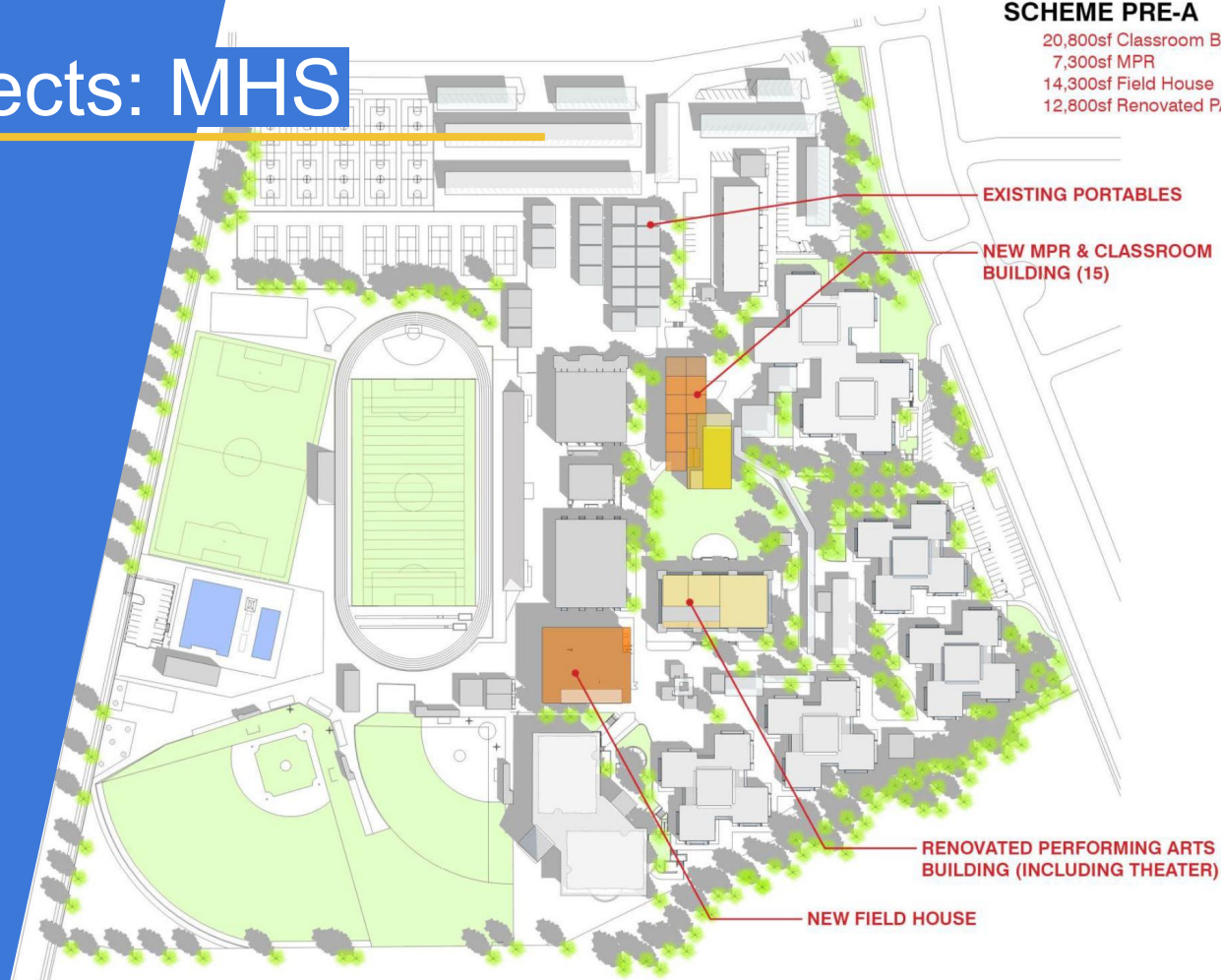

Projects: MHS

SCHEME A

19,600sf Theater
32,800sf Classroom Bldg (25)
7,300sf MPR
14,300sf Field House
12,800sf Renovated PAB

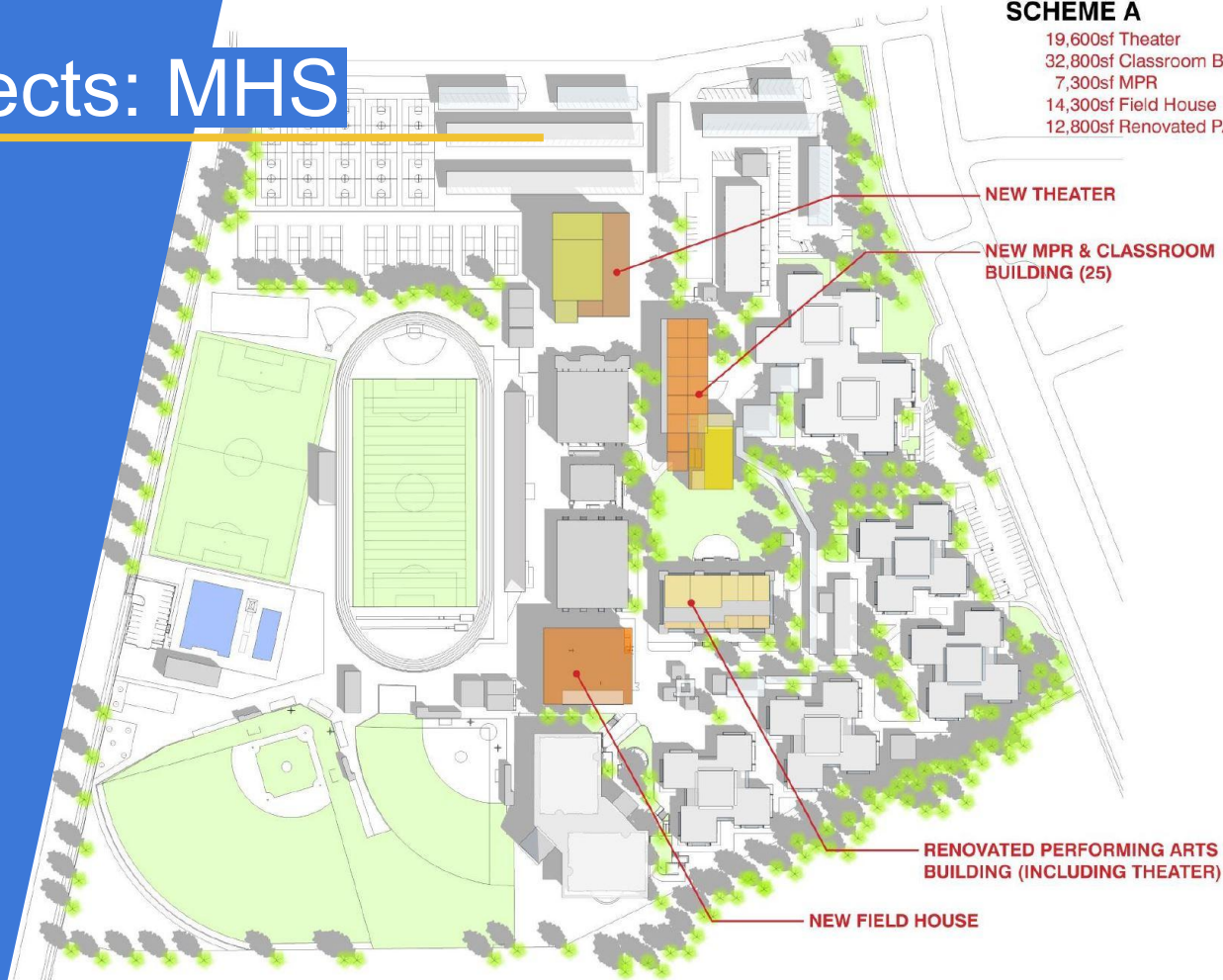

Questions



Folia Buildings (Blach)

Cherry Creek School



A state-of-the-art **Science, Technology, Engineering & Mathematics**, or STEM facility, will be built on the esplanade between Prairie Middle School and Overland High School in the Cherry Creek School District. This **Institute of Science & Technology (IST)** building is scheduled to open in August 2011, and the 58,000-square-foot structure will serve 6th through 12th graders.

The program will offer the following areas of concentration for students to compete for global opportunities leading to careers in Energy, Bioscience, Aerospace, Medicine and Information Technology.

Projects: Project List

Site	Bond Priorities	Total Assessed Need
Burnett	\$5,514,260	\$34,753,171
Curtner	\$8,391,195	\$32,640,490
Mattos	\$53,679,098	\$53,679,098
Pomeroy	\$5,956,695	\$28,805,403
Randall	\$27,287,054	\$62,558,024
Rose	\$5,311,195	\$22,257,818
Sinnott	\$6,715,839	\$29,354,039
Spangler	\$10,264,413	\$26,982,431
Weller	\$5,663,965	\$21,700,707
Zanker	\$5,603,098	\$25,151,301
CDC & Sunnyhills	\$5,027,386	\$9,465,403
Rancho	\$7,716,604	\$47,440,576
Russell	\$9,143,155	\$41,145,481
MHS	\$130,757,690	\$197,955,487
MOT	\$2,527,743	\$7,347,615
Ayer Education Park	\$32,498,956	\$89,788,575
Solar Buy Out	\$0.00	\$16,000,000
Subtotal	\$322,058,348	\$747,025,618
Program Contingency	\$16,102,917	\$37,351,281
Program Total	\$338,161,265	\$784,376,899

Project Categories (Example of each school type - needs updating)

Package Name	Examples		Curtner	Rancho	MHS
			\$9,525,764	\$8,273,630	\$102,052,153
Safety and Security	Drop-off, added lighting, fencing, door hardware		8%	9%	2%
Code	Fire alarms, handicap accessibility		9%	14%	2%
Playgrounds	MOT improvements, equipment, code		7%		
Paving	Blacktop, parking, drop-off areas		2%	2%	1%
Roofing	Replacement or repair of roofs		4%	20%	4%
HVAC	Heating, air-conditioning, ducting replacements		25%	2%	3%
Painting	Exterior, interior painting		7%	2%	2%
Utilities	Underground and in-building utilities		6%	1%	0.31%
Building Protection	Extensive building envelope work		0%	2%	
Interior Improvements	Carpet, cabinets, misc. finishes		10%	7%	0.05%
Restroom Improvements	Finishes, fixtures, accessories		15%		2%
Student Nutrition	Equipment replacements, etc.		1%	6%	1%
Portable Restoration	Utilities, building envelope		1%	2%	1%
Portable Replacements	Replace aging portables			26%	1%
Randall Improvements	Extensive remodel of this site				
Ayer Site Education Park	Remodels and Additions				
High School Improvements	Extensive scope at the high school				79%
Site allowance	To address needs unique to each site		4%	7%	1%
Other	Items not included above				

Facilities Priorities

Top Priorities	Expand Mabel Mattos
	General Safety
	Randall Improvements
	High School Needs
	Blacktop and Concrete
	Meeting Gov. Code
	Small High School Extention at Ayer
	Protect Facilities
	Traffic and Parking
	Student Nutrition
	Spangler Pipes
	Safer Drop Off Areas
	Replace Old Portables
	Meet Enrollment Growth
	2 Story Replacements
	Sports Facilities
	School Capacity
	Roof, Paint, Siding
	Replace HVAC
	Program Improvements
	Playgrounds
	Pest Control
	Modernize Classrooms
	Keycard Door Hardware
	Improve Bathrooms
	Disabled Accessibility