



Campbell Union School District Reorganization



March 17, 2016

Reorganization Plan

School	Rosemary	Campbell Middle	Village	Blackford	Rolling Hills	Monroe
Program	Expeditionary Learning Academy (Project-based Learning)	Design Academy	Preschool Site	Community School	Visual and Performing Arts	World Language
The Change	Add 5 th Grade Classes 2016	Merge Village with CMS	Merge CMS with Village	House Social Services	Theme Focused	Theme Focused
Full Implementation	Pre-8th Grades (2017-18)	Pre-8th Grades (2017-18)	Preschool (2017-18)	Pre-5th Grades (2016-17)	5th-8th Grades (2017-18)	5th-8th Grades (2017-18)
Site Needs	Portables, 5 th Grade 25 New Classrooms Gym/Multiuse Playgrounds Parking	10 New Classrooms New Event Center Playgrounds	Furniture Playgrounds Restrooms	Portables for Service Providers	Additional Staffing for New Courses New Music Room	Additional Staffing for New Courses New Classrooms

Schools Going To	Schools Coming From													
	Home School	BLACK-FORD	CAPRI	CASTLE-MONT	FOREST HILL	LYNHAVEN	MARSHALL LANE	ROSEMARY	SHERMAN OAKS	CMS	MMS	RHMS	IDA	Actual Site Enrollment Total
	BLACKFORD	327	4	4	0	4	1	15	151				31	537
	CAPRI	10	571	5	7	16	10	34	2				29	684
	CASTLEMONT	34	10	393	1	79	0	130	26				26	699
	FOREST HILL	18	63	12	476	21	16	8	9				13	636
	LYNHAVEN	16	14	11	4	506	2	26	12				22	613
	MARSHALL LANE	1	30	6	18	0	503	5	2				14	579
	ROSEMARY	5	4	9	0	13	0	438	2				18	489
	SHERMAN OAKS	51	5	24	2	26	0	9	326				80	523
	VILLAGE	27	98	21	15	27	17	29	14				23	271
	CAMPBELL	159	133	55	1	14	1	302	9	633	27	14	18	692
	MONROE	51	5	166	0	285	1	114	201	216	606	1	44	867
	ROLLING HILLS	8	340	8	240	16	298	15	8	53	28	852	27	960
	Resident Elem. Total	489	799	485	523	692	549	694	544					
Resident Middle Total	218	478	229	241	315	300	431	218	902	661	867			
Resident Combined Total	707	1277	714	764	1007	849	1125	762				345	7550	
	The Elementary numbers for the middle schools are not counted in the totals. This is just a break down of the resident elementary schools for the middle school students.													

Instructional Program: CMS/Village

Theme and Vision Possibilities:

- ▶ “We have what the world needs...Solutions to the problems of tomorrow”
- ▶ “We are all designers”
- ▶ Parent Partnership

Instructional Program Based on:

- ▶ Authentic STEAM learning experiences
 - ▶ Project and inquiry/problem based learning
 - ▶ Design Thinking
 - ▶ Innovation and Entrepreneurship
 - ▶ Development of critical and analytical thinking skills
 - ▶ Community Partnerships
-

Campbell Design Academy

What is Design Thinking?

- ▶ A set of tools, methods, and processes by which we develop new answers for challenges, big and small
 - ▶ Definition of problems and challenges
 - ▶ Understanding of needs and constraints
 - ▶ Brainstorming innovative solutions (iterations)
 - ▶ Seeking feedback and continually improving upon ideas to make them better
-

Instructional Program: Rosemary

Expeditionary Learning Schools

- ▶ Born out of collaboration between Outward Bound and Harvard Graduate School of Education
- ▶ Comprehensive school reform model

Approach to Learning

- ▶ Learning is active.
 - ▶ Learning is challenging.
 - ▶ Learning is meaningful.
 - ▶ Learning is public.
 - ▶ Learning is collaborative.
-

Expeditionary Learning 5 Core Practices

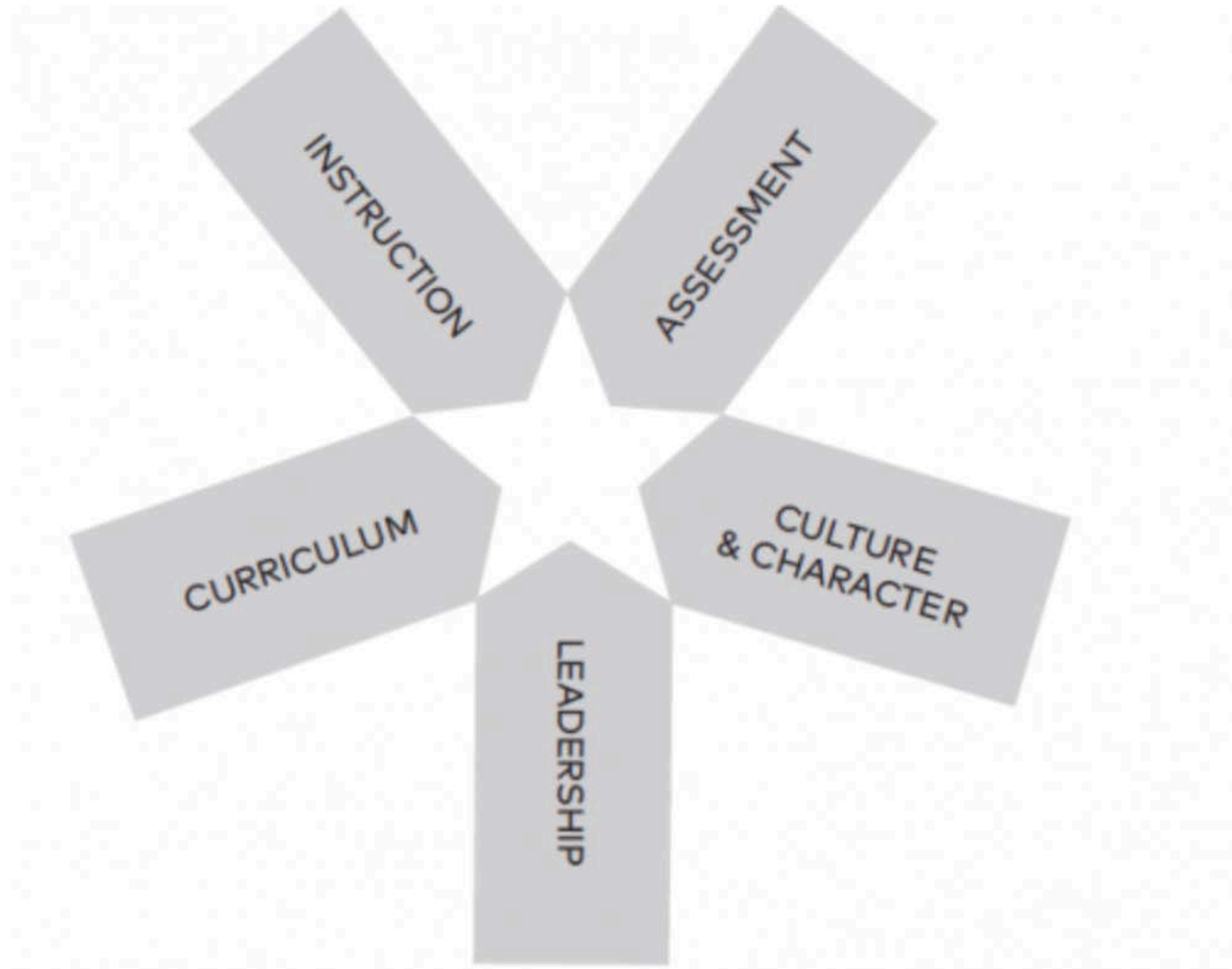

10 Design Principles of Expeditionary Learning Schools

Self-Discovery	Success and Failure
Collaboration and Competition	Diversity and Inclusion
The Having of Wonderful Ideas	The Natural World
The Responsibility for Learning	Solitude and Reflection
Empathy and Caring	Service and Compassion

Reorganization Plan

School	Rosemary	Campbell Middle	Village	Blackford	Rolling Hills	Monroe
Program	Expeditionary Learning Academy (Project-based Learning)	Design Academy	Preschool Site	Community School	Visual and Performing Arts	World Language
The Change	Add 5 th Grade Classes 2016	Merge Village with CMS	No Grades TK through 5th	House Support Services Providers	VAPA Programs	Dual Immersion Strand
Full Implementation	Pre-8th Grades (2017-18)	Pre-8th Grades (2017-18)	Preschool (2017-18)	Pre-5th Grades (2016-17)	5th-8th Grades (2017-18)	5th-8th Grades (2017-18)
Site Needs	Portables, 5 th Grade 25 New Classrooms Gym/Multiuse Playgrounds Parking	10 New Classrooms New Event Center Playgrounds	Furniture Playgrounds Restrooms	Portables for Service Providers	New Music Room	New Classrooms
Staffing	Select/Appoint principal And AP	Select/Appoint principal And AP	Additional Preschool administrative and instructional staff	No Change in admin Increase Community Liaison to 1.0 FTE	Additional Staffing for New Music, Drama & Arts (1.0)	Hire Bilingual content teachers – Science & Social Studies (0.2 each)



Charter and Non-Charter Status

		After	
		<u>Current</u>	<u>Reorganization</u>
▶ Rosemary	Charter	Charter	
▶ Old CMS	Non-Charter	Closed	
▶ New Village/CMS	Not Opened	Charter	
▶ Village	Charter	Closed	
▶ Blackford	Charter	Non-Charter	

Estimated Students, 2017-18

	<u>Enrollment</u>	<u>9th Year Enrollment</u>
Rosemary School K-8 Program		
Current Rosemary Enrollment	503	
Rosemary students at CMS	<u>304</u>	
Total	807	
 Campbell Design Academy*		
Current Village Enrollment	275	275
Remaining CMS Enrollment w/o Rosemary	368	368
Add Additional Grade Level over 3 Years (6th Grade in 2016-17)	45	135
Add Additional Kndg. Class, From 2-3 classes	<u>24</u>	<u>216</u>
Total	712	994

* Based on adding one grade level per year (6, 7 and 8) and increase from 2 to 3 Kindergarten classes per year.

Campbell Design Academy Site Plan

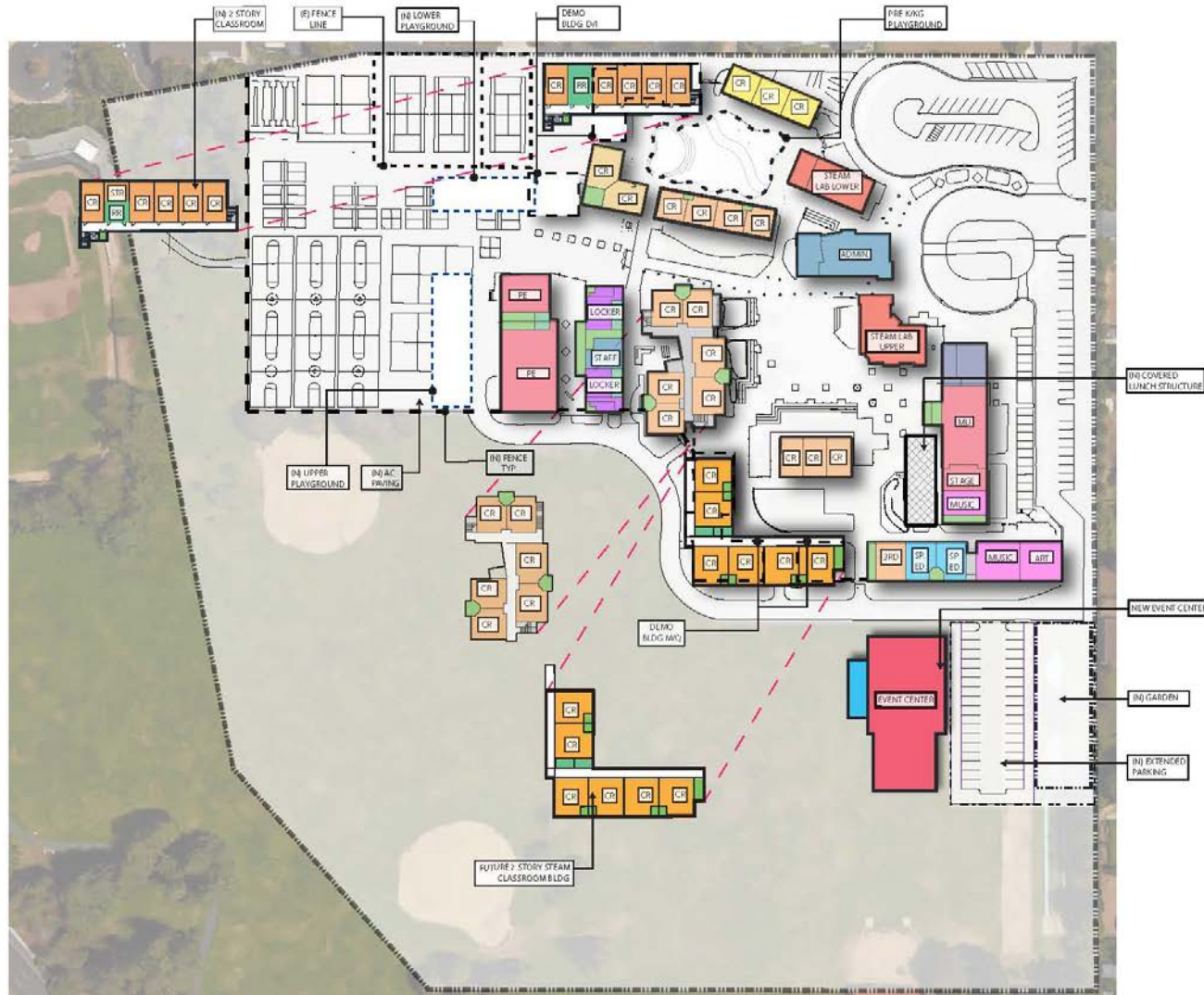

aedis
architects

Campbell
UNION SCHOOL DISTRICT

CAMPBELL MIDDLE SCHOOL NEW SITE PLAN

FOOD SERVICES
ADMIN./STAFF ROOM
SPECIAL PROGRAM
RESTROOM
STORAGE/UTILITY
CIRCULATION
COVERED WALKWAY

CLASSROOM
KINDERGARTEN
PRESCHOOL
EVENT CENTER/MU/GYM
TECHNOLOGY EDUCATION
LIBRARY/MEDIA CENTER
MUSIC/ART
LOCKER



Rosemary Site Plan

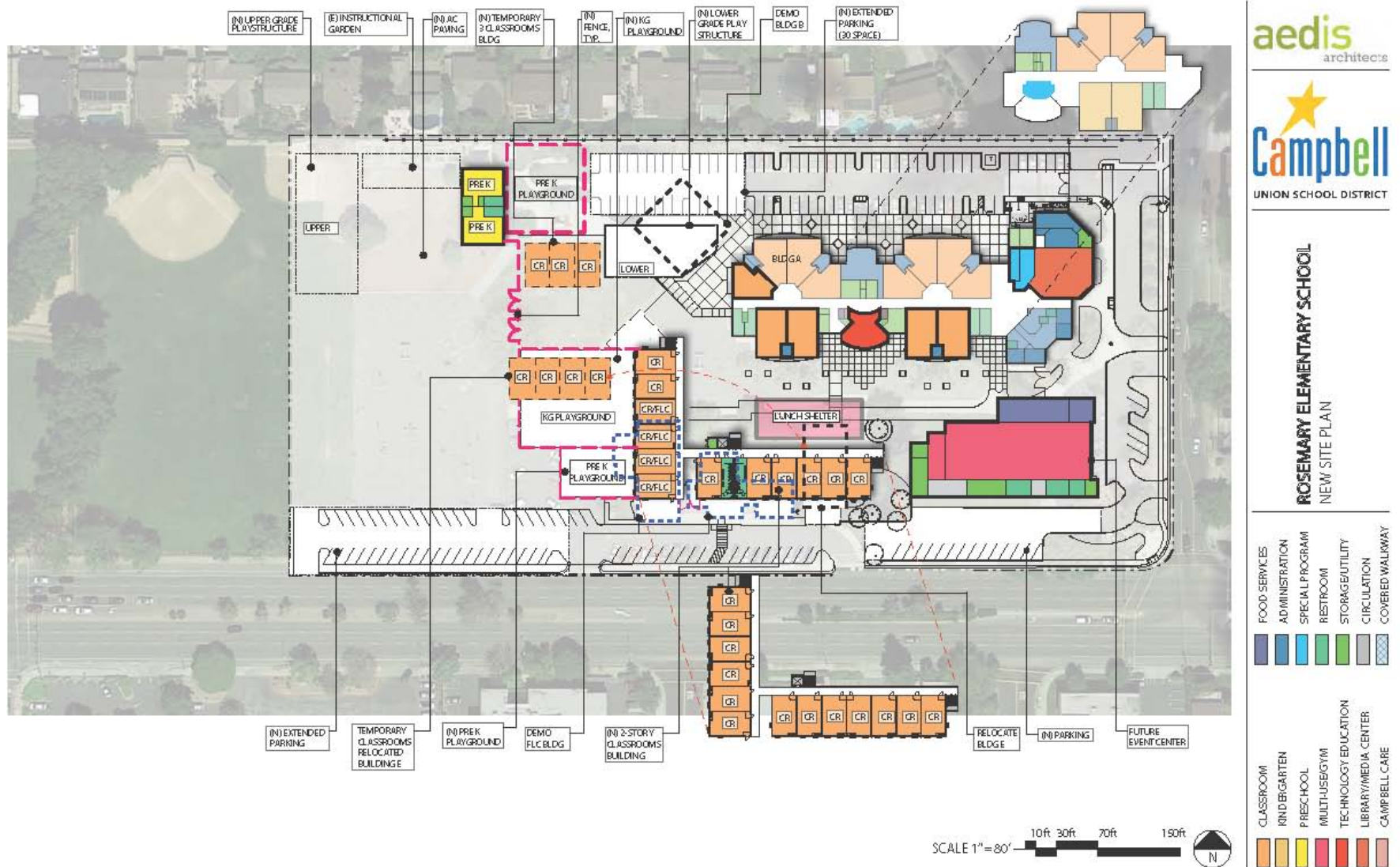

Village Site Plan



CHANGE FUNCTION
(N) PLC
(N) TOILET ROOM, TYP.
(N) OUTDOOR TEACHING AREA
(N) PLAY STRUCTURE

SCALE 1" = 60'

10ft 30ft 60ft 100ft

aedis
architects

Campbell
UNION SCHOOL DISTRICT

VILLAGE CHARTER SCHOOL NEW SITE PLAN

FOOD SERVICES
ADMINISTRATION
SPECIAL PROGRAM
RESTROOM
STORAGE/UTILITY
CIRCULATION
COVERED WALKWAY

CLASSROOM
KINDERGARTEN
PRESCHOOL
MULTI-USE/GYM
TECHNOLOGY EDUCATION
LIBRARY/MEDIA CENTER
CAMPBELL CARE

Blackford Site Plan



aedis
architects

Campbell
UNION SCHOOL DISTRICT

BLACKFORD ELEMENTARY SCHOOL NEW SITE PLAN

FOOD SERVICES
ADMINISTRATION
SPECIAL PROGRAM
RESTROOM
STORAGE/UTILITY
CIRCULATION
COVERED WALKWAY

CLASSROOM
KINDERGARTEN/T-K
PRESCHOOL
MULTI-USE/GYM
TECHNOLOGY EDUCATION
LIBRARY/MEDIA CENTER
CAMPBELL CARE

SCALE 1" = 80' 10ft 30ft 70ft 150ft



Rolling Hills Site Plan



Monroe Site Plan



aedis
architects

Campbell
UNION SCHOOL DISTRICT

MONROE MIDDLE SCHOOL NEW SITE PLAN PHASE I

FOOD SERVICES	CLASSROOM
ADMIN. / STAFF ROOM	KINDERGARTEN
SPECIAL PROGRAM	PRESCHOOL
RESTROOM	MULTI-USE GYM
STORAGE/UTILITY	TECHNOLOGY EDUCATION
CIRCULATION	LIBRARY/MEDIA CENTER
COVERED WALKWAY	MUSIC/ART
	LOCKER

SCALE 1" = 80' 10ft 30ft 70ft 150ft



Start-up Construction Schedule

<u>School Site</u>	<u>Description</u>	Estimated <u>Budget</u>	<u>Start</u>
Rosemary	Temporary Classrooms	\$150,000	Now
Rosemary	Develop Plans for New Wing/Playground	\$650,000	Now
Rosemary	Construct Classroom Building/Playground	\$14,000,000	11/2016*
CMS	Develop Plans for New Wing/Playground	\$450,000	Now
CMS	Fencing Playground	\$150,000	Fall 2016
CMS	Construct Classroom Building/Playground	\$7,000,000	11/2016*
Village	Classroom Reconfiguration	\$250,000	Spring 2017

* Pending new bond

Communication Plan

March 17, 2016	Week of March 21, 2016	Week of March 28, 2016	March 31, 2016
Board Study Session	Meet with the staff of CMS, Village, and Rosemary	Convene community meetings at CMS, Village, and Rosemary	Present updated Reorganization Plan to the Board at the Board Meeting
Identify internal champions, influencers, and opponents	Notify CETA and CSEA		

Plan B, C, D and Beyond

- ▶ Keep CMS as a 5th - 8th grade campus
 - ▶ Convert CMS to a 6th - 8th grade campus & place 5th graders at respective elementary or middle school sites
 - ▶ Close CMS and redirect students to MMS and RHMS
 - ▶ CMS as a K – 8; Keep Rosemary as a Preschool - 5
 - ▶ Consider boundary changes
-

Next Steps

- ▶ Securing Board direction
 - ▶ Continue convening both formal and informal conversations with internal (staff, parents, etc.) and external (Expeditionary Learning, Stanford, etc.) stakeholders
 - ▶ Refining the elements of the plan(s)
 - ▶ Negotiate staffing placement with CETA/CSEA
 - ▶ ?
-